

LATITUDE 37°45'00"  
**PROPOSED WELL COORDINATES**  
 N: 271359.37  
 E: 1871446.33  
 WV SOUTH ZONE  
 NAD 27

**BEARING CHART**

Well Number		Bearing	Distance
From	To		
2214	WPHC-005B	S36°55'34"E	1116.79'
WPHC-005B	WPHC-005A	S38°01'59"W	220.53'
WPHC-005A	WPHC-005C	S38°28'35"W	211.39'
WPHC-005C	1479	S75°56'12"E	2464.72'

**PLUM CREEK TIMBER LANDS LP.**  
 Deed Book 408 Page 47B  
 P/O Tax Map 123 par. 8  
 4301 ac. surface  
**WYOMING POCAHONTAS COAL CORP.**  
 4301 ac. mineral

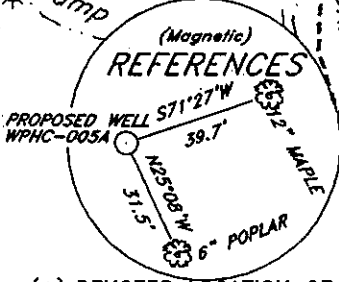

(+) DENOTES LOCATION OF WELL ON UNITED STATES TOPOGRAPHIC MAPS

FILE NO. \_\_\_\_\_  
 DRAWING NO. \_\_\_\_\_  
 SCALE 1"=2000'  
 MINIMUM DEGREE OF ACCURACY 1:280000  
 PROVEN SOURCE OF ELEVATION GPS DISK NO. N  
 2581.83'

I THE UNDERSIGNED, HEREBY CERTIFY THAT THIS PLAT IS CORRECT TO THE BEST OF MY KNOWLEDGE AND BELIEF AND SHOWS ALL THE INFORMATION REQUIRED BY LAW AND THE REGULATIONS ISSUED AND PRESCRIBED BY THE DEPARTMENT OF ENVIRONMENTAL PROTECTION.  
 (SIGNED) Bryant W. Bowman  
 R.P.E. \_\_\_\_\_ L.L.S. 736

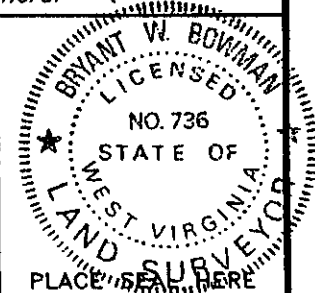

STATE OF WEST VIRGINIA  
 DEPARTMENT OF ENVIRONMENTAL PROTECTION  
 OIL AND GAS DIVISION

DATE MARCH 1, 2004  
 OPERATOR'S WELL NO. WPHC-005A  
 API WELL NO. 47-109-02400C  
 STATE COUNTY PERMIT

WELL TYPE: OIL \_\_\_ GAS \_\_\_ LIQUID INJECTION \_\_\_ WASTE DISPOSAL \_\_\_  
 (IF "GAS,") PRODUCTION \_\_\_ STORAGE \_\_\_ DEEP \_\_\_ SHALLOW \_\_\_

LOCATION: ELEVATION 2328.65' WATERSHED TROUGH FORK OF LAUREL FORK  
 DISTRICT SLAB FORK COUNTY WYOMING  
 QUADRANGLE McGRAW'S, WY

SURFACE OWNER PLUM CREEK TIMBER LANDS LP. ACREAGE 4301±  
 OIL & GAS ROYALTY OWNER PENN VIRGINIA OIL & GAS CORPORATION LEASE ACREAGE 30000±  
 LEASE NO. \_\_\_\_\_

PROPOSED WORK: DRILL  CONVERT \_\_\_ DRILL DEEPER \_\_\_ REDRILL \_\_\_ FRACTURE OR  
 STIMULATE \_\_\_ PLUG OFF OLD FORMATION \_\_\_ PERFORATE NEW  
 FORMATION \_\_\_ OTHER PHYSICAL CHANGE IN WELL (SPECIFY) \_\_\_\_\_

PLUG AND ABANDON \_\_\_ CLEAN OUT AND REPLUG \_\_\_  
 TARGET FORMATION Coal ESTIMATED DEPTH 1450

WELL OPERATOR PENN VIRGINIA OIL & GAS CORPORATION DESIGNATED AGENT MR. HARRY JEWEL  
 ADDRESS 2550 EAST STONE DRIVE SUITE 110 ADDRESS PO BOX 460  
 KINGSFORT, TN 37660 RAVENCLIFF, WV 25913