

Pinnacle Land Company, LLC -
Surface and Oil and Gas
WPP LLC - Poca No. 3 and 4 Seams
Pinnacle Mining Company, LLC -
Coal Operator
Bluestone Coal Corporation -
All Coal Seams Above No. 4
Dominion Exploration and Production Inc. -
Oil and Gas Lessee

West Virginia
 --- B-Horizontal Completion
 --- C-Horizontal Completion
 ● Proposed CBM Well
 * Proposed CBM Well

West Virginia
State Plane Coordinates
NAD 27
N 197,421.12
E 1,819,423.33

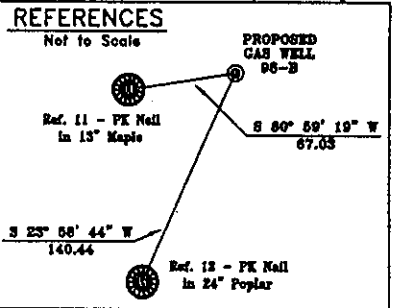

Notes:
No known domestic water supplies within 1000 feet.
(+) Denotes location of well on USGS map.

FILE No. CDXGAS
DRAWING NAME \PLATS
DRAWING NAME 98-A
SCALE 1" = 1000'
MINIMUM DEGREE OF ACCURACY 1 : 2500
PROVEN SOURCE OF ELEVATION GPS - GLOBAL POSITIONING SYSTEM

I THE UNDERSIGNED, HEREBY CERTIFY THAT THIS PLAT IS CORRECT TO THE BEST OF MY KNOWLEDGE AND BELIEF AND SHOWS ALL THE INFORMATION REQUIRED BY LAW AND THE REGULATIONS ISSUED AND PRESCRIBED BY THE DEPARTMENT OF MINES.

(SIGNED) Stacey L Boardwine
R.P.E. 15423 R.P.S.

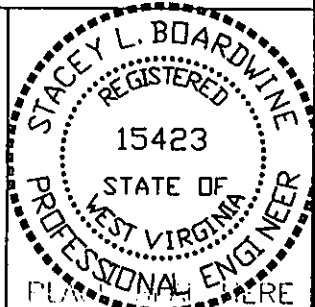

STATE OF WEST VIRGINIA
DEPARTMENT OF ENVIRONMENTAL PROTECTION
OFFICE OF OIL AND GAS
CHARLESTON, WV

DATE December 23, 2003
OPERATOR'S WELL No. 98-A
API WELL No. 47 - 109 - 02372-C
STATE COUNTY PERMIT

WELL TYPE: OIL GAS CBM LIQUID INJECTION WASTE DISPOSAL
(IF "GAS") PRODUCTION X STORAGE DEEP SHALLOW

LOCATION: ELEVATION 1990.09 WATER SHED JUD BRANCH OF INDIAN CREEK
DISTRICT BAILEYSVILLE COUNTY WYOMING
QUADRANGLE PINEVILLE, WV

SURFACE OWNER PINNACLE LAND COMPANY, LLC ACREAGE 33,742.55
CBM ROYALTY OWNER PINNACLE LAND COMPANY, LLC LEASE ACREAGE _____

LEASE No. _____

PROPOSED WORK: DRILL X CONVERT DRILL DEEPER REDRILL FRACTURE OR STIMULATE PLUG OFF OLD FORMATION PERFORATE NEW FORMATION OTHER PHYSICAL CHANGE IN WELL (SPECIFY) _____

PLUG AND ABANDON CLEAN OUT AND REPLUG

TARGET FORMATION POCAHONTAS NO. 3 AND PENN. COALS ESTIMATED DEPTH 1230'
WELL OPERATOR CDX GAS, LLC DESIGNATED AGENT JOSEPH ZUPANICK
ADDRESS P.O. BOX 609 ADDRESS PINEVILLE, WV 24874

(UNNAMED) 4-4

WYO 2372-C

State of West Virginia
Division of Environmental Protection
Section of Oil & Gas
Well Operator's Report of Well Work

#3
REVISION

Farm name: U.S. Steel Mining Company

Operator Well No: ε

Location: Elevation: 1990.09'

Quadrangle: Pinevi

District: Baileysville

County: Wyom

Latitude: 11,289 Feet South of 37 Deg. 32 Min. 30 Sec.
Longitude: 186 Feet West of 81 Deg. 35 Min. 00 Sec.

Company: CDX Gas, LLC
P.O. Box 609
Pineville, WV 24874

Agent: JOSEPH A. ZUPANICK

Inspector: Raulph Triplett
Permit Issued: 01/15/2004
Well Work commenced: 3/12/04
Well Work completed: 7/5/04

Verbal plugging
Permission granted on:
Rotary x Cable _____ Rig
Total depth (ft) A-Completion 1032', B-Completion 1221', C-Completion 1216'

Fresh water depths (ft) N/A
Salt water depths (ft) N/A
Is coal being mined in the area (Y/N)? Y
Coal depths (ft): B-Completion Void@470,822,1162
C-Completion Void@470, 822, 1162

Casing & Tubing Size	Used in Drilling	Left in Well	Cement Fill up
30"	485'	485'	59.7bbls
24"	513.5'	513.5'	127bbls
9 5/8"	513.5'	513.5'	49.8bbls
9 5/8"	513.5'	513.5'	
9 5/8"	513.5'	513.5'	
7"	960'	960'	25.6bbls
7"	1125'	1125'	30bbls
7"	1125'	1125'	30bbls

RECEIVED
Office of Oil & Gas
Office of Chief
SEP 20 2004
WV Department of
Environmental Protection

OPEN FLOW DATA

Producing formation Completion A (Non-producer)

Gas: Initial open flow N/A Mcf/d
Final open flow N/A Mcf/d

Time of open flow between initial and final tests: _____ hours
Static rock pressure _____ psig (surface pressure) after _____ hours

Pay zone depth (ft)

Oil: Initial open flow _____ Bbl/d
Final open flow _____ Bbl/d

Second Producing formation Completion B (Poca No.3)

Gas: Initial open flow _____ Mcf/d
Final open flow _____ Mcf/d

Time of open flow between initial and final tests: _____ hours
Static rock pressure _____ psig (surface pressure) after _____ hours

Pay zone depth 1167' (ft)

Oil: Initial open flow _____ Bbl/d
Final open flow _____ Bbl/d

Third Producing formation Completion C (Poca No.3)

Gas: Initial open flow _____ Mcf/d
Final open flow _____ Mcf/d

Time of open flow between initial and final tests: _____ hours
Static rock pressure _____ psig (surface pressure) after _____ hours

Pay zone depth 1162' (ft)

Oil: Initial open flow _____ Bbl/d
Final open flow _____ Bbl/d

Note: ON BACK OF THIS FORM, PUT THE FOLLOWING: 1) DETAILS OF PERFORATED INTERVALS, FRACTURING OR STIMULATING, PHYSICAL CHANGE, ETC. 2) THE WELL LOG WHICH IS A SYSTEMATICK DETAILED GEOLOGICAL RECORD OF ALL FORMATIONS, INCLUDING COAL ENCOUNTERED BY THE WELLBORE.

For: Charles T. Akers
CDX Gas, LLC

By: Charles T. Akers

Date: 9/16/04

DEC 30 2004

WYO 2372