

PROPOSED WELL COORDINATES
 N: 259062.27
 E: 1844421.80
 WV SOUTH ZONE
 NAD 27

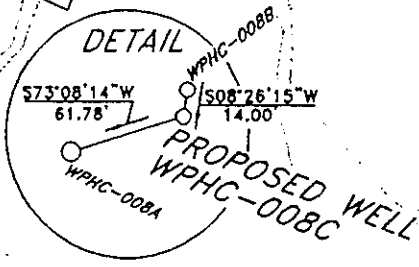
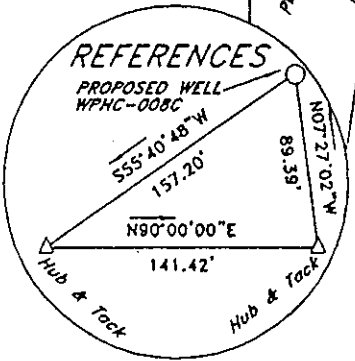

(+) DENOTES LOCATION OF WELL ON UNITED STATES TOPOGRAPHIC MAPS

FILE NO. _____
 DRAWING NO. _____
 SCALE 1"=1000'
 MINIMUM DEGREE OF ACCURACY 1:20000
 PROVEN SOURCE OF ELEVATION GPS DISK NO. 1
 ELEVATION 2347.149

I THE UNDERSIGNED, HEREBY CERTIFY THAT THIS PLAT IS CORRECT TO THE BEST OF MY KNOWLEDGE AND BELIEF AND SHOWS ALL THE INFORMATION REQUIRED BY LAW AND THE REGULATIONS ISSUED AND PRESCRIBED BY THE DEPARTMENT OF ENVIRONMENTAL PROTECTION.
 (SIGNED) Bryant M. Bowman
 R.P.E. _____ L.L.S. 736

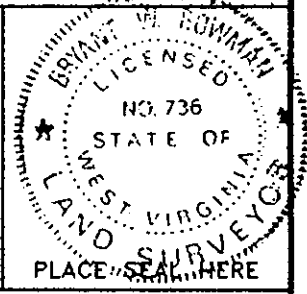

STATE OF WEST VIRGINIA
 DEPARTMENT OF ENVIRONMENTAL PROTECTION
 OIL AND GAS DIVISION

DATE JULY 24, 2003
 OPERATOR'S WELL NO. WPHC-008C
 API WELL NO. 47-109-02313C
 STATE COUNTY PERMIT

WELL TYPE: OIL GAS LIQUID INJECTION WASTE DISPOSAL
 (IF "GAS,") PRODUCTION STORAGE DEEP SHALLOW

LOCATION: ELEVATION 2384.53' WATERSHED SOW BRANCH OF LAUREL FORK
 DISTRICT SLAB FORK COUNTY WYOMING
 QUADRANGLE MATHENY, WV

SURFACE OWNER PLUM CREEK TIMBER LANDS LP. ACREAGE 30000±
 OIL & GAS ROYALTY OWNER PENN VIRGINIA OIL & GAS CORPORATION LEASE ACREAGE 30000±
 LEASE NO. _____

PROPOSED WORK: DRILL CONVERT _____ DRILL DEEPER _____ REDRILL _____ FRACTURE OR STIMULATE _____ PLUG OFF OLD FORMATION _____ PERFORATE NEW FORMATION _____ OTHER PHYSICAL CHANGE IN WELL (SPECIFY) _____

PLUG AND ABANDON _____ CLEAN OUT AND REPLUG _____
 TARGET FORMATION Barkey Pocomontas ESTIMATED DEPTH 1825'
 WELL OPERATOR PENN VIRGINIA OIL & GAS CORPORATION DESIGNATED AGENT MR. HARRY JEWEL
 ADDRESS 2550 EAST STONE DRIVE SUITE 110 ADDRESS PO BOX 460
 KINGSFORT, TN 37660 RAVENCLIFF, WV 25913

COUNTY NAME WYO PERMIT 2313C

FORM WW-6

State of West Virginia
Division of Environmental Production
Section of Oil and Gas
Well Operator's Report of Well Work

Farm Name Plum Creek Timber Company

Operator Well No.: WPHC-008C

LOCATION: Elevation: 2384

Quadrangle: Matheny 7 1/2'

District: Slab Fork County: Wyoming
Latitude: 14500 Feet South of 37 Deg. 45 Min. 00 Sec.
Longitude: 10920 Feet West of 81 Deg. 30 Min. 00 Sec.

Company:

Penn Virginia Oil & Gas Corporation

	Casing and Tubing	Used in drilling	Left in well	Cement fill up Cu. Ft.
Address: 2550 East Stone Drive, Suite 110	13 3/8"	32'	32'	0
Kingsport, TN 37660	6 5/8"	227'	227'	90
Agent: Harry Jewell	7"	1547'	1547'	295
Inspector: Ralph Triplett	2 7/8"	1802'	1802'	0
Date Permit Issued: 09/04/2003				
Date Well Work Commenced: 09/04/2003				
Date Well Work Completed: 04/11/2004				
Verbal Plugging:				
Date Permission granted on:				
Rotary X Cable Rig				
Total Depth (feet): 1,850				
Fresh Water Depth (ft):				
Salt Water Depth (ft):				
Is coal being mined in area (N/Y)?				
Coal Depths (ft):				

OPEN FLOW DATA

Producing formation Lower Beckley & Poca 6 Coals Pay zone depth (ft) _____
 Gas: Initial open flow _____ MCF/d Oil: Initial open flow _____ Bbl/d
 Final open flow 700 MCF/d Final open flow _____ Bbl/d
 Time of open flow between initial and final tests: _____ Hours
 Static rock pressure 250 psig (surface pressure) after 144 Hours

Second producing formation _____ Pay zone depth (ft) _____
 Gas: Initial open flow _____ MCF/d Oil: Initial open flow _____ Bbl/d
 Final open flow _____ MCF/d Final open flow _____ Bbl/d
 Time of open flow between initial and final tests: _____ Hours
 Static rock pressure _____ psig (surface pressure) after _____ Hours

NOTE: ON BACK OF THIS FORM PUT THE FOLLOWING: 1). DETAILS OF PERFORATED INTERVALS, FRACTURING OR STIMULATING, PHYSICAL CHANE, TEC. 2). THE WELL LOG WHICH IS A SYSTEMATIC DETAILED GEOLOGICAL RECORD OF ALL FORMATIONS, INCLUDING COAL ENCOUNTERED BY THE WELLBORE.

Signed:

By: Michael S. Stumper
Date: 12/09/2004

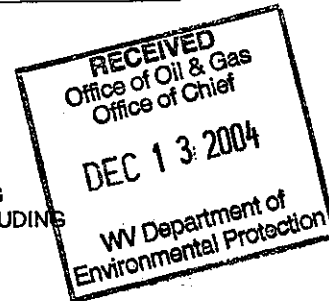

WYO 2313 C

DETAILS OF PERFORATIONS, FRACTURING, OR PHYSICAL CHANGE, ETC.

<u>FORMATIONS</u>	<u>TOP (TVD)</u>	<u>BOTTOM (TVD)</u>	<u>REMARKS</u>
Sandstone, Shale & Coal	0	1608.59	
Lower Beckley Coal	1608.59	1611.57	Drilled Horizontal
Sandstone & Shale	1611.57	1761.6	
Pocahontas #6 Coal	1761.6	1766.5	Drilled Horizontal