

**POCAHONTAS LAND COORDINATES**  
 N 45,975.170  
 E -14,256.215

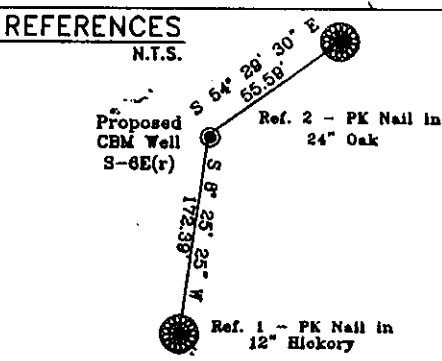

**Notes:**  
 No known domestic water supplies within 1000 feet.  
 (+) Denotes location of well on USGS map.

FILE No. CDXGAS  
 DRAWING NAME PLATS-6E  
 Drawing Number 3-17-00-1SP  
 SCALE 1" = 1000'  
 MINIMUM DEGREE OF ACCURACY 1 : 2500  
 PROVEN SOURCE OF ELEVATION USGS B.M. F44  
EL. 1565

I THE UNDERSIGNED, HEREBY CERTIFY THAT THIS PLAT IS CORRECT TO THE BEST OF MY KNOWLEDGE AND BELIEF AND SHOWS ALL THE INFORMATION REQUIRED BY LAW AND THE REGULATIONS ISSUED AND PRESCRIBED BY THE DEPARTMENT OF MINES.

(SIGNED) W. Claude Banner, Jr.  
 R.P.E. 2430 R.P.S.

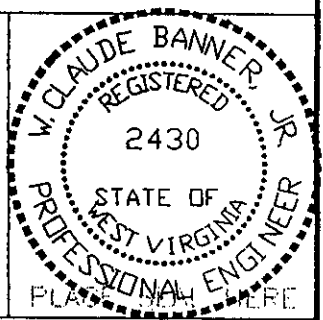

**STATE OF WEST VIRGINIA  
 DIVISION OF ENVIRONMENTAL PROTECTION  
 OFFICE OF OIL AND GAS  
 NITRO, WV**

DATE AUGUST 31, 2000  
 OPERATOR'S WELL No. S-6E(r)  
 API WELL No. 47 - 109 - 019570  
 STATE COUNTY PERMIT

WELL TYPE: OIL GAS CBM LIQUID INJECTION WASTE DISPOSAL  
 (IF "GAS") PRODUCTION X STORAGE DEEP SHALLOW  
 LOCATION: ELEVATION 2228.32 WATER SHED BAILEY BRANCH OF INDIAN CREEK  
 DISTRICT CENTER COUNTY WYOMING  
 QUADRANGLE WELCH, WV

SURFACE OWNER BERWIND LAND COMPANY ACREAGE 867.22 Tax Map 143 - Parcel 1  
 CBM ROYALTY OWNER BERWIND LAND COMPANY LEASE ACREAGE 2940.66

PROPOSED WORK: DRILL X CONVERT DRILL DEEPER REDRILL FRACTURE OR STIMULATE PLUG OFF OLD FORMATION PERFORATE NEW FORMATION OTHER PHYSICAL CHANGE IN WELL (SPECIFY)

PLUG AND ABANDON CLEAN OUT AND REPLUG  
 TARGET FORMATION POCAHONTAS NO. 3 & NO. 4 SEAMS ESTIMATED DEPTH 1559'  
 WELL OPERATOR CDX GAS, LLC MANAGER JOSEPH ZUPANICK  
 ADDRESS P.O. BOX 609 ADDRESS PINEVILLE, WV 24874

6-6 272

08T 05 2000

WYO 1957 C

State of West Virginia  
Division of Environmental Protection  
Section of Oil & Gas

*ALB*

Well Operator's Report of Well Work

Farm name: Berwind Land Company

Operator Well No: S-6E(r)

Location: Elevation: 2,228.88

Quadrangle: WELCH

District: CENTER

County: WYOMING

Latitude: 2550 Feet South of 37 Deg. 30 Min. 00 Sec.  
Longitude: 4725 Feet West of 81 Deg. 35 Min. 00 Sec.

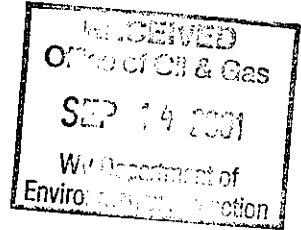

Company: CDX Gas, LLC  
P.O. Box 609  
Pineville, WV 24874

Agent: JOSEPH A. ZUPANICK

Inspector: OFIE HELMICK  
Permit Issued: 10/02/00  
Well Work commenced: 01/27/01  
Well Work completed: 07/07/01  
Verbal plugging  
Permission granted on:  
Rotary x Cable \_\_\_\_\_ Rig  
Total depth (ft) 1555'  
Fresh water depths (ft) N/A  
Salt water depths (ft) N/A  
Is coal being mined in the area (Y/N)? Y  
Coal depths (ft): 596, 792, 1451.5, 1509.5

Casing & Tubing Size	Used in Drilling	Left in Well	Cement Fill up
13 3/8"	30'	30'	Surface
9 5/8"	309'	309'	Surface
7"	1,211'	1,211'	Surface
2 7/8"	1,497'		Hanging

OPEN FLOW DATA

Producing formation Pocahontas No. 3 and No. 4 Seams  
Gas: Initial open flow N/A Mcf/d  
Final open flow N/A Mcf/d  
Time of open flow between initial and final tests: \_\_\_\_\_ hours  
Static rock pressure \_\_\_\_\_ psig (surface pressure) after \_\_\_\_\_ hours  
Pay zone depth (ft)  
Oil: Initial open flow \_\_\_\_\_ Bbl/d  
Final open flow \_\_\_\_\_ Bbl/d

Second Producing formation \_\_\_\_\_  
Gas: Initial open flow N/A Mcf/d  
Final open flow N/A Mcf/d  
Time of open flow between initial and final tests: \_\_\_\_\_ hours  
Static rock pressure \_\_\_\_\_ psig (surface pressure) after \_\_\_\_\_ hours  
Pay zone depth (ft)  
Oil: Initial open flow \_\_\_\_\_ Bbl/d  
Final open flow \_\_\_\_\_ Bbl/d

Note: ON BACK OF THIS FORM, PUT THE FOLLOWING: 1) DETAILS OF PERFORATED INTERVALS, FRACTURING OR STIMULATING, PHYSICAL CHANGE, ETC. 2) THE WELL LOG WHICH IS A SYSTEMATICK DETAILED GEOLOGICAL RECORD OF ALL FORMATIONS, INCLUDING COAL ENCOUNTERED BY THE WELLBORE.

For: Joseph Zupanick  
CDX Gas, LLC

By: J. A. Zupanick  
Date: 9/10/01

WYO 1957 C

SEP 14 2001

Operator: S-6E(r)  
API No. 47- 109-01957 C  
Location: Wyoming County

Details of Perforated Intervals, Fracturing or Stimulation, Physical Change, Etc.

N/A

Well Log & Geologic Record - Depths from K.B.

Formation	Top	Bottom
Overburden	0	6
Shale	6	15
Sandstone	15	30
Sandyshale	30	596
Coal	596	598
Sandyshale	598	719
Shale	719	726
Sandyshale	726	792
Coal	792	795
Sandyshale	795	841
Sandstone	841	950
Sandyshale	950	1250
Sandstone	1250	1451
Coal	1451.5	1456
Sandyshale	1456	1509.5
Coal	1509.5	1514
Sandyshale	1514	1555

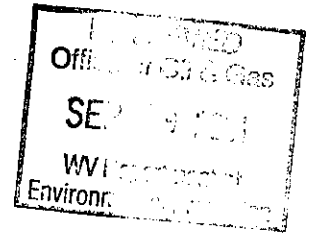

Handwritten text at the bottom right corner, possibly a signature or date, which is partially cut off and difficult to read.