



West Virginia Department of Environmental Protection
Office of Oil and Gas
WELL LOCATION FORM: GPS

API: 47-109-01242^P WELL NO.: 10046
FARM NAME: POCAHONTAS LAND CORP.
RESPONSIBLE PARTY NAME: CNX GAS COMPANY LLC
COUNTY: WYOMING DISTRICT: CENTER
QUADRANGLE: PINEVILLE 7.5 MIN.
SURFACE OWNER: PINNACLE LAND COMPANY, LLC
ROYALTY OWNER: PINNACLE LAND COMPANY, LLC
UTM GPS NORTHING: 4,151,144.16 METERS
UTM GPS EASTING: 446,735.23 METERS GPS ELEVATION: 592.35 METERS

The Responsible Party named above has chosen to submit GPS coordinates in lieu of preparing a new well location plat for a plugging permit on the above well. The Office of Oil and Gas will not accept GPS coordinates that do not meet the following requirements:

1. Datum: NAD 1983, Zone: 17 Coordinate Units: meters Altitude: Height above mean sea level (MSL) - meters
2. Accuracy to Datum - 3.05 meters
3. Data Collection Method: Survey Grade GPS : Post Processed Differential Real-Time Differential
Mapping Grade GPS : Post Processed Differential Real-Time Differential

I the undersigned hereby state this data is correct to the best of my knowledge and belief and shows all the information required by law and the regulation issued and prescribed by the Office of Oil and Gas.

Signature 
Stephen D. Losh, PS #674

Title WV Professional Surveyor #674

Date 03/09/12

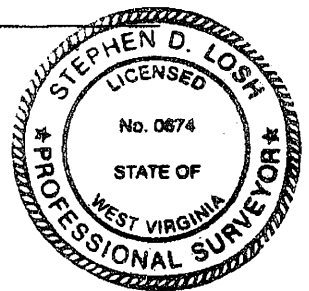

CNX USE: NAD 27 WV SOUTH SPC: 10046 = 184,666.89' 1,825,126.08' ELEV. = 1943.39'



west virginia department of environmental protection

Office of Oil and Gas
601 57th Street SE
Charleston, WV 25304
(304) 926-0450
(304) 926-0452 fax

Earl Ray Tomblin, Governor
Randy C. Huffman, Cabinet Secretary
www.dep.wv.gov

April 26, 2012

WELL WORK PLUGGING PERMIT

Plugging

This permit, API Well Number: 47-10901242, issued to CNX GAS COMPANY LLC, is evidence of permission granted to perform the specified well work at the location described on the attached pages and located on the attached plat, subject to the provisions of Chapter 22 of the West Virginia Code of 1931, as amended, and all rules and regulations promulgated thereunder, and to all conditions and provisions outlined in the pages attached hereto. Notification shall be given by the operator to the Oil and Gas Inspector at least 24 hours prior to the construction of roads, locations, and/or pits for any permitted work. In addition, the well operator shall notify the same inspector 24 hours before any actual well work is commenced and prior to running and cementing casing. Spills or emergency discharges must be promptly reported by the operator to 1-800-642-3074 and to the Oil and Gas inspector.

Upon completion of the plugging well work, the above named operator will reclaim the site according to the provisions of WV Code 22-6-30. The above named operator will also file, as required in WV Code 22-6-23, an affidavit on form WR-38 by two experienced persons in the operator's employment and the Oil and Gas inspector that the work authorized under this permit was performed and a description given. Failure to abide by all statutory and regulatory provisions governing all duties and operations here under may result in suspensions or revocation of this permit and in addition may result in civil and/or criminal penalties being imposed upon the operator.

This permit will expire in two (2) years from date of issue. If there are any questions, please free to contact me at (304) 926-0499 ext. 1654.

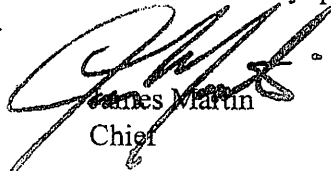

James Martin
Chief

Operator's Well No: 10046
Farm Name: PINNACLE LAND COMPANY, LL
API Well Number: 47-10901242
Permit Type: Plugging
Date Issued: 04/26/2012

Promoting a healthy environment.

APR 27 2012

WELL REFERENCES:
 N17°15'E, 107.50' TO 3" R. MAPLE
 N14°W, 109' TO 4" HICKORY

LATITUDE 37° 32' 30"

POCA. LAND CORP. (FEE)
 24,965 AC.

James
 12/11/91

3" REDBUD
 1196 Y

EAST

14" POPLAR
 PAINTED ON LINE EAST
 2644.64'

WYOMING
 CO.
 McDOWELL
 CO.

2244.75'

LONGITUDE
 81° 05' 18" W
 81° 05' 13" W

N26° 31' E
 1547.26'

S64° 45' W
 3245.66'

POCA. LAND CORP. (SUR.)
 BERWIND LAND CO. (MIN.)
 209.57 AC.

WB-50
 (PLC NO. 12)

SOUTH
 3014.81'

NORTH

POCA. LAND CORP.
 NEW RIVER COOR.:
 N. 50,528.20'
 W. 15,151.19'

LAND SURVEYING SERVICES
 21 CEDAR LANE
 BRIDGEPORT, WV 26330
 PHONE: 304-842-2018

BERWIND LAND CO.

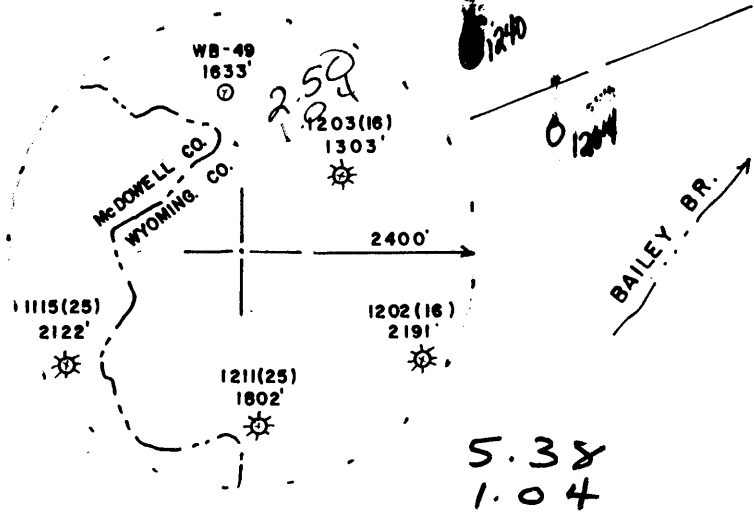

(+) DENOTES LOCATION OF WELL ON UNITED STATES TOPOGRAPHIC MAPS

FILE NO. _____
 DRAWING NO. _____
 SCALE 1" = 500'
 MINIMUM DEGREE OF
 ACCURACY 1 in 2500
 PROVEN SOURCE OF
 ELEVATION TOP OF KNOB 1750' N.W.
 OF LOCATION ELEV. - 2173'

I THE UNDERSIGNED, HEREBY CERTIFY THAT
 THIS PLAT IS CORRECT TO THE BEST OF MY
 KNOWLEDGE AND BELIEF AND SHOWS ALL THE
 INFORMATION REQUIRED BY LAW AND THE REGU-
 LATIONS ISSUED AND PRESCRIBED BY THE DEPART-
 MENT OF ENERGY.

(SIGNED) _____
 R.P.E. _____ L.L.S. 674
 STEPHEN D. LOSH

PLACE SEAL HERE

STATE OF WEST VIRGINIA
 DEPARTMENT OF ENERGY
 OIL AND GAS DIVISION



DATE SEPTEMBER 13, 19 91
 OPERATOR'S WELL NO. WB-50
 API WELL NO. PLC NO. 12

WELL TYPE: OIL ___ GAS X LIQUID INJECTION ___ WASTE DISPOSAL ___
 (IF "GAS,") PRODUCTION X STORAGE ___ DEEP ___ SHALLOW X
 LOCATION: ELEVATION 1935' WATERSHED BAILEY BRANCH
 DISTRICT CENTER 3 COUNTY WYOMING
 QUADRANGLE PINEVILLE 7.5 min. SC

SURFACE OWNER POCAHONTAS LAND CORP. ACREAGE 24,965
 OIL & GAS ROYALTY OWNER POCAHONTAS LAND CORP. LEASE ACREAGE 100.50.85

PROPOSED WORK: DRILL X CONVERT ___ DRILL DEEPER ___ REDRILL ___ FRACTURE OR
 STIMULATE ___ PLUG OFF OLD FORMATION ___ PERFORATE NEW
 FORMATION ___ OTHER PHYSICAL CHANGE IN WELL (SPECIFY) _____

PLUG AND ABANDON ___ CLEAN OUT AND REPLUG ___
 TARGET FORMATION RAVENCLIFF ESTIMATED DEPTH 2200'
 WELL OPERATOR BOWIE, INC. DESIGNATED AGENT WILLIAM BOWIE
 ADDRESS P.O. BOX 1430 1017 ADDRESS P.O. BOX 1430
 CLARKSBURG, WV 26302-1430 CLARKSBURG, WV 26302-1430

COUNTY NAME
 PERMIT

RECEIVED
Page _____ of _____
DEC 10 1991
DEPT. OF ENERGY

STATE OF WEST VIRGINIA
DEPARTMENT OF ENERGY, DIVISION OF OIL AND GAS
WELL WORK PERMIT APPLICATION

- 1) Well Operator: BOWIE, INC. 1017 6610 (3) 548
- 2) Operator's Well Number: WB 120 PLC# 12
- 3) Elevation: 2040
- 4) Well type: (a) Oil or Gas
(b) If Gas: Production Underground Storage
Deep Shallow
- 5) Proposed Target Formation(s): RAVENCLIFF 319
- 6) Proposed Total Depth: 2200 feet
- 7) Approximate fresh water strata depths: 550'
- 8) Approximate salt water depths: NA
- 9) Approximate coal seam depths: 919' 987' 1274' *WV 40-1008*
- 10) Does land contain coal seams tributary to active mine? Yes No
- 11) Proposed Well Work: new well
- 12) *Drill & Simulate New Well*

CASING AND TUBING PROGRAM

TYPE	SPECIFICATIONS			FOOTAGE INTERVALS		CEMENT Fill-up (cu. ft.)
	Size	Grade	Weight per ft.	For drilling	Left in well	
Conductor	11	API New	42.	30	30	38CSR18-11.3
Fresh Water						30CSR18-11.2.2
Coal	7			1350'	1350'	cmf. to surface
Intermediate	7	API New	20	330	330	38CSR18-11.2
Production	4 1/2	API New	10.5	2200	2200	38CSR18-11.1
Tubing						
Liners						

PACKERS : Kind _____
Sizes _____
Depths set _____

For Division of Oil and Gas Use Only

Fee(s) paid: Well Work Permit Reclamation Fund WPCP
Plat WW-9 WW-2B Bond Blanket Agent

13022

2322

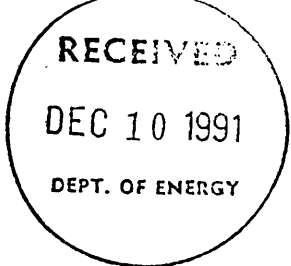

1) Date: September 19, 1991
2) Operator's well number
WB 50 PLC # 12
3) API Well No: 47 - 109 - 1242
State - County - Permit

STATE OF WEST VIRGINIA
DEPARTMENT OF ENERGY, DIVISION OF OIL AND GAS

NOTICE AND APPLICATION FOR A WELL WORK PERMIT

- | | |
|--|--|
| <p>4) Surface Owner(s) to be served:</p> <p>(a) Name <u>Pocahontas Land Corp.</u>
Address <u>Box 1517</u>
<u>Bluefield, WV 24701</u></p> <p>(b) Name _____
Address _____</p> <p>(c) Name _____
Address _____</p> | <p>5) (a) Coal Operator:</p> <p>Name <u>U. S. Steel Mining Co.</u>
Address <u>P.O. Box 430</u>
<u>Gary, WV 24836</u></p> <p>(b) Coal Owner(s) with Declaration</p> <p>Name _____
Address _____</p> <p>Name _____
Address _____</p> <p>(c) Coal Lessee with Declaration</p> <p>Name _____
Address _____</p> |
| <p>6) Inspector <u>Rodney Dillon</u>
Address <u>P.O. Box 131</u>
<u>Bradley, WV 25818</u>
Telephone (304)- <u>877-2972</u></p> | |

TO THE PERSON(S) NAMED ABOVE TAKE NOTICE THAT:

___ Included is the lease or leases or other continuing contract or contracts by which I hold the right to extract oil and gas OR
X Included is the information required by Chapter 22B, Article 1, Section 8(d) of the Code of West Virginia (see page 2)

I certify that as required under Chapter 22B of the West Virginia Code I have served copies of this notice and application, a location plat, and accompanying documents pages 1 through ___ on the above named parties, by:

- ___ Personal Service (Affidavit attached)
- ___ Certified Mail (Postmarked postal receipt attached)
- ___ Publication (Notice of Publication attached)

I have read and understand Chapter 22B and 38 CSR 11-18, and I agree to the terms and conditions of any permit issued under this application. I certify under penalty of law that I have personally examined and am familiar with the information submitted on this application form and all attachments, and that based on my inquiry of those individuals immediately responsible for obtaining the information, I believe that the information is true, accurate, and complete.

I am aware that there are significant penalties for submitting false information, including the possibility of fine and imprisonment.

Well Operator BOWIE INC.
By: [Signature]
Its: President
Address Clarksburg, WV. 26301
Box 1430
Telephone (304) 622-8896

Subscribed and sworn before me this 2nd day of October, 1991

[Signature] Notary Public
My commission expires 09/21/98

STATE OF WEST VIRGINIA
DEPARTMENT OF ENVIRONMENTAL PROTECTION
OFFICE OF OIL AND GAS

AFFIDAVIT OF PLUGGING AND FILLING WELL

AFFIDAVIT SHOULD BE IN TRIPPLICATE, one copy mailed to the Department, one copy to be retained by the Well Operator and the third copy (and extra copies if required) should be mailed to each coal operator at their respective addresses.

Farm name: Pinnacle Land LLC Operator Well No.: 10046

LOCATION: Elevation: 1935 feet Quadrangle: Pineville, WV
District: Center County: Wyoming
Latitude: 13,210 Feet South of 37 Deg. 32 Min. 30 Sec.
Longitude: 5,660 Feet West of 81 Deg. 35 Min. 00 Sec.

Well Type: OIL _____ GAS X

Company CNX Gas Co. LLC Coal Operator WPP LLC
2481 John Nash Blvd or Owner 5280 Irwin Road
Bluefield, WV 24701 Huntington, WV 25705
Agent Kent Wright Coal Operator Pinnacle Mining LLC
Permit Issued Date 04/26/2012 or Owner PO Box 338
Pineville, WV 24874

AFFIDAVIT

STATE OF WEST VIRGINIA,
County of Wyoming ss:

Jason A. Riley and Steve Greer being first duly sworn according to law depose and say that they are experienced in the work of plugging and filling oil and gas wells and were employed by the above named well operator, and participated in the work of plugging and filling the above well say that said work was commenced on the 8th day of May, 2012, and the well was plugged and filled in the following manner:

TYPE	FROM	TO	PIPE REMOVED	LEFT
Class A Cement	surface	1051'	106" - 4 1/2"	
Supertonic Cement	1051'	1625'	202" - 4 1/2"	372" 4 1/2"
Class A 3% CaCl	1625'	2638'		1057" 4 1/2"
	1176	1192	16" - 7" milled	
	1225	1247	22" - 7" milled	

Description of monument: 4 ft. by 7 inch, permanent steel with API # and date and that the work of plugging and filling said well was completed on the 7th day of June, 2012.

And further deponents saith not.

Sworn and subscribe before me this 7th day of June, 2012

My commission expires: 11-13-18

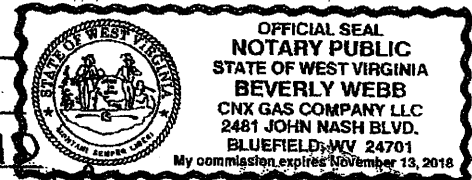

Beverly Webb
Notary Public

Affidavit reviewed by the Office of Oil and Gas: Benny Stiles

Title: inspector

JUL 2 2012
Environmental
08/03/2012