



west virginia department of environmental protection

Office of Oil and Gas
601 57th Street SE
Charleston, WV 25304
(304) 926-0450
(304) 926-0452 fax

Earl Ray Tomblin, Governor
Randy C. Huffman, Cabinet Secretary
www.dep.wv.gov

December 10, 2014

WELL WORK PLUGGING PERMIT

Plugging

This permit, API Well Number: 47-10901047, issued to HARPER, HAYDEN ENERGY KA, LLC, is evidence of permission granted to perform the specified well work at the location described on the attached pages and located on the attached plat, subject to the provisions of Chapter 22 of the West Virginia Code of 1931, as amended, and all rules and regulations promulgated thereunder, and to all conditions and provisions outlined in the pages attached hereto. Notification shall be given by the operator to the Oil and Gas Inspector at least 24 hours prior to the construction of roads, locations, and/or pits for any permitted work. In addition, the well operator shall notify the same inspector 24 hours before any actual well work is commenced and prior to running and cementing casing. Spills or emergency discharges must be promptly reported by the operator to 1-800-642-3074 and to the Oil and Gas inspector.

Upon completion of the plugging well work, the above named operator will reclaim the site according to the provisions of WV Code 22-6-30. The above named operator will also file, as required in WV Code 22-6-23, an affidavit on form WR-38 by two experienced persons in the operator's employment and the Oil and Gas inspector that the work authorized under this permit was performed and a description given. Failure to abide by all statutory and regulatory provisions governing all duties and operations here under may result in suspensions or revocation of this permit and in addition may result in civil and/or criminal penalties being imposed upon the operator.

This permit will expire in two (2) years from date of issue. If there are any questions, please free to contact me at (304) 926-0499 ext. 1654.



James Martin
Chief

Operator's Well No: WB 10
Farm Name: POCAHONTAS LAND CORP.
API Well Number: 47-10901047
Permit Type: Plugging
Date Issued: 12/10/2014

PERMIT CONDITIONS

West Virginia Code §22-6-11 allows the Office of Oil and Gas to place specific conditions upon this permit. Permit conditions have the same effect as law. Failure to adhere to the specified permit conditions may result in enforcement action.

CONDITIONS

1. All pits must be lined with a minimum of 20 mil thickness synthetic liner.
2. In the event of an accident or explosion causing loss of life or serious personal injury in or about the well or while working on the well, the well operator or its contractor shall give notice, stating the particulars of the accident or explosion, to the oil and gas inspector and the Chief within twenty-four (24) hours.
3. Well work activities shall not constitute a hazard to the safety of persons.

10901047P

WW-4B
Rev. 2/01

1) Date AUGUST 22, 2014
2) Operator's
Well No. WB 10
3) API Well No. 47-109 - 01047

STATE OF WEST VIRGINIA
DEPARTMENT OF ENVIRONMENTAL PROTECTION
OFFICE OF OIL AND GAS

APPLICATION FOR A PERMIT TO PLUG AND ABANDON

4) Well Type: Oil ___ / Gas X / Liquid injection ___ / Waste disposal ___ /
(If "Gas, Production ___ or Underground storage ___) Deep ___ / Shallow X

5) Location: Elevation 1297' Watershed INDIAN CREEK
District CENTER County WYOMING Quadrangle PINEVILLE 7.5

6) Well Operator HAYDEN HARPER ENERGY KA, LLC 7) Designated Agent BRETT MCDONOUGH
Address 1001 MOOREHEAD SQ. DR. STE 350 Address 1001 MOOREHEAD SQ. DR. STE 350
CHARLOTTE, NC 28203 CHARLOTTE, NC 28203

8) Oil and Gas Inspector to be notified
Gary Kennedy
PO Box 268
Nimitz, WV 25978

9) Plugging Contractor
Name PATCHWORK OIL & GAS, LLC
Address 8165 ELIZABETH PIKE
ELIZABETH, WV 26143

10) Work Order: The work order for the manner of plugging this well is as follows:

Plugging schematic and procedure on next page.

Notification must be given to the district oil and gas inspector 24 hours before permitted work can commence.

Work order approved by inspector *Gary Kennedy* Date 10/31/14

12/12/14

WB #10
47-109-01047

PROPOSED PLUGGING PROCEDURE

1. Prepare plugging permit application.
2. Certify to surface and coal owners.
3. Certify to State inspector for signature.
4. Once all signatures are obtained, copy for our records and certify to Jeff at the State Office for approval.
5. Receive plugging permit good for 2 years.
6. Notify the designated State inspector 24 hours prior to commencing operations.
7. Take equipment to location and begin prepping for plug.
8. Rig up
9. Verify total depth of 1420'
10. Run tubing to TD. Set first plug with 21 sacks of Class A cement with no more than 3% CaCl₂ and no other additives from TD up to 1130'. This will cover bottom plug, perforations and elevation. Pull tubing back.
12. Wait 8 hours, run in and tag plug.
13. Begin looking for freepoint.
14. Run 1 sack of 6% Bentonite gel from 1130' up to 820'.
15. Based on cement fill up on records the 4 1/2 free point should be around 770'.
16. Rip and remove 770' of 4 1/2, run tubing back in to 820', run 33 sacks for second plug of Class A cement with no more than 3% CaCl₂ and no other additives from 820' up to 667'.
17. Pull tubing back, wait 8 hours
18. Run in and tag plug.
19. Run 6 sacks of 6% Bentonite gel from 667' up to 200'.



20. Pull tubing back to 200' and run 57 sacks of Class A cement with no more than 3% CaCl₂ and no other additives to surface.
21. Solidify pit if necessary with more cement and lime, then bury.
22. Set 6" x 12.5" steel pipe with concrete with 1/2" API identification.
23. Rig down, and move equipment out.
24. Reclaim location
25. Prepare WR-34 & WR-38 for permit release.



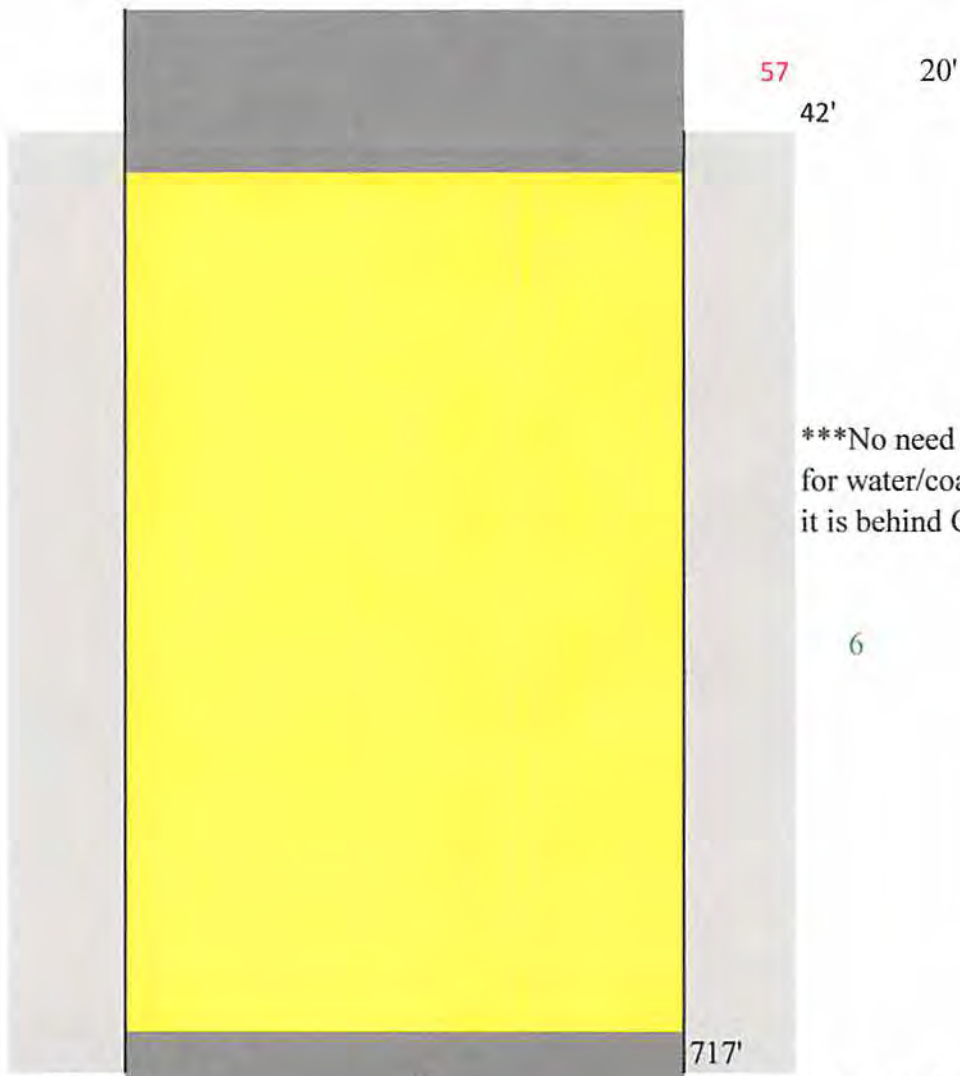

***No need to set plug for water/coal at 300' it is behind CTS 8 5/8

6

Cement fill up to approx. 777.5 attempt to rip 4 1/2 at 770'

50lb sacks of 6% gel used
100lb sacks of cement

Cement plugs are at a minimum of 100' Class A Cement with no more than 3% CaCl2 and no other additives.

Gel spacers between all cement plugs must be fresh water with at least 6% Bentonite by weight

Perforations at 1180-1280

- : Cement
- : Gel
- : Bridge Plug (if any)

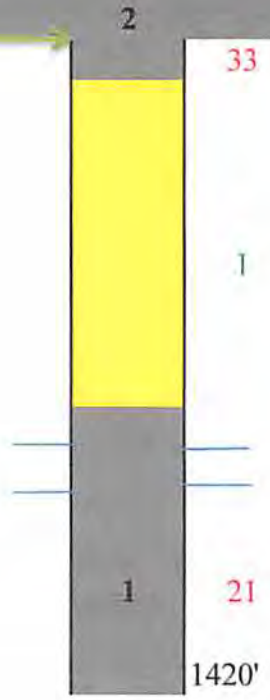

- Plug #3 200-surface
 - Plug #2 667-820 Casing rip
 - Plug #1 1130-1420 bottom, perf, elev.

WJK

109 010479

WR-35
RECEIVED
DEC 20 1989

08-Jun-88
API # 47-109-01047

State of West Virginia
DEPARTMENT OF ENERGY
Division of Oil and Gas

DIVISION OF OIL & GAS
DEPARTMENT OF ENERGY
Well Operator's Report of Well Work

Farm name: POCAHONTAS LAND CORP. Operator Well No.: WB 10

LOCATION: Elevation: 1297.00 Quadrange: PINEVILLE

District: CENTER County: WYOMING
Latitude: 5600 Feet South of 37 Deg. 32Min. 30 Sec.
Longitude: 2640 Feet West of 81 Deg. 35 Min. 0 Sec.

Company: BOWIE, INC.
132 WALDECK STREET
CLARKSBURG, WV

Asent: WILLIAM H. BOWIE

Inspector: ARTHUR ST. CLAIR
Permit Issued: 06/08/88
Well work Commenced: 11/16/89
Well work Completed: 11/26/89
Verbal Plugging
Permission granted on:
Rotary Cable _____ Ris _____
Total Depth (feet) 1420
Fresh water depths (ft) 30, 57, 300
Salt water depths (ft) NA
Coal seams mined in area (Y/N)?
Coal Depths (ft): 140-144, 350-356, 470-472

Casing Size	Used in Drillings	Left in Well	Cement Fill Up Cu. Ft.
16"	20'		
11 3/4"	42'		
8 5/8"	717	717	CTS
4 1/2"	1402	1402	1455KS

OPEN FLOW DATA

Producing formation: RAVENCLIFF Pay zone depth (ft) 1180-1280
 Gas: Initial open flow SHAW MCF/d Oil: Initial open flow _____ Bbl/d
 Final open flow 450 MCF/d Final open flow _____ Bbl/d
 Time of open flow between initial and final tests _____ Hours
 Static rock Pressure 320 psig (surface pressure) after _____ Hours

Second producing formation _____ Pay zone depth (ft) _____
 Gas: Initial open flow _____ MCF/d Oil: Initial open flow _____ Bbl/d
 Final open flow _____ MCF/d Final open flow _____ Bbl/d
 Time of open flow between initial and final tests _____ Hours
 Static rock Pressure _____ psig (surface pressure) after _____ Hours

NOTE: ON BACK OF THIS FORM PUT THE FOLLOWING: 1). DETAILS OF PERFORATED INTERVALS, FRACTURING OR STIMULATING, PHYSICAL CHANGE, ETC. 2). THE WELL LOG WHICH IS A SYSTEMATIC DETAILED GEOLOGICAL RECORD OF ALL FORMATIONS, INCLUDING COAL ENCOUNTERED BY THE WELLBORE.

For: BOWIE, INC.

By: Bradley W. Thomas

Date: 12-4-89

WYOM 140

[Handwritten signature]

(REVISED)

10901047P

DETAILS OF PERFORMED INTERVALS, FLUORIDES OR SPURRIATION, PHYSICAL CHANGE, ETC.

PERFORATIONS: 30 HOLES (1198-1272), 50000S SAND, 750 gal 15% HCl, 600 BBL 75Q FORM

WELL LOG

FORMATION	COLOR	HARD OR SOFT	TOP FEET	DEPTH FEET	REMARKS Including indication of all fresh and salt water, coal, oil and gas
FILL			0	10	
SAND			10	50	
SAND & shale			50	140	3" STREAM H ₂ O @ 30'
COAL			140	144	2" STREAM H ₂ O @ 57'
SAND & shale			144	190	
SAND			190	350	2" STREAM H ₂ O @ 300'
COAL			350	356	
SAND & shale			356	470	
SAND			470	740	
shale			740	792	
SAND			792	834	
SHALE & Red Rock			834	1148	
SAND			1148	1272	GAS SHOW
LIME			1272	1318	
Shale & Red Rock			1318	1350	
SAND			1350	1420 DTD	

RECEIVED
DEC 20 1989

DIVISION OF OIL & GAS
DEPARTMENT OF ENERGY

782L

[Handwritten signature]

Jan 5/24/88

10901047P

WELL REFERENCES:
N05°E, 95.50' TO POWER POLE
S16°30'E, 119' TO 10" POPLAR

LATITUDE 37°32'30"

2640'

TIE LINES:

- A - N 14° 26' 10" E, 636.66'
- B - S 19° 03' 00" E, 2737.78'
- C - N 28° 05' 35" W, 2234.57'

NORTH

POCA LAND COOR. =
N. 58,102.97'
W. 12,085.73'

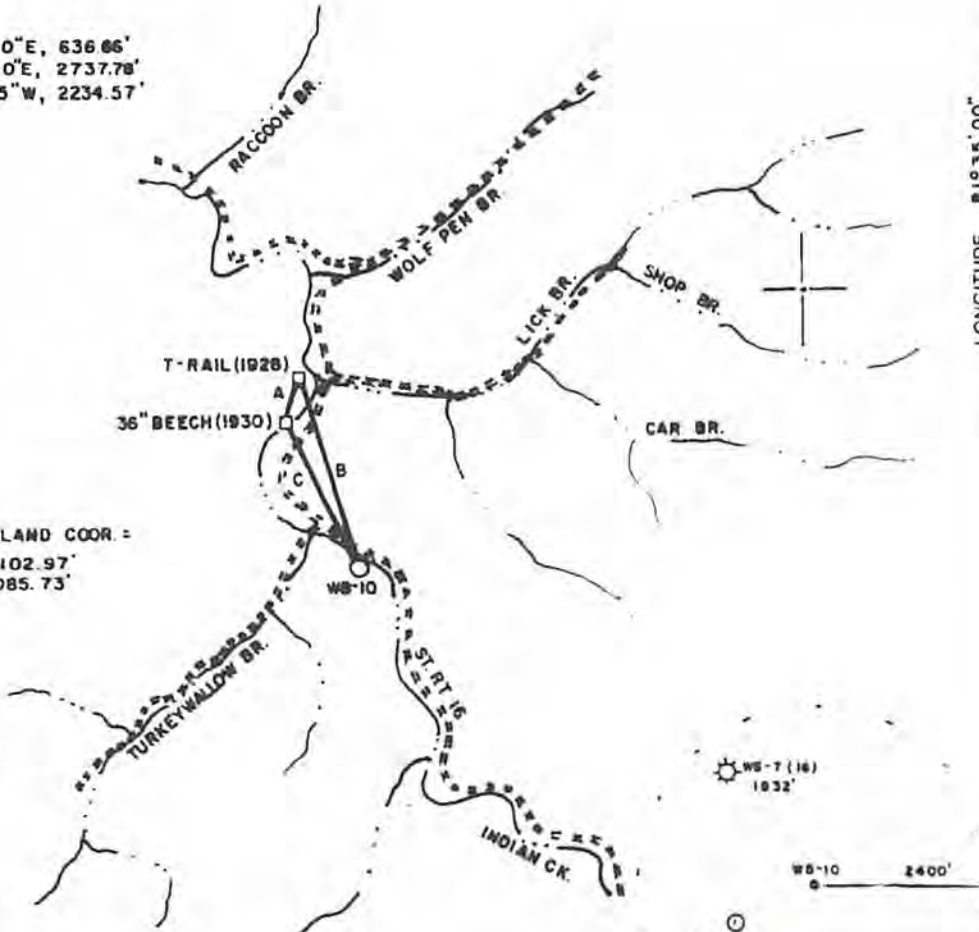

LONGITUDE 81°35'00"

LAND SURVEYING SERVICES
21 CEDAR LANE
BRIDGEPORT, WV 26330
PHONE 304-842-2018

(+) DENOTES LOCATION OF WELL ON UNITED STATES TOPOGRAPHIC MAPS

FILE NO. _____
 DRAWING NO. _____
 SCALE 1" = 2000'
 MINIMUM DEGREE OF ACCURACY 1 in 2500
 PROVEN SOURCE OF ELEVATION BM 2600' N OF LOCATION ELEV. 1281'

I THE UNDERSIGNED, HEREBY CERTIFY THAT THIS PLAT IS CORRECT TO THE BEST OF MY KNOWLEDGE AND BELIEF AND SHOWS ALL THE INFORMATION REQUIRED BY LAW AND THE REGULATIONS ISSUED AND PRESCRIBED BY THE DEPARTMENT OF ENERGY.

(SIGNED) *Stephen D. Losh*
 R.P.E. _____ I.L.S. 874
 STEPHEN D. LOSH



STATE OF WEST VIRGINIA
 DEPARTMENT OF ENERGY
 OIL AND GAS DIVISION



DATE JANUARY 02, 1988
 OPERATOR'S WELL NO. WB-10
 API WELL NO. 47-109-1047

WELL TYPE: OIL ___ GAS LIQUID INJECTION ___ WASTE DISPOSAL ___
 (IF "GAS,") PRODUCTION STORAGE ___ DEEP ___ SHALLOW

LOCATION: ELEVATION 1297' WATER SHED INDIAN CREEK
 DISTRICT _____ CENTER _____ COUNTY WYOMING

QUADRANGLE PINEVILLE 7.5 min.
 SURFACE OWNER POCAHONTAS LAND CORP. ACREAGE 24,980.40

OIL & GAS ROYALTY OWNER POCAHONTAS LAND CORP. LEASE ACREAGE 10,050.85
 LEASE NO. 56244

PROPOSED WORK: DRILL CONVERT ___ DRILL DEEPER ___ REDRILL ___ FRACTURE OR
 STIMULATE ___ PLUG OFF OLD FORMATION ___ PERFORATE NEW
 FORMATION ___ OTHER PHYSICAL CHANGE IN WELL (SPECIFY) _____

PLUG AND ABANDON ___ CLEAN OUT AND REPLUG ___

TARGET FORMATION BIG LIME ESTIMATED DEPTH 2900'

WELL OPERATOR BOWIE, INC. DESIGNATED AGENT WILLIAM BOWE
 ADDRESS 132 WALDECK ST ADDRESS 132 WALDECK ST
 CLARKSBURG, WV 26301 CLARKSBURG, WV 26301

FORM WW-6

COUNTY NAME

PERMIT

12/12/14

10901047P

WW-4A
Revised 6-07

1) Date: AUGUST 22, 2014
2) Operator's Well Number
WB 10
3) API Well No.: 47 - 109 - 01047

STATE OF WEST VIRGINIA
DEPARTMENT OF ENVIRONMENTAL PROTECTION, OFFICE OF OIL AND GAS
NOTICE OF APPLICATION TO PLUG AND ABANDON A WELL

4) Surface Owner(s) to be served:		5) (a) Coal Operator	
(a) Name	<u>PINNACLE LAND COMPANY</u>	Name	<u>PINNACLE LAND COMPANY</u>
Address	<u>PO BOX 446</u> <u>MAN, WV 25635</u>	Address	<u>PO BOX 446</u> <u>MAN, WV 25635</u>
(b) Name	_____	(b) Coal Owner(s) with Declaration	_____
Address	_____	Name	<u>NRP, WPP LLC</u>
		Address	<u>5260 IRWIN RD.</u> <u>HUNTINGTON, WV 25705</u>
(c) Name	_____	Name	_____
Address	_____	Address	_____
6) Inspector	<u>Gary Kennedy</u>	(c) Coal Lessee with Declaration	_____
Address	<u>P.O. Box 268</u> <u>Nimitz, WV 25978</u>	Name	<u>PINNACLE LAND COMPANY & MECHEL BLUESTONE</u>
Telephone	<u>304-392-9402</u>	Address	<u>PO BOX 446</u> <u>PO BOX 1085</u> <u>MAN, WV 25635</u> <u>BECKLEY, WV 25802</u>

TO THE PERSONS NAMED ABOVE: You should have received this Form and the following documents:

- (1) The application to Plug and Abandon a Well on Form WW-4B, which sets out the parties involved in the work and describes the well its and the plugging work order; and
- (2) The plat (surveyor's map) showing the well location on Form WW-6.

The reason you received these documents is that you have rights regarding the application which are summarized in the instructions on the reverses side. However, you are not required to take any action at all.

Take notice that under Chapter 22-6 of the West Virginia Code, the undersigned well operator proposes to file or has filed this Notice and Application and accompanying documents for a permit to plug and abandon a well with the Chief of the Office of Oil and Gas, West Virginia Department of Environmental Protection, with respect to the well at the location described on the attached Application and depicted on the attached Form WW-6. Copies of this Notice, the Application, and the plat have been mailed by registered or certified mail or delivered by hand to the person(s) named above (or by publication in certain circumstances) on or before the day of mailing or delivery to the Chief.

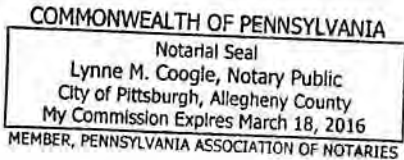

Well Operator HAYDEN HARPER ENERGY KA, LLC
 By: ERIC P LINN
 Its: VICE PRESIDENT
 Address 1001 MOREHEAD SQ DRIVE, SUITE 350
CHARLOTTE, NC 28203
 Telephone 704-343-2447

Subscribed and sworn before me this 9th day of September 2014
Lynne M Coogle Notary Public
 My Commission Expires MARCH 18, 2016

Oil and Gas Privacy Notice

The Office of Oil and Gas processes your personal information, such as name, address and phone number, as a part of our regulatory duties. Your personal information may be disclosed to other State agencies or third parties in the normal course of business or as needed to comply with statutory or regulatory requirements, including Freedom of Information Act requests. Our office will appropriately secure your personal information. If you have any questions about our use of your personal information, please contact DEP's Chief Privacy Officer at depprivacyofficer@wv.gov.

12/12/14

10901047A

SENDER: COMPLETE THIS SECTION	COMPLETE THIS SECTION ON DELIVERY
<ul style="list-style-type: none"> Complete items 1, 2, and 3. Also complete item 4 if Restricted Delivery is desired. Print your name and address on the reverse so that we can return the card to you. Attach this card to the back of the mailpiece, or on the front if space permits. 	<p>A. Signature <input type="checkbox"/> Agent <input type="checkbox"/> Addressee</p> <p><i>Donna Campbell</i></p> <p>B. Received by (Printed Name) C. Date of Delivery</p> <p><i>Donna Campbell</i> <i>9/22/14</i></p> <p>D. Is delivery address different from item 1? <input type="checkbox"/> Yes <input type="checkbox"/> No If YES, enter delivery address below:</p>
1. Article Addressed to: <i>Mechel Bluestone PO Box 1055 Beckley, WV 25802</i>	3. Service Type <input type="checkbox"/> Certified Mail <input type="checkbox"/> Express Mail <input type="checkbox"/> Registered <input type="checkbox"/> Return Receipt for Merchandise <input type="checkbox"/> Insured Mail <input type="checkbox"/> C.O.D.
2. Article Number (Transfer from service label)	4. Restricted Delivery? (Extra Fee) <input type="checkbox"/> Yes
PS Form 3811, February 2004 Domestic Return Receipt 102595-02-M-1544	

SENDER: COMPLETE THIS SECTION	COMPLETE THIS SECTION ON DELIVERY
<ul style="list-style-type: none"> Complete items 1, 2, and 3. Also complete item 4 if Restricted Delivery is desired. Print your name and address on the reverse so that we can return the card to you. Attach this card to the back of the mailpiece, or on the front if space permits. 	<p>A. Signature <input type="checkbox"/> Agent <input type="checkbox"/> Addressee</p> <p><i>[Signature]</i></p> <p>B. Received by (Printed Name) C. Date of Delivery</p> <p><i>Leslie Holker</i> <i>9/22/14</i></p> <p>D. Is delivery address different from item 1? <input type="checkbox"/> Yes <input type="checkbox"/> No If YES, enter delivery address below:</p>
1. Article Addressed to: <i>Pinnacle Land PO Box 446 Man, WV 25635</i>	3. Service Type <input type="checkbox"/> Certified Mail <input type="checkbox"/> Express Mail <input type="checkbox"/> Registered <input type="checkbox"/> Return Receipt for Merchandise <input type="checkbox"/> Insured Mail <input type="checkbox"/> C.O.D.
2. Article Number (Transfer from service label)	4. Restricted Delivery? (Extra Fee) <input type="checkbox"/> Yes
PS Form 3811, February 2004 Domestic Return Receipt 102595-02-M-1540	

SENDER: COMPLETE THIS SECTION	COMPLETE THIS SECTION ON DELIVERY
<ul style="list-style-type: none"> Complete items 1, 2, and 3. Also complete item 4 if Restricted Delivery is desired. Print your name and address on the reverse so that we can return the card to you. Attach this card to the back of the mailpiece, or on the front if space permits. 	<p>A. Signature <input type="checkbox"/> Agent <input type="checkbox"/> Addressee</p> <p><i>Amanda Beggs</i></p> <p>B. Received by (Printed Name) C. Date of Delivery</p> <p><i>Amanda Beggs</i> <i>9-22-14</i></p> <p>D. Is delivery address different from item 1? <input type="checkbox"/> Yes <input type="checkbox"/> No If YES, enter delivery address below:</p>
1. Article Addressed to: <i>NPP, WPP, LLC 5260 Irwin Rd. Huntington, WV 25705</i>	3. Service Type <input type="checkbox"/> Certified Mail <input type="checkbox"/> Express Mail <input type="checkbox"/> Registered <input type="checkbox"/> Return Receipt for Merchandise <input type="checkbox"/> Insured Mail <input type="checkbox"/> C.O.D.
2. Article Number (Transfer from service label)	4. Restricted Delivery? (Extra Fee) <input type="checkbox"/> Yes
PS Form 3811, February 2004 Domestic Return Receipt 102595-02-M-1540	

12/12/14

CK-71808
1008

STATE OF WEST VIRGINIA
DEPARTMENT OF ENVIRONMENTAL PROTECTION
OFFICE OF OIL AND GAS

CONSTRUCTION AND RECLAMATION PLAN AND SITE REGISTRATION APPLICATION FORM
GENERAL PERMIT FOR OIL AND GAS PIT WASTE DISCHARGE

Operator Name HAYDEN HARPER ENERGY KA, LLC OP Code 494495359

Watershed INDIAN CREEK Quadrangle PINEVILLE 7.5

Elevation 1297' County WYOMING District CENTER

Description of anticipated Pit Waste: FLUIDS AND OTHER MATERIALS ASSOCIATED WITH PLUGGING

Will a synthetic liner be used in the pit? YES 20M

Proposed Disposal Method For Treated Pit Wastes:

- Land Application
- Underground Injection (UIC Permit Number _____)
- Reuse (at API Number _____)
- Off Site Disposal (Supply form WW-9 for disposal location)
- Other (Explain _____)

Proposed Work For Which Pit Will Be Used:

- Drilling
- Workover
- Other (Explain _____)
- Swabbing
- Plugging

I certify that I understand and agree to the terms and conditions of the GENERAL WATER POLLUTION PERMIT issued on August 1, 2005, by the Office of Oil and Gas of the West Virginia Department of Environmental Protection. I understand that the provisions of the permit are enforceable by law. Violations of any term or condition of the general permit and/or other applicable law or regulation can lead to enforcement action.

I certify under penalty of law that I have personally examined and am familiar with the information submitted on this application form and all attachments thereto and that, based on my inquiry of those individuals immediately responsible for obtaining the information, I believe that the information is true, accurate, and complete. I am aware that there are significant penalties for submitting false information, including the possibility of fine or imprisonment.

Company Official Signature *Eric P Linn*

Company Official (Typed Name) ERIC P LINN

Company Official Title VICE PRESIDENT

RECEIVED
Office of Oil and Gas
NDV 08/20/14
WV Department of
Environmental Protection

Subscribed and sworn before me this 9TH day of SEPTEMBER, 2014

Lynne M Coogle
Notary Public

My commission expires March 18, 2016

COMMONWEALTH OF PENNSYLVANIA
Notarial Seal
Lynne M. Coogle, Notary Public
City of Pittsburgh, Allegheny County
My Commission Expires March 18, 2016
MEMBER, PENNSYLVANIA ASSOCIATION OF NOTARIES

12/12/14

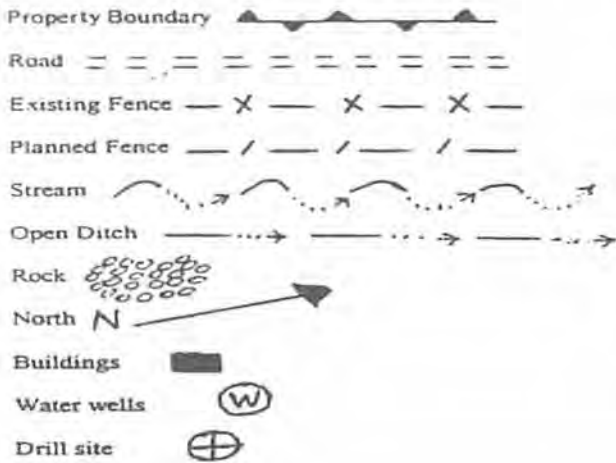

LEGEND

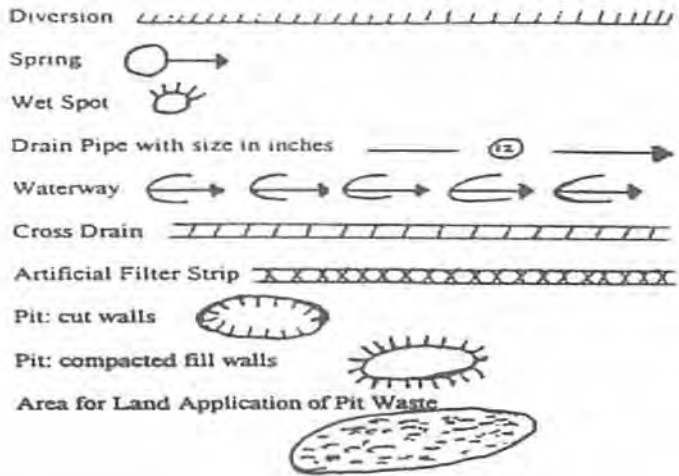

Proposed Revegetation Treatment: Acres Disturbed 3.2 Prevegetation pH 6.67
 Lime 2 Tons/acre or to correct to pH 6.5
 Fertilizer (10-20-20 or equivalent) 500 lbs/acre (500 lbs minimum)
 Mulch STRAW Tons/acre

Seed Mixtures

Seed Type	Area I lbs/acre	Seed Type	Area II lbs/acre
TALL FESCUE	40	"	
LADINO CLOVER	5	"	

Attach:
 Drawing(s) of road, location, pit and proposed area for land application.

Photocopied section of involved 7.5' topographic sheet.

Plan Approved by: *Henry Kaurish*
 Comments: _____

Title: *Inspector* Date: *10/31/14*

Field Reviewed? () Yes () No



WB 10 47-109-01047

WJK

12/12/14

WW-7
8-30-06



West Virginia Department of Environmental Protection
Office of Oil and Gas

WELL LOCATION FORM: GPS

API: 47-109-01047 WELL NO.: WB 10

FARM NAME: POCAHONATAS LAND CORP.

RESPONSIBLE PARTY NAME: HAYDEN HARPER ENERGY KA, LLC

COUNTY: WYOMING DISTRICT: CENTER 3

QUADRANGLE: PINEVILLE 7.5 549

SURFACE OWNER: PINNACLE LAND COMPANY

ROYALTY OWNER: PINNACLE LAND COMPANY

UTM GPS NORTHING: 4153466.6

UTM GPS EASTING: 447667.3 GPS ELEVATION: 1297'

The Responsible Party named above has chosen to submit GPS coordinates in lieu of preparing a new well location plat for a plugging permit or assigned API number on the above well. The Office of Oil and Gas will not accept GPS coordinates that do not meet the following requirements:

1. Datum: NAD 1983, Zone: 17 North, Coordinate Units: meters, Altitude: height above mean sea level (MSL) – meters.

2. Accuracy to Datum – 3.05 meters

3. Data Collection Method:
Survey grade GPS ____: Post Processed Differential X

Real-Time Differential ____

Mapping Grade GPS ____: Post Processed Differential ____

Real-Time Differential ____

4. Letter size copy of the topography map showing the well location.

I the undersigned, hereby certify this data is correct to the best of my knowledge and belief and shows all the information required by law and the regulations issued and prescribed by the Office of Oil and Gas.

[Signature]
Signature

OFFICE MANAGER
Title

AUGUST 22, 2014
Date