

Latitude 39° 25'

2.56 mi. S.  
3.69 mi. W.

Longitude 81° 25'

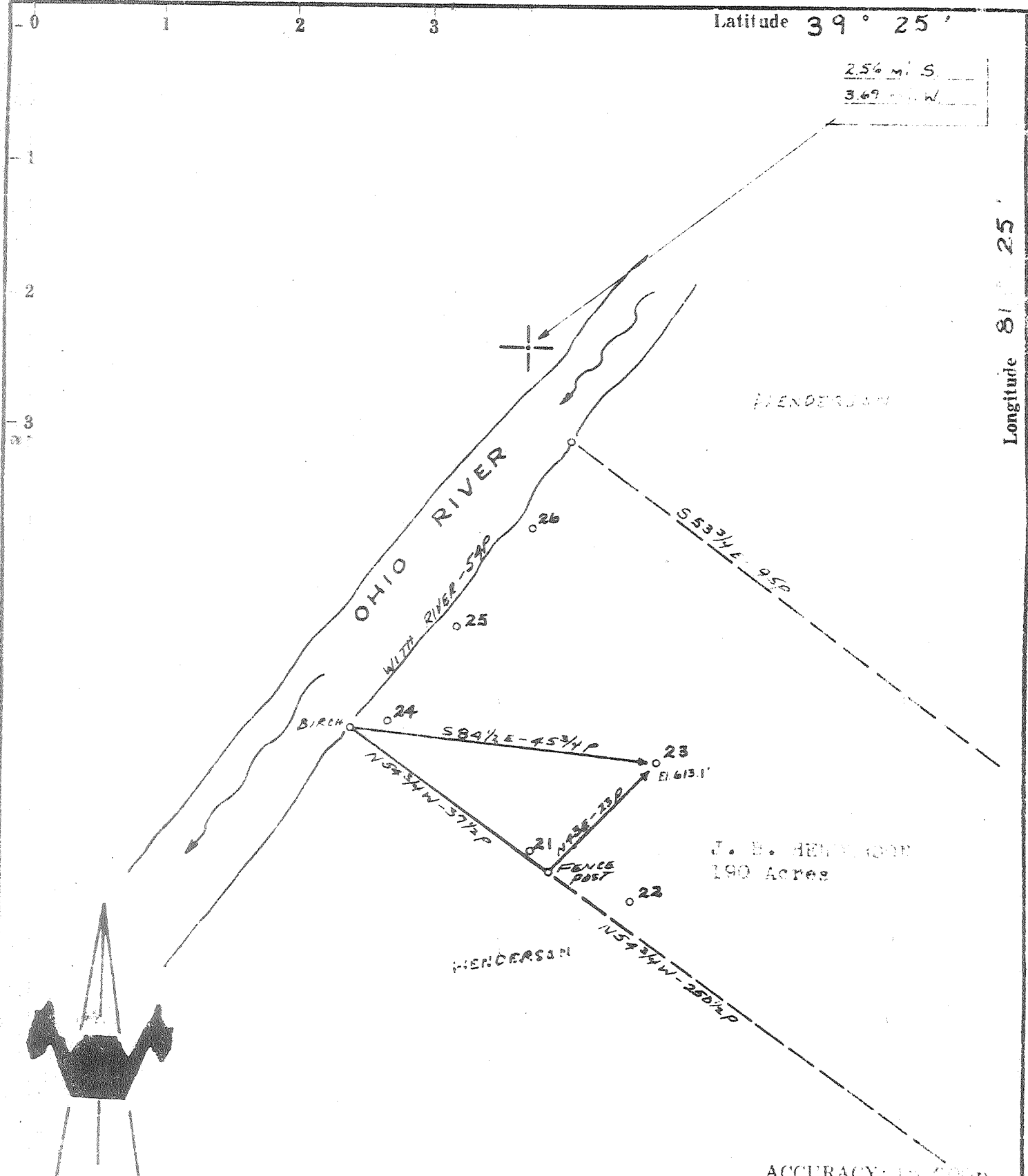

ACCURACY: 1:5000

- New Location
- Drill Deeper
- Abandonment
- Fracture
- Redrill

Source of Elevation Pohick - (615')

I, the undersigned, hereby certify that this map is correct to the best of my knowledge and belief and shows all the information required by paragraph 6 of the rules and regulations of the oil and gas section of the mining laws of West Virginia.

*Chet Waterman*

Company	A. T. WEINSTOCK
Address	WILLIAMSTOWN, W. VA.
Farm	J. B. HENDERSON
Tract	Acres 190 Lease No.
Well (Farm) No.	<u>23</u> Serial No.
Elevation (Spirit Level)	613.1'
Quadrangle	MARIETTA - WC
County	WOOD District WILLIAMS
Engineer	CHET WATERMAN
Engineer's Registration No.	3788
File No.	65003-60 Drawing No.
Date	11/2/65 Scale 1" = 20p

STATE OF WEST VIRGINIA  
DEPARTMENT OF MINES  
OIL AND GAS DIVISION  
CHARLESTON

**WELL LOCATION MAP**  
FILE NO. W00 - 180 - A

+ Denotes location of well on United States Topographic Maps, scale 1 to 62,500, latitude and longitude lines being represented by border lines as shown.

— Denotes one inch spaces on border line of original tracing.