

WW-9

CNG Transmission (47-107-01757)

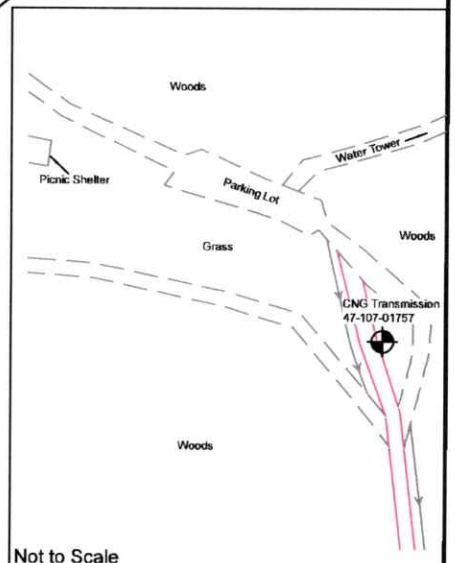
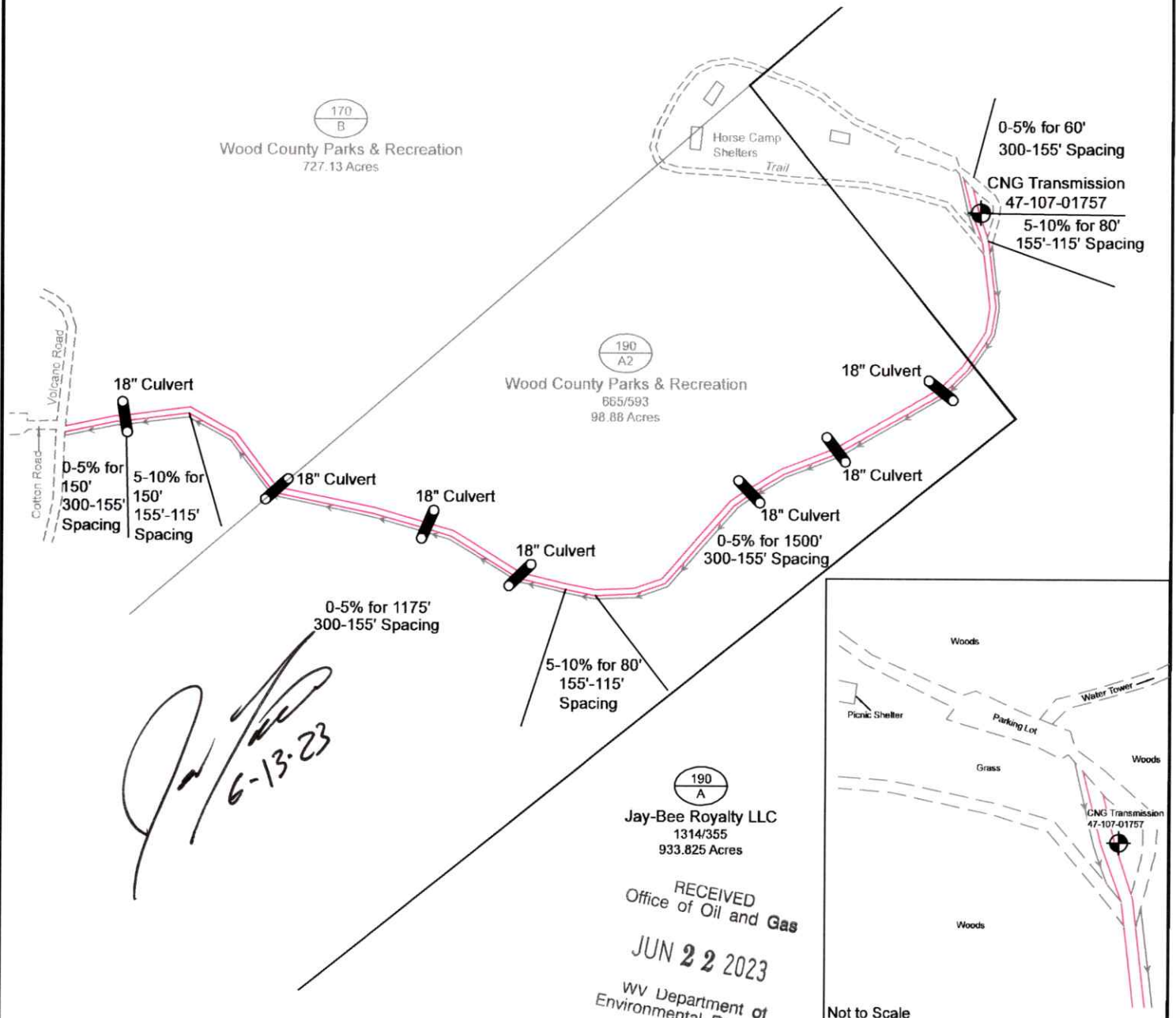

Not to Scale

Unless otherwise noted, all roads shown hereon are existing and shall be maintained in accordance with WV D.E.P., Office of Oil and Gas Erosion and Sediment Control Field Manual as revised 5/2012.

Entrances upon county/state roads shall be maintained in accordance with WV D.O.T. regulations, however, separate permits may be required by the WV D.O.T.

Sediment basins (traps) and appropriate erosion control barriers are to be constructed at all culverts and cross-drains as required in the aforementioned Erosion and Sediment Control Field Manual. Where field conditions dictate, alternative erosion control measures shall be enacted as required.

Earthwork contractors are responsible for notification to the operator and inspector prior to any deviation from this plan.

DRAWN BY: Tim Rutledge

DATE: June 02, 2023



SURVEYING AND MAPPING SERVICES PERFORMED BY:
ALLEGHENY SURVEYS, INC.
 1-800-482-8606

P.O. BOX 438
 BIRCH RIVER, WV 26610
 PH: (304) 649-8606
 FAX: (304) 649-8608

- PROPERTY BOUNDARY
- EXISTING ROAD
- ACCESS ROAD
- PROPOSED DITCH
- WOOD LINE
- EXISTING WELL LOCATION
- 5/8" REBAR FOUND NO CAP
- EXISTING CULVERT
- UTILITY POLE

07/07/2023