

Latitude 39° 20' 00"

5180' SOUTH  
6550' WEST

Longitude 81° 22' 30"

A TO 6 = S 14° E - 1200'  
B TO 6 = N 56° 15' E - 1650'

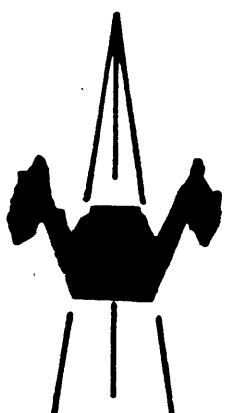
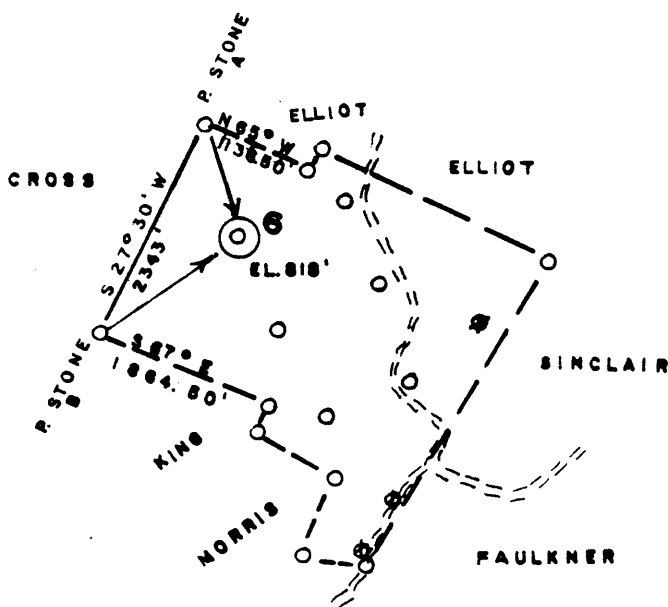

⊗ = OLD WELL  
○ = PROPOSED WELL

ACCURACY: 1/200

New Location   
 Drill Deeper   
 Abandonment   
 Fracture   
 Redrill   
 Other

Formation GORDON  
 Est. Depth 2800'

Oil   
 Gas   
 Other

Source of Elevation ROAD INTERSECTION  
 I, the undersigned, hereby certify that this map is correct to the best of my knowledge and belief and shows all the information required by paragraphs of the rules and regulations of the oil and gas section of the mining laws of West Virginia.

*Chet Waterman*  
 CHET WATERMAN  
 PROFESSIONAL ENGINEER

Company BEREA OIL & GAS CORP  
 Address CLARKSBURG, WV  
 Surface Owner P. J. CORBITT, JR.  
 Mineral Owner R. N. CORBITT HEIRS  
 Well No. 6 Acres 230.25'  
 Elevation 818'  
 Quadrangle VALLEY MILLS Series 7.5  
 County WOOD District UNION  
 Date 12/4/60 Scale 1" = 2000'

STATE OF WEST VIRGINIA  
 DEPARTMENT OF MINES  
 OIL AND GAS DIVISION  
 CHARLESTON  
**WELL LOCATION MAP**  
47 - 107 - 1129  
 STATE COUNTY PERMIT  
**CANCELLED** MAR 26 1984  
 + Denotes location of well on United States Topographic Maps.  
 Engineer CHET WATERMAN 80-727  
 Engineer's Registration No. 3788 File No.

ch 1/5

Plot Card CSD

Latitude 39° 20' 00"

5180' SOUTH  
6550' WEST

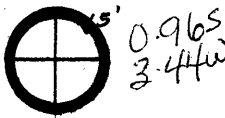

A TO 6 = S 14° E - 1200'  
B TO 6 = N 56° 15' E - 1650'

Longitude 81° 22' 30"  
81° 20'

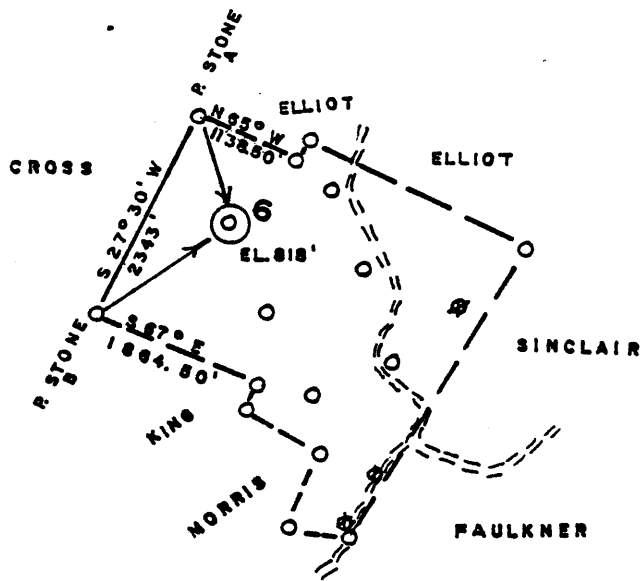

⊗ = OLD WELL  
○ = PROPOSED WELL

ACCURACY: 1/200

New Location   
Drill Deeper   
Abandonment   
Fracture   
Redrill   
Other

Formation GORDON Oil   
Est. Depth 2800' Gas   
Other

Source of Elevation ROAD INTERSECTION (771)  
I, the undersigned, hereby certify that this map is correct to the best of my knowledge and belief and shows all the information required by paragraph 6 of the rules and regulations of the oil and gas section of the mining laws of West Virginia.

*Chet Waterman*

Company BEREA OIL & GAS CORP  
Address CLARKSBURG, WV  
Surface Owner P. J. CORBITT, JR.  
Mineral Owner R. N. CORBITT HEIRS

Well No. 6 Acres 230.25'  
Elevation 818'  
Quadrangle VALLEY MILLS Series 7.5  
County WOOD District UNION  
Date 12/4/80 Scale 1" = 2000'

STATE OF WEST VIRGINIA  
DEPARTMENT OF MINES  
OIL AND GAS DIVISION  
CHARLESTON

WELL LOCATION MAP  
47 - 107 - 1129  
STATE COUNTY PERMIT

+ Denotes location of well on United States Topographic Maps.  
Engineer CHET WATERMAN 80-727  
Engineer's Registration No. 3788 File No.

JAN 26 1981



RECEIVED  
JAN - 2 1981

STATE OF WEST VIRGINIA  
DEPARTMENT OF MINES

Oil and Gas Division

OIL & GAS DIVISION  
DEPT. OF MINES

OIL AND GAS WELL PERMIT APPLICATION

TO THE DEPARTMENT OF MINES

Charleston, W. Va.

DATE December 24, 1980

Surface Owner P. J. Corbitt, Jr.

Company Berea Oil and Gas Corporation

Address Rt. 1, Waverly, WV 26184

Address 652 Empire Bank Bldg., Clarksburg, WV

Mineral Owner R. N. Corbitt Heirs

Farm Corbitt Acres 230.25

Address Rt. 1, Waverly, WV 26184

Location (waters) Bull Run

Coal Owner N/A

Well No. 6 Elevation 818'

Address \_\_\_\_\_

District Union County Wood

Coal Operator N/A

Quadrangle Valley Mills

Address \_\_\_\_\_

THIS PERMIT MUST BE POSTED AT THE WELL SITE

All provisions being in accordance with Chapter 22, of the W. Va. Code, the location is hereby approved for drilling. This permit shall expire if operations have not commenced by 9-6-81.

INSPECTOR

TO BE NOTIFIED Paul Goodnight

ADDRESS Smithville, WV 26178

PHONE 304/477-3660

J. J. Muzey  
Deputy Director Oil & Gas Division

GENTLEMEN:

The undersigned well operator is entitled to drill upon the above named farm or tract of land for oil and gas, having fee title thereto (or as the case may be) under grant or lease dated November 15 1980 by H. D. Wells Oil & Gas Exploration & Dev. made to Berea Oil & Gas Corp. and recorded on the 17th day of November 1980 in Wood County, Book 747 Page 206

XX NEW WELL \_\_\_\_\_ DRILL DEEPER \_\_\_\_\_ REDRILL \_\_\_\_\_ FRACTURE OR STIMULATE  
\_\_\_\_\_ OIL AND GAS WELL ORIGINALLY DRILLED BEFORE JUNE 5, 1969.

The enclosed plat was prepared by a registered engineer or licensed land surveyor and all coal owners and/or operators have been notified as of the above date.

The above named coal owners and/or operator are hereby notified that any objection they wish to make, or are required to make by Section 3 of the Code, must be received by, or filed with the Department of Mines within ten (10) days.

Copies of this notice and the enclosed plat were mailed by registered mail, or delivered to the above named coal operators or coal owners at their above shown respective address \_\_\_\_\_ day \_\_\_\_\_ before, or on the same day with the mailing or delivery of this copy to the Department of Mines at Charleston, West Virginia.

Very truly yours,

(Sign Name) M. V. Schwaner

Well Operator

BEREA OIL AND GAS CORPORATION  
652 Empire Bank Building

Street

Fourth & Main Streets

Clarksburg

City or Town

West Virginia 26301

State

PLEASE SUBMIT COPIES OF ALL  
GEOPHYSICAL LOGS DIRECTLY TO:

WEST VIRGINIA GEOLOGICAL AND  
ECONOMIC SURVEY  
P. O. BOX 879  
MORGANTOWN, WEST VIRGINIA 26505  
AC-304 - 292-6331

Address  
of  
Well Operator

\*SECTION 3. If no objections are filed or found by the Department of mines, within said period of ten days from the receipt of notice and plat by the department of mines, to said proposed location, the department shall forthwith issue to the well operator a permit reciting the filing of such plat, that no objections have been made by the coal operators or found thereto by the department and that the same is approved and the well operator authorized to proceed.

47-107-1129

PERMIT NUMBER

"I have read and understand the reclamation requirements as set forth in Chapter 22, Article 4, Section 12-b and will carry out the specified requirements."

Signed by

M. V. Schwaner

REVENUE BOND

**THIS IS AN ESTIMATE ONLY**  
**ACTUAL INFORMATION WILL BE SUBMITTED ON OG-10 UPON COMPLETION**

PROPOSED WORK ORDER TO XX DRILL \_\_\_\_\_ DEEPEN \_\_\_\_\_ FRACTURE STIMULATE \_\_\_\_\_  
 DRILLING CONTRACTOR: (If Known) \_\_\_\_\_ RESPONSIBLE AGENT: \_\_\_\_\_  
 NAME N/A \_\_\_\_\_ NAME Mark Schumacher \_\_\_\_\_  
 ADDRESS \_\_\_\_\_ ADDRESS 652 Empire Bank Bldg., Clarksburg, WV \_\_\_\_\_  
 TELEPHONE \_\_\_\_\_ TELEPHONE 304/624-6429 \_\_\_\_\_  
 ESTIMATED DEPTH OF COMPLETED WELL: 2800' \_\_\_\_\_ ROTARY XX \_\_\_\_\_ CABLE TOOLS \_\_\_\_\_  
 PROPOSED GEOLOGICAL FORMATION: Gordon \_\_\_\_\_  
 TYPE OF WELL OIL X GAS X COMB. X STORAGE \_\_\_\_\_ DISPOSAL \_\_\_\_\_  
 RECYCLING \_\_\_\_\_ WATER FLOOD \_\_\_\_\_ OTHER \_\_\_\_\_

**TENTATIVE CASING PROGRAM:**

CASING AND TUBING SIZE	USED FOR DRILLING	LEFT IN WELL	CEMENT LIFT UP OR SACKS - CUBIC FT.
20 - 16			
13 - 10			
9 - 5 7/8			
8 - 5 3/8 <u>XX</u>	<u>250'</u>	<u>250'</u>	<u>Surface</u>
7			
5 1/2			
4 1/2 <u>XX</u>	<u>T.D.</u>	<u>T.D.</u>	<u>800' or to reports of rule 15.01</u>
4			Perf. Top _____
2			Perf. Bottom _____
Line			Perf. Top _____
			Perf. Bottom _____

APPROXIMATE FRESH WATER DEPTHS 150 FEET SALT WATER 1500 FEET  
 APPROXIMATE COAL DEPTHS None  
 IS COAL BEING MINED IN THE AREA? No BY WHOM? \_\_\_\_\_

**TO DRILL:**

SUBMIT FIVE (5) COPIES OF OG - 1, \$100.00 PERMIT FEE, PERFORMANCE BOND AND PERMANENT COPY OF PLAT.

**TO DRILL DEEPER OR REDRILL:**

SUBMIT FIVE (5) COPIES OF OG - 1, SHOWING ORIGINAL PERMIT NUMBER AND PERFORMANCE BOND. ON WELLS DRILLED PRIOR TO 1929, A PERMANENT COPY OF THE PLAT AND THE ORIGINAL WELL RECORD MUST ALSO BE SUBMITTED.

**TO FRACTURE - STIMULATE:**

OIL AND/OR GAS WELL ORIGINALLY DRILLED BEFORE JUNE 5, 1929, FIVE (5) COPIES OG - 1, PERFORMANCE BOND, PERMANENT PLAT AND ORIGINAL WELL RECORD.

OIL AND/OR GAS WELL ORIGINALLY DRILLED ON AND/OR AFTER JUNE 5, 1929, FIVE COPIES OG - 1, SHOWING ORIGINAL PERMIT NUMBER AND PERFORMANCE BOND.

Required forms must be filed within ninety (90) days of completion for bond release. Inspector to be notified ~~two~~ four (24) hours in advance.

The following waiver must be completed by the coal operator if the permit is to be issued within ten days of receipt thereof.

WAIVER: I the undersigned, Agent for \_\_\_\_\_ Coal Company, Owner or Operator of the coal under this lease have examined and place on our mine maps this proposed well location.

We the \_\_\_\_\_ Coal Company have no objections to said well being drilled at this location, provided operator has complied with all rules and regulations in Articles 4, 5, and 7, Chapter 22 of the West Virginia Code.

\_\_\_\_\_  
 For Coal Company

\_\_\_\_\_  
 Official Title