

8/29/78

ACCURACY: 1 P / 200 P (664')

- New Location
- Drill Deeper
- Abandonment
- Fracture
- Redrill

I, the undersigned, hereby certify that this map is correct to the best of my knowledge and belief and shows all the information required by paragraph 6 of the rules and regulations of the oil and gas section of the mining laws of West Virginia.

*Chet Waterman*

Company	L. & M. OIL COMPANY
Address	CANTON, OHIO
Farm	M. M. WILSON
Tract	Acres 60 Lease No.
Well (Farm) No.	1 Serial No.
Elevation (Spirit Level)	670'
Quadrangle	MARIETTA
County	WOOD District CLAY
Engineer	CHET WATERMAN
Engineer's Registration No.	3788
File No.	78003 - 552 Drawing No.
Date	11 / 1 / 78 Scale 1" = 20 P

STATE OF WEST VIRGINIA  
 DEPARTMENT OF MINES  
 OIL AND GAS DIVISION  
 CHARLESTON

*Cancelled*

**WELL LOCATION MAP**  
 FILE NO. **107-1048**  
**FORMERLY 107-0870**

+ Denotes location of well on United States Topographic Maps, scale 1 to 62,500, latitude and longitude lines being represented by border lines as shown.

- Denotes one inch spaces on border line of original tracing.

**47-107** MAR 2 1984

2700 Gordon Sand

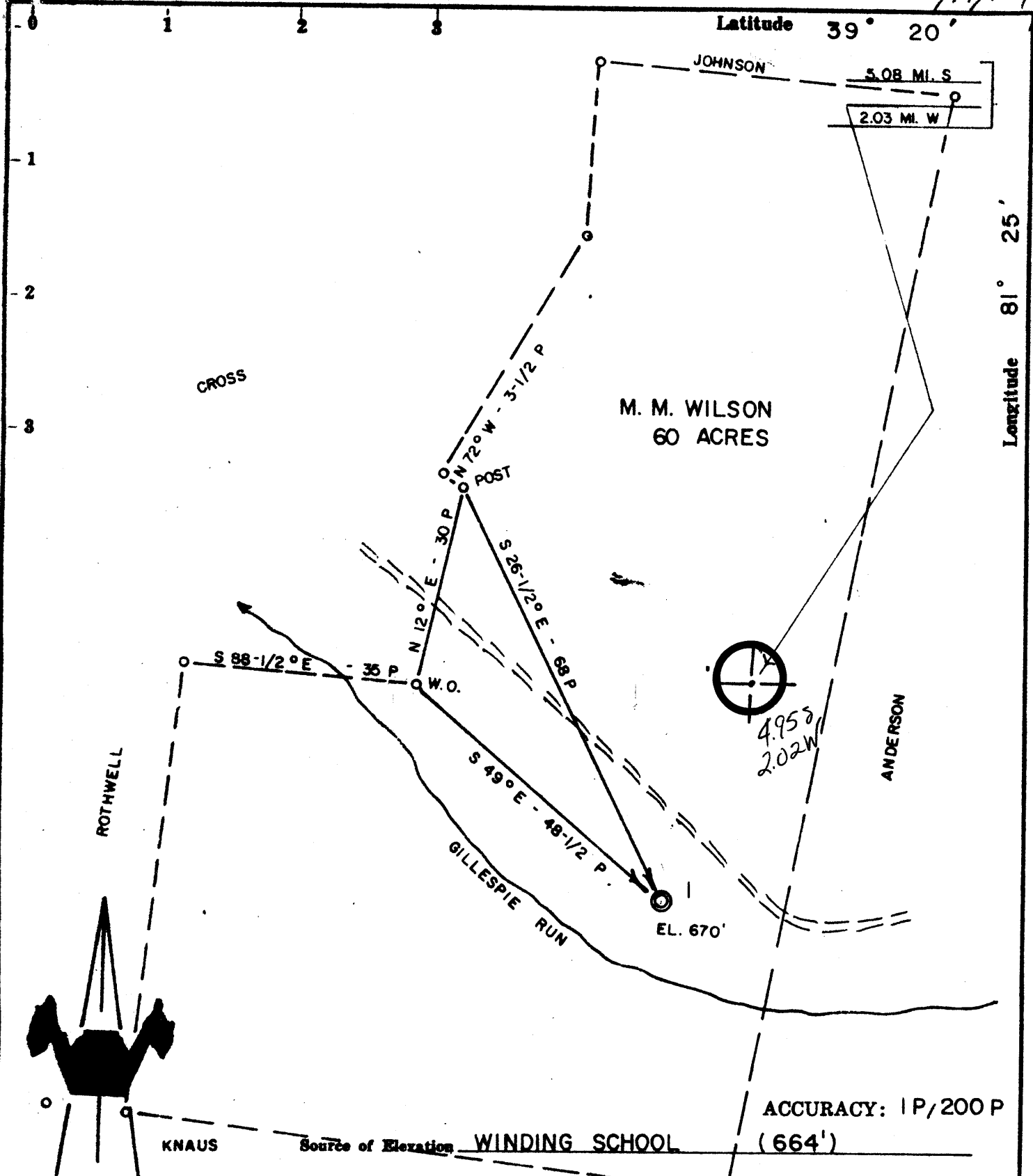

- New Location
- Drill Deeper
- Abandonment
- Fracture
- Redrill

I, the undersigned, hereby certify that this map is correct to the best of my knowledge and belief and shows all the information required by paragraph 6 of the rules and regulations of the oil and gas section of the mining laws of West Virginia.

*Chet Waterman*

Company	L. & M. OIL COMPANY
Address	CANTON, OHIO
Farm	M. M. WILSON
Tract	Acres 60 Lease No.
Well (Farm) No.	1 Serial No.
Elevation (Spirit Level)	670'
Quadrangle	MARIETTA SW
County	WOOD District CLAY
Engineer	CHET WATERMAN
Engineer's Registration No.	3788
File No.	78003 - 552 Drawing No.
Date	11 / 1 / 78 Scale 1" = 20 P

STATE OF WEST VIRGINIA  
 DEPARTMENT OF MINES  
 OIL AND GAS DIVISION  
 CHARLESTON

**WELL LOCATION MAP**

FILE NO. ~~107-1046~~

**FORMERLY 107-0870**

+ Denotes location of well on United States Topographic Maps, scale 1 to 62,500, latitude and longitude lines being represented by border lines as shown.

- Denotes one inch spaces on border line of original tracing.

**47-107**

11/17/78

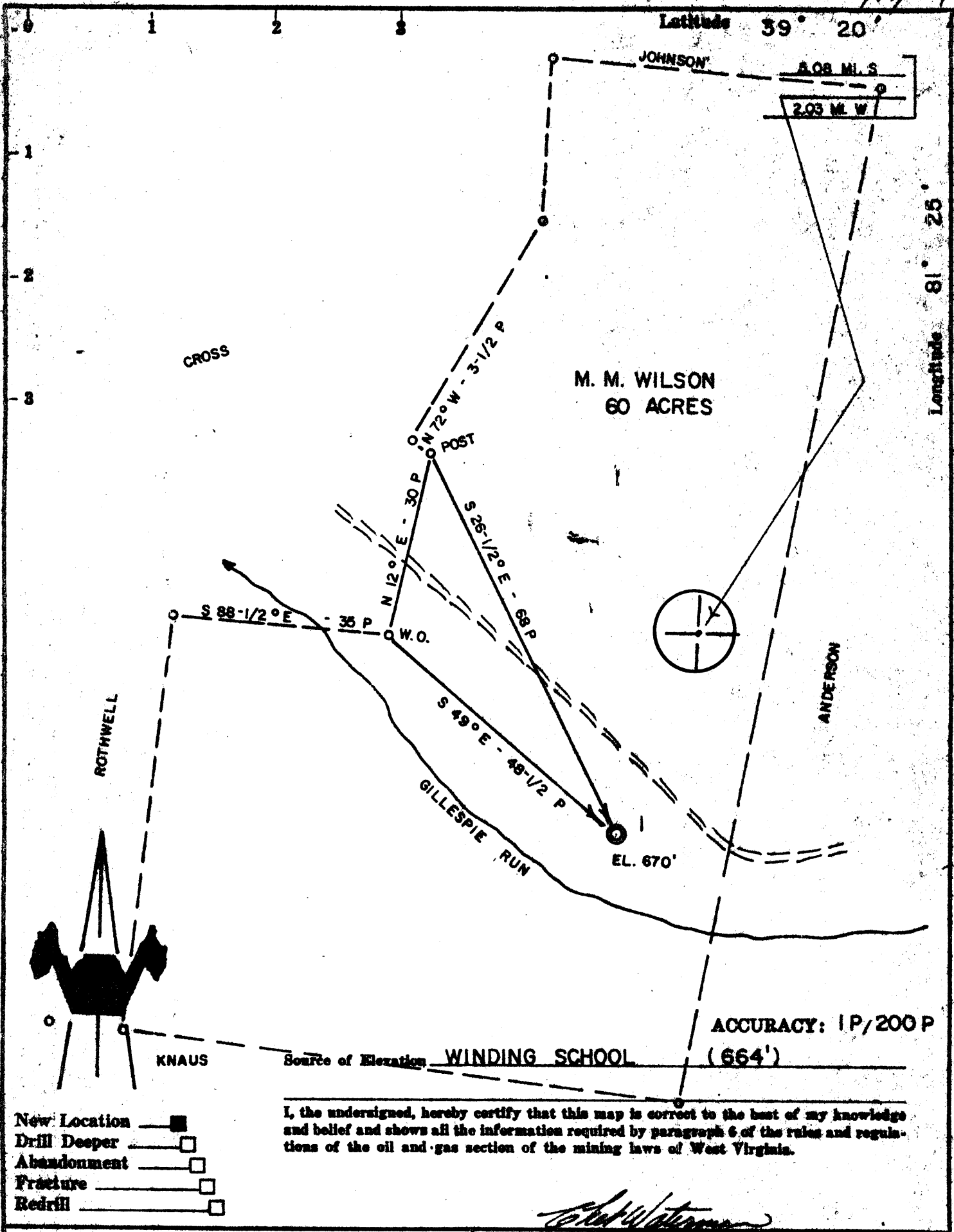

- New Location
- Drill Deeper
- Abandonment
- Fracture
- Redrill

I, the undersigned, hereby certify that this map is correct to the best of my knowledge and belief and shows all the information required by paragraph 6 of the rules and regulations of the oil and gas section of the mining laws of West Virginia.

*Chet Waterman*

Company	L. & M. OIL COMPANY
Address	CANTON, OHIO
Farm	M. M. WILSON
Tract	Acres 60 Lease No.
Well (Farm) No.	1 Serial No.
Elevation (Spirit Level)	670'
Quadrangle	MARIETTA SW
County	WOOD District CLAY
Engineer	CHET WATERMAN
Engineer's Registration No.	3788
File No.	78003 - 552 Drawing No.
Date	11 / 1 / 78 Scale 1" = 20 P

STATE OF WEST VIRGINIA  
DEPARTMENT OF MINES  
OIL AND GAS DIVISION  
CHARLESTON

**WELL LOCATION MAP**

FILE NO. **WOO-870**

Nov 1048

+ Denotes location of well on United States Topographic Maps, scale 1 to 62,500, latitude and longitude lines being represented by border lines as shown.

- Denotes one inch spaces on border line of original tracing.

**47-107** DEC 4 1978



STATE OF WEST VIRGINIA  
DEPARTMENT OF MINES

RECEIVED  
NOV 17 1978

Oil and Gas Division  
OIL & GAS DIVISION  
DEPT. OF MINES

OIL AND GAS WELL PERMIT APPLICATION

TO THE DEPARTMENT OF MINES,  
Charleston, W. Va.

DATE November 10, 1978

Surface Owner M.M. & E.J. Wilson  
Address RD#2, Parkersburg, WV 26101  
Mineral Owner M.M. & E.J. Wilson  
Address Same  
Coal Owner Same  
Address \_\_\_\_\_  
Coal Operator None  
Address \_\_\_\_\_

Company L & M Oil Company  
Address Box A, Station C, Canton, OH 44708  
Farm M.M. Wilson Acres 60  
Location (waters) Gillespie Run  
Well No. 1 Elevation 670'  
District Clay County Wood  
Quadrangle Valley Mills-Marietta

THIS PERMIT MUST BE POSTED AT THE WELL SITE

All provisions being in accordance with Chapter 22,  
of the W. Va. Code, the location is hereby approved  
for drilling. This permit shall expire if  
operations have not commenced by 3-17-79

INSPECTOR  
TO BE NOTIFIED Paul Goodnight

ADDRESS Smithville, W. Va.

PHONE 477-3660

Robert F. Bell  
Deputy Director - Oil & Gas Division

GENTLEMEN:

The undersigned well operator is entitled to drill upon the above named farm or tract of land for oil and gas, having fee title thereto, (or as the case may be) under grant or lease dated August 5 1975 by M.M. Wilson made to Mohawk Oil Corp. and recorded on the 5th day of August 1975, in Wood County, Book 657 Page 149

NEW WELL  DRILL DEEPER  REDRILL  FRACTURE OR STIMULATE  
OIL AND GAS WELL ORIGINALLY DRILLED BEFORE JUNE 5, 1969.

The enclosed plat was prepared by a registered engineer or licensed land surveyor and all coal owners and/or operators have been notified as of the above date.

The above named coal owners and/or operator are hereby notified that any objection they wish to make, or are required to make by Section 3 of the Code, must be received by, or filed with the Department of Mines within ten (10) days.

Copies of this notice and the enclosed plat were mailed by registered mail, or delivered to the above named coal operators or coal owners at their above shown respective address \_\_\_\_\_ day \_\_\_\_\_ before, or on the same day with the mailing or delivery of this copy to the Department of Mines at Charleston, West Virginia.

PLEASE SUBMIT COPIES OF ALL  
GEOPHYSICAL LOGS DIRECTLY TO:

WEST VIRGINIA GEOLOGICAL AND  
ECONOMIC SURVEY  
P. O. BOX 879  
MORGANTOWN, WEST VIRGINIA 26505  
AC-304 - 292-6331

Address  
of  
Well Operator

Very truly yours, L & M OIL COMPANY  
(Sign Name) [Signature]  
Well Operator  
Douglas M. Galloway, Assit. Sec.  
Street  
Box A, Station C  
City or Town  
Canton, Ohio 44708  
State

\*SECTION 3 . . . . If no objections are filed or found by the Department of mines, within said period of ten days from the receipt of notice and plat by the department of mines, to said proposed location, the department shall forthwith issue to the well operator a permit reciting the filing of such plat, that no objections have been made by the coal operators or found thereto by the department and that the same is approved and the well operator authorized to proceed.

BLANKET BOND

WOO-870 PERMIT NUMBER

47-107

**THIS IS AN ESTIMATE ONLY**  
**ACTUAL INFORMATION WILL BE SUBMITTED ON OG-10 UPON COMPLETION**

PROPOSED WORK ORDER TO XX DRILL \_\_\_\_\_ DEEPEN \_\_\_\_\_ FRACTURE-STIMULATE \_\_\_\_\_  
 DRILLING CONTRACTOR: (If Known) \_\_\_\_\_ RESPONSIBLE AGENT: \_\_\_\_\_  
 NAME \_\_\_\_\_ NAME Okey L. Stalnaker  
 ADDRESS \_\_\_\_\_ ADDRESS Lette Gap, West Virginia  
 TELEPHONE \_\_\_\_\_ TELEPHONE 462-7836  
 ESTIMATED DEPTH OF COMPLETED WELL: 2700 ROTARY X CABLE TOOLS \_\_\_\_\_  
 PROPOSED GEOLOGICAL FORMATION: Gordon Sand  
 TYPE OF WELL: OIL \_\_\_\_\_ GAS \_\_\_\_\_ COMB. XX STORAGE \_\_\_\_\_ DISPOSAL \_\_\_\_\_  
 RECYCLING \_\_\_\_\_ WATER FLOOD \_\_\_\_\_ OTHER \_\_\_\_\_

**TENTATIVE CASING PROGRAM:**

CASING AND TUBING SIZE	USED FOR DRILLING	LEFT IN WELL	CEMENT FILL UP OR SACKS - CUBIC FT.
20 - 16			
13 - 10			
9 - 5/8			
8 - 5/8 X	250	250	Surface
7			
5 1/2			
4 1/2 X	TD	TD	400
3			
2			Perf. Top
Liners			Perf. Bottom
			Perf. Top
			Perf. Bottom

APPROXIMATE FRESH WATER DEPTHS 150 FEET 1500 SALT WATER \_\_\_\_\_ FEET  
 APPROXIMATE COAL DEPTHS None  
 IS COAL BEING MINED IN THE AREA? No BY WHOM? \_\_\_\_\_

**TO DRILL:**

SUBMIT FIVE (5) COPIES OF OG - 1, \$100.00 PERMIT FEE, PERFORMANCE BOND AND PERMANENT COPY OF PLAT.

**TO DRILL DEEPER OR REDRILL:**

SUBMIT FIVE (5) COPIES OF OG - 1, SHOWING ORIGINAL PERMIT NUMBER AND PERFORMANCE BOND. ON WELLS DRILLED PRIOR TO 1929, A PERMANENT COPY OF THE PLAT AND THE ORIGINAL WELL RECORD MUST ALSO BE SUBMITTED.

**TO FRACTURE - STIMULATE:**

OIL AND/OR GAS WELL ORIGINALLY DRILLED BEFORE JUNE 5, 1929, FIVE (5) COPIES OG - 1, PERFORMANCE BOND, PERMANENT PLAT AND ORIGINAL WELL RECORD.  
 OIL AND/OR GAS WELL ORIGINALLY DRILLED ON AND/OR AFTER JUNE 5, 1929, FIVE COPIES OG - 1, SHOWING ORIGINAL PERMIT NUMBER, AND PERFORMANCE BOND.

Required forms must be filed within ninety (90) days of completion for bond release. Inspector to be notified twenty-four (24) hours in advance.

The following waiver must be completed by the coal operator if the permit is to be issued within ten days of receipt thereof.

WAIVER: I the undersigned, Agent for \_\_\_\_\_ Coal Company, Owner or Operator of the coal under this lease have examined and place on our mine maps this proposed well location.  
 We the \_\_\_\_\_ Coal Company have no objections to said well being drilled at this location, providing operator has complied with all rules and regulations in Articles 4, 5, and 7, Chapter 22 of the West Virginia Code.

\_\_\_\_\_  
 For Coal Company  
 \_\_\_\_\_  
 Official Title



\*\*\*Payment for this new permit was submitted to you on 6/19/80 via our ck. #1683 in the amount of \$100.00

STATE OF WEST VIRGINIA

DEPARTMENT OF MINES

RECEIVED  
Jan Britton

JUL 23 1980

Oil and Gas Division

OIL AND GAS WELL PERMIT APPLICATION OF MINES

TO THE DEPARTMENT OF MINES,  
Charleston, W. Va.

DATE July 14, 1980

Surface Owner M.M. & E.J. Wilson  
Address R.D.#2, Parkersburg, WV  
Mineral Owner Same  
Address \_\_\_\_\_  
Coal Owner Same  
Address \_\_\_\_\_  
Coal Operator None  
Address \_\_\_\_\_

Company L & M Petroleum Co.  
Address Rt. #1, Box 18-B, Marietta, OH  
Farm M.M. Wilson Acres 60  
Location (waters) Gillespie Run  
Well No. 1 Elevation 670'  
District Clay County Wood  
Quadrangle Valley Mills/Marietta

THIS PERMIT MUST BE POSTED AT THE WELL SITE

All provisions being in accordance with Chapter 22, of the W. Va. Code, the location is hereby approved for drilling \_\_\_\_\_. This permit shall expire if operations have not commenced by 3-24-81.

INSPECTOR TO BE NOTIFIED Paul Goodnight  
ADDRESS Smithville, W.Va. 26178  
PHONE 477-3660

J. C. Burdett  
Deputy Director - Oil & Gas Division

GENTLEMEN:

The undersigned well operator is entitled to drill upon the above named farm or tract of land for oil and gas, having fee title thereto, (or as the case may be) under grant or lease dated August 5 1975 by M.M. Wilson made to Mohawk Oil Corp. and recorded on the 5th day of August 1975 in Wood County, Book 657 Page 149

NEW WELL  DRILL DEEPER  REDRILL  FRACTURE OR STIMULATE  
 OIL AND GAS WELL ORIGINALLY DRILLED BEFORE JUNE 5, 1969.

The enclosed plat was prepared by a registered engineer or licensed land surveyor and all coal owners and/or operators have been notified as of the above date.

The above named coal owners and/or operator are hereby notified that any objection they wish to make, or are required to make by Section 3 of the Code, must be received by, or filed with the Department of Mines within ten (10) days.

Copies of this notice and the enclosed plat were mailed by registered mail, or delivered to the above named coal operators or coal owners at their above shown respective address \_\_\_\_\_ day \_\_\_\_\_ before, or on the same day with the mailing or delivery of this copy to the Department of Mines at Charleston, West Virginia.

PLEASE SUBMIT COPIES OF ALL GEOPHYSICAL LOGS DIRECTLY TO:

WEST VIRGINIA GEOLOGICAL AND ECONOMIC SURVEY  
P. O. BOX 879  
MORGANTOWN, WEST VIRGINIA 26505  
AC-304 - 292-6331

Address of Well Operator

Very truly yours, L & M Petroleum, Co.  
(Sign Name) Dick C. Hunter Well Operator  
Rt. #1, Box 18-B Street  
Marietta City or Town  
Ohio 45750 State

\*SECTION 3 . . . . If no objections are filed or found by the Department of mines, within said period of ten days from the receipt of notice and plat by the department of mines, to said proposed location, the department shall forthwith issue to the well operator a permit reciting the filing of such plat, that no objections have been made by the coal operators or found thereto by the department and that the same is approved and the well operator authorized to proceed.

BLANKET BOARD

(expired permit #47-107-870)

47-107-1048 PERMIT NUMBER

I have read and understand the reclamation requirements as set forth in Chapter 22, Article 4, Section 12-b and will carry out the specified requirements.

and by Dick C. Hunter

