

10700755P

WW-7  
5-02

West Virginia Department of Environmental Protection  
Office of Oil & Gas  
**WELL LOCATION FORM: GPS**

API: 47- 107 - 0755 WELL NO: 4  
FARM NAME: Sabie Innovative Plastics  
RESPONSIBLE PARTY NAME: Sabie Innovative Plastics  
COUNTY: Wood DISTRICT: Lubeck 3  
QUADRANGLE: Lubeck 7.5' 449  
SURFACE OWNER: Sabie Innovative Plastics  
ROYALTY OWNER: Sabie Innovative Plastics  
UTM GPS NORTHING: 4,344,674 (NAD 83)  
UTM GPS EASTING: 442,341 (NAD 83) GPS ELEVATION: 218 m. (715 ft)

The Responsible Party named above has chosen to submit GPS coordinates in lieu of preparing a new well location plat for a plugging permit on the above well. The Office of Oil & Gas will not accept GPS coordinates that do not meet the following requirements:

- 1. Datum: NAD 1983, Zone: 17 North, Coordinate Units: meters, Altitude: height above mean sea level (MSL) - meters.
- 2. Accuracy to Datum - 3.05 meters
- 3. Data Collection Method:

Survey Grade GPS  Post Processed Differential   
 Real-Time Differential   
Mapping Grade GPS  Post Processed Differential   
 Real-Time Differential

I the undersigned, hereby certify this data is correct to the best of my knowledge and belief and shows all the information required by law and the regulations issued and prescribed by the Office of Oil and Gas.

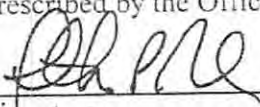
 Timothy P. Roush Professional Surveyor  
Signature Title

10/14/2014  
Date

Received  
Office of Oil & Gas  
JAN 20 2015



10700755P

SUBJECT WELL  
Sabic Innovative Plastics No.4  
47-107-0755

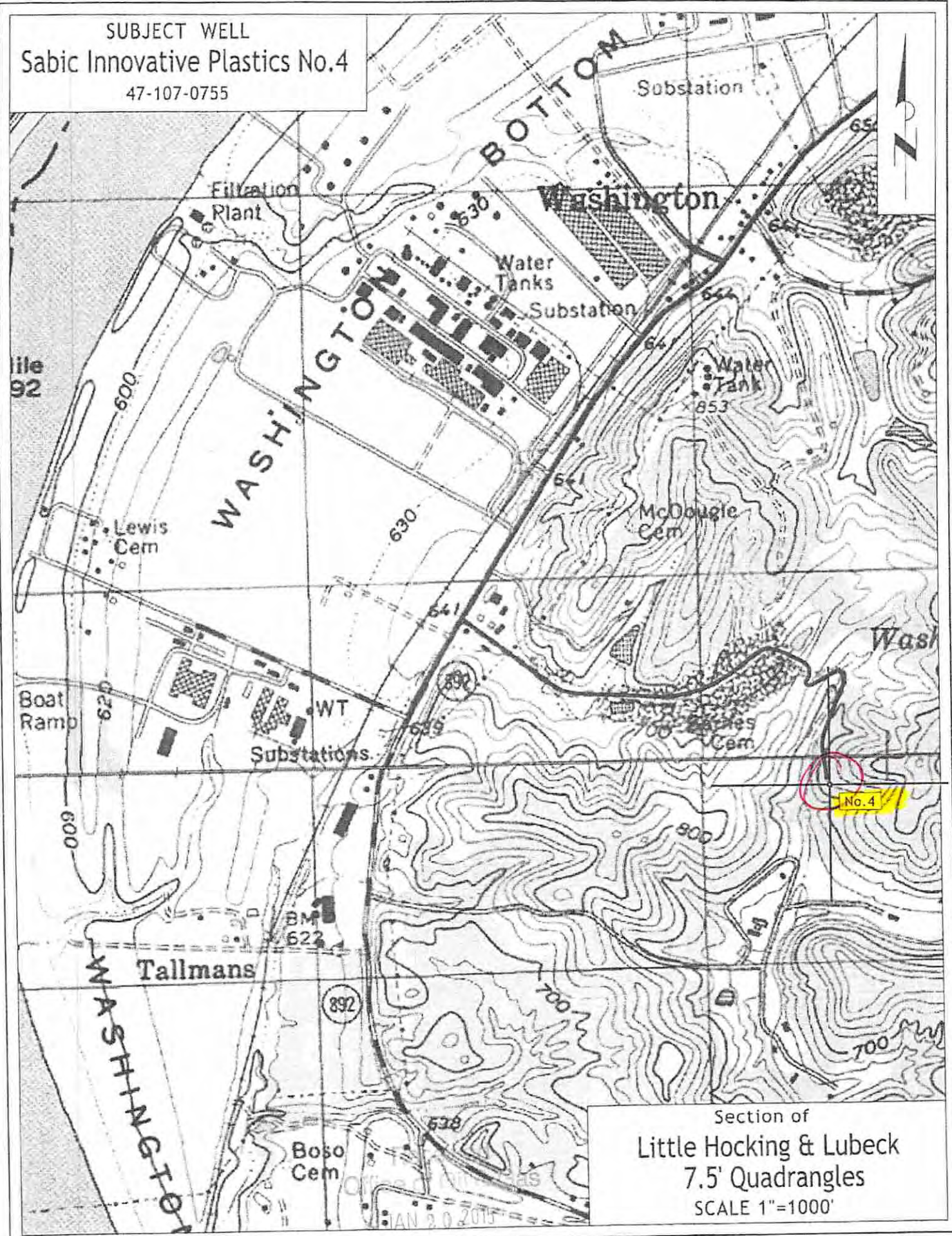

Section of  
Little Hocking & Lubeck  
7.5' Quadrangles  
SCALE 1"=1000'