

K.P. 5/8/1968 6/15/1971

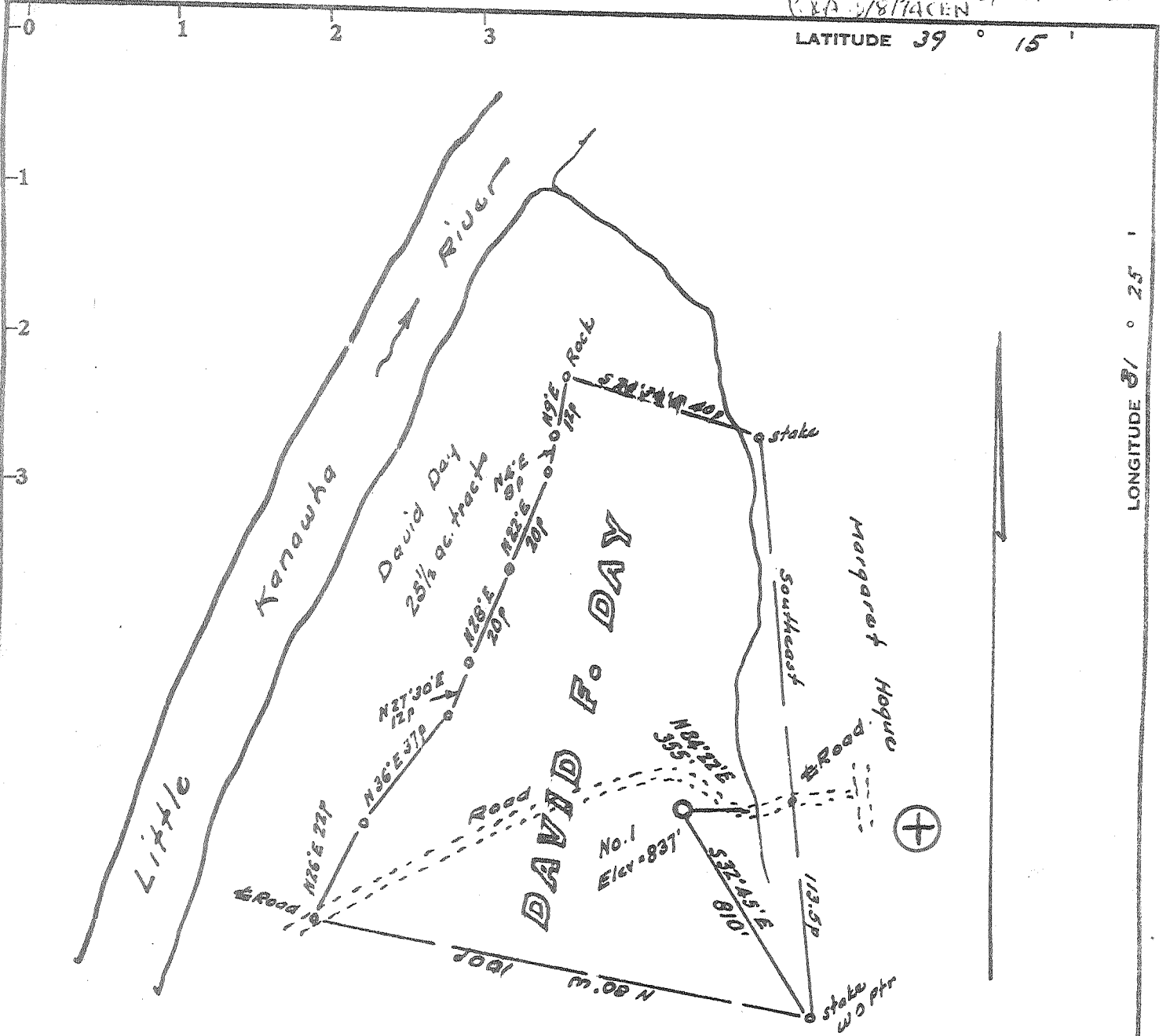

Minimum Error of Closure 1 in 200'

Source of Elevation Elev. 1/2 mile north at Tunnel Run = 848

- Fracture.....
- New Location.....
- Drill Deeper.....
- Abandonment.....

I, the undersigned, hereby certify that this map is correct to the best of my knowledge and belief and shows all the information required by paragraph 6 of the rules and regulations of the oil and gas section of the mining laws of West Virginia.

Map No. \_\_\_\_\_

Signed: [Signature]  
Squares: N S E W

Company Natural Energies, Inc.  
 Address 720 Union Trust Bldg., Parkersburg, W.V.  
 Farm David F. Day  
 Tract \_\_\_\_\_ Acres 49.5 Lease No. \_\_\_\_\_  
 Well (Farm) No. One Serial No. \_\_\_\_\_  
 Elevation (Spirit Level) 837  
 Quadrangle Elizabeth NW  
 County Wood District Clay  
 Engineer [Signature]  
 Engineer's Registration No. 1227  
 File No. \_\_\_\_\_ Drawing No. \_\_\_\_\_  
 Date June 26, 1971 Scale 1" = 300' = 695

STATE OF WEST VIRGINIA  
DEPARTMENT OF MINES  
OIL AND GAS DIVISION  
CHARLESTON

WELL LOCATION MAP

FILE NO. WOOD-597-P

+ Denotes location of well on United States Topographic Maps, scale 1 to 62,500, latitude and longitude lines being represented by border lines as shown.

- Denotes one inch spaces on border line of original tracing.

Deep Well





RECEIVED

MAY 11 1974

STATE OF WEST VIRGINIA  
DEPARTMENT OF MINES

OIL & GAS DIVISION  
DEPT. OF MINES

Oil and Gas Division

WELL RECORD

Quadrangle Clay  
Wood -597  
Permit No. 597

Rotary X Oil \_\_\_\_\_  
Cable \_\_\_\_\_ Gas \_\_\_\_\_  
Recycling \_\_\_\_\_ Comb. \_\_\_\_\_  
Water Flood \_\_\_\_\_ Storage \_\_\_\_\_  
Disposal \_\_\_\_\_ Dry (Kind)

Company <u>Natural Energies Inc.</u>	Casing and Tubing	Used in Drilling	Left in Well	Cement fill up Cu. ft. (Sks.)
Address <u>717 Union Trust, Parkersburg, WV</u>	Size			
Farm <u>D. F. Day</u> Acres _____	20-16			
Location (waters) _____	Cond.			
Well No. <u>One</u> Elev. <u>844</u>	13-10"			
District <u>Clay</u> County <u>Wood</u>	9 5/8			
The surface of tract is owned in fee by _____	8 5/8	1939	1939	Circulated cement
Address <u>R.R. 1, Parkersburg, W. Va.</u>	7			
Mineral rights are owned by <u>Same</u>	5 1/2			
Address _____	4 1/2	6102	6102	Cemented 200 sacks Hi-early
Drilling Commenced <u>7-1-71</u>	3			
Drilling Completed <u>7-14-71</u>	2			
Initial open flow <u>Show</u> cu. ft. <u>None</u> bbls.	Liners Used			
Final production _____ cu. ft. per day _____ bbls.				
Well open _____ hrs. before test _____ RP.				

Well treatment details:

Attach copy of cementing record.

Fractured Newbergh 6090 to 6096 with 1000 bbl. water and 50,000 lbs. of sand.

Coal was encountered at None Feet \_\_\_\_\_ Inches \_\_\_\_\_  
Fresh water 90 Feet \_\_\_\_\_ Salt Water \_\_\_\_\_ Feet \_\_\_\_\_  
Producing Sand Newbergh Depth 6090-6100

Formation	Color	Hard or Soft	Top Feet	Bottom Feet	Oil, Gas or Water	* Remarks
Soil		S	0	22		
Shale		S	22	90		
Sand		S	90	95		
Shale		S	95	450		
Sand		H	450	490		
Shale		H	490	870		
Sand		H	870	895		
Shale		S	895	1600		
Sand		H	1600	1640		Electric log tops
Shale		S	1640	1650		Electric log tops
Sand		H	1650	1820		Electric log tops
Shale		H	1820	1880		Electric log tops
Shaley Sand		H	1880	2105		
Shale			2105	5000		Gamma Log tops
Hard-Lime - <u>Onondaga</u>			5000	5174		Top of Lime 5000'
Sand - <u>ORISKANY</u>			5174	5204		Oriskany Sand
Lime - <u>Helderberg &amp; Salina</u>			5204	6090		
Sand - <u>Newbergh</u>			6090	6099		Newbergh Sand
Lime - <u>Mckenzie</u>			6099	6102		
T.D.			6102			

545

(over)

\* Indicates Electric Log tops in the remarks section.

JUN 10 1974