



STATE OF WEST VIRGINIA  
DEPARTMENT OF MINES  
OIL AND GAS DIVISION

NOTICE OF PROPOSED LOCATION OF OIL AND GAS WELL

To THE DEPARTMENT OF MINES,  
Charleston, W. Va.

None  
COAL OPERATOR OR COAL OWNER

ADDRESS

COAL OPERATOR OR COAL OWNER

ADDRESS

V. C. Whitlatch  
OWNER OF MINERAL RIGHTS

New England, West Virginia  
ADDRESS

B. H. Putnam  
NAME OF WELL OPERATOR

Box 647, Marietta, Ohio  
COMPLETE ADDRESS

July 29, 19 52  
PROPOSED LOCATION

Harris District

Wood County

Well No. 1

V. C. Whitlatch Farm

*39° 15'*  
*81° 40'*

GENTLEMEN:

The undersigned well operator is entitled to drill upon the above named farm or tract of land for oil and gas, having fee title thereto, (or as the case may be) under grant or lease dated April 21, 1951, made by V. C. and Esther G. Whitlatch, to B. H. Putnam, and recorded on the 30th day of April, 1951, in the office of the County Clerk for said County in Book 343, page 138.

The enclosed plat was prepared by a competent engineer and shows the proposed location of a well to be drilled for oil and gas by the undersigned well operator on the farm and in the Magisterial District and County above named, determined by survey and courses and distances from two permanent points, or land marks.

The undersigned well operator is informed and believes there are no coal operators operating beds of coal beneath said farm or tract of land on which said well is located, or within 500 feet of the boundaries of the same, who have mapped their workings and filed their maps as required by law, excepting the coal operators or coal owners (if any) above named as addressees.

The above named coal operators or coal owners (if any) are notified that any objections they may desire to make to such proposed location, or which they are required to make by Section 3 of said Code, if the drilling of a well at said proposed location will cause a dangerous condition in or about their respective coal mines, must be received by, or filed with the Department of Mines within ten\* days from the receipt of a copy of this notice and accompanying plat by said Department. Said coal operators are further notified that forms for use in making such objections will be furnished to them by the Department of Mines promptly on request and that all such objections must set forth as definitely as is reasonably possible the ground or grounds on which such objections are based and indicate the direction and distance the proposed location should be moved to overcome same.

(The next paragraph is to be completed only in Department's copy.)

Copies of this notice and the enclosed plat were mailed by registered mail, or delivered to the above named coal operators or coal owners at their above shown respective address \_\_\_\_\_ day \_\_\_\_\_ before, or on the same day with the mailing or delivery of this copy to the Department of Mines at Charleston, West Virginia.

Very truly yours,

B. H. Putnam by G. E. Lauer  
WELL OPERATOR  
P. O. Box 647

Address of Well Operator }

STREET  
Marietta, Ohio  
CITY OR TOWN

12/08/2023

STATE

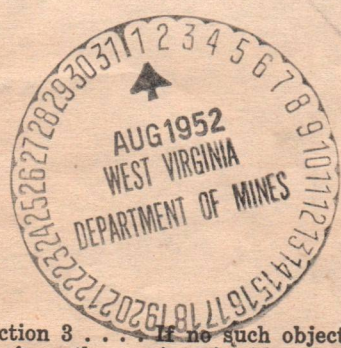

\*Section 3 . . . If no such objections be filed or be found by the department of mines, within said period of ten days from the receipt of said notice and plat by the department of mines, to said proposed location, the department shall forthwith issue to the well operator a drilling permit reciting the filing of such plat, that no objections have been made by the coal operators to the location, or found thereto by the department, and that the same is approved and the well operator authorized to proceed to drill at said location.

377





STATE OF WEST VIRGINIA  
DEPARTMENT OF MINES  
OIL AND GAS DIVISION

NOTICE OF PROPOSED LOCATION OF OIL AND GAS WELL

To The Department of Mines  
Charleston, West Virginia

E. H. Fritman  
NAME OF WELL OPERATOR

None

Box 847, Marietta, Ohio  
COMPLETE ADDRESS

ADDRESS

1951

July 23

PROPOSED LOCATION

COAL OPERATOR OR COAL OWNER

Owner

None

ADDRESS

None

Wood

V. C. Whittaker

OWNER OF MINERAL RIGHTS

Well No. 1

New England, West Virginia

V. C. Whittaker

ADDRESS

GENTLEMAN:

The undersigned well operator is desiring to drill on the above named tract of land for oil and gas having the title thereto (or as the case may be) under grant or lease dated April 23, 1951 by V. C. Whittaker, Marietta, Ohio.

The enclosed plan was prepared by a competent engineer and shows the proposed location of a well to be drilled for oil and gas on the indicated well section on the farm and in the fractional interest of the County above noted, described by survey and distance from two permanent points of the main line.

The undersigned well operator is informed and believes that there are no coal contracts covering this tract of land and that no other well is located or being located on the land. The coal operator or coal owner (if any) above named or otherwise, who has mapped their workings and filed their maps as required by law, excepting the coal operators of coal owners (if any) above named or otherwise.

The above named coal operators or coal owners (if any) are notified that any objection to the making of a well in said proposed location will cause a lawsuit to be filed in the County of Boone, West Virginia, and that the undersigned well operator will be held liable for the cost of such litigation. It is requested that all such objections be filed in writing with the Department of Mines, State Capitol Building, Charleston, West Virginia, on or before the date hereon set forth as a condition precedent to the filing of the proposed location should grounds on which such objections are based and indicate the location and distance the proposed location should be moved to overcome same.

The next paragraph is to be completed only in Department's copy.  
Copies of this notice and the enclosed plan were mailed by registered mail or delivered to the above named coal operators or coal owners at their above named respective address on the same day with the mailing or delivery of this copy to the Department of Mines at Charleston, West Virginia.

E. H. Fritman by  
G. S. Fisher

Box 847  
Marietta, Ohio

Address  
Well Operator

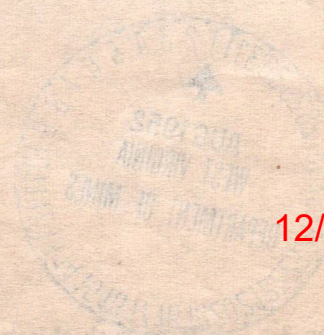

12/08/2023

Notice is hereby given that the undersigned well operator is desiring to drill on the above named tract of land for oil and gas having the title thereto (or as the case may be) under grant or lease dated April 23, 1951 by V. C. Whittaker, Marietta, Ohio.



B.2

Formation	Color	Hard or Soft	Top	Bottom	Oil, Gas or Water	Depth Found	Remarks
Slate			896	920			
Sand		hard	920	955			
Blue slate	blue		995	960			
Pink rock	pink		960	986			
Slate			986	1025			
Sand			1025	1030	SLM @	1025'	
White slate	white		1030	1100			
Lime			1100	1130			
Sandy slate			1130	1140			
Slate			1140	1170			
Sand			1170	1200	1 1/2 bailers/hr. @	1190'	
Slate			1200	1211			
Broken sand			1211	1245			
Lime,	gray	hard	1245	1255			
Sand			1255	1270			
Slate			1270	1295			
Sand			1295	1340			
Sandy slate			1340	1370			
Sand			1370	1380			
Slate			1380	1395			
Lime			1395	1405			
Sand			1405	1425			
Black slate	black		1425	1435			
Slate			1435	1445			
Sandy slate			1445	1460			
Gray sand	gray		1460	1470			
Broken sand			1470	1490			
Shelly slate			1490	1507			
Slate/shells			1507	1579			
Sand			1579	1580 1/2	SLM gas @	1579'	
Drilling stopped.....							
<u>DEEPEMED</u>							
Slate	white		1590	1603			
Sand			1603	1615			
Sand	white		1615	1630			
Sand			1630	1697			
Sand			1697	1765			
Slate			1765	1800			
Slate/shells			1800	1810			
slate			1810	1855			
Slate/lime			1855	1883			
Slate/shells			1883	1934			
Slate			1934	1985			
Slate/lime shells			1985	2036			
Slate			2038	2080			
Sand			2080	2084			
Slate			2084	2143			
Slate/lime			2143	2181			
Slate/shells			2181	2440			
Slate/lime			2440	2526			
Slate			2526	2586			
Slate/lime			2586	2667			
Slate			2667	2718			
Slate/shells			2718	2760			
Slate			2760	2820			
Slate/shells			2820	2856			
Slate/lime			2856	3083			
Slate/shells			3083	3151			
Slate			3151	3190			
Slate/shells			3190	3230			
Shale/lime			3230	3323			
Lime			3323	3404			
Shale/lime			3404	3450			
Shale			3450	3733			
Slate/shells			3733	3776			
Slate			2776	4027			

12/08/2023

Date \_\_\_\_\_, 19\_\_\_\_

APPROVED \_\_\_\_\_, Owner

By \_\_\_\_\_ (Title)



B-1



COPY

STATE OF WEST VIRGINIA  
DEPARTMENT OF MINES  
OIL AND GAS DIVISION

Quadrangle \_\_\_\_\_

WELL RECORD

Oil or Gas Well Gas  
(KIND)

Permit No. W00-377

Company B. H. Putnam, OPERATOR  
Address 512 Third St., Marietta, Ohio  
Farm V. C. WHITLATCH Acres 85  
Location (waters) Ohio River  
Well No. One Elev. 874  
District Harris County Wood  
The surface of tract is owned in fee by V. C. Whitlatch  
Address New England, W.Va.  
Mineral rights are owned by V. C. Whitlatch  
Address New England, W.Va.  
Drilling commenced 7-31-52 2-11-53  
Drilling completed 8-15-52 3-29-53  
Date Shot \_\_\_\_\_ From \_\_\_\_\_ To \_\_\_\_\_  
With \_\_\_\_\_  
Open Flow \_\_\_\_\_ /10ths Water in \_\_\_\_\_ Inch  
\_\_\_\_\_ /10ths Merc. in \_\_\_\_\_ Inch  
Volume 475,000 Cu. Ft.  
Rock Pressure 1520 lbs. 36 hrs.  
Oil none bbls., 1st 24 hrs.  
WELL ACIDIZED \_\_\_\_\_  
WELL FRACTURED Hydrafrac

Casing and Tubing	Used in Drilling	Left in Well	Packers
Size			Kind of Packer _____
16			Size of _____
13	<u>210'</u>		Depth set _____
10	<u>1045'</u>		Perf. top _____
8 1/4		<u>1770'</u>	Perf. bottom _____
6 5/8		<u>4347'</u>	Perf. top _____
5 3/16			Perf. bottom _____
3	<u>1575'</u>		
2			
Liners Used			

CASING CEMENTED 7" SIZE 350' No. Ft. 3-19-53 Date

COAL WAS ENCOUNTERED AT \_\_\_\_\_ FEET \_\_\_\_\_ INCHES  
\_\_\_\_\_ FEET \_\_\_\_\_ INCHES  
\_\_\_\_\_ FEET \_\_\_\_\_ INCHES

RESULT AFTER TREATMENT \_\_\_\_\_

ROCK PRESSURE AFTER TREATMENT \_\_\_\_\_

Fresh Water \_\_\_\_\_ Feet Salt Water 1 1/2 bailers/hr. Feet 1190'

Formation	Color	Hard or Soft	Top	Bottom	Oil, Gas or Water	Depth	Remarks
Soil			0	10			
Sand			10	25			
Red rock	red		25	90			
Blue Slate	blue		90	100			
Red rock	red		100	210			
Slate			210	242			
Red rock	red		242	275			
Sand			275	315			
Slate			315	325			
Red rock	red		325	350			
Slate			350	375			
Sand			375	385			
Red rock			385	425			
Lime			425	430			
Red rock	red		430	480			
Blue slate	blue		480	505			
Red rock	red		505	530			
Blue slate	blue		530	595			
Sand			595	611			
White slate	white		611	657			
Pink rock	pink		657	665			
Limy slate			665	682			
Sand			682	705			
Slate			705	725			
Red rock	red		725	760			
Blue slate	blue		760	776			
Slate			776	790			
Red rock	red		790	870			
Blue slate	blue		870	890			
Lime			890	896			



(over)



B-3



Bellaire

STATE OF WEST VIRGINIA  
DEPARTMENT OF MINES  
OIL AND GAS DIVISION 18

WELL RECORD

Permit No. Woo-377-D

Oil or Gas Well Gas  
(KIND)

Company B. H. Putnam, Operator  
Address 512 Third Street, Marietta, Ohio  
Farm V. C. Whitlatch Acres 85  
Location (waters) Ohio River  
Well No. 1 Elev. 874  
District Harris County Wood  
The surface of tract is owned in fee by V. C. Whitlatch  
Address New England  
Mineral rights are owned by V. C. Whitlatch  
Address New England  
Drilling commenced 7/31/52  
Drilling completed 3/29/53  
Date Shot Hydrafrac From -- To ---  
With \_\_\_\_\_  
Open Flow \_\_\_\_\_ /10ths Water in \_\_\_\_\_ Inch  
\_\_\_\_\_ /10ths Merc. in \_\_\_\_\_ Inch  
Volume 475,000 Cu. Ft.  
Rock Pressure 1520 lbs. 36 hrs.  
Oil None bbls., 1st 24 hrs.  
Fresh water None feet \_\_\_\_\_ feet  
Salt water None feet \_\_\_\_\_ feet

Casing and Tubing	Used in Drilling	Left in Well	Packers
Size			Kind of Packer
16			
13	210'		
10	1045'		Size of
8 1/4		1770'	
6 1/2		4347'	Depth set
5 3/16			
3	1575'		Perf. top
2			Perf. bottom
Liners Used			Perf. top
			Perf. bottom

CASING CEMENTED 7" SIZE 350' No. Ft. 3/19/53 Date

COAL WAS ENCOUNTERED AT None FEET \_\_\_\_\_ INCHES  
\_\_\_\_\_ FEET \_\_\_\_\_ INCHES \_\_\_\_\_ FEET \_\_\_\_\_ INCHES  
\_\_\_\_\_ FEET \_\_\_\_\_ INCHES \_\_\_\_\_ FEET \_\_\_\_\_ INCHES

Formation	Color	Hard or Soft	Top	Bottom	Oil, Gas or Water	Depth Found	Remarks
Slate	White		1590	1603			
Sand			1603	1615			
Sand	White		1615	1630			
Sand			1630	1697			
Sand	1697		1697	1765			
Slate	1765		1765	1800			
Slate-Shells			1800	1810			
Slate			1810	1855			
Slate-Lime			1855	1883			
Slate-Shells			1883	1934			
Slate			1934	1985			
Slate-Lime Shells			1985	2036			
Slate			2036	2080			
Sand			2080	2084			
Slate			2084	2143			
Slate-Lime			2143	2181			
Slate-Shells			2181	2440			
Slate-Lime			2440	2526			
Slate			2526	2586			
Slate-Lime			2586	2667			
Slate			2667	2718			
Slate-Shells			2718	2760			
Slate			2760	2820			
Slate-Shells			2820	2856			
Slate-Lime			2856	3083			
Slate-Shells			3083	3151			
Slate			3151	3190			
Slate-Shells			3190	3230			
Shale-Lime			3230	3323			
Lime			3323	3404			
Shale-Lime			3404	3450			
Shale			3450	3733			
Slate-Shells			3733	3776			
Slate			3776	4027			

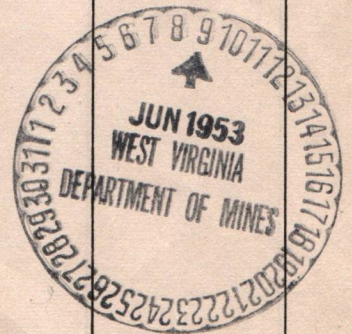

12/08/2023











STATE OF WEST VIRGINIA  
DEPARTMENT OF MINES  
OIL AND GAS DIVISION

INSPECTOR'S WELL REPORT

Permit No. \_\_\_\_\_ Oil or Gas Well \_\_\_\_\_  
(KIND)

		CASING AND TUBING	USED IN DRILLING	LEFT IN WELL	PACKERS
Company _____		Size			Kind of Packer _____
Address _____		16			
Farm _____		13			
Well No. _____		10			Size of _____
District _____ County _____		8 1/4			
Drilling commenced _____		6 5/8			Depth set _____
Drilling completed _____ Total depth _____		5 3/16			
Date shot _____ Depth of shot _____		3			Perf. top _____
Initial open flow _____ /10ths Water in _____ Inch		2			Perf. bottom _____
Open flow after tubing _____ /10ths Merc. in _____ Inch		Liners Used			Perf. top _____
Volume _____ Cu. Ft.					Perf. bottom _____
Rock pressure _____ lbs. _____ hrs.		CASING CEMENTED _____ SIZE _____ No. FT. _____ Date _____			
Oil _____ bbls., 1st 24 hrs.		COAL WAS ENCOUNTERED AT _____ FEET _____ INCHES			
Fresh water _____ feet _____ feet		_____ FEET _____ INCHES _____ FEET _____ INCHES			
Salt water _____ feet _____ feet		_____ FEET _____ INCHES _____ FEET _____ INCHES			

Drillers' Names \_\_\_\_\_

Remarks:

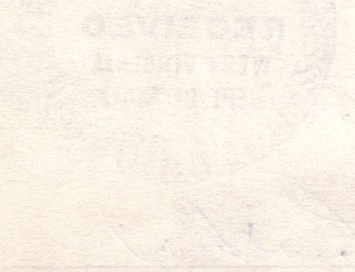

DATE

DISTRICT WELL INSPECTOR

12/08/2023







STATE OF WEST VIRGINIA  
DEPARTMENT OF MINES  
OIL AND GAS DIVISION

## INSPECTOR'S WELL REPORT

Permit No. \_\_\_\_\_

Oil or Gas Well \_\_\_\_\_  
(KIND)

	CASING AND TUBING	USED IN DRILLING	LEFT IN WELL	PACKERS
Company _____				
Address _____	Size			
Farm _____	16			Kind of Packer _____
Well No. _____	13			
District _____ County _____	10			Size of _____
Drilling commenced _____	8 1/4			
Drilling completed _____ Total depth _____	6 5/8			Depth set _____
Date shot _____ Depth of shot _____	5 3/16			
Initial open flow _____ /10ths Water in _____ Inch	3			Perf. top _____
Open flow after tubing _____ /10ths Merc. in _____ Inch	2			Perf. bottom _____
Volume _____ Cu. Ft.	Liners Used			Perf. top _____
Rock pressure _____ lbs. _____ hrs.				Perf. bottom _____
Oil _____ bbls., 1st 24 hrs.	CASING CEMENTED _____ SIZE _____ No. FT. _____ Date _____			
Fresh water _____ feet _____ feet	COAL WAS ENCOUNTERED AT _____ FEET _____ INCHES			
Salt water _____ feet _____ feet	_____ FEET _____ INCHES	_____ FEET _____ INCHES	_____ FEET _____ INCHES	_____ FEET _____ INCHES

Drillers' Names \_\_\_\_\_

Remarks: \_\_\_\_\_

DATE

DISTRICT WELL INSPECTOR

12/08/2023







STATE OF WEST VIRGINIA  
DEPARTMENT OF MINES  
OIL AND GAS DIVISION

INSPECTOR'S WELL REPORT

Permit No. \_\_\_\_\_

Oil or Gas Well \_\_\_\_\_  
(KIND)

Company _____ Address _____ Farm _____ Well No. _____ District _____ County _____ Drilling commenced _____ Drilling completed _____ Total depth _____ Date shot _____ Depth of shot _____ Initial open flow _____ /10ths Water in _____ Inch Open flow after tubing _____ /10ths Merc. in _____ Inch Volume _____ Cu. Ft. Rock pressure _____ lbs. _____ hrs. Oil _____ bbls., 1st 24 hrs. Fresh water _____ feet _____ feet Salt water _____ feet _____ feet	CASING AND TUBING	USED IN DRILLING	LEFT IN WELL	PACKERS
	Size			Kind of Packer _____
	16			
	13			
	10			Size of _____
	8 1/4			
	6 5/8			Depth set _____
	5 3/16			
	3			Perf. top _____
	2			Perf. bottom _____
	Liners Used _____			Perf. top _____
				Perf. bottom _____
	CASING CEMENTED _____ SIZE _____ No. FT. _____ Date _____			
	COAL WAS ENCOUNTERED AT _____ FEET _____ INCHES			
	_____ FEET _____ INCHES _____ FEET _____ INCHES			
	_____ FEET _____ INCHES _____ FEET _____ INCHES			

Drillers' Names \_\_\_\_\_

Remarks: \_\_\_\_\_

DATE

DISTRICT WELL INSPECTOR

12/08/2023







STATE OF WEST VIRGINIA  
DEPARTMENT OF MINES  
OIL AND GAS DIVISION

## INSPECTOR'S WELL REPORT

Permit No. \_\_\_\_\_

Oil or Gas Well \_\_\_\_\_  
(KIND)

	CASING AND TUBING	USED IN DRILLING	LEFT IN WELL	PACKERS
Company _____	Size _____			Kind of Packer _____
Address _____	16 _____			
Farm _____	13 _____			
Well No. _____	10 _____			Size of _____
District _____ County _____	8 1/4 _____			
Drilling commenced _____	6 5/8 _____			Depth set _____
Drilling completed _____ Total depth _____	5 3/16 _____			
Date shot _____ Depth of shot _____	3 _____			Perf. top _____
Initial open flow _____ /10ths Water in _____ Inch	2 _____			Perf. bottom _____
Open flow after tubing _____ /10ths Merc. in _____ Inch	Liners Used _____			Perf. top _____
Volume _____ Cu. Ft.				Perf. bottom _____
Rock pressure _____ lbs. _____ hrs.	CASING CEMENTED _____ SIZE _____ No. FT. _____ Date _____			
Oil _____ bbls., 1st 24 hrs.	COAL WAS ENCOUNTERED AT _____ FEET _____ INCHES			
Fresh water _____ feet _____ feet	_____ FEET _____ INCHES _____ FEET _____ INCHES			
Salt water _____ feet _____ feet	_____ FEET _____ INCHES _____ FEET _____ INCHES			

Drillers' Names \_\_\_\_\_

Remarks: \_\_\_\_\_

DATE

DISTRICT WELL INSPECTOR

12/08/2023





STATE OF WEST VIRGINIA  
DEPARTMENT OF MINES  
OIL AND GAS DIVISION

NOTICE OF INTENTION TO PLUG AND ABANDON WELL

(REQUIRED BY SECTION 9, ARTICLE 4, CHAPTER 22 OF THE CODE)

To THE DEPARTMENT OF MINES,

Charleston, W. Va.

Coal Operator or Coal Owner

B. H. PUTNAM, OPERATOR  
Name of Well Operator

Address

512 Third St., Marietta, Ohio  
Complete Address

Coal Operator or Coal Owner

March 13, 19 58

WELL TO BE ABANDONED

Address

HARRIS District

Lease or Property Owner

WOOD County

Address

Well No. One

V. C. Whitlatch Farm

Inspector to be notified JOHN E. LOWTHER - TELEPHONE HARRISVILLE, 135  
24 HOURS IN ADVANCE OF PLUGGING DATE

Gentlemen:—

The undersigned well operator is about to abandon the above described well and will commence

**the week of the 17th, March, 1958**

the work of plugging and abandoning said well on the date inspector is notified (which date shall not be less than five days after the day on which this notice so mailed is received, or in due course should be received by the Department of Mines).

This notice is given you in order that your respective representatives may be present at the plugging and filling of said well. You are further notified that whether you are represented or not represented the undersigned will proceed on that date, or shortly thereafter, to plug and fill said well in the manner required by Section 10, Article 4, Chapter 22 of the Code and given in detail on the reverse side of this notice, in "Work Order."

This notice is being mailed by registered mail to each of you at the above addresses on the above date.



Very truly yours,  
B. H. PUTNAM, OPERATOR

*[Signature]*  
Chief Quantities

NOTE: Upon the abandonment of all wells drilled prior to June 1, 1929, a plat prepared by a registered engineer, showing the district and county in which the tract of land is located, the name and acreage of same, the names of the owners and adjacent tracts, and the location of the about to be abandoned well, determined by survey, and the courses and distances of such well from two permanent points or landmarks on said tract, shall be submitted with this notice.

NOTE: In case plugging is not commenced within four months from the above date, this permit shall expire and be of no further force or effect.

(over)

WOO-377-p PERMIT NUMBER

12/08/2023



PROPOSED MANNER OF PLUGGING AND FILLING WELL

(REQUIRED BY RULES AND REGULATIONS)

WEST VIRGINIA DEPARTMENT OF MINES

OIL AND GAS DIVISION

WORK ORDER

Well to be plugged and filled as follows:

Fill with non-porous material from bottom 4371' to 4340', the bottom of the 7" casing, 50' neat cement, 10' crushed rock and continue filling with clay to 4121' inside the 5 1/2" casing which is cemented with 65 sacks of cement. Rip and pull the 7" casing. Set a bridge at 2130' - 50' below the Berea sand. Three bags neat cement and crushed stone, fill with mud to 1786' - 10' neat cement and crushed rock on top thereof. Fill hole completely below 8 5/8" casing. Pull 8 5/8" casing. Set permanent bridge at 1615' - 20' in Injun sand, three sacks neat cement and crushed stone. Fill with clay to 1045' - 10" casing point. Three sacks neat cement on top thereof sealing off all salt water. The 10" casing has been pulled prior to this. Set bridge at 500' and complete filling to surface. Will erect marker as described in Fule 18-1931 Regulation.

County: WOOD  
District: HARRIS  
Well No.:  
Name: V. C. Whitlatch

To the Department of Mines  
Coal Owner or Operator,  
Lease or Property Owner.

Gentlemen:

This "work order" is submitted for your approval and concurrence and unless notified of your disapproval or non-concurrence, the undersigned will proceed with the plugging and filling of said well in the above described manner on the date stated in the notice of intention to plug and abandon the said well on opposite side of this sheet.

Very truly yours,  
B. H. PUTNAM, OPERATOR

*By [Signature]*  
Well Operator.

No objections have been filed by the coal owner or coal operator, or any available adjacent lease or property owners or interposed by the Department of Mines to the manner herein described for the plugging and filling of the well above mentioned. Therefore, the same is hereby approved.

25th day of March, 1958, 19\_\_

DEPARTMENT OF MINES  
Oil and Gas Division

By: \_\_\_\_\_

NOTE: This "work order" shall be filed in triplicate, one copy for the files of the Department of Mines; one to be approved or corrected and returned to the well operator as his authority for plugging said well; and one for the well inspector.



STATE OF WEST VIRGINIA  
DEPARTMENT OF MINES  
OIL AND GAS DIVISION

AFFIDAVIT OF PLUGGING AND FILLING WELL

AFFIDAVIT SHOULD BE MADE IN TRIPLICATE, ONE COPY MAILED TO THE DEPARTMENT, ONE COPY TO BE RETAINED BY THE WELL OPERATOR AND THE THIRD COPY (AND EXTRA COPIES IF REQUIRED) SHOULD BE MAILED TO EACH COAL OPERATOR AT THEIR RESPECTIVE ADDRESSES.

COAL OPERATOR OR OWNER	B. H. PUTNAM, OPERATOR
ADDRESS	P. O. BOX 647, MARIETTA, OHIO
COAL OPERATOR OR OWNER	May 14, 1958
ADDRESS	WELL AND LOCATION
LEASE OR PROPERTY OWNER	HARRIS District
ADDRESS	WOOD County
	Well No. ONE
	V. C. WHITLATCH Farm
	John E. Lowther

STATE INSPECTOR SUPERVISING PLUGGING: John E. Lowther

OHIO }  
STATE OF ~~WEST VIRGINIA~~ } ss:  
County of WASHINGTON

Leonard L. Munday and Burris Ammons  
being first duly sworn according to law depose and say that they are experienced in the work of plugging and filling oil and gas wells and were employed by B. H. PUTNAM, OPERATOR, well operator, and participated in the work of plugging and filling the above well, that said work was commenced on the 26th day of March, 1958, and that the well was plugged and filled in the following manner:

FORMATION	SAND OR ZONE RECORD	FILLING MATERIAL	PLUGS USED SIZE & KIND	CASING	
				CSG PULLED	CSG LEFT IN
ORISKANY	4371 - 4340	Red mud			
	4340 - 4338	Lead plug	7"		
	4338 - 4278	Cement & crushed rock			
	4278 - 4121	Clay			
		Pull 7" casing		3296'6"	1119'6"
BEREA	2130	Set bridge			
	2130 - 2105	Cement and crushed rock			
	2105 - 1786	Red mud			
	1786 - 1776	Cement & crushed rock			
		Pull 8 5/8" casing		1775'	3'
INJUN	1615	Set bridge			
	1615 - 1590	Cement & crushed rock			
	1590 - 1045	Clay			
	1045 - 1020	Cement & crushed rock			
	500	Set bridge			
	500 COAL SEAMS	Cement and rock			
(NAME)	475 - 0	Fill to surface with clay	Pipe 7" x 6' marked V. C. WHITLATCH		
(NAME)			#1 - B. H. PUTNAM, OPERATOR		
(NAME)					
(NAME)					

and that the work of plugging and filling said well was completed on the 9th day of April, 1958.

And further deponents saith not.

Sworn to and subscribed before me this 3 day of June, 1958.

My commission expires: April 11, 1960

Leonard L. Munday  
Burris Ammons 12/08/2023  
Naomi Ruth Bailey  
Notary Public.  
Permit No. WOO-377-P

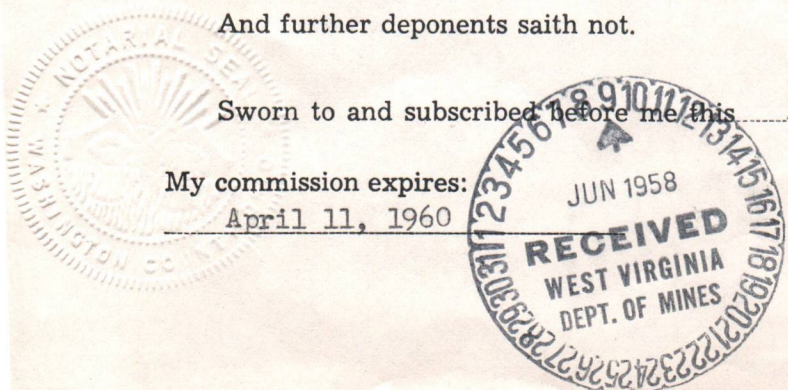







Latitude 39° 15'

Longitude 81° 40'

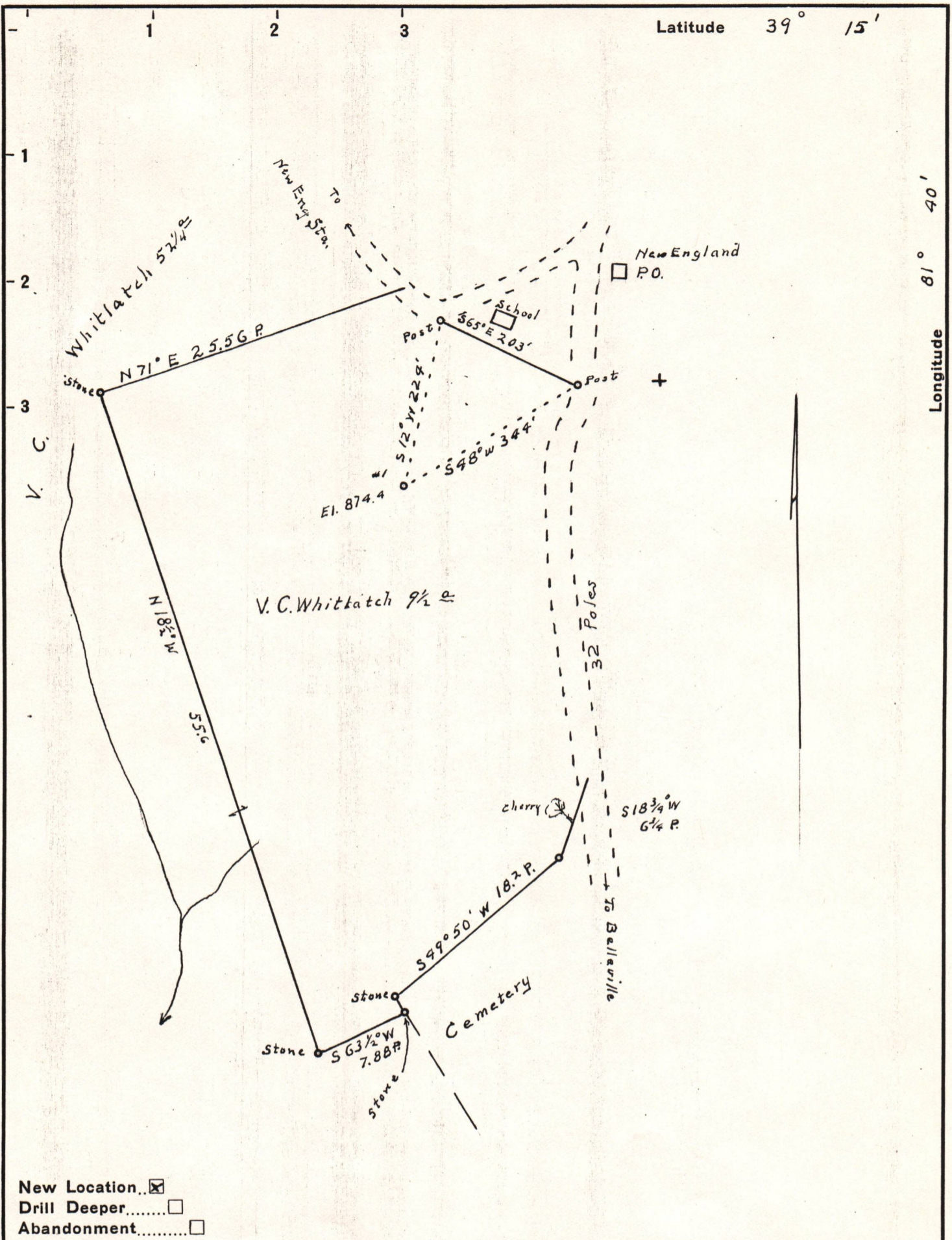

New Location...   
 Drill Deeper.....   
 Abandonment.....

Company B. H. Putnam, Operator

Address 1st Nat Bank Bldg, Marietta, Ohio

Farm V.C. Whittatch

Tract \_\_\_\_\_ Acres 9 1/2 Lease No. \_\_\_\_\_

Well (Farm) No. 1 Serial No. \_\_\_\_\_

Elevation (Spirit Level) 874.4'

Quadrangle Belleville

County Wood District Harris

Engineer Robert R. Anderson  
*by O. Meredith*

Engineer's Registration No. 296

File No. \_\_\_\_\_ Drawing No. \_\_\_\_\_

Date 7/29 52 Scale 1 in = 10 Poles

STATE OF WEST VIRGINIA  
 DEPARTMENT OF MINES  
 OIL AND GAS DIVISION  
 CHARLESTON

### WELL LOCATION MAP

FILE NO. W00-377

12/08/2023

+ Denotes location of well on United States Topographic Maps, scale 1 to 62,500, latitude and longitude lines being represented by border lines as shown.

- Denotes one inch spaces on border line of original tracing.