



STATE OF WEST VIRGINIA
DEPARTMENT OF MINES
OIL AND GAS DIVISION

NOTICE OF PROPOSED LOCATION OF OIL AND GAS WELL

To THE DEPARTMENT OF MINES,
Charleston, W. Va.

Morlan Associates of Bellville
Ralph G. Frankhouser
NAME OF WELL OPERATOR

Belleville, W. Va
COMPLETE ADDRESS

July 24, 19*52*
PROPOSED LOCATION

Harris District

Wood County

Well No. *2* *390 10'*
81° 40'

Clyde E. Morlan Farm

COAL OPERATOR OR COAL OWNER
ADDRESS
COAL OPERATOR OR COAL OWNER
ADDRESS
OWNER OF MINERAL RIGHTS
ADDRESS

GENTLEMEN:

The undersigned well operator is entitled to drill upon the above named farm or tract of land for oil and gas, having fee title thereto, (or as the case may be) under grant or lease dated *August 22, 1931*, made by *Clyde E. Morlan*, to *Ralph G. Frankhouser*, and recorded on the *25* day of *August, 1931*, in the office of the County Clerk for said County in Book *78* page *27*.

The enclosed plat was prepared by a competent engineer and shows the proposed location of a well to be drilled for oil and gas by the undersigned well operator on the farm and in the Magisterial District and County above named, determined by survey and courses and distances from two permanent points, or land marks.

The undersigned well operator is informed and believes there are no coal operators operating beds of coal beneath said farm or tract of land on which said well is located, or within 500 feet of the boundaries of the same, who have mapped their workings and filed their maps as required by law, excepting the coal operators or coal owners (if any) above named as addressees.

The above named coal operators or coal owners (if any) are notified that any objections they may desire to make to such proposed location, or which they are required to make by Section 3 of said Code, if the drilling of a well at said proposed location will cause a dangerous condition in or about their respective coal mines, must be received by, or filed with the Department of Mines within ten* days from the receipt of a copy of this notice and accompanying plat by said Department. Said coal operators are further notified that forms for use in making such objections will be furnished to them by the Department of Mines promptly on request and that all such objections must set forth as definitely as is reasonably possible the ground or grounds on which such objections are based and indicate the direction and distance the proposed location should be moved to overcome same.

(The next paragraph is to be completed only in Department's copy.)

Copies of this notice and the enclosed plat were mailed by registered mail, or delivered to the above named coal operators or coal owners at their above shown respective address _____ day _____ before, or on the same day with the mailing or delivery of this copy to the Department of Mines at Charleston, West Virginia.

Very truly yours,

Ralph G. Frankhouser
WELL OPERATOR

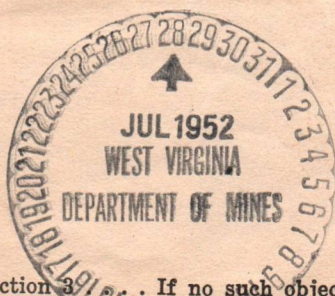

Address of Well Operator }

STREET
Belleville
CITY OR TOWN
West Virginia
STATE

12/08/2023

*Section 3... If no such objections be filed or be found by the department of mines, within said period of ten days from the receipt of said notice and plat by the department of mines, to said proposed location, the department shall forthwith issue to the well operator a drilling permit reciting the filing of such plat, that no objections have been made by the coal operators to the location, or found thereto by the department, and that the same is approved and the well operator authorized to proceed to drill at said location.

376



STATE OF WEST VIRGINIA
DEPARTMENT OF MINES
OIL AND GAS DIVISION 4

Belleville

WELL RECORD

Permit No. W00-376

Oil or Gas Well Oil
(KIND)

Company Moran Association of Belleville
Address Belleville West, Va
Farm Clyde E. Moran Acres 67
Location (waters) Ohio River, Big Pond
Well No. 2 Elev. 703'
District Harrison County Wood

Casing and Tubing	Used in Drilling	Left in Well	Packers
Size			Kind of Packer
16" ✓	20	20	
13" ✓	566-8		Size of
10" ✓	970-4		Depth set
8 1/4" ✓	1600-9	1600-9	
6 5/8"			Perf. top
5 3/16"			Perf. bottom
3"		1977	Perf. top
2"			Perf. bottom
Liners Used			

The surface of tract is owned in fee by _____
Address _____

Mineral rights are owned by _____
Address _____

Drilling commenced Feb 5-33
Drilling completed March 9-33
Date Shot March 11-33 From _____ To _____

With 40 gal. Sylvania
Open Flow _____ /10ths Water in _____ Inch
_____ /10ths Merc. in _____ Inch

Volume _____ Cu. Ft.

Rock Pressure _____ lbs. _____ hrs.
Oil _____ bbls., 1st 24 hrs.

Fresh water _____ feet _____ feet
Salt water _____ feet _____ feet

CASING CEMENTED	SIZE	No. Ft.	Date
COAL WAS ENCOUNTERED AT		FEET	INCHES
	FEET	INCHES	FEET
	FEET	INCHES	FEET

Formation	Color	Hard or Soft	Top	Bottom	Oil, Gas or Water	Depth Found	Remarks
Clay sand	-	-	370	440			
Slate	-	-	440	463			
Little Hill Sand	-	-	463	488			
Slate Shells	-	-	488	522			
Lime	-	-	522	532			
Rocks	Red	-	532	567			
Lime Shells	-	-	567	580			
Sand	-	-	580	600			
Rocks	Red	-	600	612			
Lime	-	-	612	624			
Rocks	Red	-	624	634			
Slate Shells	-	-	634	654			
Rocks	Red	-	654	671			
Little Shells	-	-	671	680			
Rocks	Red	-	680	705			
Slate	Black	-	705	729			
Lime	-	-	729	749			
Slate Shells	-	-	749	780			
Little Sand	-	-	780	807			
Slate	Black	-	807	817			
Slate Shells	-	-	817	845			
Rocks	Pink	-	845	872			
Little Sand	-	-	872	968			
Slate Shells	-	-	968	1037			
Red sand	-	-	1037	1095			
Slate Shells	-	-	1095	1112			
Sand	-	-	1112	1190			
Slate Shells	-	-	1190	1287			
Lime	Sandy	-	1287	1315			



Formation	Color	Hard or Soft	Top 4	Bottom	Oil, Gas or Water	Depth Found	Remarks
alt Sand	—	—	1315	1345			
Sand	—	—	1345	1378			
lots shells	—	—	1378	1389			
and lime	—	—	1389	1410			
slate	—	—	1410	1422			
lime	—	—	1422	1432			
slate shells	—	—	1432	1435			
rather sand	—	—	1435	1450			
slat	—	—	1450	1458			
Rock	Pink	—	1458	1464			
Big lime	—	—	1464	1512			
slate shells	—	—	1512	1519			
lime	—	—	1519	1531			
slate	—	—	1531	1539			
lime shells	—	—	1539	1539			
slate	—	—	1539	1563			
lime	Blue	—	1563	1592			
slate	—	—	1592	1597			
lime	—	Hard	1597	1665			
slate shells	—	—	1665	1710			
lime but	—	—	1710	1735			
slate shells	—	—	1735	1960			
Shale	Brown	—	1960	1975			
Brown Sand	—	Hard	1975	1981	oil	1575	1 Hll per 24h

12/08/2023

Date June 15, 1953
 APPROVED Ralph G. Foulkner, Owner
 By Promoters,
 (Title)

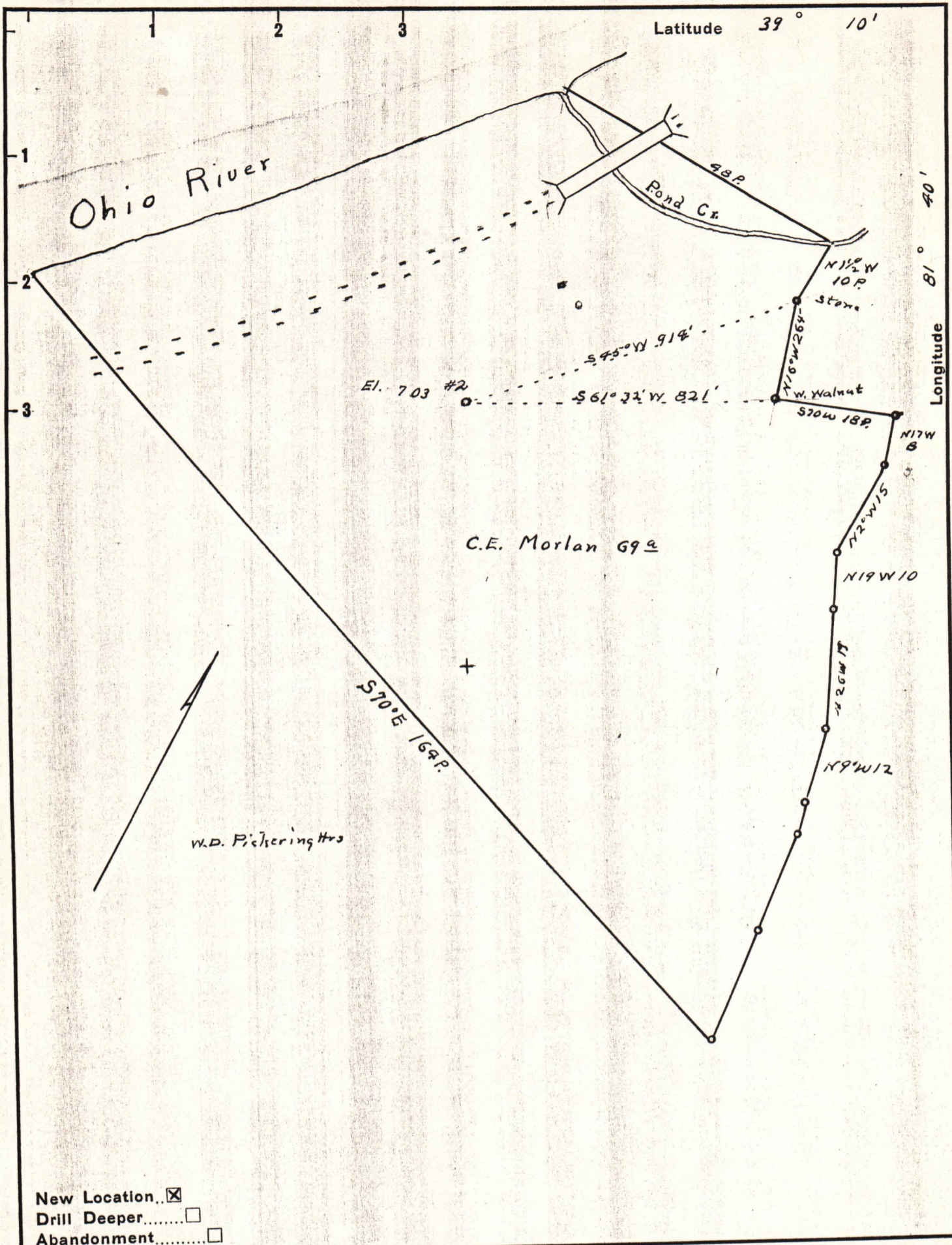

New Location
 Drill Deeper
 Abandonment

Company Morlan Association of Belleville
 Address Belleville W. Va.
 Farm C. E. Morlan
 Tract _____ Acres 69 Lease No. _____
 Well (Farm) No. 2 Serial No. _____
 Elevation (Spirit Level) 703'
 Quadrangle Belleville
 County Wood District Harris
 Engineer Robert R. Anderson
 Engineer's Registration No. 296
 File No. _____ Drawing No. _____
 Date 7'22 Scale 1 in = 20 Poles

STATE OF WEST VIRGINIA
 DEPARTMENT OF MINES
 OIL AND GAS DIVISION
 CHARLESTON

WELL LOCATION MAP
 FILE NO. W00-376

+ Denotes location of well on United States Topographic Maps, scale 1 to 62,500, latitude and longitude lines being represented by border lines as shown.
- Denotes one inch spaces on border line of original tracing.

12/08/2023