

A-10



STATE OF WEST VIRGINIA
DEPARTMENT OF MINES
OIL AND GAS DIVISION

NOTICE OF PROPOSED LOCATION OF OIL AND GAS WELL

To THE DEPARTMENT OF MINES,
Charleston, W. Va.

None
COAL OPERATOR OR COAL OWNER

ADDRESS

COAL OPERATOR OR COAL OWNER

ADDRESS

Roxie E. Maxey, et ux
OWNER OF MINERAL RIGHTS

New England, W. Va.
ADDRESS

B. H. Putnam, Operator,
NAME OF WELL OPERATOR

Box #647, Marietta, Ohio.
COMPLETE ADDRESS

July 15th, 1952
PROPOSED LOCATION

Harris District

Wood County

Well No. #1 ^{39° 15'} _{81° 40'}

Roxie E. Maxey Farm

GENTLEMEN:

The undersigned well operator is entitled to drill upon the above named farm or tract of land for oil and gas, having fee title thereto, (or as the case may be) under grant or lease dated April 21st, 1951, made by Roxie E. Maxey and A. E. Maxey, to B. H. Putnam, and recorded on the 30th day of April, 1951, in the office of the County Clerk for said County in Book 343, page 139

The enclosed plat was prepared by a competent engineer and shows the proposed location of a well to be drilled for oil and gas by the undersigned well operator on the farm and in the Magisterial District and County above named, determined by survey and courses and distances from two permanent points, or land marks.

The undersigned well operator is informed and believes there are no coal operators operating beds of coal beneath said farm or tract of land on which said well is located, or within 500 feet of the boundaries of the same, who have mapped their workings and filed their maps as required by law, excepting the coal operators or coal owners (if any) above named as addressees.

The above named coal operators or coal owners (if any) are notified that any objections they may desire to make to such proposed location, or which they are required to make by Section 3 of said Code, if the drilling of a well at said proposed location will cause a dangerous condition in or about their respective coal mines, must be received by, or filed with the Department of Mines within ten* days from the receipt of a copy of this notice and accompanying plat by said Department. Said coal operators are further notified that forms for use in making such objections will be furnished to them by the Department of Mines promptly on request and that all such objections must set forth as definitely as is reasonably possible the ground or grounds on which such objections are based and indicate the direction and distance the proposed location should be moved to overcome same.

(The next paragraph is to be completed only in Department's copy.)

Copies of this notice and the enclosed plat were mailed by registered mail, or delivered to the above named coal operators or coal owners at their above shown respective address _____ day _____ before, or on the same day with the mailing or delivery of this copy to the Department of Mines at Charleston, West Virginia.

Very truly yours, B. H. PUTNAM, OPERATOR,
By G.E. Lauer
WELL OPERATOR G.E. Lauer.

Box #647 (512 Third St.)
STREET
Marietta,
CITY OR TOWN
Ohio.
STATE

Original plat enclosed

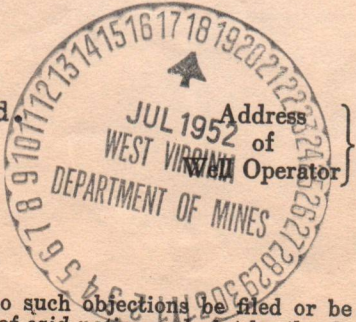

12/08/2023

*Section 3 If no such objections be filed or be found by the department of mines, within said period of ten days from the receipt of said notice and plat by the department of mines, to said proposed location, the department shall forthwith issue to the well operator a drilling permit reciting the filing of such plat, that no objections have been made by the coal operators to the location, or found thereto by the department, and that the same is approved and the well operator authorized to proceed to drill at said location.

374

NOTICE OF THE DEPARTMENT OF THE INTERIOR

U. S. DEPARTMENT OF THE INTERIOR
BUREAU OF LAND MANAGEMENT

FOR SALE BY PUBLIC AUCTION

Section 36, Township 36N, Range 10E, T13N, R10E, S47

County of Adams, State of Missouri

Approximately 160 Acres

Section 36, Township 36N, Range 10E, T13N, R10E, S47

County of Adams, State of Missouri

Approximately 160 Acres

Section 36, Township 36N, Range 10E, T13N, R10E, S47

County of Adams, State of Missouri

Approximately 160 Acres

Section 36, Township 36N, Range 10E, T13N, R10E, S47

County of Adams, State of Missouri

Approximately 160 Acres

Section 36, Township 36N, Range 10E, T13N, R10E, S47

County of Adams, State of Missouri

Approximately 160 Acres

Section 36, Township 36N, Range 10E, T13N, R10E, S47

County of Adams, State of Missouri

Approximately 160 Acres

Section 36, Township 36N, Range 10E, T13N, R10E, S47

County of Adams, State of Missouri

Approximately 160 Acres

Section 36, Township 36N, Range 10E, T13N, R10E, S47

County of Adams, State of Missouri

Approximately 160 Acres

Section 36, Township 36N, Range 10E, T13N, R10E, S47

12/08/2023



STATE OF WEST VIRGINIA
DEPARTMENT OF MINES
OIL AND GAS DIVISION 19

Belleville

WELL RECORD

Permit No. WOO-374

Oil or Gas Well Gas
(KIND)

Company B. H. Putnam, Operator
Address 512 3rd St., Marietta, Ohio
Farm Roxie E. Maxey Acres 48a.
Location (waters) Ohio River
Well No. 1 Elev. 695'
District Harris County Wood
The surface of tract is owned in fee by R. E. Maxey
Address New England
Mineral rights are owned by R. E. Maxey
Address New England
Drilling commenced 7-16-52
Drilling completed 1-17-53
Date Shot From To
With
Open Flow /10ths Water in In
/10ths Merc. in In
Volume Gas Cu. Ft.
Rock Pressure lbs. hrs.
Oil bbls., 1st 24 hrs.
Fresh water feet feet
Salt water Hole Full feet 1385 feet

Casing and Tubing	Used in Drilling	Left in Well	Packers
Size			
16			Kind of Packer
13			Baker Model K
10	960		Size of 7"
8 1/4		1544	
6 5/8		4106	Depth set 4100'
5 3/16			
3			Perf. top
2		4100'	Perf. bottom
Liners Used			Perf. top
			Perf. bottom

CASING CEMENTED 7" SIZE 4106 No. Ft. 1-11-53 Date

COAL WAS ENCOUNTERED AT FEET INCHES
FEET INCHES FEET INCHES
FEET INCHES FEET INCHES

Formation	Color	Hard or Soft	Top	Bottom	Oil, Gas or Water	Depth Found	Remarks
Surface			0	10			
Sand			10	25			
Slate			25	35			
Sand			35	100			
Red Rock	Red		100	120			
Slate			120	170			
Red Rock	Red		170	198			
Slate			198	210			
Broken Lime			210	233			
Slate			233	270			
Red Rock	Red		270	285			
Slate			285	315			
Sand			315	350			
Slate			350	355			
Lime			355	360			
Sand			360	400			
Slate			400	420			
Red Rock	Red		420	430			
Slate			430	465			
Lime			465	475			
Sand			475	495			
Slate			495	520			
Red Rock	Red		520	557			
Slate			557	580			
Red Rock	Red		580	625			
Sand			625	635			
Red Rock	Red		635	670			
Slate			670	712			
Sand			712	740			
Blue Slate	Blue		740	745			
White Slate	White		745	755			
Red Rock	Red		755	770			
Slate			770	867			
Sand			867	959			
White Slate	White		959	975	SLM @		
Blue Slate	Blue		975	988			
Sand			988	1020			
Broken Lime			1020	1030			



B-2

Formation	Color	Hard or Soft	Top	Bottom	Oil, Gas or Water	Depth Found	Remarks
Slate			1030	1090			(374)
Sand			1090	1126			
Slate			1126	1150			
Sand			1150	1196			
Slate			1196	1229			
Lime			1229	1240			
Slate			1240	1378			
Sand			1378	1510	HF Water @	1385'	
Lime			1510	1520			
Slate&Shells			1520	1533			
Slate			1533	1550	SLM @	1544'	
Lime			1550	1560			
Broken Lime			1560	1586			
Slate&Shells			1586	1836			
Coffee Shale	Brown		1836	1855			
Berea grit			1855	1859	SLM		
Slate&Shells			1859	2340			
Slate			2340	2405			
Slate&Shells			2405	2475			
Slate			2475	3025			
Brown Shale	Brown		3025	3100			
Slate&Shells			3100	3133			
Lime Shells			3133	3156			
Slate&Shells			3156	3185			
Lime			3185	3210			
Slate&Shells			3210	3315			
Lime			3315	3349			
Lime & Shale			3349	3452			
Slate&Shells			3452	3491			
Slate			3491	3536			
Lime shells & slate			3536	3565			
Slate&Shells			3565	3608			
Slate			3608	3659			
Slate&Shells			3659	3756			
Slate			3756	3813			
Brown Shale	Brown		3813	4018			
Corniferous Lime	Lime		4018	4108	SLM		
Oriskany sand			4108	4129			
Total Depth				4129			

12/08/2023

Date _____, 19____

APPROVED _____, Owner

By _____ (Title)

STATE OF WEST VIRGINIA
DEPARTMENT OF MINES
OIL AND GAS DIVISION

INSPECTOR'S WELL REPORT

Permit No. _____

Oil or Gas Well _____
(KIND)

	CASING AND TUBING	USED IN DRILLING	LEFT IN WELL	PACKERS
Company _____				
Address _____	Size			
Farm _____	16			Kind of Packer _____
Well No. _____	13			
District _____ County _____	10			Size of _____
Drilling commenced _____	8 1/4			
Drilling completed _____ Total depth _____	6 5/8			Depth set _____
Date shot _____ Depth of shot _____	5 3/16			
Initial open flow _____ /10ths Water in _____ Inch	3			Perf. top _____
Open flow after tubing _____ /10ths Merc. in _____ Inch	2			Perf. bottom _____
Volume _____ Cu. Ft.	Liners Used _____			Perf. top _____
Rock pressure _____ lbs. _____ hrs.				Perf. bottom _____
Oil _____ bbls., 1st 24 hrs.	CASING CEMENTED _____ SIZE _____ No. FT. _____ Date _____			
Fresh water _____ feet _____ feet	COAL WAS ENCOUNTERED AT _____ FEET _____ INCHES			
Salt water _____ feet _____ feet	_____ FEET _____ INCHES _____ FEET _____ INCHES			

Drillers' Names _____

Remarks:

DATE

DISTRICT WELL INSPECTOR

12/08/2023

STATE OF WEST VIRGINIA
DEPARTMENT OF MINES
OIL AND GAS DIVISION

INSPECTOR'S WELL REPORT

Permit No. _____

Oil or Gas Well _____
(KIND)

	CASING AND TUBING	USED IN DRILLING	LEFT IN WELL	PACKERS
Company _____	Size			
Address _____	16			Kind of Packer _____
Farm _____	13			
Well No. _____	10			Size of _____
District _____ County _____	8 1/4			
Drilling commenced _____	6 5/8			Depth set _____
Drilling completed _____ Total depth _____	5 3/16			
Date shot _____ Depth of shot _____	3			Perf. top _____
Initial open flow _____ /10ths Water in _____ Inch	2			Perf. bottom _____
Open flow after tubing _____ /10ths Merc. in _____ Inch	Liners Used			Perf. top _____
Volume _____ Cu. Ft.				Perf. bottom _____
Rock pressure _____ lbs. _____ hrs.	CASING CEMENTED _____ SIZE _____ No. FT. _____ Date _____			
Oil _____ bbls., 1st 24 hrs.	COAL WAS ENCOUNTERED AT _____ FEET _____ INCHES			
Fresh water _____ feet _____ feet	_____ FEET _____ INCHES _____ FEET _____ INCHES			
Salt water _____ feet _____ feet	_____ FEET _____ INCHES _____ FEET _____ INCHES			

Drillers' Names _____

Remarks: _____

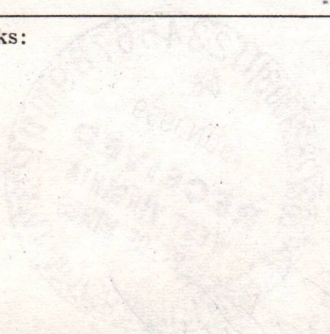

DATE

DISTRICT WELL INSPECTOR

12/08/2023

STATE OF WEST VIRGINIA
DEPARTMENT OF MINES
OIL AND GAS DIVISION

INSPECTOR'S WELL REPORT

Permit No. _____ Oil or Gas Well _____
(KIND)

	CASING AND TUBING	USED IN DRILLING	LEFT IN WELL	PACKERS
Company _____	Size _____			Kind of Packer _____
Address _____	16 _____			
Farm _____	13 _____			
Well No. _____	10 _____			Size of _____
District _____ County _____	8 1/4 _____			
Drilling commenced _____	6 5/8 _____			Depth set _____
Drilling completed _____ Total depth _____	5 3/16 _____			
Date shot _____ Depth of shot _____	3 _____			Perf. top _____
Initial open flow _____ /10ths Water in _____ Inch	2 _____			Perf. bottom _____
Open flow after tubing _____ /10ths Merc. in _____ Inch	Liners Used _____			Perf. top _____
Volume _____ Cu. Ft.				Perf. bottom _____
Rock pressure _____ lbs. _____ hrs.	CASING CEMENTED _____ SIZE _____ No. FT. _____ Date _____			
Oil _____ bbls., 1st 24 hrs.	COAL WAS ENCOUNTERED AT _____ FEET _____ INCHES			
Fresh water _____ feet _____ feet	_____ FEET _____ INCHES _____ FEET _____ INCHES			
Salt water _____ feet _____ feet	_____ FEET _____ INCHES _____ FEET _____ INCHES			

Drillers' Names _____

Remarks: _____

STATE OF WEST VIRGINIA
DEPARTMENT OF MINES
OIL AND GAS DIVISION

INSPECTOR'S WELL REPORT

Permit No. _____

Oil or Gas Well _____
(KIND)

	CASING AND TUBING	USED IN DRILLING	LEFT IN WELL	PACKERS
Company _____	Size			
Address _____	16			Kind of Packer _____
Farm _____	13			
Well No. _____	10			Size of _____
District _____ County _____	8 1/4			
Drilling commenced _____	6 5/8			Depth set _____
Drilling completed _____ Total depth _____	5 3/16			
Date shot _____ Depth of shot _____	3			Perf. top _____
Initial open flow _____ /10ths Water in _____ Inch	2			Perf. bottom _____
Open flow after tubing _____ /10ths Merc. in _____ Inch	Liners Used			Perf. top _____
Volume _____ Cu. Ft.				Perf. bottom _____
Rock pressure _____ lbs. _____ hrs.	CASING CEMENTED _____	SIZE _____	No. FT. _____	Date _____
Oil _____ bbls., 1st 24 hrs.	COAL WAS ENCOUNTERED AT _____ FEET _____ INCHES			
Fresh water _____ feet _____ feet	_____ FEET _____ INCHES _____ FEET _____ INCHES			
Salt water _____ feet _____ feet	_____ FEET _____ INCHES _____ FEET _____ INCHES			

Drillers' Names _____

Remarks: _____

DATE

DISTRICT WELL INSPECTOR

12/08/2023



STATE OF WEST VIRGINIA
DEPARTMENT OF MINES
OIL AND GAS DIVISION

NOTICE OF INTENTION TO PLUG AND ABANDON WELL

(REQUIRED BY SECTION 9, ARTICLE 4, CHAPTER 22 OF THE CODE)

To THE DEPARTMENT OF MINES,
Charleston, W. Va.

Coal Operator	B. H. Putnam, Operator
Name of Well Operator	512 Third Street Marietta, Ohio
Complete Address	May 12, 1959
Date	WELL TO BE ABANDONED
Harris District	Wood County
County	#1
Well No.	Roxie Maxey Farm
Farm	

Inspector to be notified John E. Lowther Telephone Number Niagra 4-2335
Drilling Permit No. W00-374

Gentlemen:—

The undersigned well operator is subject to abandon the above described well and will commence

the work of plugging and abandoning said well on the date inspector is notified (which date shall not be less than five days after the day on which this notice so mailed is received, or in due course should be received by the Department of Mines).

This notice is given you in order that your respective representatives may be present at the plugging and filling of said well. You are further notified that whether you are represented or not represented the undersigned will proceed on that date, or shortly thereafter, to plug and fill said well in the manner required by Section 10, Article 4, Chapter 22 of the Code and given in detail on the reverse side of this notice, in "Work Order."

This notice is being mailed by registered mail to each of you at the above addresses on the above date.

Very truly yours,

B. H. Putnam
Well Operator

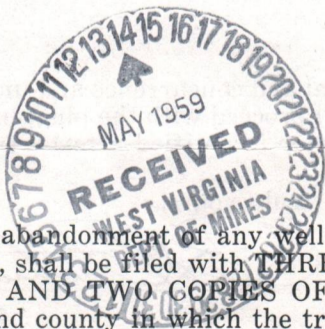

NOTE: Upon the abandonment of any well drilled prior to June 1, 1929, a plat prepared by a registered engineer, shall be filed with THREE COPIES OF APPLICATION, (OG-9) AND "WORK ORDER" AND TWO COPIES OF THE WELL RECORD, (OG-10). The map must show the district and county in which the tract of land is located, the name and acreage of same, the name or names of the owners and names of adjacent tracts and the location of the well to be abandoned, determined by survey with the courses and distances of such well from two permanent points or landmarks on said tract.

12/08/2023

NOTE: In case plugging is not commenced within four months from the date of permit, same shall expire and be of no further force or effect.

NOTE: PERMIT IS NOT TRANSFERABLE.

W00-374-P

Permit Number

PROPOSED MANNER OF PLUGGING AND FILLING WELL

(REQUIRED BY RULES AND REGULATIONS)

WEST VIRGINIA DEPARTMENT OF MINES

OIL AND GAS DIVISION

WORK ORDER

Well to be plugged and filled as follows:

Fill with non-porous material from bottom 4,129' to 4,106' the bottom of the 5 1/2" casing. 50' neat cement, 10' crushed rock and continue filling with clay to 3,946' inside 5 1/2" casing, which is cemented with 65 sacks of cement. Rip and pull the 5 1/2" casing. Set permanent bridge at 1,909' - 50' below the Berea Sand. Three bags of neat cement and crushed rock, fill with clay to 1,715' 10' of neat cement and crushed rock on top thereof, filling the hole completely below the 8 5/8" Pull 8 5/8" and set permanent bridge at 1,050' 20' in Injun Dand. Three Sacks neat cement and crushed stone. Fill with clay to 960' the 10 3/4" casing point. 10 3/4" previously pulled. Three sacks of neat cement on top thereof sealing off all salt water. The 10 3/4" has been pulled prior to this. Will set bridge at 285' and three sacks neat cement and crushed rock and fill to surface with clay. Will erect marker as described in Rule 18-1931 regulations.

Pull 8 inch casing as balance of hole is filled and plugged. This well has 7" instead of 5 1/2" which will be pulled

To the Department of Mines
Coal Owner or Operator,
Lease or Property Owner.

Gentlemen:

This "work order" is submitted for your approval and concurrence and unless notified of your disapproval or non-concurrence, the undersigned will proceed with the plugging and filling of said well in the above described manner on the date inspector is notified after permit is issued.

Very truly yours,

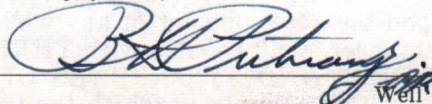
Well Operator

No objections have been filed by the coal owner or coal operator, or any available adjacent lease or property owners or interposed by the Department of Mines to the manner herein described for the plugging and filling of the well above mentioned. Therefore, the same is hereby approved this

14 day of MAY, 1959.

12/08/2023

DEPARTMENT OF MINES
Oil and Gas Division

By:



NOTE: This "work order" shall be filed in triplicate, one copy for the files of the Department of Mines; one to be approved or corrected and returned to the well operator as his authority for plugging said well; and one for the well inspector.

STATE OF WEST VIRGINIA
DEPARTMENT OF MINES
OIL AND GAS DIVISION

AFFIDAVIT OF PLUGGING AND FILLING WELL

AFFIDAVIT SHOULD BE MADE IN TRIPLICATE, ONE COPY MAILED TO THE DEPARTMENT, ONE COPY TO BE RETAINED BY THE WELL OPERATOR AND THE THIRD COPY (AND EXTRA COPIES IF REQUIRED) SHOULD BE MAILED TO EACH COAL OPERATOR AT THEIR RESPECTIVE ADDRESSES.

COAL OPERATOR OR OWNER	B. H. Putnam, Operator
ADDRESS	512 Third Street Marietta, Ohio
COAL OPERATOR OR OWNER	June 15 19 59
ADDRESS	WELL AND LOCATION
LEASE OR PROPERTY OWNER	Harris District
ADDRESS	Wood County
	Well No. #1
	Roxie Maxey Farm

STATE INSPECTOR SUPERVISING PLUGGING

OHIO AFFIDAVIT
STATE OF ~~WEST VIRGINIA~~ }
County of WASHINGTON } ss:
L. L. Munday and ~~Henry Coccox~~ Everett Coulson
being first duly sworn according to law depose and say that they are experienced in the work of plugging and filling oil and gas wells and were employed by B. H. Putnam, Jr., well operator, and participated in the work of plugging and filling the above well, that said work was commenced on the 5 day of May, 19 59, and that the well was plugged and filled in the following manner:

SAND OR ZONE RECORD	FILLING MATERIAL	PLUGS USED	CASING
FORMATION		SIZE & KIND	CSG LEFT IN
4,236' to 4,129' to 4,029'	Fill with gravel Drove Lead Plug and two bags of cement thereon	2222 2222 7"	
2,415'	Rip and Pull 7" casing		1,531'
1,909'	Set Permanent Bridge		
1,909' to 1,509'	Fill with Clayand rock Pull	8 5/8"	1,531' None
200'	Set bridge at 200' below the surface and fill with clay to surface add four bags of cement.		
	Set Marker		
COAL SEAMS (Due to Salt water condition plugging was completed in this manner by permission of inspector)		DESCRIPTION OF MONUMENT	
(NAME)		Pipe 7" x 6' marker, marked Roxie Maxey #	
(NAME)		B. H. Putnam, Operator	
(NAME)			
(NAME)			

and that the work of plugging and filling said well was completed on the 6 day of June, 1959.

And further deponents saith not.

Sworn to and subscribed before me this 16 day of June, 19 59

My commission expires:
May 28, 1960

L L Munday
Everett Coulson 12/08/2023
[Signature]
Notary Public.
Permit No. WOO-374-P

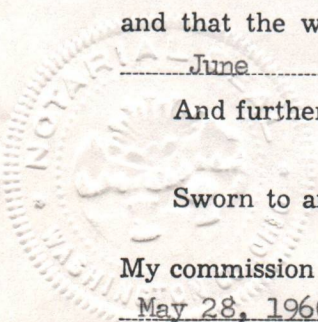

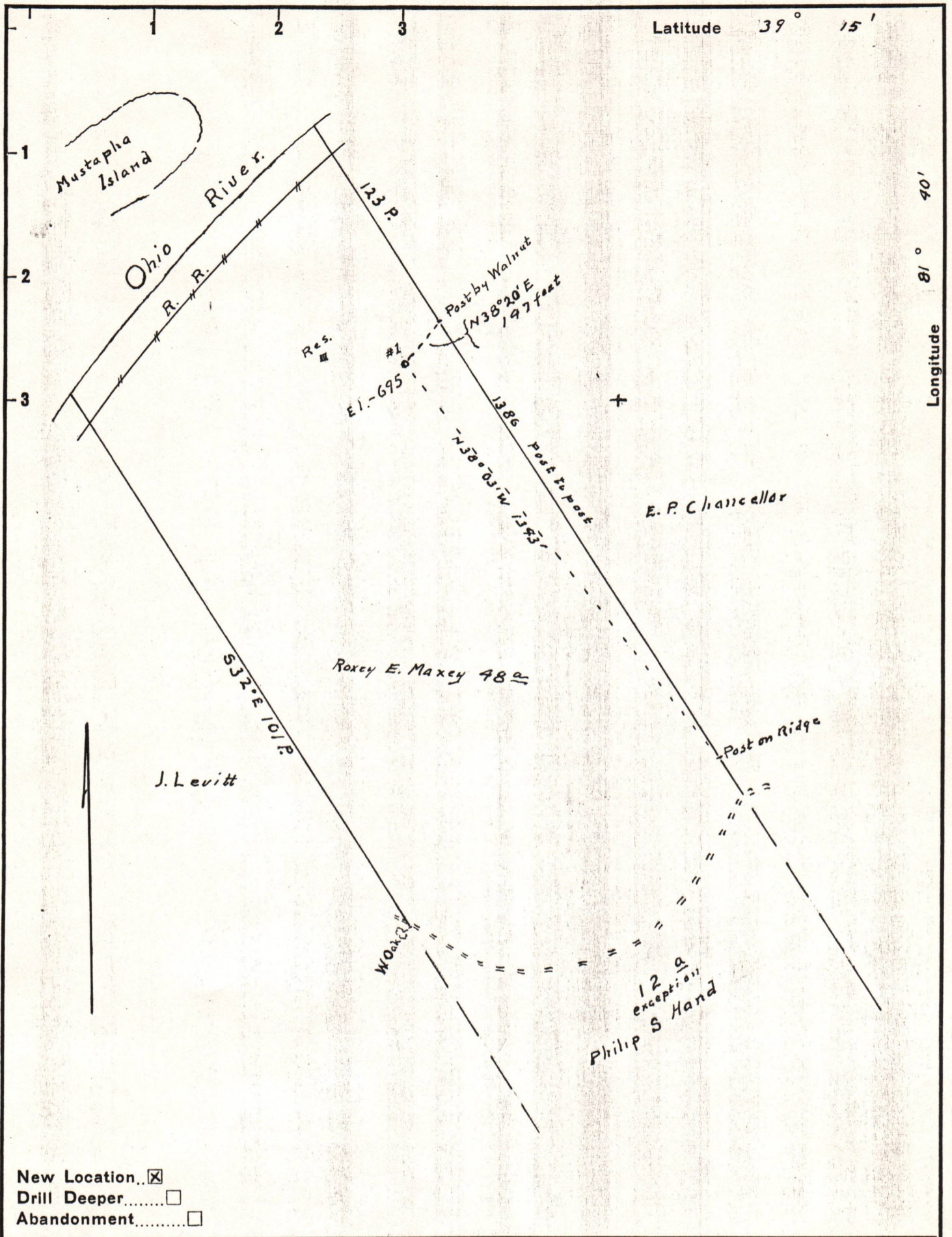

Company B.H. Putnam Operator

Address 1st Nat Bank, Marietta, Ohio

Farm Roxey E. Maxey

Tract _____ Acres 48 Lease No. _____

Well (Farm) No. 1 Serial No. _____

Elevation (Spirit Level) 695'

Quadrangle Belleville

County Wood District Harris

Engineer Robert R. Anderson
by O. Meredith

Engineer's Registration No. 296

File No. _____ Drawing No. _____

Date July 15 52 Scale 1 in = 20 Poles

STATE OF WEST VIRGINIA
DEPARTMENT OF MINES
OIL AND GAS DIVISION
CHARLESTON

WELL LOCATION MAP
FILE NO. W00-374 12/08/2023

+ Denotes location of well on United States Topographic Maps, scale 1 to 62,500, latitude and longitude lines being represented by border lines as shown.

- Denotes one inch spaces on border line of original tracing.