



STATE OF WEST VIRGINIA
DEPARTMENT OF MINES
OIL AND GAS DIVISION

Belleville

WELL RECORD

Permit No. Woo-350

Oil or Gas Well Gas
(KIND)

Company Layfield & Moats
 Address Box 1045, Parkersburg, W. Va.
 Farm J.M. Swain Acres 48
 Location (waters) Ohio River
 Well No. 1 Elev. 610
 District Harris County Wood
 The surface of tract is owned in fee by J.M. Swain
 Address Belleville, W. Va.
 Mineral rights are owned by Same
 Address _____
 Drilling commenced April 7, 1951
 Drilling completed May 26, 1951
 Date Shot May 26 From 1866 To 1896
 With 2000 lbs Powder
 Open Flow /10ths Water in _____ Inch
/10ths Merc. in _____ Inch
 Volume 548,000 Cu. Ft.
 Rock Pressure 750 lbs. 48 hrs.
 Oil _____ bbls., 1st 24 hrs.
 Fresh water _____ feet _____ feet
 Salt water _____ feet _____ feet

Casing and Tubing	Used in Drilling	Left in Well	Packers
Size			
16			Kind of Packer _____
13			
10	54	54	Size of _____
8 1/4	452	0	
6 1/2	811	811	Depth set _____
5 3/16	1556	1556	
3			Perf. top _____
2			Perf. bottom _____
Liners Used			Perf. top _____
			Perf. bottom _____

CASING CEMENTED _____ SIZE _____ No. Ft. _____ Date _____
 COAL WAS ENCOUNTERED AT None FEET _____ INCHES
 _____ FEET _____ INCHES FEET _____ INCHES
 _____ FEET _____ INCHES FEET _____ INCHES

Formation	Color	Hard or Soft	Top	Bottom	Oil, Gas or Water	Depth Found	Remarks
Slate	Grey	Soft	440	485			
Shale	Red	Soft	485	578			
Slate	Grey	Soft	578	590			
Shale	Red	Soft	590	671			
Sand	White	Hard	671	691			
Slate	Grey	Soft	691	730			
Sand	White	Hard	730	809			
Shale	Red	Soft	809	811			
Sand	White	Hard	811	870	Water	800	
Slate	Grey	Soft	870	942			
Slate & Shells			942	1182			
Sand	White	Hard	1182	1290			
Slate & Shells			1290	1360			
Sand	White	Hard	1360	1516	Water (hole full)	1390	
Slate	Grey	Soft	1516	1531			
Sand	White	Hard	1531	1540			
Slate	Grey	Soft	1540	1555			
Lime	Grey	Hard	1555	1585			
Slate & Shells			1585	1848			
Shale	Brown	Soft	1848	1866			
Sand (Berea Grit)		Hard	1866	1870	Gas	1866	
Slate & Shells			1870	1902			
		Total Depth		1902			

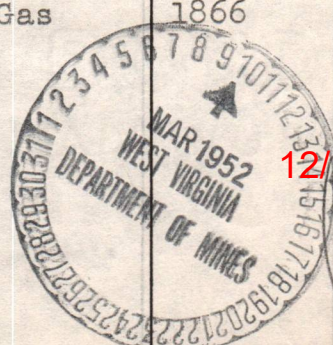

12/15/2023

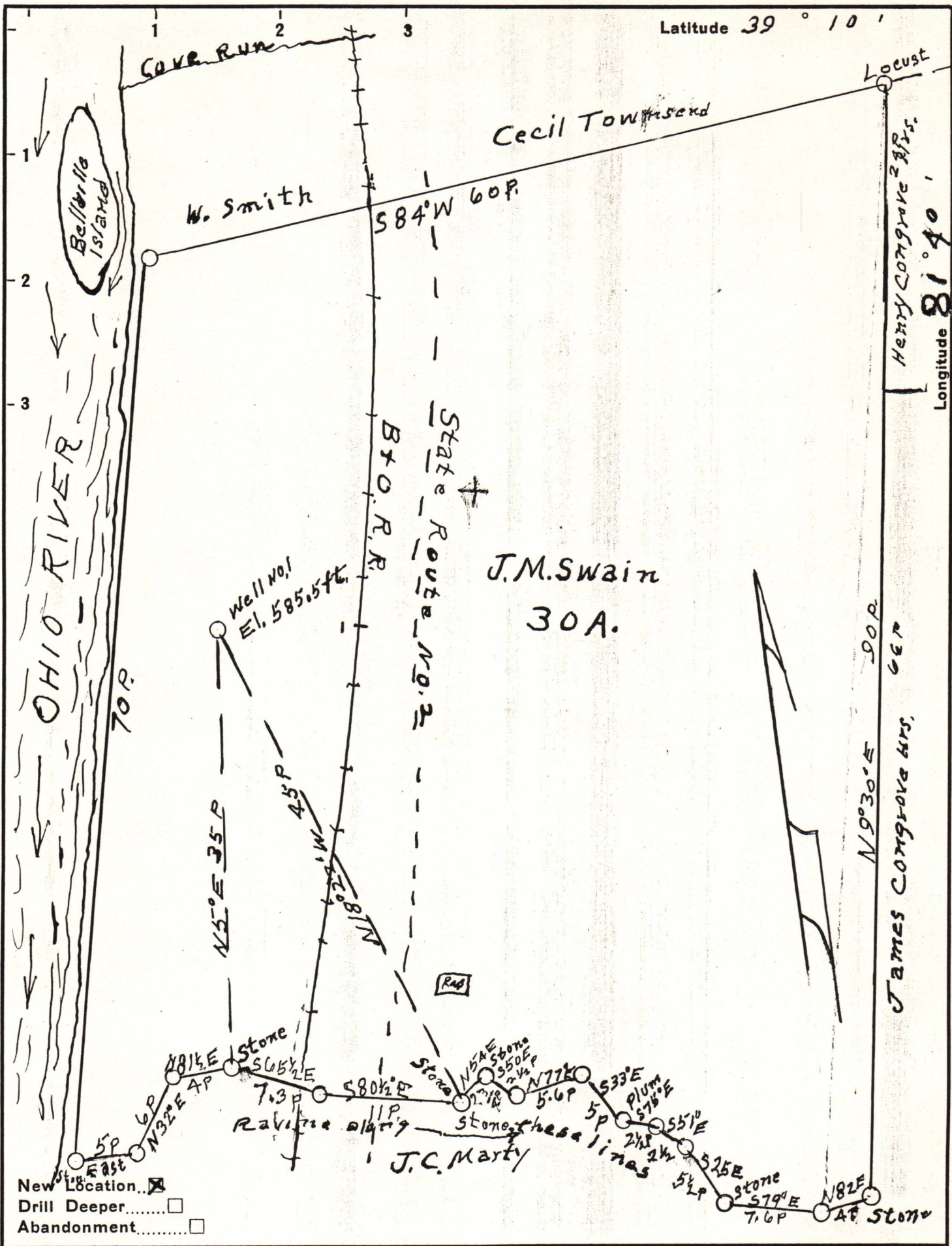

Company Dennis Layfield
 Address Parkersburg, W.Va.
 Farm J.M. Swain
 Tract _____ Acres 30 Lease No. _____
 Well (Farm) No. 1 Serial No. _____
 Elevation (Spirit Level) 585.5 ft.
 Quadrangle Belleville
 County Wood District Harris
 Engineer Robert R. Anderson
 By J.E. Anderson
 Engineer's Registration No. 296
 File No. _____ Drawing No. _____
 Date Jan 15 1951 Scale 1 in = 10 Poles

STATE OF WEST VIRGINIA
 DEPARTMENT OF MINES
 OIL AND GAS DIVISION
 CHARLESTON

WELL LOCATION MAP

FILE NO. W00-350

12/15/2023

+ Denotes location of well on United States Topographic Maps, scale 1 to 62,500, latitude and longitude lines being represented by border lines as shown.

- Denotes one inch spaces on border line of original tracing.