

A-1



STATE OF WEST VIRGINIA
DEPARTMENT OF MINES
OIL AND GAS DIVISION

NOTICE OF PROPOSED LOCATION OF OIL AND GAS WELL

To THE DEPARTMENT OF MINES,
Charleston, W. Va.

Not Operated
COAL OPERATOR OR COAL OWNER

ADDRESS

COAL OPERATOR OR COAL OWNER

ADDRESS

Godfrey L. Cabot, Inc.
OWNER OF MINERAL RIGHTS

900 Union Building, Charleston, W. Va.
ADDRESS

Godfrey L. Cabot, Inc.
NAME OF WELL OPERATOR

900 Union Building, Charleston, W. Va.
COMPLETE ADDRESS

December 16, 19 50

PROPOSED LOCATION

Steele District

Wood County
39.10
91.30

Well No. 1 Serial 1345

Sarah E. Singledecker Farm

GENTLEMEN:

The undersigned well operator is entitled to drill upon the above named farm or tract of land for oil and gas, having fee title thereto, (or as the case may be) under grant or lease dated July 15, 1906, made by George Singledecker & Wife, to Godfrey L. Cabot, Inc., and recorded on the 11th day of August, 1906, in the office of the County Clerk for said County in Book 141, page 223.

The enclosed plat was prepared by a competent engineer and shows the proposed location of a well to be drilled for oil and gas by the undersigned well operator on the farm and in the Magisterial District and County above named, determined by survey and courses and distances from two permanent points, or land marks.

The undersigned well operator is informed and believes there are no coal operators operating beds of coal beneath said farm or tract of land on which said well is located, or within 500 feet of the boundaries of the same, who have mapped their workings and filed their maps as required by law, excepting the coal operators or coal owners (if any) above named as addressees.

The above named coal operators or coal owners (if any) are notified that any objections they may desire to make to such proposed location, or which they are required to make by Section 3 of said Code, if the drilling of a well at said proposed location will cause a dangerous condition in or about their respective coal mines, must be received by, or filed with the Department of Mines within ten* days from the receipt of a copy of this notice and accompanying plat by said Department. Said coal operators are further notified that forms for use in making such objections will be furnished to them by the Department of Mines promptly on request and that all such objections must set forth as definitely as is reasonably possible the ground or grounds on which such objections are based and indicate the direction and distance the proposed location should be moved to overcome same.

(The next paragraph is to be completed only in Department's copy.)

Copies of this notice and the enclosed plat were mailed by registered mail, or delivered to the above named coal operators or coal owners at their above shown respective address _____ day _____ before, or on the same day with the mailing or delivery of this copy to the Department of Mines at Charleston, West Virginia.

Very truly yours,

Godfrey L. Cabot, Inc.
WELL OPERATOR

900 Union Building
STREET

Charleston
CITY OR TOWN

West Virginia
STATE

12/15/2023

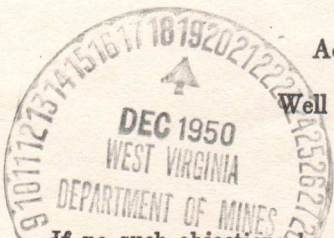

Address of Well Operator }

*Section 3 . . . If no such objections be filed or be found by the department of mines, within said period of ten days from the receipt of said notice and plat by the department of mines, to said proposed location, the department shall forthwith issue to the well operator a drilling permit reciting the filing of such plat, that no objections have been made by the coal operators to the location, or found thereto by the department, and that the same is approved and the well operator authorized to proceed to drill at said location.

349

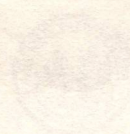

DEPARTMENT OF THE INTERIOR
BUREAU OF LAND MANAGEMENT

NOTICE OF PROPOSED LOCATION OF OIL AND GAS WELL

To the Interested Parties:
This notice is published in accordance with the provisions of the National Oil and Gas Well Control Act, 30 U.S.C. 251, et seq., and the regulations thereunder, 43 CFR 31.101-1, et seq., to advise the public of the proposed location of an oil and gas well on the public lands of the United States.

The proposed well is located on the public lands of the United States, in the State of Wyoming, in the County of _____, and is situated on the _____ section, _____ township, _____ range, _____ meridian.

The proposed well is to be drilled by _____, a corporation organized under the laws of the State of Wyoming, and is owned by _____, a corporation organized under the laws of the State of Wyoming.

The proposed well is to be drilled to a depth of _____ feet, and is to be used for the production of oil and gas. The proposed well is to be drilled in accordance with the provisions of the National Oil and Gas Well Control Act, 30 U.S.C. 251, et seq., and the regulations thereunder, 43 CFR 31.101-1, et seq.

The proposed well is to be drilled in accordance with the provisions of the National Oil and Gas Well Control Act, 30 U.S.C. 251, et seq., and the regulations thereunder, 43 CFR 31.101-1, et seq. The proposed well is to be drilled in accordance with the provisions of the National Oil and Gas Well Control Act, 30 U.S.C. 251, et seq., and the regulations thereunder, 43 CFR 31.101-1, et seq.

The proposed well is to be drilled in accordance with the provisions of the National Oil and Gas Well Control Act, 30 U.S.C. 251, et seq., and the regulations thereunder, 43 CFR 31.101-1, et seq. The proposed well is to be drilled in accordance with the provisions of the National Oil and Gas Well Control Act, 30 U.S.C. 251, et seq., and the regulations thereunder, 43 CFR 31.101-1, et seq.

The proposed well is to be drilled in accordance with the provisions of the National Oil and Gas Well Control Act, 30 U.S.C. 251, et seq., and the regulations thereunder, 43 CFR 31.101-1, et seq. The proposed well is to be drilled in accordance with the provisions of the National Oil and Gas Well Control Act, 30 U.S.C. 251, et seq., and the regulations thereunder, 43 CFR 31.101-1, et seq.

The proposed well is to be drilled in accordance with the provisions of the National Oil and Gas Well Control Act, 30 U.S.C. 251, et seq., and the regulations thereunder, 43 CFR 31.101-1, et seq. The proposed well is to be drilled in accordance with the provisions of the National Oil and Gas Well Control Act, 30 U.S.C. 251, et seq., and the regulations thereunder, 43 CFR 31.101-1, et seq.

The proposed well is to be drilled in accordance with the provisions of the National Oil and Gas Well Control Act, 30 U.S.C. 251, et seq., and the regulations thereunder, 43 CFR 31.101-1, et seq. The proposed well is to be drilled in accordance with the provisions of the National Oil and Gas Well Control Act, 30 U.S.C. 251, et seq., and the regulations thereunder, 43 CFR 31.101-1, et seq.

The proposed well is to be drilled in accordance with the provisions of the National Oil and Gas Well Control Act, 30 U.S.C. 251, et seq., and the regulations thereunder, 43 CFR 31.101-1, et seq. The proposed well is to be drilled in accordance with the provisions of the National Oil and Gas Well Control Act, 30 U.S.C. 251, et seq., and the regulations thereunder, 43 CFR 31.101-1, et seq.

The proposed well is to be drilled in accordance with the provisions of the National Oil and Gas Well Control Act, 30 U.S.C. 251, et seq., and the regulations thereunder, 43 CFR 31.101-1, et seq. The proposed well is to be drilled in accordance with the provisions of the National Oil and Gas Well Control Act, 30 U.S.C. 251, et seq., and the regulations thereunder, 43 CFR 31.101-1, et seq.

The proposed well is to be drilled in accordance with the provisions of the National Oil and Gas Well Control Act, 30 U.S.C. 251, et seq., and the regulations thereunder, 43 CFR 31.101-1, et seq. The proposed well is to be drilled in accordance with the provisions of the National Oil and Gas Well Control Act, 30 U.S.C. 251, et seq., and the regulations thereunder, 43 CFR 31.101-1, et seq.

12/15/2023

A.P.
GODFREY L. CABOT, INC.

NATURAL GAS

900 UNION BUILDING

CABOT

BOX 1473 CHARLESTON 25, W. VA.

WILLARD P. SMITH
Eastern Production Mgr.*West Virginia Division*
HARVEY J. SIMMONS, Jr.
General Superintendent

December 18, 1950

West Virginia Department of Mines
Oil and Gas Division
Charleston, West Virginia

Gentlemen:

We enclose one copy of notice of proposed location
of each of the following wells:Sarah E. Singledecker #1, Serial 1345,
located in Steele District, Wood County,
West Virginia.H. H. Kessel #1, Serial 1346, located
in Union District, Putnam County, West
Virginia.We are sending you under separate cover tracings
and location plats showing the positions of the above wells.

Yours very truly,

RB/f

cc: Ballard, w/ copy of notice & plat.
Field, w/ " " " "

12/15/2023

GODFREY L. CABOT, INC.

NATURAL GAS

CABOT

CHARLESTON 22, W. VA.

BOX 1473

200 UNION BUILDING

WILLARD P. SMITH
District Production Mgr.
West Virginia Division
HARVEY J. SIMMONS, Jr.
General Superintendent

December 18, 1950

West Virginia Department of Mines
Oil and Gas Division
Charleston, West Virginia

Enclosure

We enclose one copy of notice of proposed location
of each of the following wells:

Sam E. Stanglecker #1, Serial 1345,
located in Steele District, Wood County,
West Virginia.

H. M. Kessel #1, Serial 1346, located
in Union District, Putnam County, West
Virginia.

We are sending you under separate cover tracings
and location plats showing the positions of the above wells.

Yours very truly,

RBV

cc: ELM, w/ copy of notice & plat.
" " " " " " " " " " " "



12/15/2023

A-11

December 29, 1950

Godfrey L. Cabot, Inc.
900 Union Building
Charleston, West Virginia

Gentlemen:

Enclosed is permit WOC-349 to drill Well
No. 1-Sr-1345 on the Sarah E. Singledenker Farm,
Steele District, Wood County.

Very truly yours,

Administrative Assistant
OIL AND GAS DIVISION

CNH:K
Encl-2

CC: Inspector O. C. Howard

12/15/2023

GODFREY L. CABOT, INC.

Bellwell

Woo-349

WELL RECORD *25*

SERIAL NO. **1345** OPERATING DISTRICT **Wirt** Map Square Lot No. Warrant No. **64-39**

FARM **S.E. Singledecker** No. **1** LEASE NO.

COUNTY **Wood** TAX DISTRICT **Steele** STATE **W. Va.**

DRILLING COMMENCED **2-8-51** DRILLING COMPLETED **5-28-51**

CONTRACTOR **Company tools** ADDRESS

ROCK PRESSURE RECORD			PRODUCING SAND RECORD			DRY HOLE	
Sand	lbs., in	hrs.	Sand, from	to	Init. Prod.	M. C. F. Gas	
Sand	lbs., in	hrs.	Sand, from	to	Init. Prod.	M. C. F. Gas	
Sand	lbs., in	hrs.	Sand, from	to	Init. Prod.	M. C. F. Gas	

OPEN FLOW Time, Condition: **DRY HOLE**

10ths	Water Mercury in	inch opening	SIZE	WEIGHT	USED IN DRILLING	LEFT IN WELL	HOW CASING SET
			13"		312		
			10"		1440		
	M. C. F.	Line Pressure	8"		2091		
	Bbls. Oil	in 24 Hours	7"		4971		

24 HOUR PRODUCTION TEST AFTER TUBING

TUBED AND SHUT IN Date

Packer, Size Kind

Set, Depth Size Anchor

Perf. Top Bottom

Perf. Top Bottom

ELEVATION: **886**

SHOOTING RECORD **NOT SHOT**

Acid Shot with from to Date

Gauge Before { Acid Shot } Gauge Min. Hrs. After { Acid Shot }

FORMATION	COLOR	TOP	BOTTOM	STEEL LINE MEASUREMENTS	HARD OR SOFT	OIL, GAS OR WATER	DEPTH FOUND	REMARKS
Clay		0	10					
Red Rock		10	28					
Sand		28	44					
Red Rock		44	80					
Sand		80	90					
Slate		90	105					
Red Rock		105	150					
Slate		150	180					
Red Rock		180	230					
Slate		230	250					
Red Rock		250	320					
Slate & Shells		320	350					
Red Rock		350	370					
Slate & Shell		370	440					
Red Rock		440	515					
Lime		515	550					
Red Rock		550	570					
Lime		570	605					
Sand		605	636					
Slate		636	665					
Sand		665	740					
Slate		740	810					
Lime		810	885					
Sand		885	930			Water	900	1/2 bailer per hr.
Red Rock		930	994					
Slate & Shell		994	1015					
Red Rock		1015	1075					
Slate & Shell		1075	1112					
Sand		1112	1150					
Slate		1150	1170					
Sand		1170	1275			Water	1193	
Lime		1275	1322					
Slate		1322	1330			Water	1322	8 bailers per hr.
Lime		1330	1412					
Slate & Shell		1412	1425					
Sand		1425	1515					

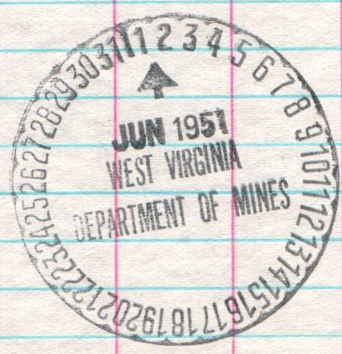

12/15/2023

1345

S.E. Singledecker

NO. 1

OPERATING DIST. Wirt TOWNSHIP

MAP SQUARE LOT NO. WARRANT NO.

64-39

25

FORMATION	COLOR	TOP	BOTTOM	STEEL LINE MEASUREMENTS	HARD OR SOFT	OIL, GAS OR WATER	DEPTH FOUND	REMARKS
Slate & Shell		1515	1650					
Sand		1650	2070			Water	1715	Hole full.
Lime		2070	2125					
Slate & Shell		2125	4050					
Brown Shale		4050	4260					
Slate & Shell		4260	4600					
Brown Shale		4600	4825			Gas	4730	Small show.
Black Shale		4825	4949					
Corniferous		4949	5084					
Oriskany		5084	5124					
Lime		5124	5130					
Sand		5130	5144					
Lime		5144						
TOTAL DEPTH			5160					

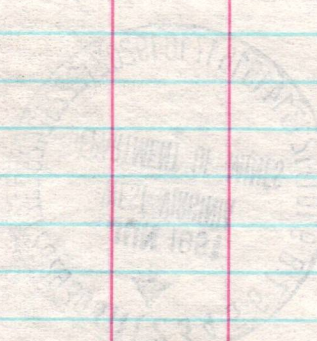

12/15/2023

DATE _____

APPROVED _____

FOREMAN

STATE OF WEST VIRGINIA
DEPARTMENT OF MINES
OIL AND GAS DIVISION

INSPECTOR'S WELL REPORT

Permit No. _____

Oil or Gas Well _____
(KIND)

	CASING AND TUBING	USED IN DRILLING	LEFT IN WELL	PACKERS
Company _____	Size			
Address _____	16			Kind of Packer _____
Farm _____	13			
Well No. _____	10			Size of _____
District _____ County _____	8 1/4			
Drilling commenced _____	6 5/8			Depth set _____
Drilling completed _____ Total depth _____	5 3/16			
Date shot _____ Depth of shot _____	3			Perf. top _____
Initial open flow _____ /10ths Water in _____ Inch	2			Perf. bottom _____
Open flow after tubing _____ /10ths Merc. in _____ Inch	Liners Used			Perf. top _____
Volume _____ Cu. Ft.				Perf. bottom _____
Rock pressure _____ lbs. _____ hrs.	CASING CEMENTED _____ SIZE _____ No. FT. _____ Date _____			
Oil _____ bbls., 1st 24 hrs.	COAL WAS ENCOUNTERED AT _____ FEET _____ INCHES			
Fresh water _____ feet _____ feet	_____ FEET _____ INCHES _____ FEET _____ INCHES			
Salt water _____ feet _____ feet	_____ FEET _____ INCHES _____ FEET _____ INCHES			

Drillers' Names _____

Remarks: _____

DATE

DISTRICT WELL INSPECTOR

12/15/2023

STATE OF WEST VIRGINIA
DEPARTMENT OF MINES
OIL AND GAS DIVISION

INSPECTOR'S WELL REPORT

Permit No. _____

Oil or Gas Well _____
(KIND)

	CASING AND TUBING	USED IN DRILLING	LEFT IN WELL	PACKERS
Company _____				
Address _____	Size			
Farm _____	16			Kind of Packer _____
Well No. _____	13			
District _____ County _____	10			Size of _____
Drilling commenced _____	8¼			
Drilling completed _____ Total depth _____	6½			Depth set _____
Date shot _____ Depth of shot _____	5 3/16			
Initial open flow _____ /10ths Water in _____ Inch	3			Perf. top _____
Open flow after tubing _____ /10ths Merc. in _____ Inch	2			Perf. bottom _____
Volume _____ Cu. Ft.	Liners Used _____			Perf. top _____
Rock pressure _____ lbs. _____ hrs.				Perf. bottom _____
Oil _____ bbls., 1st 24 hrs.	CASING CEMENTED _____ SIZE _____ No. FT. _____ Date _____			
Fresh water _____ feet _____ feet	COAL WAS ENCOUNTERED AT _____ FEET _____ INCHES			
Salt water _____ feet _____ feet	_____ FEET _____ INCHES	_____ FEET _____ INCHES	_____ FEET _____ INCHES	_____ FEET _____ INCHES

Drillers' Names _____

Remarks:

DATE

DISTRICT WELL INSPECTOR

12/15/2023



STATE OF WEST VIRGINIA
DEPARTMENT OF MINES
OIL AND GAS DIVISION

NOTICE OF INTENTION TO PLUG AND ABANDON WELL

(REQUIRED BY SECTION 9, ARTICLE 4, CHAPTER 22 OF THE CODE)

To THE DEPARTMENT OF MINES,
Charleston, W. Va.

Not operated.	Godfrey L. Cabot, Inc.
Coal Operator or Coal Owner	Name of Well Operator
	900 Union Building
	Charleston, W. Va.
Address	Complete Address
	June 1 1951
Coal Operator or Coal Owner	WELL TO BE ABANDONED
Address	Steele District
	Wood County
Godfrey L. Cabot, Inc.	Well No. 1, Serial 1345
Lease or Property Owner	S. E. Singledecker Farm
900 Union Building	
Charleston, W. Va.	
Address	

NOTIFY INSPECTOR O. C. HOWARD - GRANTSVILLE - TELEPHONE 108
24 HOURS IN ADVANCE OF PLUGGING DATE

Gentlemen:—

The undersigned well operator is about to abandon the above described well and will commence

the work of plugging and abandoning said well on the 7th day of June, 1951, (which date shall not be less than five days after the day on which this notice so mailed is received, or in due course should be received by the Department of Mines.)

This notice is given you in order that your respective representatives may be present at the plugging and filling of said well. You are further notified that whether you are represented or not represented the undersigned will proceed on that date, or shortly thereafter, to plug and fill said well in the manner required by Section 10, Article 4, Chapter 22 of the Code and given in detail on the reverse side of this notice, in "Work Order."

This notice is being mailed by registered mail to each of you at the above addresses on the above date.

Very truly yours,

GODFREY L. CABOT, INC.

Well Operator.

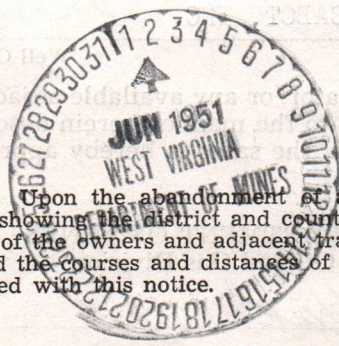

12/15/2023

NOTE: Upon the abandonment of all wells drilled prior to June 1, 1929, a plat prepared by a competent engineer, showing the district and county in which the tract of land is located, the name and acreage of same, the names of the owners and adjacent tracts, and the location of the about to be abandoned well, determined by survey, and the courses and distances of such well from two permanent points or landmarks on said tract, shall be submitted with this notice.

(Over)

WOO 349 P PERMIT NUMBER

PROPOSED MANNER OF PLUGGING AND FILLING WELL

(REQUIRED BY RULES AND REGULATIONS)

WEST VIRGINIA DEPARTMENT OF MINES

OIL AND GAS DIVISION

WORK ORDER

Well to be plugged and filled as follows:

1. Fill with clay from T.D. to 5064, 20' above Oriskany sand.
2. Run 10' cement plug (5' of crushed stone on top of cement).
3. Pull 7" casing.
4. Set permanent bridge with top of bridge at 4825.
5. Test shale gas production.
6. If not enough gas present to produce, set bridge at 2140.
7. Run 10' cement plug (5' of crushed stone on top of cement).
8. Pull 8" casing.
9. Fill with clay to 1625.
10. Run 10' cement plug.
11. Pull 10" casing.
12. Set bridge at 1240.
13. Fill with clay to 1160.
14. Run 10' cement plug.
15. Set bridge at 340.
16. Run 10' cement plug.
17. Pull 13" casing.
18. Fill with clay to surface.
19. Run cement plug.
20. Erect suitable monument as prescribed by law.

To the Department of Mines
Coal Owner or Operator,
Lease or Property Owner.

Gentlemen:

This "work order" is submitted for your approval and concurrence and unless notified of your disapproval or non-concurrence, the undersigned will proceed with the plugging and filling of said well in the above described manner on the date stated in the notice of intention to plug and abandon the said well on opposite side of this sheet.

Very truly yours,

GODFREY L. CABOT, INC.

Well Operator.

No objections have been filed by the coal owner or coal operator, or any available adjacent lease or property owners or interposed by the Department of Mines to the manner herein described for the plugging and filling of the well above mentioned. Therefore, the same is hereby approved this

12/15/2023

4th day of June, 1951, 19

DEPARTMENT OF MINES
Oil and Gas Division

By: *C. Hall*

NOTE: This "work order" shall be filed in triplicate, one copy for the files of the Department of Mines; one to be approved or corrected and returned to the well operator as his authority for plugging said well; and one for the well inspector.

B-10

FORM OG-8

STATE OF WEST VIRGINIA
DEPARTMENT OF MINES
OIL AND GAS DIVISION

AFFIDAVIT OF PLUGGING AND FILLING WELL

AFFIDAVIT SHOULD BE MADE IN TRIPPLICATE, ONE COPY MAILED TO THE DEPARTMENT, ONE COPY TO BE RETAINED BY THE WELL OPERATOR AND THE THIRD COPY (AND EXTRA COPIES IF REQUIRED) SHOULD BE MAILED TO EACH COAL OPERATOR AT THEIR RESPECTIVE ADDRESSES.

<u>Not operated</u>	<u>Godfrey L. Cabot, Inc.</u>
COAL OPERATOR OR OWNER	NAME OF WELL OPERATOR
ADDRESS	<u>900 Union Building, Charleston, W. Va.</u>
COAL OPERATOR OR OWNER	COMPLETE ADDRESS
ADDRESS	<u>July 3, 1951</u>
LEASE OR PROPERTY OWNER	WELL AND LOCATION
ADDRESS	<u>Steele</u> District
	<u>Wood</u> County
	Well No. <u>1</u> , Serial # <u>1345</u>
	<u>S. E. Singledecker</u> Farm

STATE INSPECTOR SUPERVISING PLUGGING O. C. Howard, Grantsville, W. Va.

AFFIDAVIT

STATE OF WEST VIRGINIA,
County of Calhoun } SS:

Rex J. Snider and Tony H. Snider
being first duly sworn according to law depose and say that they are experienced in the work of plugging and filling oil and gas wells and were employed by Godfrey L. Cabot, Inc., well operator, and participated in the work of plugging and filling the above well, that said work was commenced on the 7th day of June, 19 51, and that the well was plugged and filled in the following manner:

SAND OR ZONE RECORD FORMATION	FILLING MATERIAL			PLUGS USED SIZE & KIND	CASING	
	CONTENT	FROM	TO		CSG PULLED	CSG LEFT IN
	Clay	5160	5064			
		5064	5049	10' Cement &	5' Crushed Stone	
	Bridge @	4825			4971'	0 7"
		Test Shale gas and				
	Bridge @	2140				
		2140	2125	10' Cement &	5' Crushed Stone	
	Clay	2125	1625		2091'	0 8 5/8"
		1625	1610	10' Cement &	5' Crushed Stone	
	Bridge	1240			1440'	0 10 3/4"
	Clay	1240	1160			
				10' Cement		
	Bridge	340		10' Cement		
	Clay	330	Surface		312'	0 13 3/8"
				DESCRIPTION OF MONUMENT		
(NAME)				10" x 2 1/2' Concrete marker - bronze		
(NAME)				plate inserted in top with Company		
(NAME)				name, ser. no. of well, farm name and		
(NAME)				number, elevation and date abandoned.		



and that the work of plugging and filling said well was completed on the 25th day of June, 19 51.

And further deponents saith not.

Sworn to and subscribed before me this 6th day of July, 19 51.

Rex Snider
Tony H. Snider 12/15/2023
Oltho Laines

My commission expires:
November 6, 1951

Notary Public.
Permit No. Woo-349-P

RECEIVED
JULY 3 1933

Colony I. Corp., Inc.

Not Operated

300 Union Building, Charleston, W. Va.

July 3, 1933

Chicago

J. S. Sibley

W. S. Sibley

W. S. Sibley, Louisville, W. Va.

ATTEST

W. S. Sibley, President

Colman

W. S. Sibley

W. S. Sibley

Colony I. Corp., Inc.

June 31

Clay	800	800	10' Cement	4' Gravel Stone
Bridge	200	200		
Bridge	150	150	10' Cement	3' Gravel Stone
Clay	125	125	10' Cement	2' Gravel Stone
Bridge	120	120		
Clay	110	110	10' Cement	
Bridge	90	90	10' Cement	
Clay	80	80		

These figures are for work done in 1933. They do not include work done in 1932 or 1931.

12/15/2023

100-33-2

November 3, 1933

E-6

GODFREY L. CABOT, INC.

NATURAL GAS

900 UNION BUILDING



BOX 1473

CHARLESTON 25, W. VA.

WILLARD P. SMITH
Eastern Production Mgr.
West Virginia Division
HARVEY J. SIMMONS, Jr.
General Superintendent

June 1, 1951

West Virginia Department of Mines
Oil and Gas Division
Charleston, West Virginia

Gentlemen:

We enclose three copies of notice of intention to plug and abandon our S. E. Singledecker well #1, serial 1345, located in Steele District, Wood County, West Virginia, Drilling Permit W00-349.

We also enclose two copies of the record of the above well.

Yours very truly,

J. Z. Walker

c
enc



GODFREY L. CABOT, INC.

NATURAL GAS

CHARLESTON 22, W. VA.

BOX 1473

CABOT

900 UNION BUILDING

June 1, 1951

WILLARD P. SMITH
District Production Mgr.
West Virginia Division
HARVEY J. SIMMONS, Jr.
General Superintendent

West Virginia Department of Mines
Oil and Gas Division
Charleston, West Virginia

Gentlemen:

We enclose three copies of notice of intention to
plug and abandon our S. W. Singlehooker well #1,
located in Steele District, Wood
County, West Virginia, Drilling Permit WOO-389.

We also enclose two copies of the record of the
above well.

Yours very truly,

J. E. Warden

enc



12/15/2023

E-17

GODFREY L. CABOT, INC.

NATURAL GAS

900 UNION BUILDING

CABOT

BOX 1473

CHARLESTON 25, W. VA.

WILLARD P. SMITH
Eastern Production Mgr.

West Virginia Division
HARVEY J. SIMMONS, Jr.
General Superintendent

July 13, 1951

Department of Mines
Oil and Gas Division
Charleston, West Virginia

Gentlemen:

We enclose copy of affidavit of plugging and filling our S. E. Singledecker well #1, serial 1345, located in Steele District, Wood County, West Virginia, Permit No. W00-349-P.

Yours very truly,

J. E. Walker

c
enc
cc Ballard, with copy of affidavit.

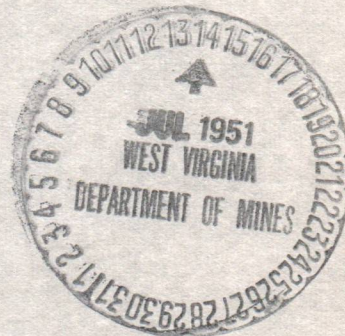

GODFREY L. CABOT, INC.

NATURAL GAS

CABOT

CHARLESTON 22, W. VA.

BOX 1473

300 UNION BUILDING

WILLARD F. SMITH
Eastern Production Mgr.
West Virginia Division
HARVEY J. SIMMONS, Jr.
General Superintendent

July 13, 1951

Department of Mines
Oil and Gas Division
Charleston, West Virginia

Gentlemen:

We enclose copy of affidavit of plugging and filling
our S. E. Singlebecker well #1, Section 13E, located
in Steele District, Wood County, West Virginia,
Permit No. WOO-389-1.

Yours very truly,

J. E. Wiggins

87

cc Ballard, with copy of affidavit.
one
c



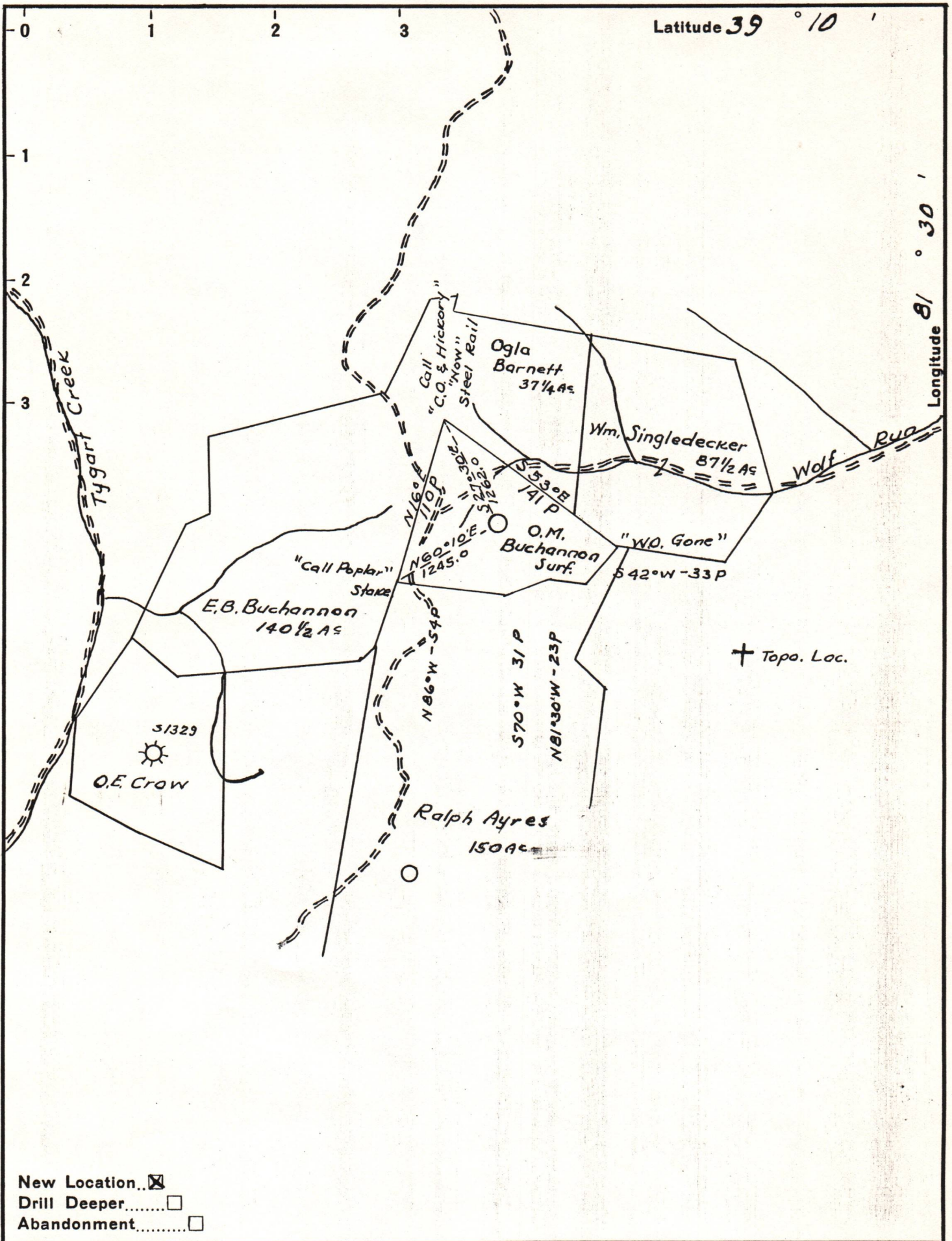

New Location..
 Drill Deeper.....
 Abandonment.....

Company Godfrey L. Cabot Inc.
 Address 300 Union Bldg. Charleston Wva.
 Farm Sarah E. Singledecker (GLC 066)
 Tract _____ Acres 54 ^{Deed} ~~Lease~~ No. 2-92
 Well (Farm) No. 1 Serial No. 1345
 Elevation (Spirit Level) 885.72
 Quadrangle Belleville
 County Wood District Steele
 Engineer H. J. ... Jr
 Engineer's Registration No. 1652
 File No. _____ Drawing No. _____
 Date 12-16-50 Scale 1" = 1320'

STATE OF WEST VIRGINIA
 DEPARTMENT OF MINES
 OIL AND GAS DIVISION
 CHARLESTON

WELL LOCATION MAP

FILE NO. W00-349 12/15/2023

+ Denotes location of well on United States Topographic Maps, scale 1 to 62,500, latitude and longitude lines being represented by border lines as shown.

- Denotes one inch spaces on border line of original tracing.