



STATE OF WEST VIRGINIA
DEPARTMENT OF MINES
OIL AND GAS DIVISION

NOTICE OF PROPOSED LOCATION OF OIL AND GAS WELL

To THE DEPARTMENT OF MINES,
Charleston, W. Va.

S. M. Wigal
COAL OPERATOR OR COAL OWNER

Columbian Carbon Company
NAME OF WELL OPERATOR

Rockport, W. Va.
ADDRESS

Box 873, Charleston 23, W. Va.
COMPLETE ADDRESS

Virginia M. Perkins
COAL OPERATOR OR COAL OWNER

May 26, 1950
PROPOSED LOCATION

Rockport, W. Va.
ADDRESS

Steele District

OWNER OF MINERAL RIGHTS

Wood County

ADDRESS

Well No. 1 - GW-11149

S. M. Wigal et al Farm

GENTLEMEN:

The undersigned well operator is entitled to drill upon the above named farm or tract of land for oil and gas, having fee title thereto, (or as the case may be) under ~~grant~~ lease dated January 7, 1950, made by S. M. Wigal et al, to Columbian Carbon Company, and recorded on the _____ day of _____, in the office of the County Clerk for said County in Book _____, page _____.

The enclosed plat was prepared by a competent engineer and shows the proposed location of a well to be drilled for oil and gas by the undersigned well operator on the farm and in the Magisterial District and County above named, determined by survey and courses and distances from two permanent points, or land marks.

The undersigned well operator is informed and believes there are no coal operators operating beds of coal beneath said farm or tract of land on which said well is located, or within 500 feet of the boundaries of the same, who have mapped their workings and filed their maps as required by law, excepting the coal operators or coal owners (if any) above named as addressees.

The above named coal operators or coal owners (if any) are notified that any objections they may desire to make to such proposed location, or which they are required to make by Section 3 of said Code, if the drilling of a well at said proposed location will cause a dangerous condition in or about their respective coal mines, must be received by, or filed with the Department of Mines within ten* days from the receipt of a copy of this notice and accompanying plat by said Department. Said coal operators are further notified on request and that all such objections must set forth as definitely as is reasonably possible the ground or grounds on which such objections are based and indicate the direction and distance the proposed location should be moved to overcome same.

(The next paragraph is to be completed only in Department's copy.)

Copies of this notice and the enclosed plat were mailed by registered mail, or delivered to the above named coal operators or coal owners at their above shown respective addresses _____ day _____ before, ~~of~~ on the same day with the mailing or delivery of this copy to the Department of Mines at Charleston, West Virginia.

Very truly yours,

COLUMBIAN CARBON COMPANY
by: O. W. VanPetten, Vice President
WELL OPERATOR

Box 873
STREET

Charleston 23
CITY OR TOWN

W. Va.
STATE

Address of Well Operator }

12/15/2023

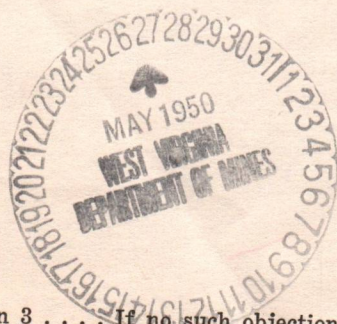

*Section 3 If no such objections be filed or be found by the department of mines, within said period of ten days from the receipt of said notice and plat by the department of mines, to said proposed location, the department shall forthwith issue to the well operator a drilling permit reciting the filing of such plat, that no objections have been made by the coal operators to the location, or found thereto by the department, and that the same is approved and the well operator authorized to proceed to drill at said location.

A-10

COLUMBIAN CARBON COMPANY

903 SECURITY BUILDING

POST OFFICE DRAWER 873

CHARLESTON 23, W. VA.

May 25, 1950

West Virginia Department of Mines
Oil and Gas Division
State Capitol Building
Charleston 5, W. Va.

Re: GW-1149, S. M. Wigal et al #1

Gentlemen:

We enclose the following in connection with the above
proposed location:

1 Copy Notice of Proposed Location

Original Survey Tracing

Will you please issue a Drilling Permit?

Yours very truly,



O. W. Van Petten

lw
encl

cc-Mr. R. G. Merrick



A-11

June 6, 1950

Columbian Carbon Company
P. O. Box 873
Charleston, West Virginia

Gentlemen:

Enclosed is permit WOC-324 to drill
Well No. 1-GM-1149 on the S. M. Wigal et al Farm,
Steele District, Wood County.

Very truly yours,

Administrative Assistant
OIL AND GAS DIVISION

CWH:K
Encl-2

CC: Inspector O. C. Howard

12/15/2023

A. N.

COLUMBIAN CARBON COMPANY

903 SECURITY BUILDING

POST OFFICE DRAWER 873

CHARLESTON 23, W. VA.

September 7, 1950

West Virginia Department of Mines
Oil and Gas Division
State Capitol Building
Charleston 5, W. Va.

Re: GW-1149, S. M. Wigal #1

Gentlemen:

We are attaching the following in connection with the above well:

3 Copies Notice of Intention to Plug & Abandon

2 Copies of Well Record

Will you please approve and return one copy of the Work Order for our files? We would also like to have your verbal approval to start this work immediately.

Yours very truly,

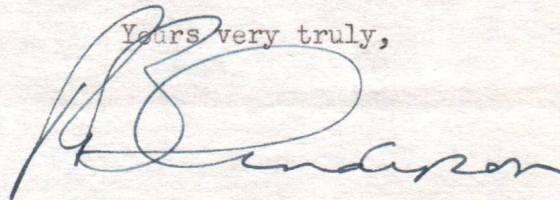

R. B. Anderson

bl
att

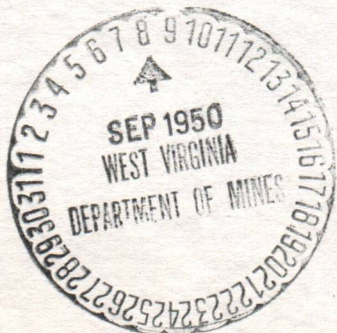

12/15/2023

COLUMBIAN CARBON COMPANY

503 SECURITY BUILDING
POST OFFICE DRAWER 513
CHARLESTON 23, W. VA.

September 7, 1950

Mr. J. H. Anderson
Federal Bureau of Investigation
Washington 25, D. C.

Re: [Illegible]

Sir:

We are attaching the following in connection with the above well:

1. A copy of the report of the geologist who visited the well.

2. A copy of the well log.

All data are approximate and should not be used for any purpose other than for general information. You will note that the well is not a water well.

Very truly yours,



J. H. Anderson

dl
503





STATE OF WEST VIRGINIA
DEPARTMENT OF MINES
OIL AND GAS DIVISION

WELL RECORD

Permit No. W00-324

Oil or Gas Well DRY HOLE
(KIND)

Company Columbian Carbon Company
Address Box 873, Charleston 23, W. Va.
Farm S. M. Wögal, et al Acres 1585
Location (waters) Tygart Creek
Well No. 1-GW-1149 Elev. 1070.78'G
District Steele County Wood
The surface of tract is owned in fee by S. M. Wögal, et al
Address Rockport, W. Va.
Mineral rights are owned by S. M. Wögal, et al
(for further addresses contact Columbian Carbon Co. Address _____

Casing and Tubing	Used in Drilling	Left in Well	Packers
Size			
16"	21'		Kind of Packer <u>Midget</u>
13 3/8" 48#	473'7"	<u>Pulled</u>	<u>Bottom Hole</u>
10 3/4" 40#	1607'10"	<u>Pulled</u>	Size of <u>7"</u>
8 1/4" 24#	2412'8"	<u>Pulled</u>	
6 3/8" 23#	5272'6"	<u>5272'6"</u>	Depth set <u>5250'SIM</u>
5 3/16"			
3			Perf. top _____
2			Perf. bottom _____
Liners Used			Perf. top _____
			Perf. bottom _____

Drilling commenced 5-29-50
Drilling completed 9-6-50
Date Shot Not Shot From _____ To _____
With _____

Open Flow _____ /10ths Water in _____ Inch
_____ /10ths Merc. in _____ Inch
Volume Dry Hole _____ Cu. Ft.
Rock Pressure _____ lbs. _____ hrs.
Oil _____ bbls., 1st 24 hrs.
Fresh water _____ feet _____ feet
Salt water 2055' hole full feet _____ feet

CASING CEMENTED	SIZE	No. Ft.	Date
See reverse side			
COAL WAS ENCOUNTERED AT	FEET	INCHES	
_____	_____	_____	_____
_____	_____	_____	_____
_____	_____	_____	_____

Formation	Color	Hard or Soft	Top	Bottom	Oil, Gas or Water	Depth Found	Remarks
Sand			0	17			
Slate			17	55			
Red Rock			55	60			
Slate			60	82			
Red Rock			82	87			
Slate			87	108			
Red Rock			108	123			
Slate			123	155			
Red Rock			155	180			
Slate			180	210			
Red Rock			210	230			
Slate			230	286			
Red Rock			286	299			
Slate			299	356			
Red Rock			356	363			
Slate			363	369			
Red Rock			369	411			
Slate			411	422			
Red Rock			422	437			
Lime			437	456			
Red Rock			456	481			
Slate			481	488			
Red Rock			488	558			
Lime			558	570			
Red Rock			570	620			
Slate			620	645			
Red Rock			645	716			
Slate			716	777			
Red Rock			777	817			
Sand			817	828			
Slate			828	880			
Sand			880	915			
Slate			915	950			
Sand			950	970			
Slate			970	1025			
Sand			1025	1057			
Slate			1057	1085			
Red Rock			1085	1109			
Sand			1109	1121			

1046'SIM-1046'DIM

12/15/2023

B-2

Formation	Color	Hard or Soft	Top	Bottom	Oil, Gas or Water	Depth Found	Remarks
Red Rock			1121	1150			
Slate			1150	1165			
Red Rock			1165	1185			
Sand			1185	1200			
Slate			1200	1240			
Red Rock			1240	1305			
Slate			1305	1324			
Sand			1324	1348			
Slate			1348	1408			
Sand			1408	1482			
Slate			1482	1558			
Sand			1558	1572			
Slate			1572	1582			
Sand	1586'DLM-1590'SLM		1582	1633			
Lime			1633	1662			
Sand			1662	1690			
Slate			1690	1705			
Sand			1705	1740			
Slate			1740	1775			
Sand			1775	1810			
Slate			1810	1850			
Sand			1850	1865			
Slate			1865	1950			
Sand			1950	2002			
Slate			2002	2024			
Sand			2024	2281	S. water	2055'	hole full
Lime	2401'DLM-2401'SLM		2281	2438			
Slate & Shells			2438	4136			
Brown Shale			4136	4470			
Slate			4470	4891			
Shale			4891	4940			
Lime			4940	4981			
Shale			4981	5208			
Lime			5208 DLM	5343'SLM			
			5230 SLM	5346'DLM			
Sand (Oriskany)			5343'SLM				
Lime	5250'SLM-5250'DLM		5346'DLM	5394			
			5394	5431'			
		TOTAL DEPTH	-----	5431'			
<u>Casing Record</u>							
6-15-50	13-3/8" casing - ran 26 sacks of aquagel with circulation and returns Columbian Carbon Company Crew						
6-25-50	10-3/4" casing - ran 28 sacks of aquagel with circulation and returns Columbian Carbon Company Crew						
7- 9-50	8-5/8" casing - ran 28 sacks of aquagel with circulation and returns Columbian Carbon Company Crew						
8- 8-50	7" casing - ran 60 sacks of aquagel - no circulation or returns.						

12/15/2023

Date Sept. 7, 19 50

APPROVED Columbian Carbon Company, Owner

By O.W. Van Petten, Vice President
(Title)

STATE OF WEST VIRGINIA
DEPARTMENT OF MINES
OIL AND GAS DIVISION

INSPECTOR'S WELL REPORT

Permit No. _____

Oil or Gas Well _____
(KIND)

Company _____ Address _____ Farm _____ Well No. _____ District _____ County _____ Drilling commenced _____ Drilling completed _____ Total depth _____ Date shot _____ Depth of shot _____ Initial open flow _____ /10ths Water in _____ Inch Open flow after tubing _____ /10ths Merc. in _____ Inch Volume _____ Cu. Ft. Rock pressure _____ lbs. _____ hrs. Oil _____ bbls., 1st 24 hrs. Fresh water _____ feet _____ feet Salt water _____ feet _____ feet	CASING AND TUBING Size 16 13 10 8¼ 6½ 5 3/16 3 2 Liners Used	USED IN DRILLING	LEFT IN WELL	PACKERS Kind of Packer Size of Depth set Perf. top Perf. bottom Perf. top Perf. bottom	
		CASING CEMENTED _____ SIZE _____ No. FT. _____ Date _____			
		COAL WAS ENCOUNTERED AT _____ FEET _____ INCHES			
		_____ FEET _____ INCHES _____ FEET _____ INCHES			
		_____ FEET _____ INCHES _____ FEET _____ INCHES			

Drillers' Names _____

Remarks: _____

DATE _____

DISTRICT WELL INSPECTOR

12/15/2023

B-3

STATE OF WEST VIRGINIA
DEPARTMENT OF MINES
OIL AND GAS DIVISION

INSPECTOR'S PLUGGING REPORT

Permit No. Woo. 324P

Well No. 160W 1149

COMPANY Columbian Carbon Co ADDRESS Charleston W. Va.

FARM S M Nigal DISTRICT Steele COUNTY Wood

Filling Material Used _____

Liner Location Amount Packer Location

PLUGS USED AND DEPTH PLACED			BRIDGES	CASING AND TUBING		
CEMENT-THICKNESS	WOOD-SIZE	LEAD	CONSTRUCTION-LOCATION	RECOVERED	SIZE	LOST
	<u>Gravel</u>		<u>5'4 31 - 5'3 43</u>			
<u>5 bags</u>			<u>5'3 43 - 5'3 18</u>			
<u>M & S</u>	<u>fluy</u>		<u>5'3 18 - 5'3 15</u>			
	<u>Pulling on 6 3/4" casing</u>					

Drillers' Names Danell Westfall Richard Michael

Remarks: _____

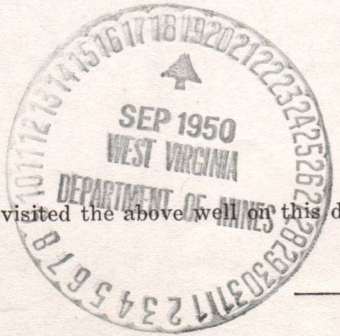

9/12-1950
DATE

I hereby certify I visited the above well on this date.

Al Howard
DISTRICT WELL INSPECTOR

12/15/2023

STATE OF WEST VIRGINIA
DEPARTMENT OF MINES
OIL AND GAS DIVISION

INSPECTOR'S WELL REPORT

Permit No. _____

Oil or Gas Well _____
(KIND)

	CASING AND TUBING	USED IN DRILLING	LEFT IN WELL	PACKERS
Company _____	Size			
Address _____	16			Kind of Packer _____
Farm _____	13			
Well No. _____	10			Size of _____
District _____ County _____	8 1/4			
Drilling commenced _____	6 5/8			Depth set _____
Drilling completed _____ Total depth _____	5 3/16			
Date shot _____ Depth of shot _____	3			Perf. top _____
Initial open flow _____ /10ths Water in _____ Inch	2			Perf. bottom _____
Open flow after tubing _____ /10ths Merc. in _____ Inch	Liners Used			Perf. top _____
Volume _____ Cu. Ft.				Perf. bottom _____
Rock pressure _____ lbs. _____ hrs.	CASING CEMENTED _____ SIZE _____ No. FT. _____ Date _____			
Oil _____ bbls., 1st 24 hrs.	COAL WAS ENCOUNTERED AT _____ FEET _____ INCHES			
Fresh water _____ feet _____ feet	_____ FEET _____ INCHES _____ FEET _____ INCHES			
Salt water _____ feet _____ feet	_____ FEET _____ INCHES _____ FEET _____ INCHES			

Drillers' Names _____

Remarks:

DATE

DISTRICT WELL INSPECTOR

12/15/2023

STATE OF WEST VIRGINIA
DEPARTMENT OF MINES
OIL AND GAS DIVISION

INSPECTOR'S WELL REPORT

Permit No. _____

Oil or Gas Well _____
(KIND)

	CASING AND TUBING	USED IN DRILLING	LEFT IN WELL	PACKERS
Company _____				
Address _____	Size			
Farm _____	16			Kind of Packer _____
Well No. _____	13			
District _____ County _____	10			Size of _____
Drilling commenced _____	8 1/4			
Drilling completed _____ Total depth _____	6 5/8			Depth set _____
Date shot _____ Depth of shot _____	5 3/16			
Initial open flow _____ /10ths Water in _____ Inch	3			Perf. top _____
Open flow after tubing _____ /10ths Merc. in _____ Inch	2			Perf. bottom _____
Volume _____ Cu. Ft.	Liners Used			Perf. top _____
Rock pressure _____ lbs. _____ hrs.				Perf. bottom _____
Oil _____ bbls., 1st 24 hrs.	CASING CEMENTED _____ SIZE _____ No. FT. _____ Date _____			
Fresh water _____ feet _____ feet	COAL WAS ENCOUNTERED AT _____ FEET _____ INCHES			
Salt water _____ feet _____ feet	_____ FEET _____ INCHES _____ FEET _____ INCHES			
	_____ FEET _____ INCHES _____ FEET _____ INCHES			

Drillers' Names _____

Remarks:

DATE

DISTRICT WELL INSPECTOR

12/15/2023

STATE OF WEST VIRGINIA
DEPARTMENT OF MINES
OIL AND GAS DIVISION

INSPECTOR'S WELL REPORT

Permit No. _____

Oil or Gas Well _____
(KIND)

	CASING AND TUBING	USED IN DRILLING	LEFT IN WELL	PACKERS
Company _____				
Address _____	Size			
Farm _____	16			Kind of Packer _____
Well No. _____	13			
District _____ County _____	10			Size of _____
Drilling commenced _____	8 1/4			
Drilling completed _____ Total depth _____	6 5/8			Depth set _____
Date shot _____ Depth of shot _____	5 3/16			
Initial open flow _____ /10ths Water in _____ Inch	3			Perf. top _____
Open flow after tubing _____ /10ths Merc. in _____ Inch	2			Perf. bottom _____
Volume _____ Cu. Ft.	Liners Used			Perf. top _____
Rock pressure _____ lbs. _____ hrs.				Perf. bottom _____
Oil _____ bbls., 1st 24 hrs.	CASING CEMENTED _____ SIZE _____ No. FT. _____ Date _____			
Fresh water _____ feet _____ feet	COAL WAS ENCOUNTERED AT _____ FEET _____ INCHES			
Salt water _____ feet _____ feet	_____ FEET _____ INCHES	_____ FEET _____ INCHES	_____ FEET _____ INCHES	_____ FEET _____ INCHES

Drillers' Names _____

Remarks: _____

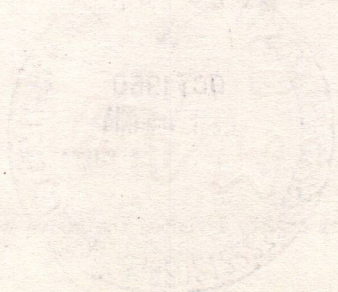

DATE

DISTRICT WELL INSPECTOR

12/15/2023



STATE OF WEST VIRGINIA
DEPARTMENT OF MINES
OIL AND GAS DIVISION

NOTICE OF INTENTION TO PLUG AND ABANDON WELL

(REQUIRED BY SECTION 9, ARTICLE 4, CHAPTER 22 OF THE CODE)

To THE DEPARTMENT OF MINES,
Charleston, W. Va.

None
COAL OPERATOR OR COAL OWNER

Columbian Carbon Company
NAME OF WELL OPERATOR

ADDRESS

Box 873, Charleston 23, W. Va.
COMPLETE ADDRESS

COAL OPERATOR OR COAL OWNER

September 7, 19 50

ADDRESS

WELL TO BE ABANDONED

Steele District

Wood County

LEASE OR PROPERTY OWNER

Well No. 1-GW-1149

ADDRESS

S. M. Wigal Farm

NOTIFY INSPECTOR O.C. HOWARD - GRANTSVILLE - TELEPHONE 108
24 HOURS IN ADVANCE OF PLUGGING DATE

Gentlemen:—

The undersigned well operator is about to abandon the above described well and will commence

We would like verbal approval to start plugging immediately

the work of plugging and abandoning said well on the 7th day of September, 19 50,
(which date shall not be less than five days after the day on which this notice so mailed is received,
or in due course should be received by the Department of Mines.)

This notice is given you in order that your respective representatives may be present at the
plugging and filling of said well. You are further notified that whether you are represented or not
represented the undersigned will proceed on that date, or shortly thereafter, to plug and fill said
well in the manner required by Section 10, Article 4, Chapter 22 of the Code and given in detail on the
reverse side of this notice, in "Work Order."

This notice is being mailed by registered mail to each of you at the above addresses on the
above date.

Very truly yours,

Columbian Carbon Company

by: *R. B. Anderson*
R. B. Anderson, Sup Well Operator.

12/15/2023

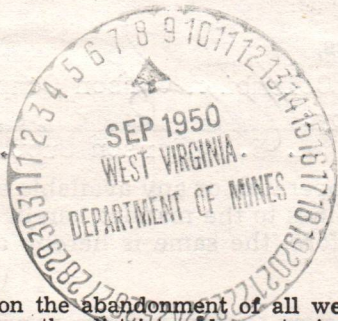

NOTE: Upon the abandonment of all wells drilled prior to June 1, 1929, a plat prepared by a competent
engineer, showing the district and county in which the tract of land is located, the name and acreage of same,
the names of the owners and adjacent tracts, and the location of the about to be abandoned well, determined
by survey, and the courses and distances of such well from two permanent points or landmarks on said tract, shall
be submitted with this notice.

(Over)

W00-324-P PERMIT NUMBER

PROPOSED MANNER OF PLUGGING AND FILLING WELL

(REQUIRED BY RULES AND REGULATIONS)

WEST VIRGINIA DEPARTMENT OF MINES

OIL AND GAS DIVISION

WORK ORDER

Well to be plugged and filled as follows:

Fill solid 5431' to 5343'

Cement plug 5343' to 5318' - 5 sacks

M & F Plug 5318' to 5315'

Fill hole with Aquagel 4% with 25 sacks Gelatin and 210 bbls. water

Pull 7" O.D. casing - rip at 5220' - 1st joint up from bottom if necessary.

Bridge 2045'-2035'

Cement 2035'-2025' - 5 sacks

Rerun 479'7" of 13-3/8" casing that was pulled originally with a die nipple and screw on to 13-3/8" casing and pull. Rip at 1016' - 1st joint up from bottom if necessary.

Bridge 41'-31'

Cement 31'-21' - 12 sacks

Pull 16" Drive pipe

Fill solid to surface - concrete monument at surface marked

GW-1149, S. M. Wigan #1, Columbian Carbon Company and date plugged.

To the Department of Mines
Coal Owner or Operator,
Lease or Property Owner.

Gentlemen:

This "work order" is submitted for your approval and concurrence and unless notified of your disapproval or non-concurrence, the undersigned will proceed with the plugging and filling of said well in the above described manner on the date stated in the notice of intention to plug and abandon the said well on opposite side of this sheet.

Very truly yours,

Columbian Carbon Company

by: 

K. E. Anderson Supt Well Operator.

No objections have been filed by the coal owner or coal operator, or any available adjacent lease or property owners or interposed by the Department of Mines to the manner herein described for the plugging and filling of the well above mentioned. Therefore, the same is hereby approved this

7th day of September, 1950

12/15/2023

DEPARTMENT OF MINES
Oil and Gas Division

By: 

NOTE: This "work order" shall be filed in triplicate, one copy for the files of the Department of Mines; one to be approved or corrected and returned to the well operator as his authority for plugging said well; and one for the well inspector.



STATE OF WEST VIRGINIA
DEPARTMENT OF MINES
OIL AND GAS DIVISION

RECEIVED

OCT 7 - 1950

COLUMBIAN CARBON CO.,
CHARLESTON, W. VA.

AFFIDAVIT OF PLUGGING AND FILLING WELL

AFFIDAVIT SHOULD BE MADE IN TRIPPLICATE, ONE COPY MAILED TO THE DEPARTMENT, ONE COPY TO BE RETAINED BY THE WELL OPERATOR AND THE THIRD COPY (AND EXTRA COPIES IF REQUIRED) SHOULD BE MAILED TO EACH COAL OPERATOR AT THEIR RESPECTIVE ADDRESSES.

<u>none</u>	<u>Columbian Carbon Company</u>
COAL OPERATOR OR OWNER	NAME OF WELL OPERATOR
ADDRESS	<u>Box 873, Charleston 23, W. Va.</u>
ADDRESS	COMPLETE ADDRESS
COAL OPERATOR OR OWNER	<u>October 2, 1950</u>
ADDRESS	WELL AND LOCATION
LEASE OR PROPERTY OWNER	<u>Steele</u> District
ADDRESS	<u>Wood</u> County
ADDRESS	Well No. <u>1 - GW-1149</u>
ADDRESS	<u>S. M. Wigal</u> Farm

STATE INSPECTOR SUPERVISING PLUGGING.....

AFFIDAVIT

STATE OF WEST VIRGINIA,

County of Wood

SS:

Darrell Westfall

and

Donald L. Ramsey

being first duly sworn according to law depose and say that they are experienced in the work of plugging and filling oil and gas wells and were employed by Columbian Carbon Company, well operator, and participated in the work of plugging and filling the above well, that said work was commenced on the 7th day of September, 1950, and that the well was plugged and filled in the following manner:

SAND OR ZONE RECORD	FILLING MATERIAL			PLUGS USED	CASING		
	FORMATION	CONTENT	FROM		TO	CSG PULLED	CSG LEFT IN
	Filled solid		5431	5343	7"	5047'4"	225'2"
	cement-5 sacks		5343	5318	8-5/8"	all	
	M&F Plug		5318	5315	10-3/4"	all	
	Filled with Aquagel				13-3/8"	473'7"	585'4"
	Ripped 7" at		5047'		16"	all	
	Bridge		2045'	2035'			
	Cement-5 sacks		2035'	2025'			
	bridge		41'	31'			
	Cement-12 sacks		31'	21'			
	pulled 16" casing						
	filled solid		21'	0'			
COAL SEAMS	DESCRIPTION OF MONUMENT						
(NAME)	GW-1149, S. M. Wigal #1,						
(NAME)	Columbian Carbon Company						
(NAME)	October 2, 1950						
(NAME)							

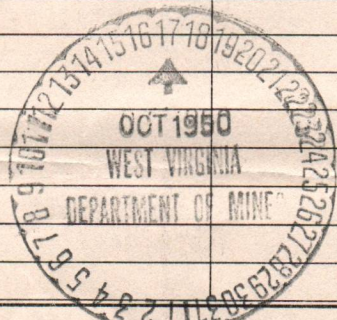

and that the work of plugging and filling said well was completed on the 2nd day of October, 1950.

And further deponents saith not.

Sworn to and subscribed before me this 2 day of October, 1950.

Darrell Westfall
Donald L. Ramsey
Harold Anderson

12/15/2023

Notary Public.

Permit No. Wec-324P

My commission expires: January 31-1951

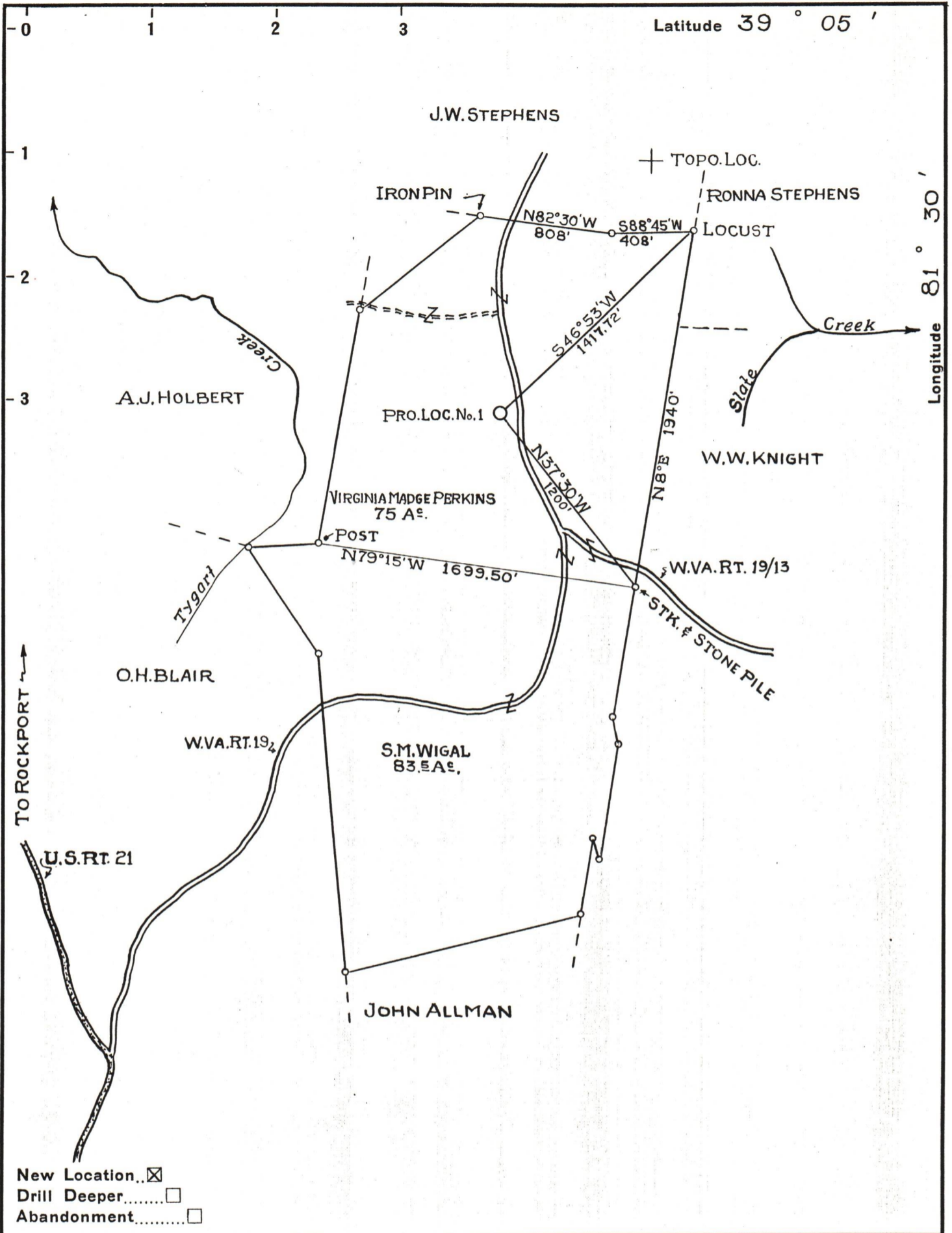

Company COLUMBIAN CARBON COMPANY

Address Box 873 CHARLESTON W.VA.

Farm S.M. WIGAL ETAL

Tract _____ Acres 158.5 Lease No. C-3733

Well (Farm) No. 1 Serial No. GW-1149

Elevation (Spirit Level) 1070.78

Quadrangle BELLEVILLE 75.E S-130 W-235

County WOOD District STEELE

Engineer R.B. Anderson

Engineer's Registration No. 2074

File No. _____ Drawing No. W-7-50

Date MAY 25 1950 Scale 1" = 660'

STATE OF WEST VIRGINIA
DEPARTMENT OF MINES
OIL AND GAS DIVISION
CHARLESTON

WELL LOCATION MAP

FILE NO. W00-324

12/15/2023

+ Denotes location of well on United States Topographic Maps, scale 1 to 62,500, latitude and longitude lines being represented by border lines as shown.

- Denotes one inch spaces on border line of original tracing.