



STATE OF WEST VIRGINIA
DEPARTMENT OF MINES
OIL AND GAS DIVISION

NOTICE OF PROPOSED LOCATION OF OIL AND GAS WELL

To THE DEPARTMENT OF MINES,
Charleston, W. Va.

NONE
COAL OPERATOR OR COAL OWNER

CLARENCE W. MEADOWS, Agent
NAME OF WELL OPERATOR

ADDRESS

701-703 United Carbon Bldg.
Charleston, W.Va.
COMPLETE ADDRESS

COAL OPERATOR OR COAL OWNER

March 1, 19 50

PROPOSED LOCATION

ADDRESS

STEELE District

C.A. Barnett
OWNER OF MINERAL RIGHTS

WOOD County

Rockport, W.Va.
ADDRESS

Well No. 2 ^{39005'} _{81'30'}

C.A. Barnett Farm

GENTLEMEN:

The undersigned well operator is entitled to drill upon the above named farm or tract of land for oil and gas, having fee title thereto, (or as the case may be) under grant or lease dated May 25 1949, made by C.A. Barnett & Wife, to Clarence W. Meadows, and recorded on the 27 day of May 1949, in the office of the County Clerk for said County in Book 322, page 331.

The enclosed plat was prepared by a competent engineer and shows the proposed location of a well to be drilled for oil and gas by the undersigned well operator on the farm and in the Magisterial District and County above named, determined by survey and courses and distances from two permanent points, or land marks.

The undersigned well operator is informed and believes there are no coal operators operating beds of coal beneath said farm or tract of land on which said well is located, or within 500 feet of the boundaries of the same, who have mapped their workings and filed their maps as required by law, excepting the coal operators or coal owners (if any) above named as addressees.

The above named coal operators or coal owners (if any) are notified that any objections they may desire to make to such proposed location, or which they are required to make by Section 3 of said Code, if the drilling of a well at said proposed location will cause a dangerous condition in or about their respective coal mines, must be received by, or filed with the Department of Mines within ten* days from the receipt of a copy of this notice and accompanying plat by said Department. Said coal operators are further notified that forms for use in making such objections will be furnished to them by the Department of Mines promptly on request and that all such objections must set forth as definitely as is reasonably possible the ground or grounds on which such objections are based and indicate the direction and distance the proposed location should be moved to overcome same.

(The next paragraph is to be completed only in Department's copy.)

Copies of this notice and the enclosed plat were mailed by registered mail, or delivered to the above named coal operators or coal owners at their above shown respective address _____ day _____ before, or on the same day with the mailing or delivery of this copy to the Department of Mines at Charleston, West Virginia.

Very truly yours, Clarence W. Meadows

By Robert C. Lafferty *Robert C. Lafferty*
WELL OPERATOR Geologist

701-703 United Carbon Bldg
STREET

Charleston
CITY OR TOWN

W. Va
STATE

12/15/2023



Address of Well Operator }

*Section 3 If no such objections be filed or be found by the department of mines, within said period of ten days from the receipt of said notice and plat by the department of mines, to said proposed location, the department shall forthwith issue to the well operator a drilling permit reciting the filing of such plat, that no objections have been made by the coal operators to the location, or found thereto by the department, and that the same is approved and the well operator authorized to proceed to drill at said location.

DEPARTMENT OF MINES
Geological Division

NOTICE OF PROPOSED LOCATION OF OIL AND GAS WELLS

TO: CHARLES W. BARNETT, Geologist
701-703 United States Bldg.
Charleston, W. Va.

FROM: CLARENCE W. MESSORS
1448
231

DATE: 1948

RE: Oil and Gas Wells

The proposed wells are located in a tract of land owned by the State of West Virginia, and are situated in the County of Boone, West Virginia. The location of the wells is shown on the attached map, which is a part of the geological map of the area. The wells are proposed to be drilled to a depth of 1000 feet, and are expected to produce oil and gas. The proposed location of the wells is in the vicinity of the town of Charleston, West Virginia. The proposed location of the wells is in the vicinity of the town of Charleston, West Virginia. The proposed location of the wells is in the vicinity of the town of Charleston, West Virginia.

CLARENCE W. MESSORS
Geologist

By Robert G. Lafferty, Geologist

701-703 United States Bldg.
Charleston, W. Va.

12/15/2023

A-9

Wood-309
BU

February 24, 1950

Mr. Clarence W. Meadows, Attorney
701-03 United Carbon Building
Charleston, West Virginia

Dear Mr. Meadows:

We have not yet received notices to drill or tracings of location for the C. A. Barnett Well No. 2 which, we understand, is drilling at about 2000 feet; the Davis No. 1 and Betts No. 1, all in Steele District, Wood County.

We would appreciate receiving these data at an early date.

Very truly yours,

Administrative Assistant
OIL AND GAS DIVISION

MG:g

12/15/2023

A-10

March 16, 1950

Mr. Clarence W. Meadows, Agent
701-703 United Carbon Building
Charleston, West Virginia

Dear Sir:

Enclosed is permit WOO-309 to drill Well
No. 2 on the C. A. Barnett Farm, Steele District,
Wood County.

Very truly yours,

Administrative Assistant
OIL AND GAS DIVISION

GMH:K
Encl-2

CC: Inspector O. C. Howard

12/15/2023

A-11



STATE OF WEST VIRGINIA
DEPARTMENT OF MINES
CHARLESTON

ARCH J. ALEXANDER
CHIEF

July 22, 1950

Hon. Clarence W. Meadows
701-703 United Carbon Building
Charleston, West Virginia

Dear Sir:

Please send affidavits for the plugging of the following wells:

<u>Permit No.</u>	<u>Well No.</u>	<u>Farm</u>	<u>District</u>	<u>County</u>
Wir-288-P	1	Morris	Tucker	Wirt
Woo-309-P	2	C. A. Barnett	Steele	Wood

Forms OG-8 are enclosed.

Very truly yours,

Administrative Assistant
OIL AND GAS DIVISION

CNH:K
CC: Inspector O. C. Howard



STATE OF WEST VIRGINIA
 DEPARTMENT OF MINES
 CHARLESTON

ARCH J. ALEXANDER
 CHIEF

July 28, 1960

Mr. Clarence M. Haddock
 701-702 United Carbon Building
 Charleston, West Virginia

Dear Sir:

Please refer to the following for the following

files:

Form No.	Date	Name	Initials	Signature
WV-308-F	1	Haddock		
WV-308-F	2	D. A. Haddock		

Forms 00-8 are attached.

Very truly yours,

Administrative Assistant
 OIL AND GAS DIVISION

CC: Inspector C. G. Hovard



STATE OF WEST VIRGINIA
DEPARTMENT OF MINES
OIL AND GAS DIVISION 5

Bellaire

WELL RECORD

Oil or Gas Well **Dry Hole**
(KIND)

Permit No. **WOO - 309**

Company **Clarence W. Meadows, Agent**
Address **United Carbon Bldg, Charleston, W.Va.**
Farm **C.A. Barnett** Acres **245**
Location (waters) **Sandy Creek**
Well No. **2 L-449** Elev. **1084 D.F.**
District **Steele** County **WOOD**
The surface of tract is owned in fee by **C.A. Barnett**
Address **Rockport, W.Va.**
Mineral rights are owned by **C.A. Barnett**
Address **Rockport, W.Va.**
Drilling commenced **1-21-50**
Drilling completed **5-1-50**
Date Shot From To
With
Open Flow /10ths Water in Inch
/10ths Merc. in Inch
Volume Cu. Ft.
Rock Pressure lbs. hrs.
Oil bbls., 1st 24 hrs.
Fresh water feet feet
Salt water **1485, 2025, 2075** feet **5416** feet

Casing and Tubing	Used in Drilling	Left in Well	Packers
Size			
16 Wood	20	20	Kind of Packer
18	929' 1"		
10 3/4	1466' 1"		Size of
1 1/2 85/8	2395		
3/4 7	5295		Depth set
5 3/16			
3			Perf. top
2			Perf. bottom
Liners Used			Perf. top
			Perf. bottom

CASING CEMENTED **7** SIZE **5295** No. Ft. **4-25-50** Date

COAL WAS ENCOUNTERED AT FEET INCHES
FEET INCHES FEET INCHES
FEET INCHES FEET INCHES

Formation	Color	Hard or Soft	Top	Bottom	Oil, Gas or Water	Depth Found	Remarks
Soil			0	5			
Lime			5	90			
Red Rock			90	130			
Lime			130	140			
Red Rock			140	235			
Gritty Lime			235	255			
Red Rock			255	430			
Sand			430	455			
Lime			455	505			
Red Rock			505	515			
Slate & Shells			515	555			
Red Rock			555	570			
Gritty Lime			570	630			
Slate & Shells			630	650			
Lime			650	685			
Red Rock			685	735			
Slate & Shells			735	760			
Sand			760	830			
Red Rock			830	850			
Sandy Lime			850	935			
Red Rock			935	955			
Slate & Shells			955	1045			
Red Rock			1045	1060			
Slate & Shells			1060	1085			
Sand			1085	1110			
Slate & Shells			1110	1125			
Red Rock			1125	1190			
Lime			1190	1240			
Slate & Shells			1240	1300			
Red Rock			1300	1350			
Slate & Shells			1350	1385			
Sand			1385	1410			
Slate	Black		1410	1435			
Slate	Blue		1435	1450			
Sand			1450	1525	Water	1485	7 Bailers in 12 Hrs.
Slate & Shells			1525	1640			
Sand Broken			1640	1695			
Slate & Shells			1695	1755			

12/15/2023

B-2

Formation	Color	Hard or Soft	Top	Bottom	Oil, Gas or Water	Depth Found	Remarks
Sand			1755	1765			
Lime			1765	1800			
Sand			1800	1835			
Lime			1835	1890			
Slate & Shells			1890	1910			
Lime			1910	1940			
Slate & Shells			1940	2020			
Maxon Sand			2020	2350	Water	2025	8 Blrs in 2 Hrs.
					Water	2075	Hole Full
Slate			2350	2355			
Lime			2355	2363			
Slate			2363	2367			
Lime			2367	2393			
Slate & Shells			2393	2670			
Brown Shale			2670	2696			
Sand			2696	2702			
Slate & Shells			2702	3510			
Slate			3510	4200			
Shale			4200	4550	Gas	4275-4285	Show
Slate			4550	4985			
Shale Brown			4985	5279			
Corniferous Lime			5279	5396			
Oriskany Sand			5396	5416	Gas	5400	Small Show
Total Depth				5416	Gas, Oil & Water	5416	

12/15/2023

DEPARTMENT OF MINES
BUREAU OF METAL MINING

Date May 2, 1950

APPROVED Clarence W. Meadows, Agent, Owner

By Robert C. Lafferty Geologist

STATE OF WEST VIRGINIA
DEPARTMENT OF MINES
OIL AND GAS DIVISION

INSPECTOR'S WELL REPORT

Permit No. _____

Oil or Gas Well _____
(KIND)

	CASING AND TUBING	USED IN DRILLING	LEFT IN WELL	PACKERS
Company _____	Size _____			
Address _____	16 _____			Kind of Packer _____
Farm _____	13 _____			
Well No. _____	10 _____			Size of _____
District _____ County _____	8 1/4 _____			
Drilling commenced _____	6 5/8 _____			Depth set _____
Drilling completed _____ Total depth _____	5 3/16 _____			
Date shot _____ Depth of shot _____	3 _____			Perf. top _____
Initial open flow _____ /10ths Water in _____ Inch	2 _____			Perf. bottom _____
Open flow after tubing _____ /10ths Merc. in _____ Inch	Liners Used _____			Perf. top _____
Volume _____ Cu. Ft.				Perf. bottom _____
Rock pressure _____ lbs. _____ hrs.	CASING CEMENTED _____ SIZE _____ No. FT. _____ Date _____			
Oil _____ bbls., 1st 24 hrs.	COAL WAS ENCOUNTERED AT _____ FEET _____ INCHES			
Fresh water _____ feet _____ feet	_____ FEET _____ INCHES	_____ FEET _____ INCHES	_____ FEET _____ INCHES	_____ FEET _____ INCHES
Salt water _____ feet _____ feet	_____ FEET _____ INCHES	_____ FEET _____ INCHES	_____ FEET _____ INCHES	_____ FEET _____ INCHES

Drillers' Names _____

Remarks: _____

DATE _____

DISTRICT WELL INSPECTOR
12/15/2023

B-4

STATE OF WEST VIRGINIA
DEPARTMENT OF MINES
OIL AND GAS DIVISION

INSPECTOR'S PLUGGING REPORT

Permit No. Woo. 309P Well No. 2

COMPANY Blair W Meadows Coynt ADDRESS Charleston W Va

FARM C A Barnett DISTRICT Steel COUNTY Wood

Filling Material Used Clay ball and cement

Liner Location Amount Packer Location

PLUGS USED AND DEPTH PLACED			BRIDGES	CASING AND TUBING		
CEMENT-THICKNESS	WOOD-SIZE	LEAD	CONSTRUCTION-LOCATION	RECOVERED	SIZE	LOST
	Clay		5414 - 5376	5296	6 5/8	00
10'	5" stave		5376 - 5361			
	Bridges		4315 -			
	Clay		4315 - 4250			
10'	5" stave		4250 - 4235			
	Pulling	8 1/4"	Casing			

Drillers' Names Rush Hickman C B Thompson

Remarks:



5/17-1950
DATE

I hereby certify I visited the above well on this date.

Ch Howard
DISTRICT WELL INSPECTOR

12/15/2023

STATE OF WEST VIRGINIA
DEPARTMENT OF MINES
OIL AND GAS DIVISION

INSPECTOR'S WELL REPORT

Permit No. _____

Oil or Gas Well _____
(KIND)

	CASING AND TUBING	USED IN DRILLING	LEFT IN WELL	PACKERS
Company _____	Size			
Address _____	16			Kind of Packer _____
Farm _____	13			
Well No. _____	10			Size of _____
District _____ County _____	8 1/4			
Drilling commenced _____	6 5/8			Depth set _____
Drilling completed _____ Total depth _____	5 3/16			
Date shot _____ Depth of shot _____	3			Perf. top _____
Initial open flow _____ /10ths Water in _____ Inch	2			Perf. bottom _____
Open flow after tubing _____ /10ths Merc. in _____ Inch	Liners Used _____			Perf. top _____
Volume _____ Cu. Ft.				Perf. bottom _____
Rock pressure _____ lbs. _____ hrs.	CASING CEMENTED _____	SIZE _____	No. FT. _____	Date _____
Oil _____ bbls., 1st 24 hrs.	COAL WAS ENCOUNTERED AT _____ FEET _____ INCHES			
Fresh water _____ feet _____ feet	_____ FEET _____ INCHES	_____ FEET _____ INCHES	_____ FEET _____ INCHES	_____ FEET _____ INCHES
Salt water _____ feet _____ feet	_____ FEET _____ INCHES	_____ FEET _____ INCHES	_____ FEET _____ INCHES	_____ FEET _____ INCHES

Drillers' Names _____

Remarks: _____

12/15/2023





STATE OF WEST VIRGINIA
DEPARTMENT OF MINES
OIL AND GAS DIVISION

NOTICE OF INTENTION TO PLUG AND ABANDON WELL

(REQUIRED BY SECTION 9, ARTICLE 4, CHAPTER 22 OF THE CODE)

To THE DEPARTMENT OF MINES,
Charleston, W. Va.

NONE	Clarence W. Meadows, Agent
COAL OPERATOR OR COAL OWNER	NAME OF WELL OPERATOR
ADDRESS	United Carbon Bldg. Charleston, W.Va.
COAL OPERATOR OR COAL OWNER	COMPLETE ADDRESS
ADDRESS	May 2 1945
COAL OPERATOR OR COAL OWNER	WELL TO BE ABANDONED
ADDRESS	STEELE District
C. A. Barnett	WOOD County
LEASE OR PROPERTY OWNER	Well No. 2 L-449
Rockport, W.Va.	C.A. Barnett Farm
ADDRESS	

NOTIFY INSPECTOR O. C. HOWARD - GRANTSVILLE - TELEPHONE 108
24 HOURS IN ADVANCE OF PLUGGING DATE

Gentlemen:—

The undersigned well operator is about to abandon the above described well and will commence the work of plugging and abandoning said well on the 8 day of May, 1945, (which date shall not be less than five days after the day on which this notice so mailed is received, or in due course should be received by the Department of Mines.)

This notice is given you in order that your respective representatives may be present at the plugging and filling of said well. You are further notified that whether you are represented or not represented the undersigned will proceed on that date, or shortly thereafter, to plug and fill said well in the manner required by Section 10, Article 4, Chapter 22 of the Code and given in detail on the reverse side of this notice, in "Work Order."

This notice is being mailed by registered mail to each of you at the above addresses on the above date.

Very truly yours,

Robert C. Supply

Well Operator.

12/15/2023

NOTE: Upon the abandonment of all wells drilled prior to June 1, 1929, a plat prepared by a competent engineer, showing the district and county in which the tract of land is located, the name and acreage of same, the names of the owners and adjacent tracts, and the location of the about to be abandoned well, determined by survey, and the courses and distances of such well from two permanent points or landmarks on said tract, shall be submitted with this notice.

(Over)

B-9

PROPOSED MANNER OF PLUGGING AND FILLING WELL

(REQUIRED BY RULES AND REGULATIONS)

WEST VIRGINIA DEPARTMENT OF MINES

OIL AND GAS DIVISION

WORK ORDER

Well to be plugged and filled as follows:

Bottom	Top	
5416	5414	Led Plug
5414	5376	Red Mud
5376	5371	Cement Plug
Pull 7" Casing		
4315	4315	Set Bridge
4315 4250	4355 4250	Red Mud
4355 4255	4350	Cement Plug
Pull 8" Casing		
	2105	Set Bridge
2105	2005	Red Mud
2005	2000	Cement Plug
	1510	Set Bridge
1510	1470	Red Mud
1470	1465	Cement Plug
Pull 13" Casing		
	30	Set Bridge
30	02	Red Mud
02	00	Cement

Note: WCO- 309 Shall be marked in cement monument.

To the Department of Mines Coal Owner or Operator, Lease or Property Owner.

Gentlemen:

This "work order" is submitted for your approval and concurrence and unless notified of your disapproval or non-concurrence, the undersigned will proceed with the plugging and filling of said well in the above described manner on the date stated in the notice of intention to plug and abandon the said well on opposite side of this sheet.

Very truly yours,

Well Operator.

No objections have been filed by the coal owner or coal operator, or any available adjacent lease or property owners or interposed by the Department of Mines to the manner herein described for the plugging and filling of the well above mentioned. Therefore, the same is hereby approved this

9th day of May, 1950, 194

12/15/2023

DEPARTMENT OF MINES Oil and Gas Division

By: C. N. Hall

NOTE: This "work order" shall be filed in triplicate, one copy for the files of the Department of Mines; one to be approved or corrected and returned to the well operator as his authority for plugging said well; and one for the well inspector.

E-6.

Clarence W. Meadows
Attorney and Public Relations Counsel
701-03 United Carbon Building
Charleston 1, West Virginia

Capitol 6-6222

July 24, 1950

Mr. C. N. Hall
Oil and Gas Division
Department of Mines
State Capitol
Charleston, W. Va.

Dear Senator:

I acknowledge receipt of your communication of July 22 requesting affidavits for the plugging of the Morris Well #1, permit Wir-288-P and the C. A. Barnett Well #2, permit Woo-309-P.

I was under the impression that these had been filed with you by the drilling contractor who has been paid in each instance and I am, therefore, forwarding these forms to Mr. C. J. Hughes of Logan, contractor on the Morris Well and Mr. E. M. Reynolds, of Ripley, contractor on the Barnett #2 Well, with the request that such be completed and forwarded to your office at an early date.

Very truly yours,

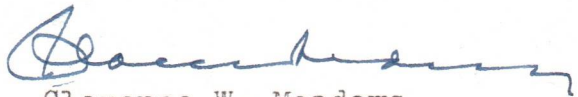

Clarence W. Meadows

CWM:PR

E-1



STATE OF WEST VIRGINIA
DEPARTMENT OF MINES
CHARLESTON

ARCH J. ALEXANDER
CHIEF

September 28, 1950

W00-309

Mr. E. M. Reynolds, Contractor
Ripley, West Virginia

Dear Mr. Reynolds:

We have been advised by Mr. Clarence W. Meadows that affidavit of plugging Well No. 2 on the C. A. Barnett Farm, Steele District, Wood County should be filed by you.

Please file one copy of form OG-8 for plugging the above-described well as soon as possible. Blanks are enclosed.

Very truly yours,

C. N. H. C.
Administrative Assistant
OIL AND GAS DIVISION

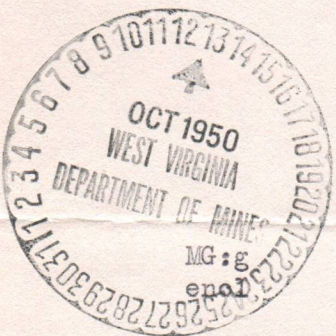

cc: Mr. Clarence W. Meadows

The day that we finished plugging this well my boys say that Mr. Robert Lafferty took the plugging permit with him the day they finished plugging the well.

If you will send me a copy we will fill it out.

E. M. Reynolds



STATE OF WEST VIRGINIA
DEPARTMENT OF MINES
CHARLESTON

September 2, 1930

RECEIVED
MAY 11 1931

Very truly yours,
[Illegible Signature]

[Illegible Text]

RECEIVED

[Illegible Text]

[Illegible Text]

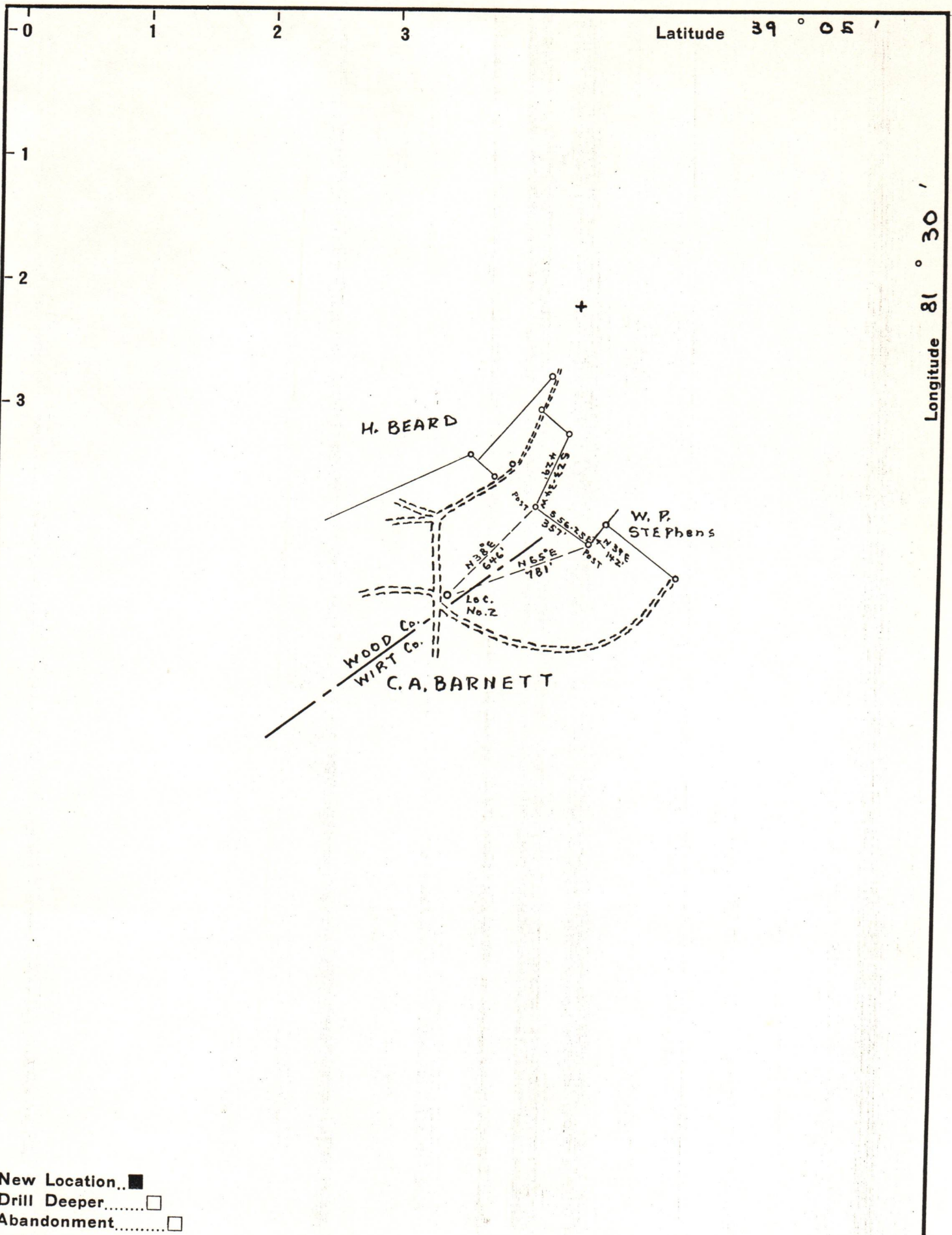

Latitude 39 ° 05 '

Longitude 81 ° 30 '

New Location..
 Drill Deeper.....
 Abandonment.....

Company CLARENCE W. MEADOWS, Agent
 Address 701-03 UNITED CARBON Bldg, Charleston, W. Va.
 Farm C.A. BARNETT
 Tract _____ Acres 245 Lease No. _____
 Well (Farm) No. 2 Serial No. L-449
 Elevation (Spirit Level) 1080.3 Gr.
 Quadrangle BELLEVILLE
 County Wood District STEELE
 Engineer Robert C. Lafferty
 Engineer's Registration No. 1654
 File No. 45 Drawing No. 2
 Date 1-3-50 Scale 1" = 660'

STATE OF WEST VIRGINIA
 DEPARTMENT OF MINES
 OIL AND GAS DIVISION
 CHARLESTON

WELL LOCATION MAP

FILE NO. W00-309 12/15/2023

+ Denotes location of well on United States Topographic Maps, scale 1 to 62,500, latitude and longitude lines being represented by border lines as shown.

- Denotes one inch spaces on border line of original tracing.