

STATE OF WEST VIRGINIA
DEPARTMENT OF MINES
OIL AND GAS DIVISION

NOTICE OF PROPOSED LOCATION OF OIL AND GAS WELL

To THE DEPARTMENT OF MINES,
Charleston, W. Va.

COAL OPERATOR OR COAL OWNER

ADDRESS

COAL OPERATOR OR COAL OWNER

ADDRESS

Mary Elizabeth Stuckey et al
OWNER OF MINERAL RIGHTS

Route 1, Windy, West Virginia
ADDRESS

UNITED CARBON COMPANY

NAME OF WELL OPERATOR

Box 1913, Charleston 27, W. Va.
COMPLETE ADDRESS

December 21, 1949

PROPOSED LOCATION

Steele District

Wood County

Well No. 1 37° 15' 51' 30"

Mary Elizabeth Stuckey et al Farm

GENTLEMEN:

The undersigned well operator is entitled to drill upon the above named farm or tract of land for oil and gas, having fee title thereto, (or as the case may be) under grant or lease dated November 10, 1949, made by Mary Elizabeth Stuckey et al, to United Carbon Company, and recorded on the - day of Now being recorded, in the office of the County Clerk for said County in Book -, page -.

The enclosed plat was prepared by a competent engineer and shows the proposed location of a well to be drilled for oil and gas by the undersigned well operator on the farm and in the Magisterial District and County above named, determined by survey and courses and distances from two permanent points, or land marks.

The undersigned well operator is informed and believes there are no coal operators operating beds of coal beneath said farm or tract of land on which said well is located, or within 500 feet of the boundaries of the same, who have mapped their workings and filed their maps as required by law, excepting the coal operators or coal owners (if any) above named as addressees.

The above named coal operators or coal owners (if any) are notified that any objections they may desire to make to such proposed location, or which they are required to make by Section 3 of said Code, if the drilling of a well at said proposed location will cause a dangerous condition in or about their respective coal mines, must be received by, or filed with the Department of Mines within ten* days from the receipt of a copy of this notice and accompanying plat by said Department. Said coal operators are further notified that forms for use in making such objections will be furnished to them by the Department of Mines promptly on request and that all such objections must set forth as definitely as is reasonably possible the ground or grounds on which such objections are based and indicate the direction and distance the proposed location should be moved to overcome same.

(The next paragraph is to be completed only in Department's copy.)

Copies of this notice and the enclosed plat were mailed by registered mail, or delivered to the above named coal operators or coal owners at their above shown respective address - day - before, or on the same day with the mailing or delivery of this copy to the Department of Mines at Charleston, West Virginia.

Very truly yours,

UNITED CARBON COMPANY

WELL OPERATOR

Box 1913

STREET

Charleston 27

CITY OR TOWN

West Virginia

STATE

12/15/2023

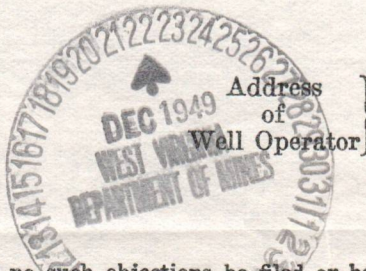

*Section 3 If no such objections be filed or be found by the department of mines, within said period of ten days from the receipt of said notice and plat by the department of mines, to said proposed location, the department shall forthwith issue to the well operator a drilling permit reciting the filing of such plat, that no objections have been made by the coal operators to the location, or found thereto by the department, and that the same is approved and the well operator authorized to proceed to drill at said location.

STATE OF WEST VIRGINIA
DEPARTMENT OF MINES
OIL AND GAS DIVISION

NOTICE OF PROPOSED LOCATION OF OIL AND GAS WELL

To The Department of Mines,
Charleston, W. Va.

NAME OF WELL OPERATOR	UNITED CARBON COMPANY	COAL OPERATOR OR COAL OWNER	
COMPLETE ADDRESS	Box 1913, Charleston, W. Va.	ADDRESS	
PROPOSED LOCATION	December 21, 1919	COAL OPERATOR OR COAL OWNER	
DISTRICT	Steels	ADDRESS	
COUNTY	Wood	OWNER OF MINERAL RIGHTS	Mary Elizabeth Stuckey et al
WELL NO.	I	ADDRESS	Route 1, Windy, West Virginia
NAME OF WELL OPERATOR	Mary Elizabeth Stuckey et al		

GENTLEMEN:

The undersigned well operator is entitled to drill upon the above named farm or tract of land for oil and gas having fee title thereto, (or as the case may be) under grant or lease dated _____ to _____ made by _____ Mary Elizabeth Stuckey et al _____ day _____ and recorded on the _____ day _____ of _____ Now being recorded _____ in the office of the County Clerk for said County in _____ Book _____ page _____

The enclosed plat was prepared by a competent engineer and shows the proposed location of a well to be drilled for oil and gas by the undersigned well operator on the farm and in the Magisterial District of _____ above named, determined by survey and courses and distances from two permanent points, or land marks.

The undersigned well operator is informed and believes there are no coal operators operating beds of coal beneath said farm or tract of land on which said well is located, or within 300 feet of the boundary of the same, who have marked their workings and filed their maps as required by law, excepting the coal operators or coal owners (if any) above named an addressee.

The above named coal operators or coal owners (if any) are notified that any objections they may desire to make to such proposed location, or which they are required to make by Section 3 of said Code, if the drilling of a well at said proposed location will cause a danger or condition in or about their respective coal mines must be received by or filed with the Department of Mines within ten days from the receipt of a copy of this notice and accompanying plat by said Department. Said coal operators are further notified that forms for use in making such objections will be furnished to them by the Department of Mines promptly on request and that all such objections must set forth as definitely as is reasonably possible the ground or grounds on which such objections are based and indicate the direction and distance the proposed location should be moved to overcome same.

(The next paragraph is to be completed only in Department's copy.)

Copies of this notice and the enclosed plat were mailed by registered mail, or delivered to the above named coal operators or coal owners at their above shown respective address _____ day _____ or on the same day with the mailing or delivery of this copy to the Department of Mines at Charleston, West Virginia.

Very truly yours

UNITED CARBON COMPANY
WELL OPERATOR

Box 1913
Charleston, W. Va.

CITY OR TOWN
West Virginia



12/15/2023

Section 3. If no such objections be filed or be found by the department of mines, within said period of ten days from the receipt of said notice and plat by the department of mines, to said proposed location, the department shall forthwith issue to the well operator a drilling permit locating the line of such plat, that no objections have been made by the coal operators to the location or found therein by the department, and that the same is approved and the well operator authorized to proceed to drill at said location.

A-10

January 3, 1949

United Carbon Company
Box 1913
Charleston, West Virginia

Gentlemen:

Enclosed is permit WOO-300 to drill Well
No. 1 on the Mary Elizabeth Stuckey et al Farm,
Steele District, Wood County.

Very truly yours,

Administrative Assistant
OIL AND GAS DIVISION

CNH:K
Encl-2

CC: Inspector O. C. Howard

12/15/2023

A-11

UNITED CARBON COMPANY

CARBON BLACKS, GASOLINE AND NATURAL GAS

UNITED CARBON BUILDING

CHARLESTON, WEST VIRGINIA

December 21, 1949

State of West Virginia
Department of Mines
Oil and Gas Division
Charleston 5, West Virginia

Attention: Mr. Arch J. Alexander, Chief

Gentlemen:

We are enclosing a notice and plat showing the location of our Mary Elizabeth Stuckey et al Well No. 1 which we propose to drill for oil and gas purposes, situate on the Left Fork of Sandy Creek, Steele District, Wood County, West Virginia.

Very truly yours,

UNITED CARBON COMPANY

E. S. Withrow
Assistant Engineer,

EGW:ml

Enclosures:2



12/15/2023

A-12

UNITED CARBON COMPANY

UNITED CARBON BUILDING

CHARLESTON, WEST VIRGINIA

July 27, 1950

State of West Virginia
Department of Mines
Oil and Gas Division
Charleston 5, West Virginia

Mr. Arch J. Alexander, Chief

Gentlemen:

We are enclosing the record of our Mary Elizabeth Stukey et al Well No. 1 on the Left Fork of Sandy Creek, Steele District, Wood County, permit WOO-300.

Very truly yours

UNITED CARBON COMPANY

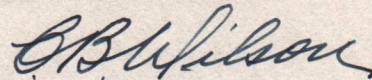

General Superintendent

CBW:ml

Enclosure

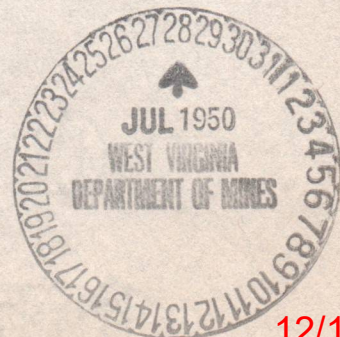

12/15/2023



STATE OF WEST VIRGINIA
DEPARTMENT OF MINES
OIL AND GAS DIVISION

WELL RECORD

Permit No. W00-300

Oil or Gas Well Gas
(KIND)

Company United Carbon Company
Address Box 1913, Charleston 27, W. Va.
Farm Mary Elizabeth Stucky et al Acres 52
Location (waters) Left Fork of Sandy Creek
Well No. 1 (1682) Elev. 960.4' gr.
District Steele County Wood
The surface of tract is owned in fee by Mary E. Stucky et al
Address Rt. 1, Windy, W. Va.
Mineral rights are owned by Same
Address _____

Drilling commenced February 1, 1950
Drilling completed May 27, 1950
Date Shot Not shot From _____ To _____
With _____

Open Flow /10ths Water in _____ Inch
/10ths Merc. in _____ Inch
Volume 12,990,000 Cu. Ft.
Rock Pressure 800 lbs. 15 hrs.
Oil _____ bbls., 1st 24 hrs.
~~Fresh~~ water 75'; 882'; 912 feet 1995 feet
Salt water _____ feet _____ feet

Casing and Tubing	Used in Drilling	Left in Well	Packers
Size			
16	14'	14'	Kind of Packer
13 3/8"	972'	972'	
10 3/4"	1476'	1476'	Size of
8 1/2 5/8"	2294' 1/4"	2294' 1/4"	Depth set
6% 7" OD	5162'	5162'	
5 3/16			
3			Perf. top
2 3/8"	5288'	5288'	Perf. bottom
Liners Used			Perf. top
			Perf. bottom

CASING CEMENTED 7" SIZE 10 bags No. Ft. _____ Date _____

COAL WAS ENCOUNTERED AT 1189 FEET 84 INCHES
____ FEET _____ INCHES FEET _____ INCHES
____ FEET _____ INCHES FEET _____ INCHES

Formation	Color	Hard or Soft	Top	Bottom	Oil, Gas or Water	Depth Found	Remarks
Surface			0	14			
Red Rock			14		Water	75'	1 1/2 blr. per hr.
Slate			189	198			
Red Rock			198	261			
Slate			261	280			
Red Rock			280	345			
Sand			345	358			
Red Rock			358	418			
Slate			418	430			
Red Rock			430	695			
Sand		Hard	695	715			
Red Rock			715	782			
Slate & Shells			782	842			
Sand			842	855			
Slate			855	868			
Sand			868	915	Water	882'	2 1/2 blrs. per hr.
Slate	White		915	956	Water	912'	5 blrs. per hr.
Red Rock			956	964			
Slate			964	983			
Sand			983	1005			
Slate	White		1005	1030			
Red Rock			1030	1124			
Slate & Shells			1124	1189			
Coal		Soft	1189	1196			
Slate			1196	1205			
Red Rock			1205	1260			
Slate			1260	1384			
Sand			1384	1404			
Slate & Shells			1404	1490			
Slate	Black		1490	1500			
Slate & Shells			1500	1541			
Sand		Soft	1541	1598			
Slate	Black		1598	1602			
Slate & Shells			1602	1710			
Sand		Broken	1710	1930			
Sand			1930	2230	Water	1995'	Hole full
Lime	Black		2230	2330			
Slate & Shells			2330	4110			
Shale	Brown		4110	4220			



12/15/2023

B-2

Formation	Color	Hard or Soft	Top	Bottom	Oil, Gas or Water	Depth Found	Remarks
Slate	White		4220	4263			
Shale	Brown		4263	4445			
Slate	White		4445	4965			
Shale	Brown		4965	5158			
Corniferous Lime			5158	5281			
Oriskany Sand			5281	5290	Gas	5284-5290'	12,990MCF
TOTAL DEPTH			5290'	5290'			

12/15/2023

DEPARTMENT OF MINES
STATE OF WEST VIRGINIA

Date June 19, 1950

APPROVED UNITED CARBON COMPANY, Owner

By *W. B. Wilson*
Gen. Supt., (Title)



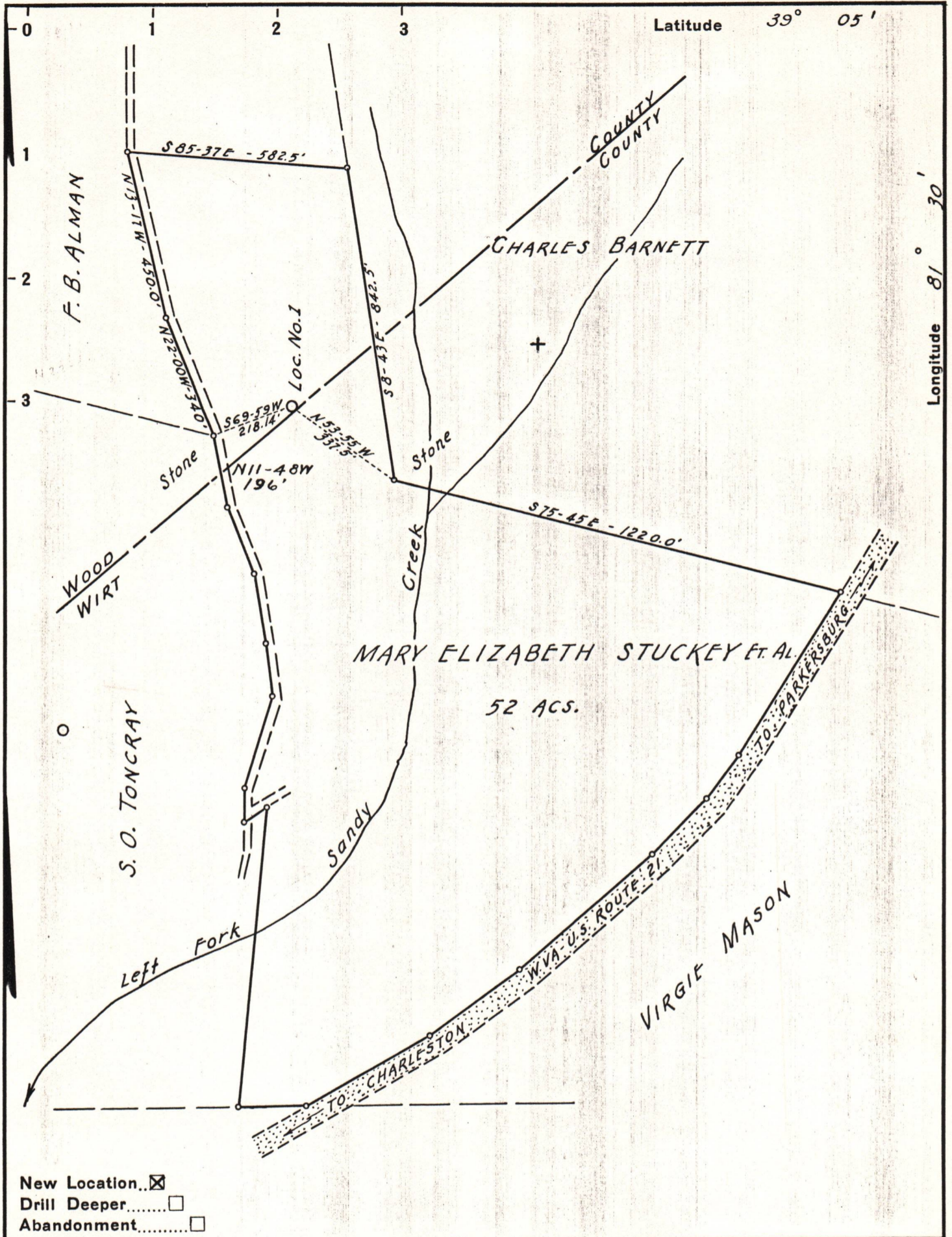

Company UNITED CARBON COMPANY

Address CHARLESTON, W.VA.

Farm MARY ELIZABETH STUCKEY ET AL.

Tract _____ Acres 52 Lease No. 6141

Well (Farm) No. ONE Serial No. 1682

Elevation (Spirit Level) 960.4 GR.

Quadrangle BELLVILLE S.E.

County WOOD District STEELE

Engineer E. G. Withrow

Engineer's Registration No. 1377 Ky.

File No. 97-D Drawing No. _____

Date Dec. 21, 1949 Scale 1" = 330'

STATE OF WEST VIRGINIA
 DEPARTMENT OF MINES
 OIL AND GAS DIVISION
 CHARLESTON

WELL LOCATION MAP

FILE NO. W00-300 12/15/2023

+ Denotes location of well on United States Topographic Maps, scale 1 to 62,500, latitude and longitude lines being represented by border lines as shown.

- Denotes one inch spaces on border line of original tracing.