

A1

STATE OF WEST VIRGINIA  
DEPARTMENT OF MINES  
OIL AND GAS DIVISION

NOTICE OF PROPOSED LOCATION OF OIL AND GAS WELL

To THE DEPARTMENT OF MINES,  
Charleston, W. Va.

No coal operation

---

COAL OPERATOR OR COAL OWNER

---

ADDRESS

---

COAL OPERATOR OR COAL OWNER

---

ADDRESS

---

OWNER OF MINERAL RIGHTS

---

ADDRESS

O. F. Kinney

---

NAME OF WELL OPERATOR

---

Walker, Route No. 2, W. Va.

---

COMPLETE ADDRESS

---

July 16, 1949

---

PROPOSED LOCATION

---

Walker District District

---

Wood County

---

Well No. 1 <sup>39° 20'</sup> <sub>81° 15'</sub>

---

W. W. Franklin Farm

GENTLEMEN:

The undersigned well operator is entitled to drill upon the above named farm or tract of land for oil and gas, having fee title thereto, (or as the case may be) under grant or lease dated September 15, 1947, made by Walter W. Franklin et al, to O. F. Kinney, and recorded on the        day of       , in the office of the County Clerk for said County in Book 301, page 163.

The enclosed plat was prepared by a competent engineer and shows the proposed location of a well to be drilled for oil and gas by the undersigned well operator on the farm and in the Magisterial District and County above named, determined by survey and courses and distances from two permanent points, or land marks.

The undersigned well operator is informed and believes there are no coal operators operating beds of coal beneath said farm or tract of land on which said well is located, or within 500 feet of the boundaries of the same, who have mapped their workings and filed their maps as required by law, excepting the coal operators or coal owners (if any) above named as addressees.

The above named coal operators or coal owners (if any) are notified that any objections they may desire to make to such proposed location, or which they are required to make by Section 3 of said Code, if the drilling of a well at said proposed location will cause a dangerous condition in or about their respective coal mines, must be received by, or filed with the Department of Mines within ten\* days from the receipt of a copy of this notice and accompanying plat by said Department. Said coal operators are further notified that forms for use in making such objections will be furnished to them by the Department of Mines promptly on request and that all such objections must set forth as definitely as is reasonably possible the ground or grounds on which such objections are based and indicate the direction and distance the proposed location should be moved to overcome same.

(The next paragraph is to be completed only in Department's copy.)

Copies of this notice and the enclosed plat were mailed by registered mail, or delivered to the above named coal operators or coal owners at their above shown respective address        day        before, or on the same day with the mailing or delivery of this copy to the Department of Mines at Charleston, West Virginia.

Very truly yours,

*O. F. Kinney*  
WELL OPERATOR  
Route NO. 2,  
STREET  
Walker,  
CITY OR TOWN  
W. Va.  
STATE

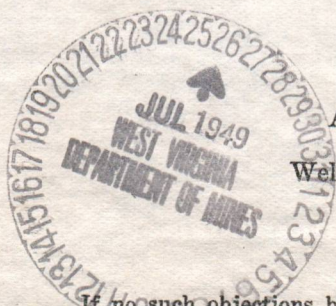

Address of Well Operator }

12/15/2023

\*Section 3 . . . . If no such objections be filed or be found by the department of mines, within said period of ten days from the receipt of said notice and plat by the department of mines, to said proposed location, the department shall forthwith issue to the well operator a drilling permit reciting the filing of such plat, that no objections have been made by the coal operators to the location, or found thereto by the department, and that the same is approved and the well operator authorized to proceed to drill at said location.

290



NOTICE OF PROPOSED LOCATION OF OIL AND GAS WELL

To The Department of Mines,  
Charleston, W. Va.

NAME OF WELL OPERATOR <u>O. E. Kinney</u>	COAL OPERATOR OR COAL OWNER <u>No coal operation</u>
COMPLETE ADDRESS <u>Box 10, Route 10, W. Va.</u>	ADDRESS <u></u>
PROPOSED LOCATION <u>W. Va.</u>	COAL OPERATOR OR COAL OWNER <u></u>
District <u>W. Va.</u>	ADDRESS <u></u>
County <u>W. Va.</u>	OWNER OR MINERAL RIGHTS <u></u>
Well No. <u>1</u>	ADDRESS <u></u>
Farm <u></u>	ADDRESS <u></u>

The undersigned well operator is entitled to drill upon the above named farm or tract of land for oil and gas having fee title thereto (or as the case may be) under grant or lease dated September 16, 1947, made by Walter W. Franklin et al to O. E. Kinney and recorded on the \_\_\_\_\_ day \_\_\_\_\_ in the office of the County Clerk for said County in Book 301, page 163.

The enclosed plat was prepared by a competent engineer and shows the proposed location of a well to be drilled for oil and gas by the undersigned well operator on the farm and in the Mineral District and County above named, determined by survey and courses and distances from two permanent points or land marks.

The undersigned well operator is informed and believes there are no coal operations operating on or beneath said farm or tract of land on which said well is located, or within 500 feet of the boundary of the same, who have signed their workings and filed their maps as required by law, excepting the coal operators or coal owners (if any) above named as addressees.

The above named coal operators or coal owners (if any) are notified that any objections they may desire to make to such proposed location or which they are required to make by Section 3 of said Code, if the drilling of a well at said proposed location will cause a dangerous condition in or about their respective coal mines, must be received by or filed with the Department of Mines within ten days from the receipt of a copy of this notice and accompanying plat by said Department. Said coal operators are further notified that forms for use in making such objections will be furnished to them by the Department of Mines promptly on request and that all such objections must set forth as definitely as is reasonably possible the ground or grounds on which such objections are based and indicate the direction and distance the proposed location should be moved to overcome same.

(The next paragraph is to be completed only in Department's copy.)  
Copies of this notice and the enclosed plat were mailed by registered mail, or delivered to the above named coal operators or coal owners at their above shown respective addresses \_\_\_\_\_ day \_\_\_\_\_ before or on the same day with the mailing or delivery of this copy to the Department of Mines at Charleston, West Virginia.

Very truly yours,

[Signature]  
WELL OPERATOR  
Route 10, Box 10  
STREET  
W. Va.  
CITY OR TOWN  
STATE

Address  
of  
Well Operator  
[Circular Stamp]

Section 3 of said Code provides that if a proposed location be filed on or be found by the Department of Mines within said period of ten days from the receipt of such notice and plat by the Department of Mines to cause a dangerous condition in or about their respective coal mines, the well operator or mining person retaining the title of such plat that no objections have been made by the coal operators or coal owners to the location or found location of the Department, and that the same is approved and the well operator authorized to proceed to drill at said location.

12/15/2023



A

July 22, 1950

Mr. O. F. Finney  
Route 2  
Walker, West Virginia

Dear Sir:

Please send affidavit for the plugging of Well No. 1 on the W. W. Franklin Farm, Walker District, Wood County for which permit WOO-290-P was issued January 17, 1950.

Forms OG-8 are enclosed.

Very truly yours,

Administrative Assistant  
OIL AND GAS DIVISION

CNH:K  
CC: Inspector O. C. Howard

12/15/2023





STATE OF WEST VIRGINIA  
DEPARTMENT OF MINES  
OIL AND GAS DIVISION

WELL RECORD

Permit No. W00-290

Oil or Gas Well Dry hol  
(KIND)

Company O. F. Kinney  
Address Waler, Rd. # 2, W. Va.  
W. W. Franklin  
Farm \_\_\_\_\_ Acres 87-1/2  
Location (waters) Issac's Fork-Bull Creek  
Well No. 1 Elev. see plat  
District Walker County Wood  
The surface of tract is owned in fee by W.W. Franklin  
Address Parkersburg, W. Va.  
Mineral rights are owned by W.W. Franklin and  
Norma Marshall, Address Parkersburg, W. Va.  
Drilling commenced Dec. 1, 1949  
Drilling completed Jan. 2, 1950  
Date Shot \_\_\_\_\_ From \_\_\_\_\_ To \_\_\_\_\_  
With \_\_\_\_\_

Casing and Tubing	Used in Drilling	Left in Well	Packers
Size			
16			Kind of Packer
13			
10			Size of
8 3/4	190	190	
6 1/4	1069	1069	Depth set
5 3/16			
3			Perf. top
2			Perf. bottom
Liners Used			Perf. top
			Perf. bottom

Open Flow \_\_\_\_\_ /10ths Water in \_\_\_\_\_ Inch  
\_\_\_\_\_ /10ths Merc. in \_\_\_\_\_ Inch  
Volume \_\_\_\_\_ Cu. Ft.  
Rock Pressure \_\_\_\_\_ lbs. \_\_\_\_\_ hrs.  
Oil \_\_\_\_\_ bbls., 1st 24 hrs.  
Fresh water \_\_\_\_\_ feet \_\_\_\_\_ feet  
Salt water \_\_\_\_\_ feet \_\_\_\_\_ feet

CASING CEMENTED \_\_\_\_\_ SIZE \_\_\_\_\_ No. Ft. \_\_\_\_\_ Date \_\_\_\_\_

COAL WAS ENCOUNTERED AT \_\_\_\_\_ FEET \_\_\_\_\_ INCHES  
\_\_\_\_\_ FEET \_\_\_\_\_ INCHES FEET \_\_\_\_\_ INCHES  
\_\_\_\_\_ FEET \_\_\_\_\_ INCHES FEET \_\_\_\_\_ INCHES

Formation	Color	Hard or Soft	Top	Bottom	Oil, Gas or Water	Depth Found	Remarks
Clay, red-rock & slate			0000	455			
Lime & shell			455'	470'			
Red rock, slate shell			470	1065			
Duncan sand			1065	1104			
Sand, slate gray rock			1104	1575			
Maxton sand			1575	1617			
Slate, shale, shell			1617	1669			
Slate, shells			1669	1716			
Injun Sand			1716	1817			Bottom of Hole- Dry



12/15/2023











STATE OF WEST VIRGINIA  
DEPARTMENT OF MINES  
OIL AND GAS DIVISION

INSPECTOR'S WELL REPORT

Permit No. \_\_\_\_\_

Oil or Gas Well \_\_\_\_\_  
(KIND)

Company _____ Address _____ Farm _____ Well No. _____ District _____ County _____ Drilling commenced _____ Drilling completed _____ Total depth _____ Date shot _____ Depth of shot _____ Initial open flow _____ /10ths Water in _____ Inch Open flow after tubing _____ /10ths Merc. in _____ Inch Volume _____ Cu. Ft. Rock pressure _____ lbs. _____ hrs. Oil _____ bbls., 1st 24 hrs. Fresh water _____ feet _____ feet Salt water _____ feet _____ feet	CASING AND TUBING	USED IN DRILLING	LEFT IN WELL	PACKERS
	Size			Kind of Packer _____
	16			Size of _____
	13			Depth set _____
	10			Perf. top _____
	8 1/4			Perf. bottom _____
	6 5/8			Perf. top _____
	5 3/16			Perf. bottom _____
	3			
	2			
	Liners Used _____			
	CASING CEMENTED _____ SIZE _____ No. FT. _____ Date _____			
	COAL WAS ENCOUNTERED AT _____ FEET _____ INCHES			
	_____ FEET _____ INCHES _____ FEET _____ INCHES			
	_____ FEET _____ INCHES _____ FEET _____ INCHES			

Drillers' Names \_\_\_\_\_

Remarks: \_\_\_\_\_

DATE \_\_\_\_\_

DISTRICT WELL INSPECTOR \_\_\_\_\_

12/15/2023



B-3

STATE OF WEST VIRGINIA  
DEPARTMENT OF MINES  
OIL AND GAS DIVISION

INSPECTOR'S PLUGGING REPORT

Permit No. 290-0 Nov 28 1949 Well No. 1

COMPANY B H King ADDRESS Walker W Va.

FARM W W Franklin DISTRICT Walker COUNTY Wood

Filling Material Used clay and cement

Liner Location Amount Packer Location

PLUGS USED AND DEPTH PLACED			BRIDGES	CASING AND TUBING		
CEMENT-THICKNESS	WOOD-SIZE	LEAD	CONSTRUCTION-LOCATION	RECOVERED	SIZE	LOST
	clay		1517 - 1660			
10'	5" stone		1660 - 1635			
	Bucky		1260			
10'	5" stone		1260 - 1235			
	clay		1235 - 1100			
10'	5" stone		1100 - 1085			
	clay		1085 - 960			
10'	5" stone		960 - 935			
	Bucky		460			
10'	5" stone		460 - 435 Clay to surface			

Drillers' Names Arthur Motes Brooks Harper

Remarks:

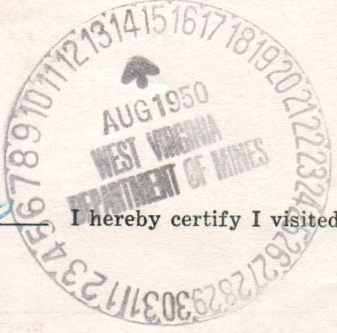

8-7-1950  
DATE

I hereby certify I visited the above well on this date.

Al Stewart

DISTRICT WELL INSPECTOR  
12/15/2023



STATE OF WEST VIRGINIA  
DEPARTMENT OF MINES  
OIL AND GAS DIVISION

## INSPECTOR'S WELL REPORT

Permit No. \_\_\_\_\_

Oil or Gas Well \_\_\_\_\_  
(KIND)

	CASING AND TUBING	USED IN DRILLING	LEFT IN WELL	PACKERS
Company _____				
Address _____	Size			
Farm _____	16			Kind of Packer _____
Well No. _____	13			
District _____ County _____	10			Size of _____
Drilling commenced _____	8 1/4			
Drilling completed _____ Total depth _____	6 5/8			Depth set _____
Date shot _____ Depth of shot _____	5 3/16			
Initial open flow _____ /10ths Water in _____ Inch	3			Perf. top _____
Open flow after tubing _____ /10ths Merc. in _____ Inch	2			Perf. bottom _____
Volume _____ Cu. Ft.	Liners Used			Perf. top _____
Rock pressure _____ lbs. _____ hrs.				Perf. bottom _____
Oil _____ bbls., 1st 24 hrs.	CASING CEMENTED _____ SIZE _____ No. FT. _____ Date _____			
Fresh water _____ feet _____ feet	COAL WAS ENCOUNTERED AT _____ FEET _____ INCHES			
Salt water _____ feet _____ feet	_____ FEET _____ INCHES _____ FEET _____ INCHES			

Drillers' Names \_\_\_\_\_

Remarks: \_\_\_\_\_

DATE

DISTRICT WELL INSPECTOR

12/15/2023





STATE OF WEST VIRGINIA  
DEPARTMENT OF MINES  
OIL AND GAS DIVISION

NOTICE OF INTENTION TO PLUG AND ABANDON WELL

(REQUIRED BY SECTION 9, ARTICLE 4, CHAPTER 22 OF THE CODE)

To THE DEPARTMENT OF MINES,  
Charleston, W. Va.

None  
-----  
COAL OPERATOR OR COAL OWNER

O. F. Kinney

-----  
NAME OF WELL OPERATOR

-----  
ADDRESS

Walker, Rd. #2, W. Va.

-----  
COMPLETE ADDRESS

-----  
COAL OPERATOR OR COAL OWNER

January 12

-----  
19 50

WELL TO BE ABANDONED

-----  
ADDRESS

Walker

-----  
District

-----  
LEASE OR PROPERTY OWNER

Wood

-----  
County

-----  
ADDRESS

Well No. 1

W. W. Franklin

-----  
Farm

NOTIFY INSPECTOR O. C. HOWARD - GRANTSVILLE - TELEPHONE 108  
24 HOURS IN ADVANCE OF PLUGGING DATE

Gentlemen:—

The undersigned well operator is about to abandon the above described well and will commence

the work of plugging and abandoning said well on the 28th day of January, 19 50,  
(which date shall not be less than five days after the day on which this notice so mailed is received,  
or in due course should be received by the Department of Mines.)

This notice is given you in order that your respective representatives may be present at the  
plugging and filling of said well. You are further notified that whether you are represented or not  
represented the undersigned will proceed on that date, or shortly thereafter, to plug and fill said  
well in the manner required by Section 10, Article 4, Chapter 22 of the Code and given in detail on the  
reverse side of this notice, in "Work Order."

This notice is being mailed by registered mail to each of you at the above addresses on the  
above date.

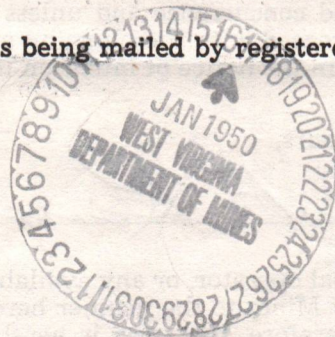

Very truly yours,

*O. F. Kinney*

-----  
Well Operator.

12/15/2023

NOTE: Upon the abandonment of all wells drilled prior to June 1, 1929, a plat prepared by a competent  
engineer, showing the district and county in which the tract of land is located, the name and acreage of same,  
the names of the owners and adjacent tracts, and the location of the about to be abandoned well, determined  
by survey, and the courses and distances of such well from two permanent points or landmarks on said tract, shall  
be submitted with this notice.

(Over)



PROPOSED MANNER OF PLUGGING AND FILLING WELL

(REQUIRED BY RULES AND REGULATIONS)

WEST VIRGINIA DEPARTMENT OF MINES

OIL AND GAS DIVISION

WORK ORDER

Well to be plugged and filled as follows:

WORK ORDER PREPARED BY THE DEPARTMENT OF MINES

Total Depth 1817'

Fill with red clay from bottom 1817' - 1650' - a point in the Big Lime  
Neat Cement 1650' - 1640'  
5' crushed stone on cement plug - sealing hole completely below Big Lime

SET A PERMANENT BRIDGE AT 1250' - a point in the Salt Sands  
2 sacks neat cement and 5' crushed stone on bridge  
Fill with clay to 1100' - 31' below 6-1/4" casing  
Neat Cement 1100' - 1090'  
5' crushed stone on cement plug - sealing hole completely below 6" casing

Pull 6-1/4" casing and

Continue filling with clay to 950'  
Neat Cement 950' - 940'

SET A PERMANENT BRIDGE AT 460'  
2 sacks neat cement and 5' crushed stone on bridge  
Fill with clay to 200' -- Pull 8-1/4" casing and  
Continue filling with clay to surface

Erect marker such as is described in Rule 18, 1931 Regulations

To the Department of Mines  
Coal Owner or Operator,  
Lease or Property Owner.

Gentlemen:

This "work order" is submitted for your approval and concurrence and unless notified of your disapproval or non-concurrence, the undersigned will proceed with the plugging and filling of said well in the above described manner on the date stated in the notice of intention to plug and abandon the said well on opposite side of this sheet.

Very truly yours,

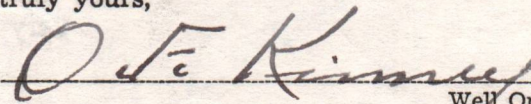
  
Well Operator.

No objections have been filed by the coal owner or coal operator, or any available adjacent lease or property owners or interposed by the Department of Mines to the manner herein described for the plugging and filling of the well above mentioned. Therefore, the same is hereby approved this

17th day of January, 1950, 19

DEPARTMENT OF MINES  
Oil and Gas Division

By: 

NOTE: This "work order" shall be filed in triplicate, one copy for the files of the Department of Mines; one to be approved or corrected and returned to the well operator as his authority for plugging said well; and one for the well inspector.



STATE OF WEST VIRGINIA  
DEPARTMENT OF MINES  
OIL AND GAS DIVISION

AFFIDAVIT OF PLUGGING AND FILLING WELL

AFFIDAVIT SHOULD BE MADE IN TRIPLICATE, ONE COPY MAILED TO THE DEPARTMENT, ONE COPY TO BE RETAINED BY THE WELL OPERATOR AND THE THIRD COPY (AND EXTRA COPIES IF REQUIRED) SHOULD BE MAILED TO EACH COAL OPERATOR AT THEIR RESPECTIVE ADDRESSES.

O.F. KINNEY  
NAME OF WELL OPERATOR

WALKER, ROUTE #2, W.VA.  
COMPLETE ADDRESS

Nov. 15 1952  
WELL AND LOCATION

WALKER District

WOOD County

Well No. 1

W.W. FRANKLIN Farm

O.C. HOWARD  
STATE INSPECTOR SUPERVISING PLUGGING

AFFIDAVIT

STATE OF WEST VIRGINIA,

County of WOOD } SS:

ARTHUR S. MOATS and HARRY DALLISON  
being first duly sworn according to law depose and say that they are experienced in the work of plugging and filling oil and gas wells and were employed by O.F. KINNEY, well operator, and participated in the work of plugging and filling the above well, that said work was commenced on the APRIL day of 1952, and that the well was plugged and filled in the following manner:

SAND OR ZONE RECORD	FILLING MATERIAL	PLUGS USED	CASING	
			CSG PULLED	CSG LEFT IN
FORMATION	<u>RED CLAY 1817-1650</u>	<u>1 1/2" - 1650</u>		
	<u>CEMENT - 1650 - 1640</u>			
	<u>STONE - 1640 - 1635</u>			
	<u>BRIDGE AT 1200</u>			
	<u>CEMENT 1200 - 1190</u>			
	<u>STONE 1190 - 1185</u>			
	<u>CLAY 1185 - 1100</u>			
	<u>CEMENT 1100 - 1090</u>	<u>6 3/4 - 1069</u>		<u>NONE</u>
	<u>STONE 1090 - 1085</u>			
	<u>CLAY 1085 - 950</u>			
	<u>CEMENT 950 940</u>			
	<u>BRIDGE AT 450</u>			
	<u>CEMENT 450 440</u>			
	<u>STONE 440 430</u>	<u>8 1/4</u>	<u>200</u>	<u>NONE.</u>
	<u>CLAY TO SURFACE</u>			
COAL SEAMS			DESCRIPTION OF MONUMENT	
(NAME)			<u>PIECE OF 6" CASING</u>	
(NAME)			<u>FILLED WITH CEMENT.</u>	
(NAME)				
(NAME)				

and that the work of plugging and filling said well was completed on the APRIL day of 1952

And further deponents saith not.

Sworn to and subscribed before me this 16 day of Nov, 1952

My commission expires: March 1st 1956

Harry Dallison  
Arthur S. Moats  
William E. Harris

12/15/2023

Notary Public.

Permit No. 200-290-P

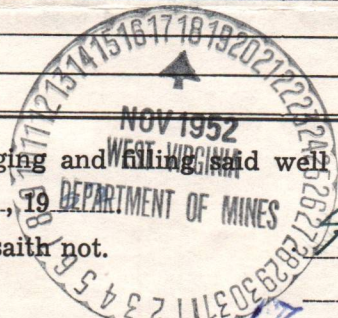



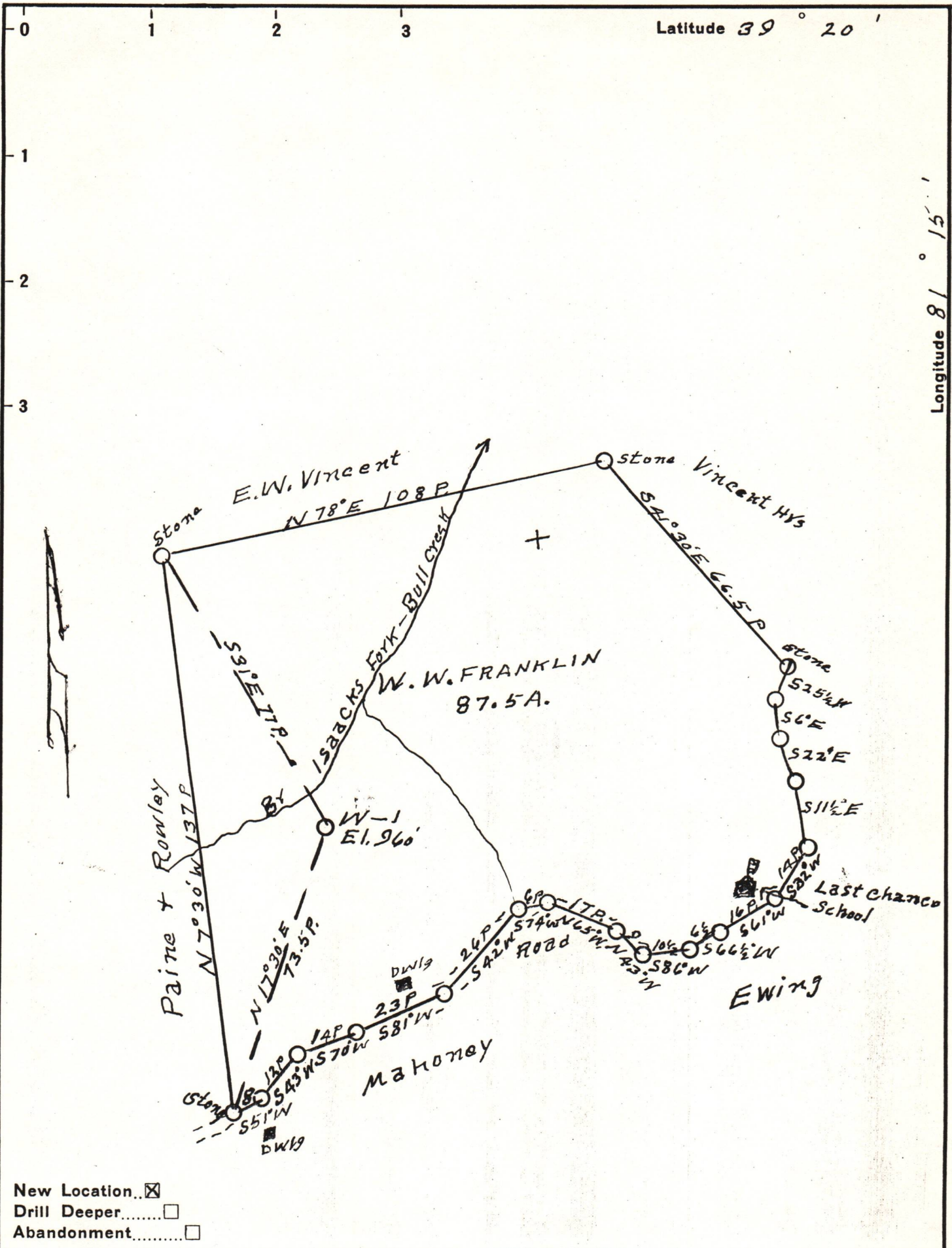

Latitude 39° 20'

Longitude 81° 15'

- New Location...
- Drill Deeper.....
- Abandonment.....

Company O.F. KINNEY  
 Address RD No 2, WALKER, W.Va.  
 Farm W.W. FRANKLIN  
 Tract \_\_\_\_\_ Acres 87½ Lease No. \_\_\_\_\_  
 Well (Farm) No. 1 Serial No. \_\_\_\_\_  
 Elevation (Spirit Level) 960'  
 Quadrangle MARIETTA  
 County WOOD District WALKER  
 Engineer Robert R. Anderson  
 By J.E. ANDERSON Engineer's Registration No. 296  
 File No. \_\_\_\_\_ Drawing No. 296  
 Date JULY 23, 1949 Scale 1 in = 30 Poles

STATE OF WEST VIRGINIA  
 DEPARTMENT OF MINES  
 OIL AND GAS DIVISION  
 CHARLESTON

**WELL LOCATION MAP**  
 FILE NO. W00-29215/2023

- + Denotes location of well on United States Topographic Maps, scale 1 to 62,500, latitude and longitude lines being represented by border lines as shown.
- Denotes one inch spaces on border line of original tracing.