

Latitude 39° 05'

Longitude 81° 35'

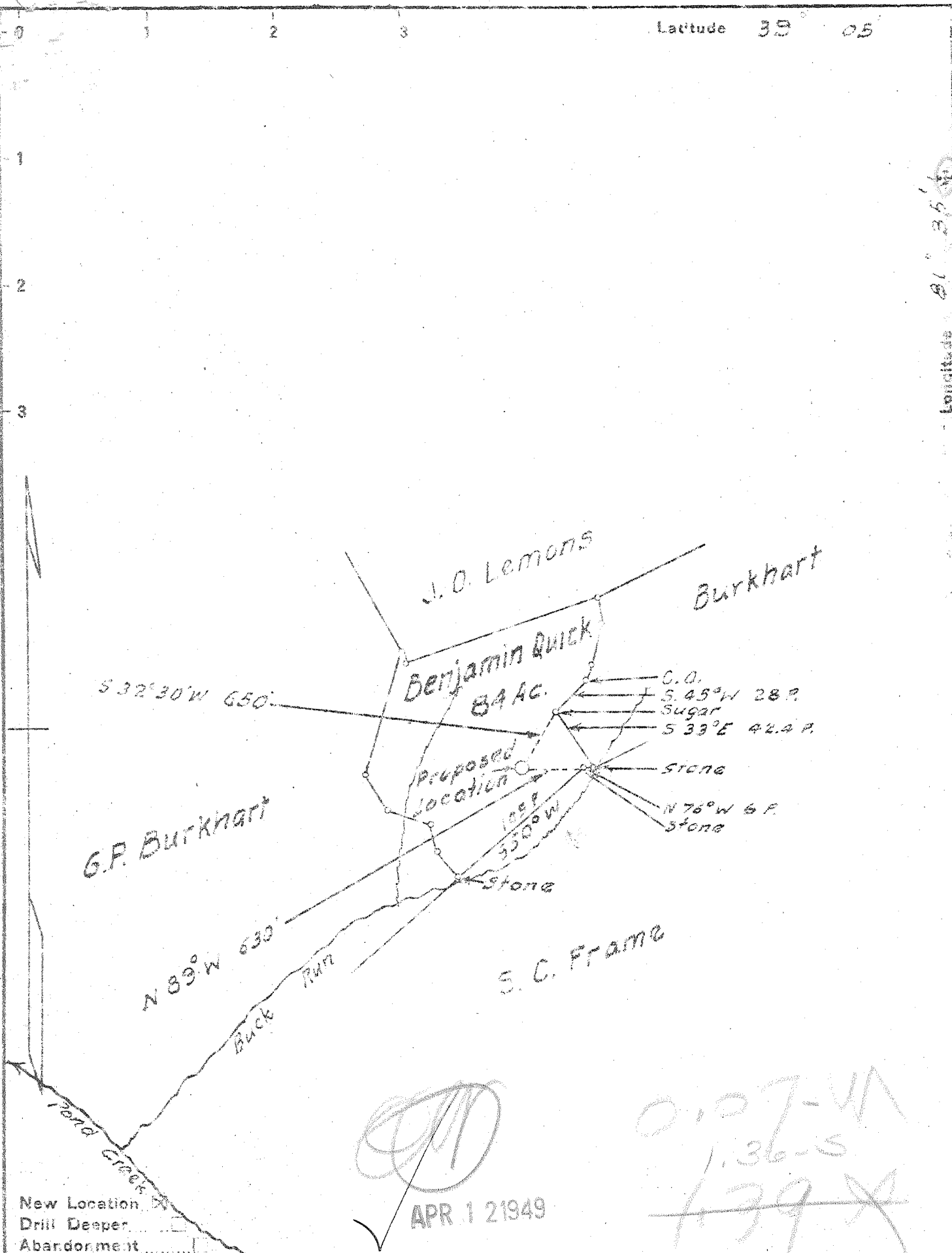

New Location
 Drill Deeper
 Abandonment

(Signature)
 APR 1 2 1949

0.07-41
 1.36-5
 179 X

Company Godfrey L. Cabot, Inc.
 Address 200 Union Bldg. Charleston, W. Va.
 Farm Benjamin Quick
 Tract _____ Acres 84 Lease No. 2-111
 Well (Farm) No. 1 Serial No. 1300
 Elevation (Spirit Level) 997
 Quadrangle Belleville
 County Wood District Steels
 Engineer Logan McDonald
 Engineer's Registration No. 610
 File No. _____ Drawing No. _____
 Date 3-14-49 Scale 1" = 1320'

STATE OF WEST VIRGINIA
 DEPARTMENT OF MINES
 OIL AND GAS DIVISION
 CHARLESTON

WELL LOCATION MAP
 FILE NO. W00-280

+ Denotes location of well on United States Topographic Maps, scale 1 to 62,500, latitude and longitude lines being represented by border lines as shown.
 - Denotes one inch spaces on border line of original tracing.

1.39 S. 39° 05'
 0.07 W. 81° 35'

WEST VIRGINIA DEPARTMENT OF MINES
 OIL & GAS DIVISION
 WELL RECORD

on W. side of Buck Run
 at Pond Creek
 8NE-(6-5)

P

Permit No. Woo 280	Godfrey L. Cabot, Inc.	Gas Well		
Belleville Quad. - SC	Charleston, W. Va.	CASING & TUBING	13	48# 264 204
Company	Benjamin Quick Acres		10	32.75# 1068 1068
Address			8	24# 1944 1944
Farm			7	24# 2182 2182
Location	serial 1300-#1 Elev. 997		5	4950 4950
Well No.	Steele Wood County		2	4.2#
District	April 26, 1949			4.6# 5066 5066
Commenced	Aug. 18, 1949			
Completed	16/10ths M in 2" 1 hr. A.S. when	Spang (1042-20# 908-		
Open flow	shut in	17#		
Volume	622 MCF (B.S. 40 MCF)			
Rock Pressure	1780 lbs. in 60 hrs. Oriskany			
Water	817° 1 1/2 blrs. per hr.			
	1645 2 blrs. per hr.; 1922° H.F.			
	1939° 80° - 1-1/2 hrs. continued to fill to 850°			
Date shot	8-19-49 Depth 5053 to 5069 with 40 qts.			

Surface	0	23	Blue Lime	2600	2975
Limestone	23	115	Slate & Shells	2975	3985
Pink Rock	115	210	Brown Shale	3985	4015
Sand	210	220	Slate & Shells	4015	4690
Red Rock	220	242	Brown Shale	4690	4945
Blue Slate	242	257	Corniferous	4945	5053
Red Rock	257	265	Oriskany	5053	5100
Slate & Shells	265	290	Lime - <i>held 20000</i>	5100	5104
Red Rock	290	380	T.D.		5104
Sand	380	420	SIM 1931:2188; 5053		
Red Rock	420	525	Gas 3815 show		
Slate	525	538	Gas 5053-5057; 174 MCF		
Red Rock	538	578			
Blue Lime	578	600			
Red Rock	600	620			
Blue Lime	620	640			
Red Rock	640	704			
Blue Lime	704	765			
Red Rock	765	785			
Blue Lime	785	800			
Black Slate	800	807			
Sand	807	860			
Slate Shells	860	914			
Sand	914	979			
Red Rock	979	1069			
Gray Lime	1069	1100			
Slate & Shell	1100	1150			
Red Rock	1150	1210			
Lime	1210	1225			
Slate-Shells	1225	1270			
Black Slate	1270	1320			
Gray Sand	1320	1332			
Dark Lime	1332	1355			
Sand	1355	1424			
Black Lime	1424	1475			
White Sand	1475	1543			
Slate-Shells	1543	1640			
White Sand	1640	1715			
Black Lime	1715	1778			
White Sand	1778	1800			
Lime	1800	1904			
Gray Sand	1904	1967			
Sand & Slate	1967	2000			
Sand	2000	2087			
Lime	2087	2132			
Slate & Shells	2132	2182			
Gray Lime	2182	2240			
Slate & Shells	2240	2448			
Black Shale	2448	2465			
Slate & Shells	2465	2549			
Blue Lime	2549	2580			
Slate & Shells	2580	2600			

4945 5053 5100
 997 997 997
 3948 4056 4103

485

Deep Well