

Latitude 33 05

Longitude 81° 30' 30" (74)
81° 30' 15" (15)

2.10-S
~~2.11-S~~
4.20 W
7 WC (6-5)

H.T. FRANK

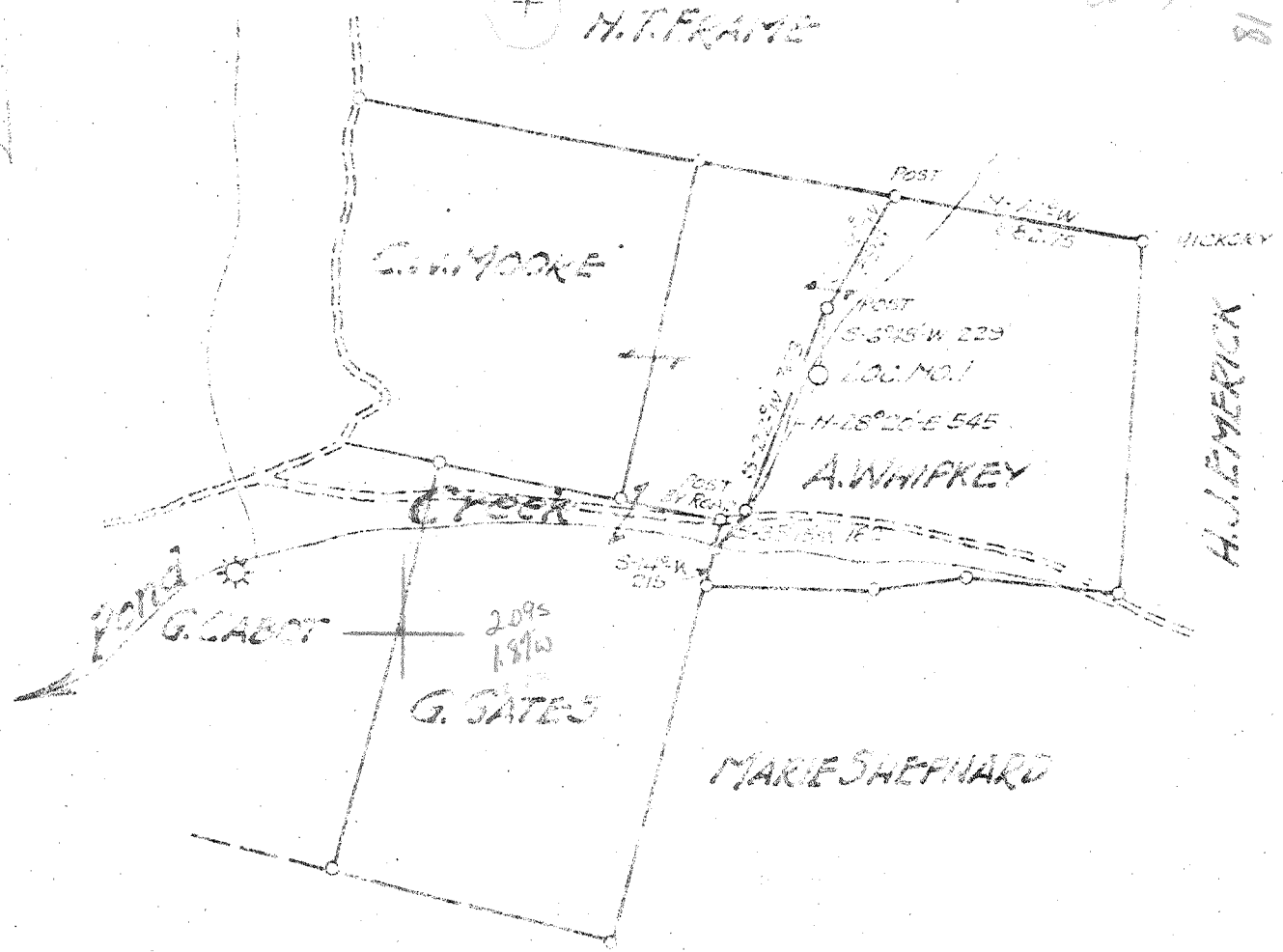

2095
181W
G. GATES

15' calc
2.095
4.10W

New Location
Drill Deeper
Abandonment

Company COLUMBIAN CARBON CO.
 Address BOX ST. CHARLESTON W.VA.
 Farm G.W. MOORE ET AL.
 Tract _____ Acres 132 Lease No. WV 1720
 Well (Farm) No. 1 Serial No. _____
 Elevation (Spirit Level) 171.67
 Quad angle BELLEVILLE-7-S-211 W-40
 County WOOD District STEELE
 Engineer C.O. Brubaker
 Engineer's Registration No. 683
 File No. _____ Drawing No. W 7/49
 Date 3/12/49 Scale 1" = 660'

STATE OF WEST VIRGINIA
DEPARTMENT OF MINES
OIL AND GAS DIVISION
CHARLESTON

WELL LOCATION MAP
FILE NO. WOO-219

* Denotes location of well on United States Topographic Maps, scale 1 to 62,500. latitude and longitude lines being represented by border lines as shown.

- Denotes one inch spaces on border line of original tracing.

Deep Well

WEST VIRGINIA DEPARTMENT OF MINES
OIL & GAS DIVISION
W E L L R E C O R D

Permit No. Woo 279
Bellville Quad.

Gas Well
CASING & TUBING

Company	Columbian Carbon Company
Address	Box 873, Charleston 23, W.Va. 16 42# 21'6 21'6
Farm	G.W. Moore et al Acres 132 13 3/8 48# 798'4 Fld.
Location	Pond Creek 10 1/2 40# 1089'4 Fld.
Well No.	1-GW-1124 Elev. 771.67'G 8 1/2 24# 1969'9 Fld.
District	Steele Wood County 6 5/8 24# 4815'2 Same
Surface	C.W. Moore et al, Rt. #1, 2 3/8 4# 4949'7 Same
	Rockport, W.Va. 3 1/2 94'9 Same
Mineral	Same (for further addresses contact C.C.Co.) Midget B.H. Packer
Commenced	4-12-49 Size 6 5/8
Completed	7-24-49 Depth 4783' SLM
Date shot	7-26-49 Depth 4924 to 4884
	with 250# 4" gelatin
Open flow	5/10ths W in 7" 23#
Volume	954,000 C.F.
Rock Pressure	1520 lbs. 5 days
Fresh Water	12' 1-16" blr. per hr.; 595' 2 blrs. per hr.
Salt Water	1230' 1 1/2-10" blr. per hr.; 1711' H.F.

Red Rock	0	12	Slate & Shells	2340	3485
Sand	12	28	Brown Shale	3485	3505
Red Rock	28	75	Slate & Shells	3505	3895
White Slate	75	80	Brown Shale	3895	4040
Red Rock	80	165	Slate & Shells	4040	4120
Blue Slate	165	175	Big White	4120	4470
Red Rock	175	225	Brown Shale	4470	4650
Sand	225	235	Black Shale 4766'DLM-4783'SLM		
Red Rock	235	292		4650	DLM 4766
Sand	292	345			SLM 4783
Red Rock	345	375	Corniferous Lime	4766'DLM	
Sand	375	405	Oriskany Sand	4884	4922
Red Rock	405	504	Lime - Heidelberg	4922	4964
Blue Slate	504	589	T.D.		4964
Sand	589	645	Gas 2400' show		
Slate	645	712	Gas 2500' show		
Sand	712	740	Gas pays:		
Blue Slate	740	760	4885-89 2/10 W 7" 23# 603 M		
Red Rock 793'DLM-794'SLM	760	793	4896-4900 30/10 W 2" 231 M		
White Slate	793	829	4907-4911 75/10 W 2" 365 M		
Red Rock	829	874	4922-24 30/10 W 2" 231 M		
Blue Slate	874	890			
Red Rock	890	900	CEMENT RECORD:		
Blue Slate	900	925	4-26-49 13 3/8" casing- ran 19 sacks		
Red Rock	925	993	of aquagel. No circulation or returns.		
Blue Slate	993	1025	5-2-49 10 1/2" casing- ran 20 sacks of		
Sand	1025	1075	aquagel. Circulation and returns.		
Lime 1080'DLM-1081'SLM	1075	1085	5-20-49 8 5/8" casing- ran 23 sacks		
Sand	1085	1173	of aquagel. Circulation but not returns		
Slate	1173	1200	6-29-49 6 5/8" casing-ran 60 sacks		
Sand	1200	1215	of aquagel. Got returns while pumping.		
Lime	1215	1275	C.C.Co.Crew		
Sand	1275	1330			
Slate	1330	1340			
Lime	1340	1407			
Slate	1407	1427			
Sand	1427	1510			
Slate	1510	1590			
Lime 8	1590	1624			
Sand	1624	1800			
Slate	1800	1811			
Sand	1811	1825			
Lime	1825	1837			
Slate	1837	1841			
Sand	1841	1855			
Lime 1961'DLM-1954 SLM	1855	2081			
Slate & Shells	2081	2261			
Brown Shale	2261	2293			
Slate	2293	2340			

4783 4884 4922
4772 772 772
4011 4112 4150

485