

STATE OF WEST VIRGINIA  
DEPARTMENT OF MINES  
OIL AND GAS DIVISION

NOTICE OF PROPOSED LOCATION OF OIL AND GAS WELL

To THE DEPARTMENT OF MINES,  
Charleston, W. Va.

NONE  
COAL OPERATOR OR COAL OWNER

---

ADDRESS

---

COAL OPERATOR OR COAL OWNER

---

ADDRESS

---

OWNER OF MINERAL RIGHTS

---

ADDRESS

H. Rey Helvenston  
NAME OF WELL OPERATOR

---

Box 7825, Pittsburgh, Pa.  
COMPLETE ADDRESS

---

August 13, 19 48  
PROPOSED LOCATION

---

Lubeck District

---

Wood County

---

Well No. 1 39° 15'  
81° 40'

---

E. E. Orem et al Farm

GENTLEMEN :

The undersigned well operator is entitled to drill upon the above named farm or tract of land for oil and gas, having fee title thereto, (or as the case may be) under grant or lease dated \_\_\_\_\_  
March, made by E. E. Orem et al, to  
H. Rey Helvenston, and recorded on the 14th day  
of February, 1948, in the office of the County Clerk for said County in  
Book 312, page 476.

The enclosed plat was prepared by a competent engineer and shows the proposed location of a well to be drilled for oil and gas by the undersigned well operator on the farm and in the Magisterial District and County above named, determined by survey and courses and distances from two permanent points, or land marks.

The undersigned well operator is informed and believes there are no coal operators operating beds of coal beneath said farm or tract of land on which said well is located, or within 500 feet of the boundaries of the same, who have mapped their workings and filed their maps as required by law, excepting the coal operators or coal owners (if any) above named as addressees.

The above named coal operators or coal owners (if any) are notified that any objections they may desire to make to such proposed location, or which they are required to make by Section 3 of said Code, if the drilling of a well at said proposed location will cause a dangerous condition in or about their respective coal mines, must be received by, or filed with the Department of Mines within ten\* days from the receipt of a copy of this notice and accompanying plat by said Department. Said coal operators are further notified that forms for use in making such objections will be furnished to them by the Department of Mines promptly on request and that all such objections must set forth as definitely as is reasonably possible the ground or grounds on which such objections are based and indicate the direction and distance the proposed location should be moved to overcome same.

(The next paragraph is to be completed only in Department's copy.)

Copies of this notice and the enclosed plat were mailed by registered mail, or delivered to the above named coal operators or coal owners at their above shown respective address \_\_\_\_\_ day \_\_\_\_\_ before, or on the same day with the mailing or delivery of this copy to the Department of Mines at Charleston, West Virginia.

Very truly yours,

H. Rey Helvenston  
WELL OPERATOR  
Box 7825, Pittsburgh, Pa.  
STREET  
By John R. Nickel  
CITY OR TOWN  
Attorney.  
STATE

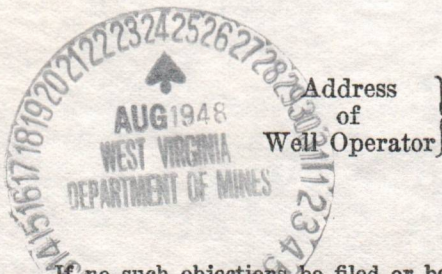

12/15/2023

\*Section 3 . . . . If no such objections be filed or be found by the department of mines, within said period of ten days from the receipt of said notice and plat by the department of mines, to said proposed location, the department shall forthwith issue to the well operator a drilling permit reciting the filing of such plat, that no objections have been made by the coal operators to the location, or found thereto by the department, and that the same is approved and the well operator authorized to proceed to drill at said location.

A-10

September 3, 1948

Mr. H. Roy Helvenston  
Box 7825  
Pittsburgh, Pennsylvania

Dear Sir:

Enclosed is permit WOO-260 to drill Well  
No. 1 on the E. E. Orem et al Farm, Lubeck District,  
Wood County.

Very truly yours,

Administrative Assistant  
OIL AND GAS DIVISION

CMH:K  
Encl-2

CC: Inspector O. C. Howard

12/15/2023



STATE OF WEST VIRGINIA  
DEPARTMENT OF MINES  
CHARLESTON

ARCH J. ALEXANDER  
CHIEF

February 3, 1950

Mr. H. R. Helvenston  
Box 7825  
Pittsburgh 16, Pennsylvania

Dear Sir:

We have never received affidavits for the  
plugging of the following wells:-

<u>PERMIT NO.</u>	<u>FARM</u>	<u>WELL NO.</u>	<u>DISTRICT</u>	<u>ISSUED</u>
WOO-254-P	Constance Hohlitzell	No. 2	Williams	6/25/48
WOO-260-P	E. E. Orem et al	No. 1	Lubeck	9/16/48
WOO-266-P	C. W. Butcher	No. 1	Lubeck	11/27/48

This information is long overdue and we would  
appreciate one copy of the affidavit for each of the above-named  
wells, as soon as possible.

Very truly yours,

Administrative Assistant  
OIL AND GAS DIVISION

MG:g  
encl

cc: O. G. Howard, Inspector

12/15/2023



STATE OF WEST VIRGINIA  
 DEPARTMENT OF MINES  
 CHARLESTON

ARCH J. ALEXANDER  
 CHIEF

February 2, 1920

Mr. H. A. Johnston  
 Box 7825  
 Pittsburgh 18, Pennsylvania

Dear Sir:

We have never received affidavits for the  
 signing of the following wells-

ISSUED	DISTRICT	WELL NO.	WELL NAME	PERMIT NO.
2/28/18	Williams	No. 5	Concession Coalfield	W00-284-7
2/13/18	Labadie	No. 1	H. A. Green et al	W00-280-1
11/27/18	Labadie	No. 1	G. W. Labadie	W00-281-2

This information is long overdue and we would  
 appreciate one copy of the affidavits for each of the above-named  
 wells, as soon as possible.

Very truly yours,

Administrative Assistant  
 Oil and Gas Division

WJG  
 encl

cc: G. D. Howard, Inspector



B-1

STATE OF WEST VIRGINIA DEPARTMENT OF MINES OIL AND GAS DIVISION

Bellville

WELL RECORD

Permit No. W00-260

Oil or Gas Well (KIND) Dry

Company: H. REY HELVENSTON
Address: OREM
Farm: OREM Acres: 150
Location (waters): OHIO RIVER
Well No. 1 Elev. 600
District: LUBECK County: WOOD
The surface of tract is owned in fee by E.E. OREM & J.C. OREM Address: PARKERSBURG WVA
Mineral rights are owned by H. REY HELVENSTON Address:
Drilling commenced SEPT. 1, 1948
Drilling completed SEPT. 14, 1948
Date Shot X From To
With
Open Flow /10ths Water in Inch
/10ths Merc. in Inch
Volume Cu. Ft.
Rock Pressure lbs. hrs.
Oil bbls., 1st 24 hrs.
Fresh water feet feet
Salt water feet feet

Table with columns: Casing and Tubing, Used in Drilling, Left in Well, Packers. Includes rows for sizes 16, 13, 10, 8 1/4, 6 1/2, 5 3/16, 3, 2 and packer details.

Table with columns: CASING CEMENTED, SIZE, No. Ft., Date. Includes rows for COAL WAS ENCOUNTERED AT with FEET and INCHES measurements.

Main geological log table with columns: Formation, Color, Hard or Soft, Top, Bottom, Oil, Gas or Water, Depth Found, Remarks. Lists various rock layers like SOIL, sand & gravel, slate, etc., with depths from 0 to 774.

12/15/2023

(Over) Well plugged - No affidavit

Formation	Color	Hard or Soft	Top	Bottom	Oil, Gas or Water	Depth Found	Remarks
			1720	1710			
			1700	1690			
			1680	1670			
			1660	1650			
			1640	1630			
			1620	1610			
			1600	1590			
			1580	1570			
			1560	1550			
			1540	1530			
			1520	1510			
			1500	1490			
			1480	1470			
			1460	1450			
			1440	1430			
			1420	1410			
			1400	1390			
			1380	1370			
			1360	1350			
			1340	1330			
			1320	1310			
			1300	1290			
			1280	1270			
			1260	1250			
			1240	1230			
			1220	1210			
			1200	1190			
			1180	1170			
			1160	1150			
			1140	1130			
			1120	1110			
			1100	1090			
			1080	1070			
			1060	1050			
			1040	1030			
			1020	1010			
			1000	990			
			980	970			
			960	950			
			940	930			
			920	910			
			900	890			
			880	870			
			860	850			
			840	830			
			820	810			
			800	790			
			780	770			
			760	750			
			740	730			
			720	710			
			700	690			
			680	670			
			660	650			
			640	630			
			620	610			
			600	590			
			580	570			
			560	550			
			540	530			
			520	510			
			500	490			
			480	470			
			460	450			
			440	430			
			420	410			
			400	390			
			380	370			
			360	350			
			340	330			
			320	310			
			300	290			
			280	270			
			260	250			
			240	230			
			220	210			
			200	190			
			180	170			
			160	150			
			140	130			
			120	110			
			100	90			
			80	70			
			60	50			
			40	30			
			20	10			
			0	0			

12/15/2023

Date \_\_\_\_\_, 19\_\_\_\_

APPROVED \_\_\_\_\_, Owner

By \_\_\_\_\_ (Title)

B-2

STATE OF WEST VIRGINIA  
 DEPARTMENT OF MINES  
 OIL AND GAS DIVISION

INSPECTOR'S PLUGGING REPORT

Permit No. Woo 210 P Well No. 1  
 COMPANY H Roy Helverston ADDRESS Pittsburgh Pa.  
 FARM C C Cream et al DISTRICT Letch COUNTY Wood

Filling Material Used clay and cement

Liner Location Amount Packer Location

PLUGS USED AND DEPTH PLACED			BRIDGES	CASING AND TUBING		
CEMENT-THICKNESS	WOOD-SIZE	LEAD	CONSTRUCTION-LOCATION	RECOVERED	SIZE	LOST
<i>Completed on inspection</i>						

Drillers' Names

Remarks:

10/7-1948  
 DATE

I hereby certify I visited the above well on this date.

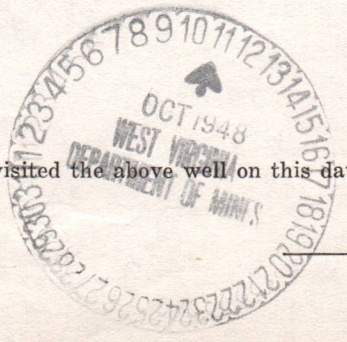

*Al Howard*

DISTRICT WELL INSPECTOR  
 12/15/2023

STATE OF WEST VIRGINIA  
 DEPARTMENT OF MINES  
 OIL AND GAS DIVISION

INSPECTOR'S WELL REPORT

Permit No. \_\_\_\_\_

Oil or Gas Well \_\_\_\_\_  
 (KIND)

		CASING AND TUBING	USED IN DRILLING	LEFT IN WELL	PACKERS
Company _____		Size			Kind of Packer _____
Address _____		16 _____			
Farm _____		13 _____			
Well No. _____		10 _____			Size of _____
District _____ County _____		8 1/4 _____			
Drilling commenced _____		6 5/8 _____			Depth set _____
Drilling completed _____ Total depth _____		5 3/16 _____			
Date shot _____ Depth of shot _____		3 _____			Perf. top _____
Initial open flow _____ /10ths Water in _____ Inch		2 _____			Perf. bottom _____
Open flow after tubing _____ /10ths Merc. in _____ Inch		Liners Used _____			Perf. top _____
Volume _____ Cu. Ft.					Perf. bottom _____
Rock pressure _____ lbs. _____ hrs.		CASING CEMENTED _____	SIZE _____	No. FT. _____	Date _____
Oil _____ bbls., 1st 24 hrs.		COAL WAS ENCOUNTERED AT _____ FEET _____ INCHES			
Fresh water _____ feet _____ feet		_____ FEET _____ INCHES	_____ FEET _____ INCHES	_____ FEET _____ INCHES	_____ FEET _____ INCHES
Salt water _____ feet _____ feet		_____ FEET _____ INCHES	_____ FEET _____ INCHES	_____ FEET _____ INCHES	_____ FEET _____ INCHES

Drillers' Names \_\_\_\_\_

Remarks: \_\_\_\_\_

DATE \_\_\_\_\_

DISTRICT WELL INSPECTOR



12/15/2023



PROPOSED MANNER OF PLUGGING AND FILLING WELL

(REQUIRED BY RULES AND REGULATIONS)

WEST VIRGINIA DEPARTMENT OF MINES

OIL AND GAS DIVISION

WORK ORDER

Well to be plugged and filled as follows:

WORK ORDER PREPARED BY THE DEPARTMENT OF MINES

Total Depth 774'

Fill with red clay from bottom 774' - 645'

Neat Cement 645' - 635'

5' crushed stone on cement plug - sealing off all salt water

SET A PERMANENT BRIDGE AT 336' - 30' below 6-5/8" casing

2 sacks neat cement and 5' crushed stone on bridge

PULL 6-5/8" casing

Fill with clay to surface

Erect marker such as is described in Rule 16, 1931 Regulations

To the Department of Mines  
Coal Owner or Operator,  
Lease or Property Owner.

Gentlemen:

This "work order" is submitted for your approval and concurrence and unless notified of your disapproval or non-concurrence, the undersigned will proceed with the plugging and filling of said well in the above described manner on the date stated in the notice of intention to plug and abandon the said well on opposite side of this sheet.

Very truly yours,

Well Operator.

No objections have been filed by the coal owner or coal operator, or any available adjacent lease or property owners or interposed by the Department of Mines to the manner herein described for the plugging and filling of the well above mentioned. Therefore, the same is hereby approved this

16th day of September, 1948, 19

DEPARTMENT OF MINES  
Oil and Gas Division

By: \_\_\_\_\_

NOTE: This "work order" shall be filed in triplicate, one copy for the files of the Department of Mines; one to be approved or corrected and returned to the well operator as his authority for plugging said well; and one for the well inspector.

B-8



STATE OF WEST VIRGINIA  
DEPARTMENT OF MINES  
OIL AND GAS DIVISION

NOTICE OF INTENTION TO PLUG AND ABANDON WELL

(REQUIRED BY SECTION 9, ARTICLE 4, CHAPTER 22 OF THE CODE)

To THE DEPARTMENT OF MINES,  
Charleston, W. Va.

no coal

COAL OPERATOR OR COAL OWNER

H. REY HELVENSTON

NAME OF WELL OPERATOR

BOX 7825

Pittsburgh, Pennsylvania

COMPLETE ADDRESS

ADDRESS

September 16,

19 48

COAL OPERATOR OR COAL OWNER

WELL TO BE ABANDONED

LUBECK

District

ADDRESS

WOOD

County

LEASE OR PROPERTY OWNER

Well No. 1

E. E. OREM et al

Farm

NOTIFY INSPECTOR O. C. HOWARD - GRANTSVILLE - TELEPHONE 108  
24 HOURS IN ADVANCE OF PLUGGING OPERATIONS

Gentlemen:--

The undersigned well operator is about to abandon the above described well and will commence

the work of plugging and abandoning said well on the \_\_\_\_\_ day of \_\_\_\_\_, 19 \_\_\_\_,  
(which date shall not be less than five days after the day on which this notice so mailed is received,  
or in due course should be received by the Department of Mines.)

This notice is given you in order that your respective representatives may be present at the  
plugging and filling of said well. You are further notified that whether you are represented or not  
represented the undersigned will proceed on that date, or shortly thereafter, to plug and fill said  
well in the manner required by Section 10, Article 4, Chapter 22 of the Code and given in detail on the  
reverse side of this notice, in "Work Order."

This notice is being mailed by registered mail to each of you at the above addresses on the  
above date.

Very truly yours,

*H. Rey Helvenston*

Well Operator.

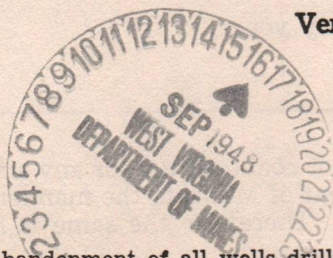

12/15/2023

NOTE: Upon the abandonment of all wells drilled prior to June 1, 1929, a plat prepared by a competent  
engineer, showing the district and county in which the tract of land is located, the name and acreage of same,  
the names of the owners and adjacent tracts, and the location of the about to be abandoned well, determined  
by survey, and the courses and distances of such well from two permanent points or landmarks on said tract, shall  
be submitted with this notice.

(Over)

WOO-260 -P

PERMIT NUMBER

Latitude 39° 15'

Longitude 81° 40'

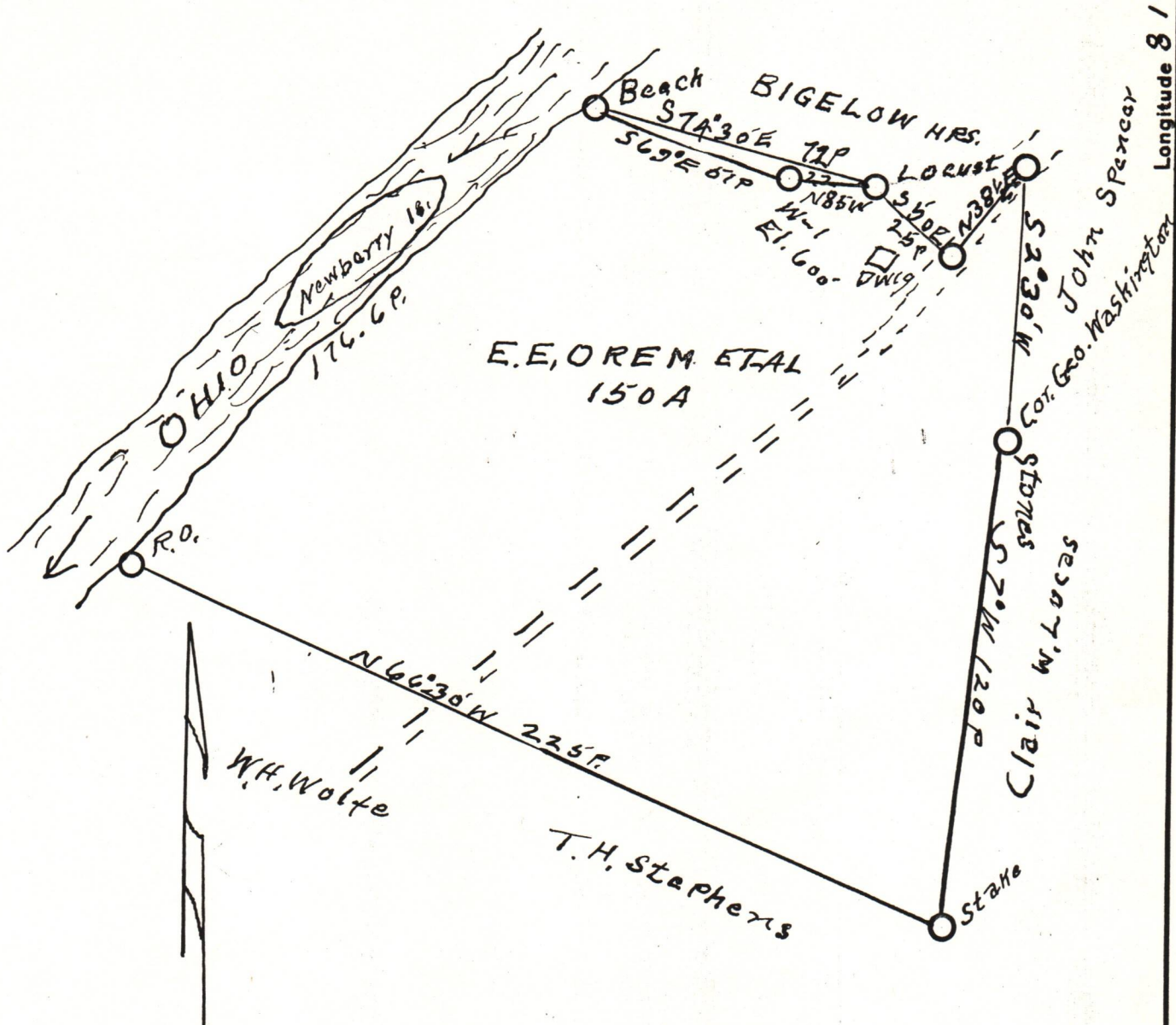

New Location..    
 Drill Deeper.....    
 Abandonment.....

Company H-REY HELVESTON   
 Address Box 7825 PITTSBURGH, PA.   
 Farm E.E. OREM ETAL   
 Tract \_\_\_\_\_ Acres 150 Lease No. \_\_\_\_\_   
 Well (Farm) No. 1 Serial No. \_\_\_\_\_   
 Elevation (Spirit Level) 600'   
 Quadrangle BLLEVILLE   
 County WOOD District LUBECK   
 Engineer Robert R. Anderson   
 per J.E.A.   
 Engineer's Registration No. 296   
 File No. \_\_\_\_\_ Drawing No. \_\_\_\_\_   
 Date Aug 13, 1948 Scale 1 in = 40 Feet

STATE OF WEST VIRGINIA   
 DEPARTMENT OF MINES   
 OIL AND GAS DIVISION   
 CHARLESTON

WELL LOCATION MAP   
 FILE NO. WOOD-266 12/15/2023

+ Denotes location of well on United States Topographic Maps, scale 1 to 62,500, latitude and longitude lines being represented by border lines as shown.   
 - Denotes one inch spaces on border line of original tracing.