

NOTICE OF PROPOSED LOCATION OF OIL AND GAS WELL

(REQUIRED BY SECTION 2, CHAPTER 22, CODE 1931)

WEST VIRGINIA DEPARTMENT OF MINES

OIL AND GAS SECTION

To THE DEPARTMENT OF MINES,
Charleston, W. Va.

Cancelled 6/30/48

none
COAL OPERATOR OR COAL OWNER

H. R. Helvenston
NAME OF WELL OPERATOR

ADDRESS

Hunt Road, Fox Chapel
Sharpsburg, Pa.
COMPLETE ADDRESS

COAL OPERATOR OR COAL OWNER

_____, 193____
PROPOSED LOCATION

ADDRESS

Williams District

OWNER OF MINERAL RIGHTS

Wood County

ADDRESS

Well No. One ^{39° 25'} _{81° 25'}

Constance Hoblitzell Farm

GENTLEMEN :

The undersigned well operator is entitled to drill upon the above named farm or tract of land for oil and gas, having fee title thereto, (or as the case may be) under grant or lease dated 6th of March, 1948, made by Constance Hoblitzell, to H. R. Helvenston, and recorded on the _____ day of April, 1948. in the office of the County Clerk for said County in

Book 307, page 532.

The enclosed plat was prepared by a competent engineer and shows the proposed location of a well to be drilled for oil and gas by the undersigned well operator on the farm and in the Magisterial District and County above named, determined by survey and courses and distances from two permanent points, or land marks.

The undersigned well operator is informed and believes there are no coal operators operating beds of coal beneath said farm or tract of land on which said well is located, or within 500 feet of the boundaries of the same, who have mapped their workings and filed their maps as required by law, excepting the coal operators or coal owners (if any) above named as addressees.

The above named coal operators or coal owners (if any) are notified that any objections they may desire to make to such proposed location, or which they are required to make by Section 3 of said Code, if the drilling of a well at said proposed location will cause a dangerous condition in or about their respective coal mines, must be received by, or filed with the Department of Mines within ten* days from the receipt of a copy of this notice and accompanying plat by said Department. Said coal operators are further notified that forms for use in making such objections will be furnished to them by the Department of Mines promptly on request and that all such objections must set forth as definitely as is reasonably possible the ground or grounds on which such objections are based and indicate the direction and distance the proposed location should be moved to overcome same.

(The next paragraph is to be completed only in Department's copy.)

Copies of this notice and the enclosed plat were mailed by registered mail, or delivered to the above named coal operators or coal owners at their above shown respective address _____ day _____ before, or on the same day with the mailing or delivery of this copy to the Department of Mines at Charleston, West Virginia.

Very truly yours,

H. R. Helvenston

WELL OPERATOR

Hunt Road, Fox Chapel
STREET

Sharpsburg
CITY OR TOWN

Pennsylvania
STATE

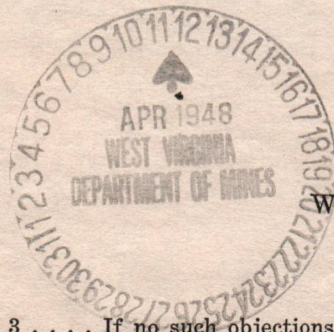

Address of Well Operator }

12/15/2023

*Section 3 If no such objections be filed, or be found by the department of mines, within said period of ten days from the receipt of said notice and plat by the department of mines, to said proposed location, the department shall forthwith issue to the well operator a drilling permit reciting the filing of such plat, that no objections have been made by the coal operators to the location, or found thereto by the department, and that the same is approved and the well operator authorized to proceed to drill at said location.

NOTICE OF PROPOSED LOCATION OF OIL AND GAS WELLS
WEST VIRGINIA DEPARTMENT OF MINES
OIL AND GAS SECTION

To the Department of Mines
Charleston, W. Va.

NAME OF WELL OPERATOR
ADDRESS

PROPOSED LOCATION

NAME OF WELL OPERATOR
ADDRESS

PROPOSED LOCATION

NAME OF WELL OPERATOR
ADDRESS

PROPOSED LOCATION

NAME OF WELL OPERATOR
ADDRESS

PROPOSED LOCATION

NAME OF WELL OPERATOR
ADDRESS

PROPOSED LOCATION

NAME OF WELL OPERATOR
ADDRESS

PROPOSED LOCATION

NAME OF WELL OPERATOR
ADDRESS

PROPOSED LOCATION

NAME OF WELL OPERATOR
ADDRESS

PROPOSED LOCATION

12/15/2023

A-10

HITESHEW, ADAMS & HICKEL

ATTORNEYS AND COUNSELLORS AT LAW

PARKERSBURG, W. VA.

June 29, 1948

HARRY O. HITESHEW
ISAAC M. ADAMS
JOHN R. HICKEL
DEWEY S. WASS
JOHN S. CATHER

OFFICES
PARKERSBURG, W. VA.
ST. MARYS, W. VA.

Department of Mines
Oil and Gas Division
Charleston, W. Va.

Attention Marie E. Griffith

Gentlemen:

We have and thank you for your letter of June 28th, returning the log book for Well No. 2 on the Constance Hoblitzell Farm, Williams District, Wood County.

Well No. 1 on said farm was not drilled for the reason that after the application was obtained, it was found that the drilling equipment could not be taken to the inaccessible location where the same was granted.

We will make the permit number corrections on the affidavits when submitted. We thank you for the courtesy extended to the writer while in Charleston last Friday.

Very truly yours

HITESHEW, ADAMS & HICKEL

By

John R. Hickel
John R. Hickel

Jrh:gh

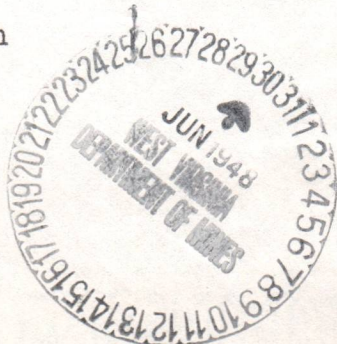

12/15/2023

HITESHU ADAMS & HICKEL

ATTORNEYS AND COUNSELLORS AT LAW

PARKERSBURG W. VA

June 29, 1918

HARRY O. HITCHCOCK
ISAAC M. KANE
JOHN B. HICKEL
GEORGE S. WARR
JOHN S. CATHER

OFFICE
PARKERSBURG W. VA
ST. MARTIN W. VA

Department of Mines
Oil and Gas Division
Charleston, W. Va.

Attention Maria E. Griffith

Gentlemen:

We have and thank you for your letter of June 28th, regarding the log book for Well No. 12 on the Constance Mitchell Farm, Williams District, Wood County.

The reason for the application was to determine if it was found that the drilling equipment would not be taken to the proposed location where the same was drilled.

We will make the permit number corrections on the affidavits when submitted. We thank you for the courtesy extended to the writer while in Charleston last Friday.

Very truly yours

HITESHU ADAMS & HICKEL

John B. Hickel
John B. Hickel

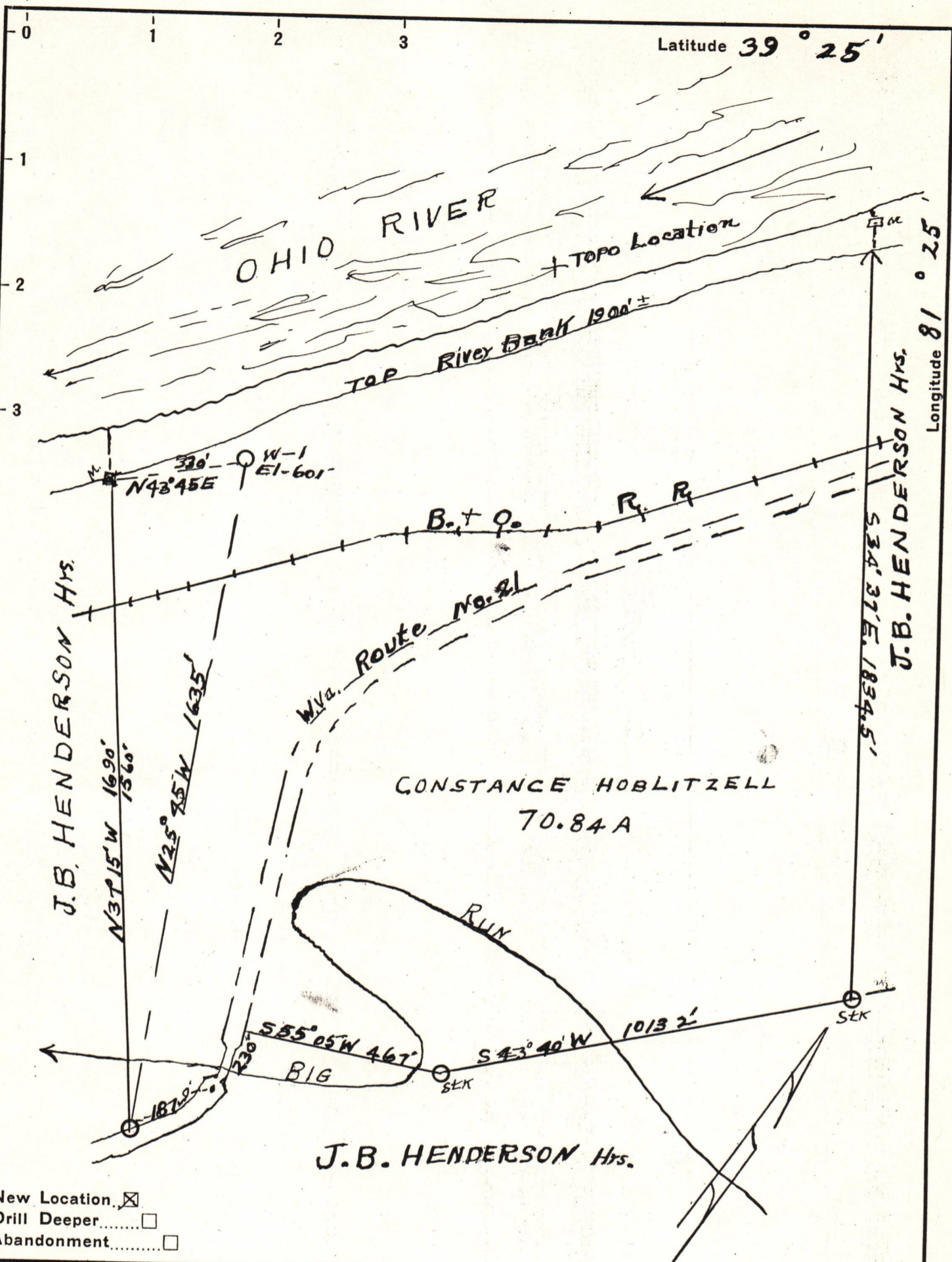

Company H.R. HELVESTON

Address P.O. BOX 7826 PITTSBURGH, PA.

Farm CONSTANCE HOBLITZELL

Tract 5 Acres 70.84 Lease No. _____

Well (Farm) No. 1 Serial No. _____

Elevation (Spirit Level) 601

Quadrangle MARIETTA

County WOOD District WILLIAMS

Engineer J.E. Anderson, Wood County

Engineer's Registration No. SURVEYOR

File No. _____ Drawing No. _____

Date APR. 5, 1948 Scale 1 in = 300 ft.

STATE OF WEST VIRGINIA
DEPARTMENT OF MINES
OIL AND GAS DIVISION
CHARLESTON

WELL LOCATION MAP
FILE NO. W00-249 **12/15/2023**
Cancelled 6/30/48

+ Denotes location of well on United States Topographic Maps, scale 1 to 62,500, latitude and longitude lines being represented by border lines as shown.

- Denotes one inch spaces on border line of original tracing.