

STATE OF WEST VIRGINIA
 DEPARTMENT OF MINES
 OIL AND GAS DIVISION

NOTICE OF PROPOSED LOCATION OF OIL AND GAS WELL

To THE DEPARTMENT OF MINES,
 Charleston, W. Va.

COAL OPERATOR OR COAL OWNER	UNITED FUEL GAS CO., <small>NAME OF WELL OPERATOR</small>
ADDRESS	% G. H. Moore P.O. Box 1273, Charleston 25, W. Va. <small>COMPLETE ADDRESS</small>
COAL OPERATOR OR COAL OWNER	June 3, 19 47 <small>PROPOSED LOCATION</small>
ADDRESS	Steele District
M. A. Webber <small>OWNER OF MINERAL RIGHTS</small>	Wood County
R.F.D. #2 Belleville, W. Va. <small>ADDRESS</small>	Well No. 6211 ^{39° 10'} _{81° 35'}
	M. A. Webber Farm

GENTLEMEN :

The undersigned well operator is entitled to drill upon the above named farm or tract of land for oil and gas, having fee title thereto, (or as the case may be) under grant or lease dated _____ December 21, 1944, made by M. A. Webber et ux, to Lee Batten, and recorded on the 10th day of April 1945, in the office of the County Clerk for said County in Book 260, page 395.

The enclosed plat was prepared by a competent engineer and shows the proposed location of a well to be drilled for oil and gas by the undersigned well operator on the farm and in the Magisterial District and County above named, determined by survey and courses and distances from two permanent points, or land marks.

The undersigned well operator is informed and believes there are no coal operators operating beds of coal beneath said farm or tract of land on which said well is located, or within 500 feet of the boundaries of the same, who have mapped their workings and filed their maps as required by law, excepting the coal operators or coal owners (if any) above named as addressees.

The above named coal operators or coal owners (if any) are notified that any objections they may desire to make to such proposed location, or which they are required to make by Section 3 of said Code, if the drilling of a well at said proposed location will cause a dangerous condition in or about their respective coal mines, must be received by, or filed with the Department of Mines within ten* days from the receipt of a copy of this notice and accompanying plat by said Department. Said coal operators are further notified that forms for use in making such objections will be furnished to them by the Department of Mines promptly on request and that all such objections must set forth as definitely as is reasonably possible the ground or grounds on which such objections are based and indicate the direction and distance the proposed location should be moved to overcome same.

(The next paragraph is to be completed only in Department's copy.)

Copies of this notice and the enclosed plat were mailed by registered mail, or delivered to the above named coal operators or coal owners at their above shown respective address Same day before, or on the same day with the mailing or delivery of this copy to the Department of Mines at Charleston, West Virginia.

Very truly yours,



Address of Well Operator }

UNITED FUEL GAS CO., <small>WELL OPERATOR</small>
% G. H. Moore <small>STREET</small>
P.O. Box 1273, Charleston 25, <small>CITY OR TOWN</small>
West Virginia 12/22/2023 <small>STATE</small>

*Section 3 If no such objections be filed or be found by the department of mines, within said period of ten days from the receipt of said notice and plat by the department of mines, to said proposed location, the department shall forthwith issue to the well operator a drilling permit reciting the filing of such plat, that no objections have been made by the coal operators to the location, or found thereto by the department, and that the same is approved and the well operator authorized to proceed to drill at said location.

228

A-10

June 14, 1947

United Fuel Gas Company
c/o G. H. Moore
Box 1273
Charleston, West Virginia

Gentlemen:

Enclosed is permit WOO-226 to drill Well
No. 6211 on the M. A. Webber Farm, Steele District,
Wood County.

Very truly yours,

Administrative Assistant
OIL AND GAS DIVISION

CHH:K
Encl-2

CC: Inspector G. E. Smith

12/22/2023



STATE OF WEST VIRGINIA DEPARTMENT OF MINES OIL AND GAS DIVISION

B-1

Beelville

WELL RECORD

Permit No. W00-228-P

ABANDONMENT

Oil or Gas Well Dry Hole (KIND)

Company United Fuel Gas Company
Address P.O. Box 1273, Charleston 25, W. Va.
Farm M. A. Webber Acres 121
Location (waters) North Fork
Well No. 6211 Elev. 818 3/4
District Steele County Wood
The surface of tract is owned in fee by
Mineral rights are owned by M. A. Webber
R.F.D. #2 Address Belleville, W. Va.
Drilling commenced 7-25-47
Drilling completed 4-17-48
Date Shot Not Shot From To
With
Open Flow /10ths Water in Inch
/10ths Merc. in Inch
Volume Cu. Ft.
Rock Pressure lbs. hrs.
Oil bbls., 1st 24 hrs.
Fresh water 340' 1143' feet feet
Salt water 1575, 5541 feet feet

Table with columns: Casing and Tubing, Used in Drilling, Left in Well, Packers. Includes rows for Size, Kind of Packer, Depth set, Perf. top/bottom.

CASING CEMENTED SIZE No. Ft. Date
COAL WAS ENCOUNTERED AT 620 FEET 48 INCHES
FEET INCHES FEET INCHES
FEET INCHES FEET INCHES

Main well log table with columns: Formation, Color, Hard or Soft, Top, Bottom, Oil, Gas or Water, Depth Found, Remarks. Includes geological descriptions and depth markers.



Handwritten signature and date 12/22/2023

B-2

Formation	Color	Hard or Soft	Top	Bottom	Oil, Gas or Water	Depth Found	Remarks
White Slate			3870	4280			
Brown Shale			4280	4515			
Corniferous Lime			4515	4625			
Oriskany Sand			4625	4666			
Lime			4666	5541			Water 5541' - Newburg.
Newburg(Dolomite)			5541	5566			
Lime			5566	5703			
Big Six Sand			5703	5735			
Broken Lime			5735	5756			
Red Lime			5756	5839			
Broken Lime			5839	5849			
Red Lime			5849	5880			
Broken Lime			5880	5965			
Red Lime			5965	6022			
Hard Lime			6022	6062			
Red Rock			6062	6064			
Slate			6064	6075			
Clinton Sand			6075	6141			
Lime			6141	6200			
Sand			6200	6212			
Red Medina			6212	6590			
Slate			6590	6595			
Red Medina			6595	6607			
Slate			6607	6627			
Total Depth			6627				

12/22/2023

DELIVERMENT OF WINES
BY THE MESSRS. LINDSAY

Date April 22, 19 48

APPROVED H. F. Gas Co, Owner

By G. H. Moore Chief Engineer (Title)

STATE OF WEST VIRGINIA
DEPARTMENT OF MINES
OIL AND GAS DIVISION

B-3

INSPECTOR'S PLUGGING REPORT

Permit No. Woo 229 P Well No. 6211
 COMPANY United Fuel Gas Co. ADDRESS Charleston W Va
 FARM M A Weber DISTRICT Steel COUNTY Wood
 Filling Material Used Gravel and cement

Liner Location Amount Packer Location

PLUGS USED AND DEPTH PLACED			BRIDGES	CASING AND TUBING		
CEMENT-THICKNESS	WOOD-SIZE	LEAD	CONSTRUCTION-LOCATION	RECOVERED	SIZE	LOST
	Bridges		6191-			
	Gravel		6191 - 6085-			
10'			6085- 6075-			
	Bridges		4785 Filling with gravel			

Drillers' Names Homer Bonnet John Stahaker

Remarks:

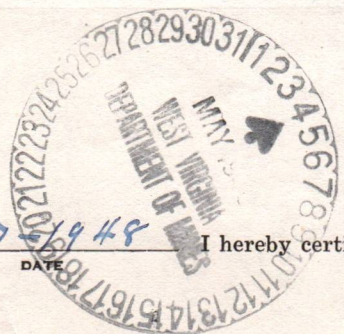

4/27/2023 I hereby certify I visited the above well on this date.

Clb Howard

DISTRICT WELL INSPECTOR
12/22/2023

STATE OF WEST VIRGINIA
DEPARTMENT OF MINES
OIL AND GAS DIVISION

INSPECTOR'S WELL REPORT

Permit No. _____

Oil or Gas Well _____
(KIND)

Company _____	CASING AND TUBING	USED IN DRILLING	LEFT IN WELL	PACKERS
Address _____	Size			
Farm _____	16			Kind of Packer _____
Well No. _____	13			
District _____ County _____	10			Size of _____
Drilling commenced _____	8 1/4			
Drilling completed _____ Total depth _____	6 5/8			Depth set _____
Date shot _____ Depth of shot _____	5 3/16			
Initial open flow _____ /10ths Water in _____ Inch	3			Perf. top _____
Open flow after tubing _____ /10ths Merc. in _____ Inch	2			Perf. bottom _____
Volume _____ Cu. Ft.	Liners Used			Perf. top _____
Rock pressure _____ lbs. _____ hrs.				Perf. bottom _____
Oil _____ bbls., 1st 24 hrs.	CASING CEMENTED _____	SIZE _____	No. FT. _____	Date _____
Fresh water _____ feet _____ feet	COAL WAS ENCOUNTERED AT _____ FEET _____ INCHES			
Salt water _____ feet _____ feet	_____ FEET _____ INCHES _____ FEET _____ INCHES			

Drillers' Names _____

Remarks: _____

DATE _____

DISTRICT WELL INSPECTOR _____
12/22/2023

B-4

STATE OF WEST VIRGINIA
DEPARTMENT OF MINES
OIL AND GAS DIVISION

INSPECTOR'S PLUGGING REPORT

Permit No. Woo 228

Well No. 6211

COMPANY United Fuel Gas Co. ADDRESS Charleston W Va

FARM M A Weber DISTRICT Steele COUNTY Wood

Filling Material Used

Liner Location Amount Packer Location

PLUGS USED AND DEPTH PLACED			BRIDGES	CASING AND TUBING		
CEMENT-THICKNESS	WOOD-SIZE	LEAD	CONSTRUCTION-LOCATION	RECOVERED	SIZE	LOST
	Gravel		5785 - 5713			
2 bags			5713			
	Bridg		5616			
	Gravel		5716 - 5541			
	Lead wood		5541 - 5536			
2 bags			5536 - 5526			
	Bridg		4716			
	Gravel		4716 - 4635			
2 bags			4635 - 4625			
	Gravel		4625 - 4550			
2 bags			4550 - 4540			
Casing completed to 7" casing						

Drillers' Names Harner Bennett John Stabaker

Remarks: Ready to rig casing

5/5-1948
DATE

I hereby certify I visited the above well on this date.

W. Howard

DISTRICT WELL INSPECTOR
12/22/2023

STATE OF WEST VIRGINIA
DEPARTMENT OF MINES
OIL AND GAS DIVISION

INSPECTOR'S WELL REPORT

Permit No. _____

Oil or Gas Well _____
(KIND)

Company _____ Address _____ Farm _____ Well No. _____ District _____ County _____ Drilling commenced _____ Drilling completed _____ Total depth _____ Date shot _____ Depth of shot _____ Initial open flow _____ /10ths Water in _____ Inch Open flow after tubing _____ /10ths Merc. in _____ Inch Volume _____ Cu. Ft. Rock pressure _____ lbs. _____ hrs. Oil _____ bbls., 1st 24 hrs. Fresh water _____ feet _____ feet Salt water _____ feet _____ feet	CASING AND TUBING Size 16 13 10 8 1/4 6 5/8 5 3/16 3 2 Liners Used	USED IN DRILLING	LEFT IN WELL	PACKERS Kind of Packer _____ Size of _____ Depth set _____ Perf. top _____ Perf. bottom _____ Perf. top _____ Perf. bottom _____
CASING CEMENTED _____ SIZE _____ No. FT. _____ Date _____				
COAL WAS ENCOUNTERED AT _____ FEET _____ INCHES				
_____ FEET _____ INCHES FEET _____ INCHES				
_____ FEET _____ INCHES FEET _____ INCHES				

Drillers' Names _____

Remarks: _____

DATE

DISTRICT WELL INSPECTOR

12/22/2023

B-10

STATE OF WEST VIRGINIA
DEPARTMENT OF MINES
OIL AND GAS DIVISION

INSPECTOR'S PLUGGING REPORT

Permit No. W00228P Well No. 6211

COMPANY United Fuel Gas Co ADDRESS Charleston WV^{va}

FARM M A Webber DISTRICT Steub COUNTY Wood

Filling Material Used Gravel clay Lead wool

Liner Location Amount Packer Location

PLUGS USED AND DEPTH PLACED			BRIDGES	CASING AND TUBING		
CEMENT-THICKNESS	WOOD-SIZE	LEAD	CONSTRUCTION-LOCATION	RECOVERED	SIZE	LOST
	Bridges		2060	3743	6 5/8	800
	clay		2060 - 2020			
10"			2020 - 2010			
	Adjustment	completed to 8 1/4" casing				
	Pulling	8 1/4" casing				

Drillers' Names John Stahake Howard Bonnet

Remarks:

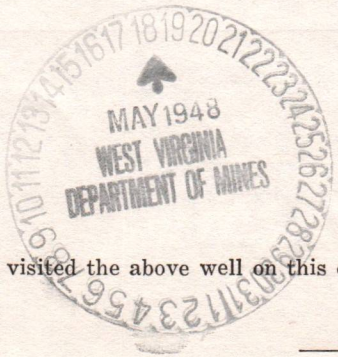

5/9-1948
DATE

I hereby certify I visited the above well on this date.

Ch Howard

DISTRICT WELL INSPECTOR
12/22/2023

STATE OF WEST VIRGINIA
DEPARTMENT OF MINES
OIL AND GAS DIVISION

INSPECTOR'S WELL REPORT

Permit No. _____

Oil or Gas Well _____
(KIND)

		CASING AND TUBING	USED IN DRILLING	LEFT IN WELL	PACKERS
Company _____		Size			
Address _____		16			Kind of Packer _____
Farm _____		13			
Well No. _____		10			Size of _____
District _____	County _____	8 1/4			
Drilling commenced _____		6 5/8			Depth set _____
Drilling completed _____		5 3/16			
Total depth _____		3			Perf. top _____
Date shot _____		2			Perf. bottom _____
Depth of shot _____		Liners Used			Perf. top _____
Initial open flow _____ /10ths Water in _____ Inch					Perf. bottom _____
Open flow after tubing _____ /10ths Merc. in _____ Inch					
Volume _____	Cu. Ft.	CASING CEMENTED _____	SIZE _____	No. FT. _____	Date _____
Rock pressure _____	lbs.				
	hrs.				
Oil _____	bbls., 1st 24 hrs.	COAL WAS ENCOUNTERED AT _____	FEET _____	INCHES _____	
Fresh water _____	feet	_____	FEET _____	INCHES _____	
Salt water _____	feet	_____	FEET _____	INCHES _____	

Drillers' Names _____

Remarks: _____



DATE

DISTRICT NO. 1 INSPECTOR

12/22/2023

B-1

STATE OF WEST VIRGINIA
DEPARTMENT OF MINES
OIL AND GAS DIVISION

INSPECTOR'S PLUGGING REPORT

Permit No. WV 228P Well No. 6211

COMPANY United Fuel Gas Co. ADDRESS Charleston W Va

FARM M A Weber DISTRICT State COUNTY Wood

Filling Material Used Gravel Lead wool clay and cement

Liner Location Amount Packer Location

PLUGS USED AND DEPTH PLACED			BRIDGES	CASING AND TUBING		
CEMENT-THICKNESS	WOOD-SIZE	LEAD	CONSTRUCTION-LOCATION	RECOVERED	SIZE	LOST
	Bridges		1625-	2006	8 1/4	00
	Clay		1625-1125			
10'			1125-1115			
	Clay		1115-1070			
	Bridges		654			
4 1/2 sacks			654-600			
	Clay		600-564			
	Clay		564 to surface			

Drillers' Names Howard Bonnett John Stahaker

Remarks: Completed 5/19-48



5/19-1948 I hereby certify I visited the above well on this date.
DATE

Albert Howard
DISTRICT WELL INSPECTOR

12/22/2023

STATE OF WEST VIRGINIA
DEPARTMENT OF MINES
OIL AND GAS DIVISION

INSPECTOR'S WELL REPORT

Permit No. _____

Oil or Gas Well _____
(KIND)

Company _____ Address _____ Farm _____ Well No. _____ District _____ County _____ Drilling commenced _____ Drilling completed _____ Total depth _____ Date shot _____ Depth of shot _____ Initial open flow _____ /10ths Water in _____ Inch Open flow after tubing _____ /10ths Merc. in _____ Inch Volume _____ Cu. Ft. Rock pressure _____ lbs. _____ hrs. Oil _____ bbls., 1st 24 hrs. Fresh water _____ feet _____ feet Salt water _____ feet _____ feet	CASING AND TUBING Size 16 13 10 8 1/4 6 5/8 5 3/16 3 2 Liners Used	USED IN DRILLING	LEFT IN WELL	PACKERS Kind of Packer _____ Size of _____ Depth set _____ Perf. top _____ Perf. bottom _____ Perf. top _____ Perf. bottom _____
CASING CEMENTED _____ SIZE _____ No. FT. _____ Date _____				
COAL WAS ENCOUNTERED AT _____ FEET _____ INCHES _____ FEET _____ INCHES _____ FEET _____ INCHES _____ FEET _____ INCHES _____ FEET _____ INCHES				

Drillers' Names _____

Remarks: _____

DATE _____

DISTRICT WELL INSPECTOR
12/22/2023



STATE OF WEST VIRGINIA
DEPARTMENT OF MINES
OIL AND GAS DIVISION

NOTICE OF INTENTION TO PLUG AND ABANDON WELL

(REQUIRED BY SECTION 9, ARTICLE 4, CHAPTER 22 OF THE CODE)

To THE DEPARTMENT OF MINES,
Charleston, W. Va.

COAL OPERATOR OR COAL OWNER

ADDRESS

COAL OPERATOR OR COAL OWNER

ADDRESS

M. A. Webber

LEASE OR PROPERTY OWNER

R.F.D. #2
Belleville, West Virginia

ADDRESS

UNITED FUEL GAS COMPANY

NAME OF WELL OPERATOR

C/O G. H. Moore
P.O. Box 1273, Charleston, W. Va.

COMPLETE ADDRESS

April 22, 1948

WELL TO BE ABANDONED

Steele District

Wood County

Well No. 6211

M. A. Webber Farm

NOTIFY INSPECTOR O. C. HOWARD, GRANTSVILLE, W. VA. - PHONE 108
Gentlemen:— 24 HOURS IN ADVANCE OF PLUGGING DATE.

The undersigned well operator is about to abandon the above described well and will commence the work of plugging and abandoning said well on the 26th day of April, 1948, (which date shall not be less than five days after the day on which this notice so mailed is received, or in due course should be received by the Department of Mines.)

This notice is given you in order that your respective representatives may be present at the plugging and filling of said well. You are further notified that whether you are represented or not represented the undersigned will proceed on that date, or shortly thereafter, to plug and fill said well in the manner required by Section 10, Article 4, Chapter 22 of the Code and given in detail on the reverse side of this notice, in "Work Order."

This notice is being mailed by registered mail to each of you at the above addresses on the above date.

Very truly yours,

UNITED FUEL GAS COMPANY

Well Operator.

12/22/2023

NOTE: Upon the abandonment of all wells drilled prior to June 1, 1929, a plat prepared by a competent engineer, showing the district and county in which the tract of land is located, the name and acreage of same, the names of the owners and adjacent tracts, and the location of the about to be abandoned well, determined by survey, and the courses and distances of such well from two permanent points or landmarks on said tract, shall be submitted with this notice.

(Over)

278-P
WOO-288 - P PERMIT NUMBER

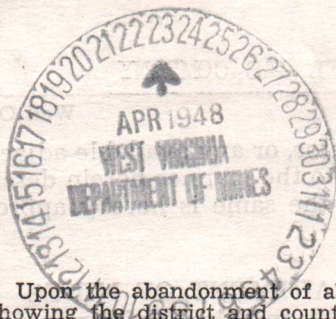

PROPOSED MANNER OF PLUGGING AND FILLING WELL

(REQUIRED BY RULES AND REGULATIONS)

WEST VIRGINIA DEPARTMENT OF MINES

OIL AND GAS DIVISION

WORK ORDER

Well to be plugged and filled as follows:

U-6211 - M. A. Webber Farm Steele Dist. Wood County Map Sq. 60-113

Total Depth	6627 Sand Line Measurement
Set Bridge at	6191
Fill with Gravel	6191 to 6085
Cement and Plug (2 Sacks)	6085 to 6075
Set Bridge at	5785
Fill with Gravel	5785 to 5713
Cement and Plug (2 Sacks)	5713 to 5703
Set Bridge at	5616
Fill with Gravel	5616 to 5541
Lead Wool 200#	5541 to 5536
Cement Plug (2 Sacks)	5536 to 5526
Set Bridge at	4716
Fill with Gravel	4716 to 4635
Cement Plug (2 Sacks)	4635 to 4625
Fill with Gravel	4625 to 4550
Cement Plug (2 Sacks)	4550 to 4540
Pull 7" Casing set at (cemented)	4534-Rip Collar where free
Set Bridge at	2060
Fill with Clay	2060 to 2020
Cement Plug (2 Sacks)	2020 to 2010
Pull 8-5/8" Casing (aquagelled) set at	2006
Set Bridge at	1625
Fill with Clay	1625 to 1125
Cement Plug (4 Sacks)	1125 to 1115
Fill with Clay	1115 to 1070
Pull 10-3/4" Casing (aquagelled) set at	1074
Set Bridge at	654
Fill with Cement (45 Sacks)	654 to 600
Fill with Clay	600 to 564
Pull 13-3/8" Casing set at	562
Fill with Clay	562 to Surface
Set Monument as required by Law	

To the Department of Mines
Coal Owner or Operator,
Lease or Property Owner.

Gentlemen:

This "work order" is submitted for your approval and concurrence and unless notified of your disapproval or non-concurrence, the undersigned will proceed with the plugging and filling of said well in the above described manner on the date stated in the notice of intention to plug and abandon the said well on opposite side of this sheet.

Very truly yours,

UNITED FUEL GAS COMPANY

Well Operator.

No objections have been filed by the coal owner or coal operator, or any available adjacent lease or property owners or interposed by the Department of Mines to the manner herein described for the plugging and filling of the well above mentioned. Therefore, the same is hereby approved this

23d day of April, 19 48.

12/22/2023

DEPARTMENT OF MINES
Oil and Gas Division

By: C. H. Hall

NOTE: This "work order" shall be filed in triplicate, one copy for the files of the Department of Mines; one to be approved or corrected and returned to the well operator as his authority for plugging said well; and one for the well inspector.



STATE OF WEST VIRGINIA
DEPARTMENT OF MINES
OIL AND GAS DIVISION

AFFIDAVIT OF PLUGGING AND FILLING WELL

AFFIDAVIT SHOULD BE MADE IN TRIPPLICATE, ONE COPY MAILED TO THE DEPARTMENT, ONE COPY TO BE RETAINED BY THE WELL OPERATOR AND THE THIRD COPY (AND EXTRA COPIES IF REQUIRED) SHOULD BE MAILED TO EACH COAL OPERATOR AT THEIR RESPECTIVE ADDRESSES.

COAL OPERATOR OR OWNER	United Fuel Gas Company
ADDRESS	NAME OF WELL OPERATOR Charleston, West Virginia
COAL OPERATOR OR OWNER	COMPLETE ADDRESS May 24, 194 ⁸
ADDRESS	WELL AND LOCATION Steele District
LEASE OR PROPERTY OWNER	Wood County
ADDRESS	Well No. 6211
	M. A. Webber Farm

STATE INSPECTOR SUPERVISING PLUGGING

AFFIDAVIT

STATE OF WEST VIRGINIA,

County of _____

SS:

George W. Bowen

and

being first duly sworn according to law depose and say that they are experienced in the work of plugging and filling oil and gas wells and were employed by United Fuel Gas Company, well operator, and participated in the work of plugging and filling the above well, that said work was commenced on the 26th day of April, 194⁸, and that the well was plugged and filled in the following manner:

SAND OR ZONE RECORD	FILLING MATERIAL			PLUGS USED	CASING	
	FORMATION	CONTENT	FROM TO		SIZE & KIND	CSG PULLED
Total Depth			6627	7" O.D.	4073	801
Set Bridge			6191	8-5/8" O.D.	2006	0
Clinton Sand	Gravel	6191	6085	10-3/4" O.D.	1074	0
	Cement - 2 Sk.	6085	6075	13-3/8" O.D.	562	0
Big Six Sand	Bridge set at		5785			
	Gravel	5785	5713			
	Cement-2 Sk.	5713	5703			
Newberg Dolomite	Bridge set at		5616			
	Gravel	5616	5541			
	Lead Wool	5541	5536			
Oriskany Sand	Cement-2 Sk.	5536	5526			
	Bridge set at	4716				
	Gravel	4716	4635			
COAL SEAMS	Cement-2 Sk.	4635	4625			
	Gravel	4625	4550			
	Cement-2 Sk.	4550	4540			
(NAME)	Bridge set at		2060	4-1/2" of 13-3/8" used as monument		
(NAME)	Clay	2060	2020	Fill with cement. Marked with company		
(NAME)	Cement-2 Sk.	2020	2010	initials Well Number, farm and date		
(NAME)	Bridge set at		1625	abandoned.		

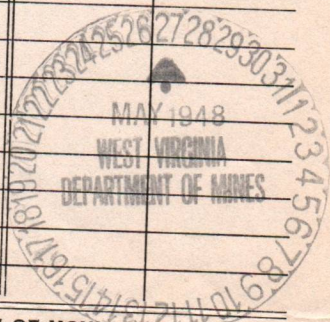

and that the work of plugging and filling said well was completed on the 19th day of May, 194⁸.

And further deponents saith not.

Geo A Bowen

12/22/2023

Sworn to and subscribed before me this 26 day of May, 194⁸.

My commission expires:

6-6-1953

J. W. Londerree
Notary Public.

J. W. LONDEREE
NOTARY PUBLIC, KANAWHA CO. W. VA.
MY COMMISSION EXPIRES JUNE 6, 1953

Permit No. Woo-228-P



STATE OF WEST VIRGINIA
DEPARTMENT OF MINES
OIL AND GAS DIVISION

AFFIDAVIT OF PLUGGING AND FILLING WELL

AFFIDAVIT SHOULD BE MADE IN TRIPLICATE, ONE COPY MAILED TO THE DEPARTMENT, ONE COPY TO BE RETAINED BY THE WELL OPERATOR AND THE THIRD COPY (AND EXTRA COPIES IF REQUIRED) SHOULD BE MAILED TO EACH COAL OPERATOR AT THEIR RESPECTIVE ADDRESSES.

COAL OPERATOR OR OWNER	NAME OF WELL OPERATOR
ADDRESS	COMPLETE ADDRESS
COAL OPERATOR OR OWNER	WELL AND LOCATION 194
ADDRESS	District
LEASE OR PROPERTY OWNER	County
ADDRESS	Well No. _____
	Farm _____

STATE INSPECTOR SUPERVISING PLUGGING.....

AFFIDAVIT

STATE OF WEST VIRGINIA, }
County of _____ } SS:

_____ and _____
being first duly sworn according to law depose and say that they are experienced in the work of plugging and filling oil and gas wells and were employed by _____, well operator, and participated in the work of plugging and filling the above well, that said work was commenced on the _____ day of _____, 194____, and that the well was plugged and filled in the following manner:

SAND OR ZONE RECORD	FILLING MATERIAL			PLUGS USED	CASING	
	FORMATION	CONTENT	FROM TO		SIZE & KIND	CSG PULLED
Salt Sand	Clay		1625 1125			
	Cement-45 Sks.		1125 1115			
	Clay		1115 1070			
Coal	Set Bridge at		654			
	Cement-45 Sks.		654 600			
	Clay		600 564			
	Clay		564 Surface			
COAL SEAMS				DESCRIPTION OF MONUMENT		
(NAME)						
(NAME)						
(NAME)						
(NAME)						

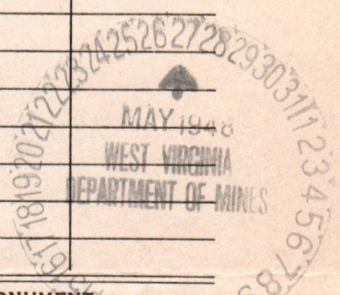

and that the work of plugging and filling said well was completed on the _____ day of _____, 194____.

And further deponents saith not.

Geo A Bowen

12/22/2023

Sworn to and subscribed before me this _____ day of _____, 194____.

My commission expires:

Notary Public.

Permit No. *W00-228-P*

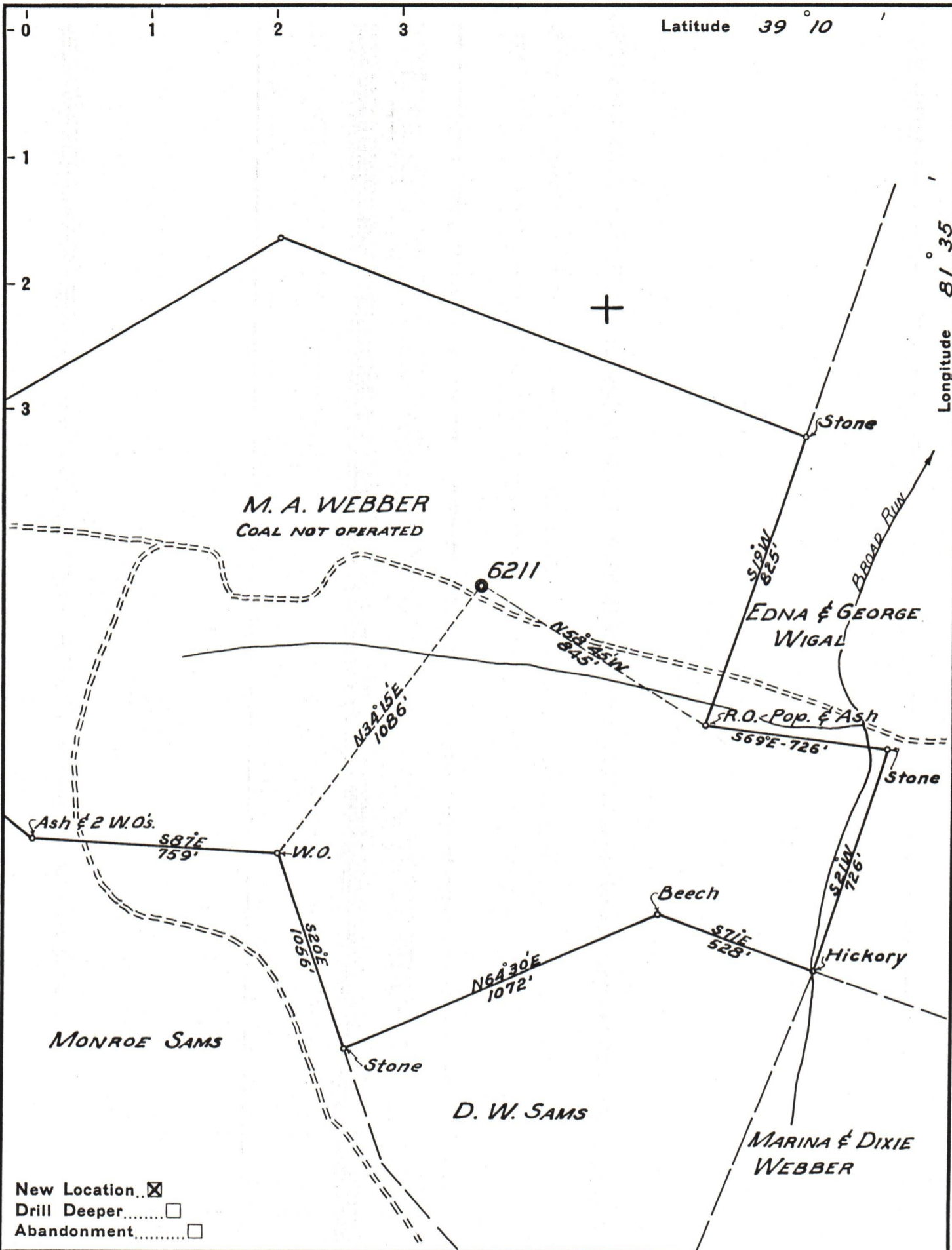

Company UNITED FUEL GAS CO.

Address CHARLESTON, W.VA.

Farm M.A. WEBBER

Tract _____ Acres 121 Lease No. 44701

Well (Farm) No. _____ Serial No. 6211

Elevation (Spirit Level) 818.3'

Quadrangle BELLVILLE

County WOOD District STEELE

Engineer J.A. Moore

Engineer's Registration No. 662

File No. 60-113 Drawing No. _____

Date JUNE-2, 1947 Scale 1" = 400'

STATE OF WEST VIRGINIA
DEPARTMENT OF MINES
OIL AND GAS DIVISION
CHARLESTON

WELL LOCATION MAP

FILE NO. W00-228 12/22/2023

+ Denotes location of well on United States Topographic Maps, scale 1 to 62,500, latitude and longitude lines being represented by border lines as shown.

- Denotes one inch spaces on border line of original tracing.

"IMPERIAL" TRACING CLOTH
K & E CO., N. Y.