

NOTICE OF PROPOSED LOCATION OF OIL AND GAS WELL
(REQUIRED BY SECTION 2, CHAPTER 22, CODE 1931)
WEST VIRGINIA DEPARTMENT OF MINES
OIL AND GAS SECTION

To THE DEPARTMENT OF MINES,
Charleston, W. Va.

None
COAL OPERATOR OR COAL OWNER

Potter Development Company
NAME OF WELL OPERATOR

None
ADDRESS

Mill Street, Port Allegany, Pennsylvania
COMPLETE ADDRESS

None
COAL OPERATOR OR COAL OWNER

November 10, 1937
PROPOSED LOCATION

None
ADDRESS

Harris District

W. H. Orem
OWNER OF MINERAL RIGHTS

Wood County

Belleville, W. Va. R. F. D. #3.
ADDRESS

Well No. 1 39° 05' 81° 40' 6.3 ac

W. H. Orem Farm

GENTLEMEN:

The undersigned well operator is entitled to drill upon the above named farm or tract of land for leasehold oil and gas, having title thereto, (or as the case may be) under grant or lease dated

January 5, 1937, made by W. H. Orem and Georgia, his wife, to

N. P. Johnston, and recorded on the 8th day

of November, 1937, in the office of the County Clerk for said County in

Book 218, page

The enclosed plat was prepared by a competent engineer and shows the proposed location of a well to be drilled for oil and gas by the undersigned well operator on the farm and in the Magisterial District and County above named, determined by survey and courses and distances from two permanent points, or land marks.

The undersigned well operator is informed and believes there are no coal operators operating beds of coal beneath said farm or tract of land on which said well is located, or within 500 feet of the boundaries of the same, who have mapped their workings and filed their maps as required by law, excepting the coal operators or coal owners (if any) above named as addressees.

The above named coal operators or coal owners (if any) are notified that any objections they may desire to make to such proposed location, or which they are required to make by Section 3 of said Code, if the drilling of a well at said proposed location will cause a dangerous condition in or about their respective coal mines, must be received by, or filed with the Department of Mines within ten* days from the receipt of a copy of this notice and accompanying plat by said Department. Said coal operators are further notified that forms for use in making such objections will be furnished to them by the Department of Mines promptly on request and that all such objections must set forth as definitely as is reasonably possible the ground or grounds on which such objections are based and indicate the direction and distance the proposed location should be moved to overcome same.

(The next paragraph is to be completed only in Department's copy.)

Copies of this notice and the enclosed plat were mailed by registered mail, or delivered to the above named coal operators or coal owners at their above shown respective address day before, or on the same day with the mailing or delivery of this copy to the Department of Mines at Charleston, West Virginia.

Very truly yours,

Potter Development Company
WELL OPERATOR

Mill Street
STREET

Port Allegany
CITY OR TOWN

Pennsylvania
STATE

Address of Well Operator }

01/05/2024

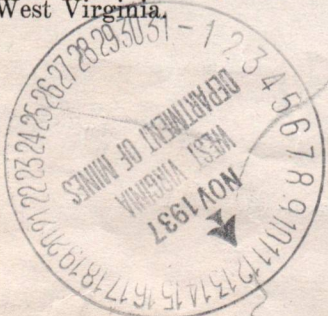

*Section 3 If no such objections be filed, or be found by the department of mines, within said period of ten days from the receipt of said notice and plat by the department of mines, to said proposed location, the department shall forthwith issue to the well operator a drilling permit reciting the filing of such plat, that no objections have been made by the coal operators to the location, or found thereto by the department, and that the same is approved and the well operator authorized to proceed to drill at said location.

47 6000 - 72



WELL RECORD, FORM OG-10, MUST BE SUBMITTED TO OBTAIN RELEASE OF WELL UNDER BOND.

STATE OF WEST VIRGINIA
DEPARTMENT OF MINES
OIL AND GAS DIVISION

NOTICE OF PROPOSED LOCATION OF OIL AND GAS WELL

To THE DEPARTMENT OF MINES,
Charleston, W. Va.

COAL OPERATOR OR COAL OWNER

ADDRESS

COAL OPERATOR OR COAL OWNER

ADDRESS

W. H. Orem et al

OWNER OF MINERAL RIGHTS

Rt. 1, Belleville, W. Va.

ADDRESS

Resorts Development Corp.

NAME OF WELL OPERATOR

c/o Howard G. Combs
401 - 27th Street

COMPLETE ADDRESS

February 15, 19 68

PROPOSED LOCATION

Harris District

Wood County

Well No. 1

W. H. Orem Farm

Elevation 684' Acres

GENTLEMEN:

The undersigned well operator is entitled to drill upon the above named farm or tract of land for oil and gas, having fee title thereto, (or as the case may be) under grant or lease dated June 6, 1967, made by Wm. H. Orem & Georgia Orem, his wife, to A. Travis, and recorded on the 7th day of November, 1967, in the office of the County Clerk for said County in Book 537, page 422.

The enclosed plat was prepared by a competent engineer and shows the proposed location of a well to be drilled for oil and gas by the undersigned well operator on the farm and in the Magisterial District and County above named, determined by survey and courses and distances from two permanent points, or land marks.

The undersigned well operator is informed and believes there are no coal operators operating beds of coal beneath said farm or tract of land on which said well is located, or within 500 feet of the boundaries of the same, who have mapped their workings and filed their maps as required by law, excepting the coal operators or coal owners (if any) above named as addressees.

The above named coal operators or coal owners (if any) are notified that any objections they may desire to make to such proposed location, or which they are required to make by Section 3 of said Code, if the drilling of a well at said proposed location will cause a dangerous condition in or about their respective coal mines, must be received by, or filed with the Department of Mines within ten* days from the receipt of a copy of this notice and accompanying plat by said Department. Said coal operators are further notified that forms for use in making such objections will be furnished to them by the Department of Mines promptly on request and that all such objections must set forth as definitely as is reasonably possible the ground or grounds on which such objections are based and indicate the direction and distance the proposed location should be moved to overcome same.

(The next paragraph is to be completed only in Department's copy.)

Copies of this notice and the enclosed plat were mailed by registered mail, or delivered to the above named coal operators or coal owners at their above shown respective address day before, or on the same day with the mailing or delivery of this copy to the Department of Mines at Charleston, West Virginia.

Very truly yours,

(Sign Name) BY: Resorts Development Corp.

WELL OPERATOR

401 - 27th Street

STREET

Vienna

CITY OR TOWN

West Virginia

STATE

01/05/2024



Address of Well Operator }

*Section 3 If no such objections be filed or be found by the department of mines, within said period of ten days from the receipt of said notice and plat by the department of mines, to said proposed location, the department shall forthwith issue to the well operator a drilling permit reciting the filing of such plat, that no objections have been made by the coal operators to the location, or found thereto by the department, and that the same is approved and the well operator authorized to proceed to drill at said location.

BOND RE-DRILL

WOOD-72-RED PERMIT NUMBER

Grantsville, W. Va.
Feb. 14, 1968

Mr. Gurmer Wamock
Deputy Director
Oil and Gas Division
Department of Mines
Charleston, W. Va. 25305

In Re: Well No. 1, W. H. Orem Farm
Potter Development Company
Permit Number Wee-72

Dear Sir:

On Feb. 12 I made an inspection of the well drilled in 1939 by the New Penn Development Corporation of Port Allegany, Penna., on the W. H. Orem Farm on Little Pond Run in Harris District, Wood County, and for which a plugging permit was issued on Jan. 31, 1939.

The well is presently being worked on by Howard Combs of the Resorts Development Company of 401-27 th. Street, Vienna, W. Va. The drilling contractor is the Sturms Brothers of Grantsville, W. Va.

I found the casing in the well to be, 14"-59'; 11 3/4"-988' and 7" run with bottom hole packer when well was being cleaned out to 1857' or to the casing seat of the 9" casing which had been pulled when the well was plugged, evidently in 1947. I found that the well had been plugged back to the bottom of the 11 3/4" casing (988'), and that wood, lead and cement plugs were drilled out during the recent work on the well. This evident after conversation with Mr. Combs and the workmen on the well.

The well has been cleaned out to 5406' and three bags of cal-seal placed at this depth. The well was logged by Smith & Williams on 2-10-'68.

On 2-12 & 13, '68, 4 1/2" pipe was run in the well and stopped approximately 150' of bottom. (5406'). This pipe will be cemented in and well will be fractured. (Pipe will be set on bottom.)

Mr. Combs stated that the lease and well had been abandoned by the New Penn Development Corporation and that he had taken a new lease from th Orem Heirs.

On Feb. 13, 1968 I posted a well violation in the presence of Mr. Combs and Mr. Travis, who were at the well, charging that work had been done knowingly after starting, that the well had been partially plugged, without a well permit and that the Department of Mines had not been notified that the title to a well permit issued had not been transferred.

Very truly yours,
Harry A. Holliday
Harry A. Holliday, Insp.

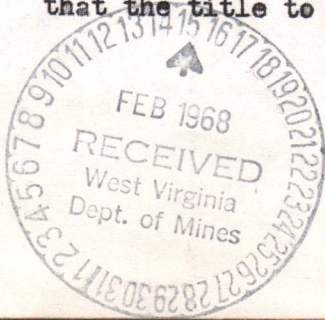

01/05/2024

Graniteville, W. Va.
Feb. 13, 1968

Mr. G. G. ...
...
Department of Mines
Charleston, W. Va. 25305

In Re: Well No. 1, W. H. Green Farm
Fetter Development Company
Permit Number 400-75

Dear Sir:

On Feb. 13 I made an inspection of the well drilled in 1959 by the new development corporation of Fort Allegany, Penn., on the W. H. Green Farm on Little Pond Run in Harris District, Wood County, and for which a plugging permit was issued on Jan. 31, 1959. The well is presently being worked on by Howard Combs of the Fetter Development Company at 601-27 1/2 Street, Vienna, W. Va. The drilling contractor is the Starns Brothers of Graniteville, W. Va. I found the casing in the well to be 11 3/4" - 11 3/4" - 11 3/4" and 7" run with bottom hole packer when well was being cleaned out in 1959. On the casing seat of the 9" casing which had been pulled when the well was plugged, evidently in 1957, I found that the well had been plugged back to the bottom of the 11 3/4" casing (988'), and that wood, lead and cement plugs were drilled out during the recent work on the well. This evident

...
...
The well has been cleaned out to 988' and three bags of cement placed at this depth. The well was lagged by Smith & Williams on 2-10-'68. On 2-12-'68, 1 1/2" pipe was run in the well and stopped approximately 150' of bottom. (980'). This pipe will be cemented in and well will be fractured. (Pipe will be set on bottom.) Mr. Combs stated that the lease and well had been abandoned by the new development corporation and that he had taken a new lease from the Green Farm.

On Feb. 13, 1968 I located a well violation in the presence of Mr. Combs and Mr. Travis, who were at the well. Changes that work had been done knowingly after stating that the well had been partially plugged, without a well permit - and that the Department of Mines had not been notified that the title to a well permit issued had not been transferred.

Very truly yours,
Harry A. Holliday, Jr.



State of West Virginia

Department of Mines

Charleston 25305

April 10, 1970

JOHN ASHCRAFT
DIRECTOR

PAUL C. RILEY
DEPUTY DIRECTOR

Resort Development Company
c/o Mr. Howard Combs
401 - 27th. Street
Vienna, West Virginia 26105

Dear Sir:

Would you please help us to close our files on the
W. H. Orem Farm - Well #1 - Permit No. Wood-72-Red.

The bond is still in force on this well, and the last
reports we received were in March 1968.

Thank you for your assistance.

Very truly yours,

Robert L. Dodd
Deputy Director
Oil & Gas Division

RLD/ch

cc: Mr. Harry Stevens
Mr. Kenneth Butcher

*Release Resorts Drilling Bond -
Well is dry and being plugged
by Pursley: Under Pursley Blanket Bond*

[Handwritten signature: RLD]

[Handwritten signature: JWR]

BOND CANCELLED
RETURNED TO WELL OPERATOR AND/OR PRINCIPAL

4/24/ 1970

01/05/2024



State of Illinois
Department of State
Springfield, Illinois
January 12, 1955

State of Illinois
Department of State

State of Illinois
Department of State

Mr. J. Development C. Lang
c/o E. Howard Combs
201 - 27th Street
West Virginia State

Dear Sir:

Would you please help us to check our files on the
W. H. Brock farm - well #1 - located No. Road-12-100.
The same is still in force on this well, and the last
reports we received were in March 1953.

I am sure you will assist us.

Very truly yours,

Robert M. Doherty
County Director
Oil & Gas Division

WHL/er
cc: Mr. Harry Stevenson
Mr. Kenneth Wilson

[Handwritten signature and notes, including "Approved" and "1/12/55"]

STATE OF WEST VIRGINIA
DEPARTMENT OF MINES
OIL AND GAS DIVISION

WELL RECORD

Permit No. W00-72

Oil or Gas Well Gas - Dry
(Kind)

Company NEW PENN DEVELOPMENT CORPORATION
 Address Port Allegany, Penna.
 Farm W. H. Orem Acres 63
 Location (waters) Little Pond Creek
 Well No. #1 Elev. 684
 District Harris County Wood
 The surface of tract is owned in fee by W. H. Orem
Bellville, W. Va. Address R. F. D. #3
 Mineral rights are owned by W. H. Orem
Bellville, W. Va. Address R. F. D. #3
 Drilling commenced 1/18/38
 Drilling completed 1/9/39
 Date shot - Depth of shot -
 Open Flow /10ths Water in Inch
/10ths Merc. in Inch
 Volume 17,600 Cu. Ft.
 Rock Pressure - lbs. - hrs.
 Oil - bbls., 1st 24 hrs.
 Fresh water - feet
 Salt water - feet

Casing and Tubing	Used in Drilling	Left in Well	Packers
Size			
1 1/4" O.D.	59'		Kind of Packer
1 1/2" O.D.	988'		Size of
1 3/4" O.D.	1,857'		
8 1/4"			Depth set
6 5/8"			
5 3/16"			Perf. top
3"			Perf. bottom
2"			Perf. top
Liners Used			Perf. bottom

CASING CEMENTED SIZE No. FT. Date
 COAL WAS ENCOUNTERED AT 1180 FEET INCHES
 FEET INCHES FEET INCHES
 FEET INCHES FEET INCHES

Formation	Color	Hard or Soft	Top	Bottom	Oil Gas or Water	Depth Found	Remarks
Mud			0	45			
Sandstone			45	80			
Rock	Red		80	95			
Slate	White		95	110			
Rock	Red		110	150			
Sand			150	187			
Rock	Red		187	210			
Slate & shells			210	265			
Rock	Red		265	305			
Slate & shells			305	335			
Rock	Red		335	350			
Shells			350	385			
Sand			385	443			
Slate			443	487			
Sand			487	535			
Slate			535	560			
Rock	Red		560	590			
Slate			590	600			
Rock	Red		600	650			
Slate			650	690			
Rock	Red		690	868			
Slate	Gray		868	910			
Sand			910	945			
Slate			945	950	S.W. @ 958		DUNKARD SAND
Sand			950	958			
Slate			958	975			
Sand			975	1040			1ST COW RUN SAND
Slate	Dark		1040	1060			
Sand			1060	1145	2Bail.S.W./Hr. @ 1075		2ND COW RUN SAND
Slate			1145	1164			
Sand			1164	1180			
Coal			1180	1182			
Sand			1182	1228			
Slate			1228	1300			
Sand			1300	1365	Show of S.W.		SALT SAND
Slate			1365	1410	Show of S.W. @ 1395		
Sand			1410	1482	Show of S.W.		
Slate			1482	1492			
Lime			1492	1538	Total S.W. now		BIG LIME (Green-brier)
Sand			1538	1555	5 bailers/hr. Show of S.W.		BIG INJUN SAND



59' - 14"

S.W. @ 958

988' - 11 3/4'

2Bail.S.W./Hr. @ 1075

01/05/2024

WELL RECORD

APPROVED _____
 NEW PENN DEVELOPMENT CORPORATION
 By W. J. [Signature] Vice Pres.
 Date: January 17th, 1939

Formation	Color	Hard or Soft	Top	Bottom	Oil, Gas or Water	Depth Found	Remarks
Slate & Shells	Brown		1555	1995			
Shale			1995	2012			
Sand			2012	2015			
Slate			2015	3205			
Slate	Brown		3205	3270			
Slate	Brown		3270	3530			
Slate	Brown		3530	3660	Gas	@ 3550	
Slate	Gray		3660	3913	Gas	3625-35	
Slate	Brown to black		3913	4054			
Shale, pyritic, crystalline			4054	4210			
Lime shells	Brown to gray to white		4183	4210			
Lime, some chert			4210	4303			
Sand	White		4303	4321			
Sub-angular calcite & lime cement			4321	4333			
Sandy lime	White		4333	4481			
Lime	Gray to dark gray		4481	4505			
Lime	White		4505	4600			
Lime	Gray to dark gray		4600	5158			
Lime			5158	5179	Show of gas		
Sand			5179	5300			
Lime			5300	5365			
Sand	Gray		5365	5385			
Shale	Red		5385	5525			
Shale	Gray & red		5525	5655			
Shale			5655	5710			
Sand	Gray		5710	5720			
Shale			5720	5740			
Sand			5740	5785			
Sand	Gray		5785	5833	LM of gas 1 ball./hr. s.w. 5780	5765	
Lime & shale			5833	5852			
Sand	Gray		5852	5896			
Shale	Brownish red		5896	TOTAL DEPTH			

TOP WHITE MEDINA

NEWBURG SAND KEEPER or BIG 6

Gas gauged 17,000 cu. ft. at completion

CORNIFEROUS LIME ORISKANY SAND

BERRA SAND

1887' - 8 1/4"

01/05/2024

STATE OF WEST VIRGINIA
DEPARTMENT OF MINES
OIL AND GAS DIVISION

INSPECTOR'S WELL REPORT

~~NO PERMIT ISSUED 2-12-68~~

ORIG. Permit No. WOOD-72-Red

POTTER DEVEL. CO.

Oil or Gas Well _____
(KIND)

ORIGINAL PERMIT ISSUED TO: NEW PENN DEVEL. CO. - 11-10-'37

Company <u>HAWARD COMBS-RESORTS DEVEL. COMP.</u> <u>401-79TH ST.</u>	CASING AND TUBING	USED IN DRILLING	LEFT IN WELL	PACKERS
	Address <u>VIENNA, W.VA.</u>	Size		
Farm <u>W. HOREM (63A.)</u>	14"			
Well No. <u>I.</u>	16	<u>59'</u>	<u>59'</u>	Kind of Packer
District <u>HARRIS</u> County <u>WOOD</u>	18			
Drilling commenced <u>11-27</u>	10 <u>11 3/4</u>	<u>988</u>	<u>988</u>	Size of
197. CONN. - 1-18-'38	8 1/4 <u>9"</u>	<u>1857</u>	<u>0</u>	
Drilling completed <u>2-10-'68</u> Total depth <u>5406'</u>	6 5/8 <u>7" AUN 27</u>	<u>1857</u>		Depth set
Date shot _____ Depth of shot _____	5 3/16			
Initial open flow _____ /10ths Water in _____ Inch	3			Perf. top
Open flow after tubing _____ /10ths Merc. in _____ Inch	2			Perf. bottom
Volume _____ Cu. Ft.	Liners Used			Perf. top
Rock pressure _____ lbs. _____ hrs.				Perf. bottom
Oil _____ bbls., 1st 24 hrs.	CASING CEMENTED _____ SIZE _____ No. FT. _____ Date _____			
Fresh water _____ feet _____ feet	NAME OF SERVICE COMPANY _____			
Salt water _____ feet _____ feet	COAL WAS ENCOUNTERED AT _____ FEET _____ INCHES			
	_____ FEET _____ INCHES _____ FEET _____ INCHES			
	_____ FEET _____ INCHES _____ FEET _____ INCHES			

SEE WELL RECORD OF 1-17-68

Drillers' Names HERBERT ANGUS - CURLY LEACH

Remarks: STURMS BROS CONTR. - SPUDDER.
HOLE WAS FOUND PLUGGED BELOW 11 3/4" PIPE. AND WAS CLEANED OUT TO 1857'
7" PIPE RUN TO 1857' WITH 7x8 1/4" PACKER ON BTM.
HOLE THEN CLEANED TO 5406' AND 3 BAGS CAL-SEAL WAS RUN TO SEAL BTM. HOLE.
HOLE WAS LOGGED BY SMITH + WILLIAMS - 2-10-'68.
4 1/2" PIPE RUN 2-12 + 2-13-'68.
(VIOLATION PASTED AT WELL 2-13-'68 FOR NO DRILL PERMIT OR NOTIFICATION
OF WELL TITLE CHANGE OF OWNERSHIP.

2124 2-13-68
DATE

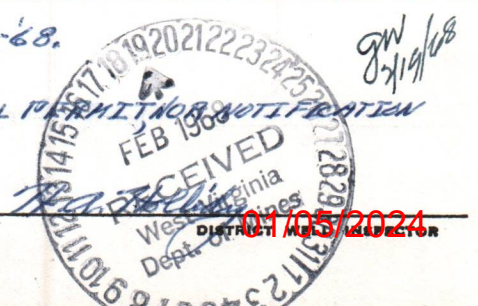

B-9

OG-11

STATE OF WEST VIRGINIA
DEPARTMENT OF MINES
OIL AND GAS DIVISION

INSPECTOR'S WELL REPORT

Permit No. W00-72 RED.

Oil or Gas Well _____
(KIND)

Company RESORTS DEVELOPMENT CORP.
401-27 HAST.

Address VIENNA, W. VA.

Farm W. H. OREN (63 ± A)

Well No. I

District HARRIS County WOOD
1ST. COMM. - 1-18-38

Drilling commenced 11-67
1ST. COMM. 1-9-39 T.O. 5896'

Drilling completed 2-68 Total depth 5406'

Date shot _____ Depth of shot _____

Initial open flow _____ /10ths Water in _____ Inch

Open flow after tubing _____ /10ths Merc. in _____ Inch

Volume _____ Cu. Ft.

Rock pressure _____ lbs. _____ hrs.

Oil _____ bbls., 1st 24 hrs.

Fresh water _____ feet _____ feet

Salt water _____ feet _____ feet

CASING AND TUBING	USED IN DRILLING	LEFT IN WELL	PACKERS
Size			
16 1/4"	59'	59'	Kind of Packer _____
13			
10 1/4"	988'	988'	Size of _____
8 1/4"	1857	0	
6 5/8"	CEMENTED.		Depth set _____
5 3/16"	4 1/2" 5406'	5406'	
3			Perf. top _____
2			Perf. bottom _____
Liners Used			Perf. top _____
			Perf. bottom _____

TOP CEM. APPROX. - 3800'

CASING CEMENTED 4 1/2" SIZE 5406 No. FT. 214-68 Date _____

NAME OF SERVICE COMPANY LAWSON

COAL WAS ENCOUNTERED AT NONE FEET _____ INCHES

_____ FEET _____ INCHES FEET _____ INCHES

_____ FEET _____ INCHES FEET _____ INCHES

Drillers' Names HERBERT ANGUS - CURLY LEACH

Remarks: STUM BROS. - CONTR.

WELL FRACTURED BY HALLIBURTON - 2-23-24-25.

7 ZONES FRACTURED, IN SHALE + NEWBURG - 7000 BBL. WATER.

SWABBING WATER - SHALE ON VACUUM AFTER FRACTURE.

NEWBURG SAND DISPLACES WATER AFTER FRACTURE.

2-26-68
DATE

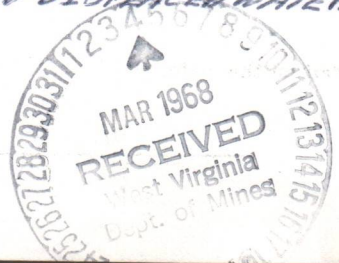

Tha Holliday
DISTRICT W. VA. DEPT. OF MINES

01/05/2024

STATE OF WEST VIRGINIA
DEPARTMENT OF MINES
OIL AND GAS DIVISION

INSPECTOR'S WELL REPORT

Permit No. WOOD-72 RED

Oil or Gas Well GAS
(KIND)

		CASING AND TUBING	USED IN DRILLING	LEFT IN WELL	PACKERS
Company	<u>RESORTS DEVELOPMENT CORP.</u>				
Address	<u>401-27th ST. VIENNA, W. VA.</u>	Size			
Farm	<u>W. H. OREM (63rd A.)</u>	16 1/4"	59'	59'	Kind of Packer
Well No.	<u>I</u>	13			
District	<u>HARRIS</u> County <u>WOOD</u>	10 11/14	988	988	Size of
	<u>1ST. CONN. 1-18-38</u>	8 3/4"	1857	0	
Drilling commenced	<u>11-67</u>	6 5/8"			Depth set
	<u>1ST. CONN. 1-9-39 - T.D. 5896'</u>	5-8/16	5406	5406	
Drilling completed	<u>2-68</u> Total depth <u>5406'</u>	3			Perf. top
Date shot		2			Perf. bottom
Initial open flow		Liners Used	<u>4 1/2 - 7' LONG</u>		Perf. top
Open flow after tubing					Perf. bottom
Volume		<u>TOP CEM. APPROX. - 3800'</u>			
Rock pressure		CASING CEMENTED <u>4 1/2</u> SIZE <u>5406</u> No. FT. <u>2148</u> Date			
Oil		NAME OF SERVICE COMPANY <u>LAWSON</u>			
Fresh water	<u>?</u> feet	COAL WAS ENCOUNTERED AT <u>NONE</u> FEET _____ INCHES			
Salt water	_____ feet	_____ FEET _____ INCHES _____ FEET _____ INCHES			

Drillers' Names HERBERT ANGUS - CURLY LEACH

Remarks: STURN BRIG. CONTR.
7' LINER SET INSIDE 4 1/2 TO COVER PERF. IN ORISNARY TO SEAL OFF WATER.
DRIILLING OUT PLUG BELOW NEWBURG TO UNCOVER LOWER FRACTURE ZONE.
WELL FRACTURED IN 7 ZONES BY HALLIBURTON 2-23-24-25-68.

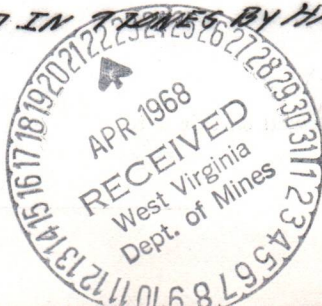

4-16-68
DATE

H. A. Holliday
INSPECTOR

01/05/2024

B' 6

STATE OF WEST VIRGINIA
DEPARTMENT OF MINES
OIL AND GAS WELLS DIVISION

RECEIVED
MAY 18 1970

INSPECTOR'S PLUGGING REPORT OIL & GAS DIVISION
DEPT. OF MINES

Permit No. Woo-72 P Well No. 1

COMPANY A. A. Pursley ADDRESS Leroy, W.Va.

FARM W. H. Arum DISTRICT Harris COUNTY Wood

Filling Material Used Fil Cement

Liner Location Amount Packer Location

PLUGS USED AND DEPTH PLACED			BRIDGES	CASING AND TUBING		
CEMENT-THICKNESS	WOOD-SIZE	LEAD	CONSTRUCTION-LOCATION	RECOVERED	SIZE	LOST

Started & pulling 2" tubing off 5200

Drillers' Names Jean Pursley
C. A. Teals

Remarks: Sucker rods were pulled on 5-12-70

5-13-70
DATE I hereby certify I visited the above well on this date.

K. E. Butcher
DISTRICT WELL INSPECTOR

01/05/2024

STATE OF WEST VIRGINIA
DEPARTMENT OF MINES
OIL AND GAS WELLS DIVISION

INSPECTOR'S WELL REPORT

Permit No. _____

Oil or Gas Well _____
(KIND)

	CASING AND TUBING	USED IN DRILLING	LEFT IN WELL	PACKERS
Company _____	Size			Kind of Packer _____
Address _____	16 _____			
Farm _____	13 _____			Size of _____
Well No. _____	10 _____			
District _____ County _____	8 1/4 _____			Depth set _____
Drilling commenced _____	6 5/8 _____			
Drilling completed _____ Total depth _____	5 3/16 _____			Perf. top _____
Date shot _____ Depth of shot _____	3 _____			
Initial open flow _____ /10ths Water in _____ Inch	2 _____			Perf. bottom _____
Open flow after tubing _____ /10ths Merc. in _____ Inch	Liners Used _____			Perf. top _____
Volume _____ Cu. Ft.				Perf. bottom _____
Rock pressure _____ lbs. _____ hrs.	CASING CEMENTED _____ SIZE _____ No. FT. _____ Date _____			
Oil _____ bbls., 1st 24 hrs.	NAME OF SERVICE COMPANY _____			
Fresh water _____ feet _____ feet	COAL WAS ENCOUNTERED AT _____ FEET _____ INCHES			
Salt water _____ feet _____ feet	_____ FEET _____ INCHES _____ FEET _____ INCHES			

Drillers' Names _____

Remarks:

DATE

DISTRICT WELL INSPECTOR

01/05/2024

**STATE OF WEST VIRGINIA
DEPARTMENT OF MINES
OIL AND GAS WELLS DIVISION**

INSPECTOR'S WELL REPORT

Permit No. _____

Oil or Gas Well _____
(KIND)

	CASING AND TUBING	USED IN DRILLING	LEFT IN WELL	PACKERS
Company _____	Size			
Address _____	16			Kind of Packer _____
Farm _____	13			
Well No. _____	10			Size of _____
District _____ County _____	8 1/4			
Drilling commenced _____	6 5/8			Depth set _____
Drilling completed _____ Total depth _____	5 3/16			
Date shot _____ Depth of shot _____	3			Perf. top _____
Initial open flow _____ /10ths Water in _____ Inch	2			Perf. bottom _____
Open flow after tubing _____ /10ths Merc. in _____ Inch	Liners Used			Perf. top _____
Volume _____ Cu. Ft.				Perf. bottom _____
Rock pressure _____ lbs. _____ hrs.	CASING CEMENTED _____ SIZE _____ No. FT. _____ Date _____			
Oil _____ bbls., 1st 24 hrs.	NAME OF SERVICE COMPANY _____			
Fresh water _____ feet _____ feet	COAL WAS ENCOUNTERED AT _____ FEET _____ INCHES			
Salt water _____ feet _____ feet	_____ FEET _____ INCHES FEET _____ INCHES			
	_____ FEET _____ INCHES FEET _____ INCHES			

Drillers' Names _____

Remarks:

DATE

DISTRICT WELL INSPECTOR
01/05/2024

STATE OF WEST VIRGINIA
DEPARTMENT OF MINES
OIL AND GAS WELLS DIVISION

RECEIVED

MAY 26 1970

OIL & GAS DIVISION
DEPT. OF MINES
INSPECTOR'S PLUGGING REPORT

Permit No. W00-72 P. Well No. 1

COMPANY A.A. Pursley ADDRESS Leroy, WVA

FARM W.H. Orem DISTRICT Harris COUNTY Wood

Filling Material Used Jel Cement

Liner Location Amount Packer Location

PLUGS USED AND DEPTH PLACED			BRIDGES	CASING AND TUBING		
CEMENT-THICKNESS	WOOD-SIZE	LEAD	CONSTRUCTION-LOCATION	RECOVERED	SIZE	LOST
Shot off 4 1/2" pipe at dph. 3460'						

Drillers' Names Jean Pursley
Co. Jones

Remarks: Pulling 4 1/2" pipe,

5-18-70
DATE

I hereby certify I visited the above well on this date.

N.E. Butcher
DISTRICT WELL INSPECTOR

01/05/2024

STATE OF WEST VIRGINIA
DEPARTMENT OF MINES
OIL AND GAS WELLS DIVISION

INSPECTOR'S WELL REPORT

Permit No. _____

Oil or Gas Well _____
(KIND)

Company _____	CASING AND TUBING	USED IN DRILLING	LEFT IN WELL	PACKERS
Address _____	Size			
Farm _____	16			Kind of Packer _____
Well No. _____	13			
District _____ County _____	10			Size of _____
Drilling commenced _____	8 1/4			Depth set _____
Drilling completed _____ Total depth _____	6 5/8			
Date shot _____ Depth of shot _____	5 3/16			Perf. top _____
Initial open flow _____ /10ths Water in _____ Inch	3			Perf. bottom _____
Open flow after tubing _____ /10ths Merc. in _____ Inch	2			Perf. top _____
Volume _____ Cu. Ft.	Liners Used			Perf. bottom _____
Rock pressure _____ lbs. _____ hrs.	CASING CEMENTED _____ SIZE _____ No. FT. _____ Date _____			
Oil _____ bbls., 1st 24 hrs.	NAME OF SERVICE COMPANY _____			
Fresh water _____ feet _____ feet	COAL WAS ENCOUNTERED AT _____ FEET _____ INCHES			
Salt water _____ feet _____ feet	_____ FEET _____ INCHES _____ FEET _____ INCHES			
	_____ FEET _____ INCHES _____ FEET _____ INCHES			

Drillers' Names _____

Remarks:

DATE

DISTRICT WELL INSPECTOR

01/05/2024

STATE OF WEST VIRGINIA
DEPARTMENT OF MINES
OIL AND GAS WELLS DIVISION

INSPECTOR'S WELL REPORT

Permit No. _____

Oil or Gas Well _____
(KIND)

	CASING AND TUBING	USED IN DRILLING	LEFT IN WELL	PACKERS
Company _____	Size			
Address _____	16			Kind of Packer _____
Farm _____	13			
Well No. _____	10			Size of _____
District _____ County _____	8 1/4			
Drilling commenced _____	6 5/8			Depth set _____
Drilling completed _____ Total depth _____	5 3/16			
Date shot _____ Depth of shot _____	3			Perf. top _____
Initial open flow _____ /10ths Water in _____ Inch	2			Perf. bottom _____
Open flow after tubing _____ /10ths Merc. in _____ Inch	Liners Used			Perf. top _____
Volume _____ Cu. Ft.				Perf. bottom _____
Rock pressure _____ lbs. _____ hrs.	CASING CEMENTED _____ SIZE _____ No. FT. _____ Date _____			
Oil _____ bbls., 1st 24 hrs.	NAME OF SERVICE COMPANY _____			
Fresh water _____ feet _____ feet	COAL WAS ENCOUNTERED AT _____ FEET _____ INCHES			
Salt water _____ feet _____ feet	_____ FEET _____ INCHES _____ FEET _____ INCHES			
	_____ FEET _____ INCHES _____ FEET _____ INCHES			

Drillers' Names _____

Remarks: _____

DATE _____

DISTRICT WELL INSPECTOR
01/05/2024

C-8

RECEIVED

STATE OF WEST VIRGINIA
DEPARTMENT OF MINES
OIL AND GAS WELLS DIVISION

JUN 2 1970

OIL & GAS DIVISION
DEPT. OF MINES

INSPECTOR'S PLUGGING REPORT

Permit No. Woo-72P Well No. 1

COMPANY Pursley Well Service ADDRESS Teray, W.Va.

FARM W.H. Orem DISTRICT Harris COUNTY Wood

Filling Material Used Jel Cement

Liner Location Amount Packer Location

PLUGS USED AND DEPTH PLACED			BRIDGES	CASING AND TUBING		
CEMENT-THICKNESS	WOOD-SIZE	LEAD	CONSTRUCTION-LOCATION	RECOVERED	SIZE	LOST
<u>490'-500'</u>						
<u>205'-220'</u>						
<u>0'-10'</u>	<u>Jel</u>		<u>10'-500'</u>			

Drillers' Names Jean Pursley
Co. Tools

Remarks: Hole was filled with Jel except where cement plugs were placed.

5-28-70 I hereby certify I visited the above well on this date.
DATE

K.C. Butcher
DISTRICT WELL INSPECTOR

01/05/2024

**STATE OF WEST VIRGINIA
DEPARTMENT OF MINES
OIL AND GAS WELLS DIVISION**

INSPECTOR'S WELL REPORT

Permit No. _____

Oil or Gas Well _____
(KIND)

	CASING AND TUBING	USED IN DRILLING	LEFT IN WELL	PACKERS
Company _____	Size			
Address _____	16			Kind of Packer _____
Farm _____	13			
Well No. _____	10			Size of _____
District _____ County _____	8 1/4			
Drilling commenced _____	6 5/8			Depth set _____
Drilling completed _____ Total depth _____	5 3/16			
Date shot _____ Depth of shot _____	3			Perf. top _____
Initial open flow _____ /10ths Water in _____ Inch	2			Perf. bottom _____
Open flow after tubing _____ /10ths Merc. in _____ Inch	Liners Used			Perf. top _____
Volume _____ Cu. Ft.				Perf. bottom _____
Rock pressure _____ lbs. _____ hrs.	CASING CEMENTED _____ SIZE _____ No. FT. _____ Date _____			
Oil _____ bbls., 1st 24 hrs.	NAME OF SERVICE COMPANY _____			
Fresh water _____ feet _____ feet	COAL WAS ENCOUNTERED AT _____ FEET _____ INCHES			
Salt water _____ feet _____ feet	_____ FEET _____ INCHES _____ FEET _____ INCHES			
	_____ FEET _____ INCHES _____ FEET _____ INCHES			

Drillers' Names _____

Remarks:

DATE _____

DISTRICT WELL INSPECTOR

01/05/2024



State of West Virginia

Department of Mines
Oil and Gas Division
Charleston 5

July 14, 1970

C-10
Pursley's Pulling & Well Service
B ox 51
Leroy, West Virginia 25252

IN RE: Permit W00-72-P
Farm W. H. Orem
Well No. 1
District Harris
County Wood

Gentlemen:

The final inspection report for the Well which is described above has been received in this office.

Please be advised that the Well which is covered by the above permit number has been released under your Blanket Bond.

Very truly yours,

Deputy Director
Oil and Gas Wells Division

b

01/05/2024

THE UNIVERSITY OF CHICAGO
DIVISION OF THE PHYSICAL SCIENCES
DEPARTMENT OF CHEMISTRY
5708 S. UNIVERSITY AVENUE
CHICAGO, ILLINOIS 60637

RECEIVED
JAN 10 1964

1964

TO THE DIRECTOR, UNIVERSITY OF CHICAGO

FROM THE DEPARTMENT OF CHEMISTRY

RE: [Illegible]

[Illegible]

B-11

OG-11

STATE OF WEST VIRGINIA
DEPARTMENT OF MINES
OIL AND GAS WELLS DIVISION

RECEIVED

JUL 14 1970

INSPECTOR'S WELL REPORT

OIL & GAS DIVISION
DEPT. OF MINES

Permit No. Wood-72 P.

Oil or Gas Well _____
(KIND)

Company	CASING AND TUBING	USED IN DRILLING	LEFT IN WELL	PACKERS
<u>Pursley's Well Service</u>	Size			
Address <u>Leray, W.Va.</u>	16			Kind of Packer
Farm <u>W.H. Owen</u>	13			
Well No. <u>1</u>	10			Size of
District <u>Harris</u> County <u>Wood</u>	8 1/4			
Drilling commenced _____	6 5/8			Depth set
Drilling completed _____ Total depth _____	5 3/16			
Date shot _____ Depth of shot _____	3			Perf. top
Initial open flow _____ /10ths Water in _____ Inch	2			Perf. bottom
Open flow after tubing _____ /10ths Merc. in _____ Inch	Liners Used			Perf. top
Volume _____ Cu. Ft.				Perf. bottom
Rock pressure _____ lbs. _____ hrs.	CASING CEMENTED _____ SIZE _____ No. FT. _____ Date _____			
Oil _____ bbls., 1st 24 hrs.	NAME OF SERVICE COMPANY _____			
Fresh water _____ feet _____ feet	COAL WAS ENCOUNTERED AT _____ FEET _____ INCHES			
Salt water _____ feet _____ feet	_____ FEET _____ INCHES FEET _____ INCHES			
	_____ FEET _____ INCHES FEET _____ INCHES			

Drillers' Names _____

Remarks: Final inspection made for bond release.

BOND CANCELLED
RETURNED TO WELL OPERATOR AND/OR PRINCIPAL

7-7-70
DATE

July 14, 1970

K.E. Butcher
DISTRICT WELL INSPECTOR

01/05/2024

B-12



State of West Virginia

Department of Mines
Oil and Gas Division
Charleston 5

April 24, 1970

Resort Development Company
c/o Mr. Howard Combs
401 - 27th Street
Vienna, West Virginia 26105

IN RE: Permit WOO-72-RED
Farm W. H. Oram
Well No. 1
District Harrie
County Wood

Gentlemen:

The final inspection report for the Well which is described above has been received in this office.

Please be advised that the Bond which is covered by the above permit number has been released. **Plugging permit issued to Pursley's Pulling & Well Service.**

Kindly return the enclosed cancelled Bond to the Surety Company that executed said bond in your behalf, in order that they may give you credit on their records.

Very truly yours,

Deputy Director
Oil and Gas Wells Division

INSTRUCTIONS TO DELIVERING EMPLOYEE

Show to whom, date, and address where delivered Deliver ONLY to addressee
(Additional charges required for these services)

RECEIPT

Received the numbered article described below.

REGISTERED NO. _____ SIGNATURE OR NAME OF ADDRESSEE (Must always be filled in)
CERTIFIED NO. _____ 1 W. H. Oram WOOD-72-RED (Bond)
INSURED NO. _____ 2 _____ SIGNATURE OF ADDRESSEE'S AGENT, IF ANY
DATE DELIVERED _____ 3 _____ SHOW WHERE DELIVERED (only if requested)

APR 25 1970

STATE OF WEST VIRGINIA
DEPARTMENT OF MINES
OIL AND GAS DIVISION

NOTICE OF INTENTION TO PLUG AND ABANDON WELL

(REQUIRED BY SECTION 9, ARTICLE 4, CHAPTER 22 OF THE CODE)

To THE DEPARTMENT OF MINES,
Charleston, W. Va.

NEW PENN DEVELOPMENT CORPORATION

NAME OF WELL OPERATOR

NONE

COAL OPERATOR OR COAL OWNER

Port Allegany, Penna.

COMPLETE ADDRESS

ADDRESS

January 12th, 1939

WELL TO BE ABANDONED

NONE

COAL OPERATOR OR COAL OWNER

Harris District

ADDRESS

Wood County

W. H. Orem

LEASE OR PROPERTY OWNER

Well No. #1

Bellville, W. Va., R.F.D. #3

ADDRESS

W. H. Orem Farm

Gentlemen:—

The undersigned well operator is about to abandon the above described well and will commence the

work of plugging and abandoning said well on the ^{31st} 11th day of January, 1939, (which date shall not be less than five days after the day on which this notice so mailed is received, or in due course should be received by the Department of Mines.)

This notice is given you in order that your respective representatives may be present at the plugging and filling of said well. You are further notified that whether you are represented or not represented the undersigned will proceed on that date, or shortly thereafter, to plug and fill said well in the manner required by Section 10, Article 4, Chapter 22 of the Code and given in detail on the reverse side of this notice, in "Work Order."

This notice is being mailed by registered mail to each of you at the above addresses on the above date.

Very truly yours,

NEW PENN DEVELOPMENT CORPORATION

T. A. Orem

Well Operator
Vice Pres.

NOTE: Upon the abandonment of all wells drilled prior to June 1, 1929, a plat prepared by a competent engineer, showing the district and county in which the tract of land is located, the name and acreage of same, the names of the owners of adjacent tracts, and the location of the about to be abandoned well, determined by survey, and the courses and distances of such well from two permanent points or landmarks on said tract, shall be submitted with this notice.

(Over)

WOO-72-P

PERMIT NUMBER

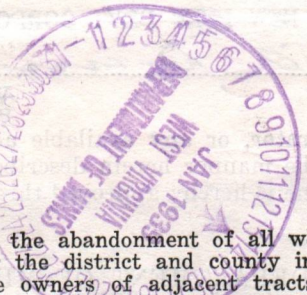

01/05/2024

PROPOSED MANNER OF PLUGGING AND FILLING WELL

(REQUIRED BY RULES AND REGULATIONS)

WEST VIRGINIA DEPARTMENT OF MINES
OIL AND GAS DIVISION
WORK ORDER

Well to be plugged and filled as follows:

- Plug at 5600 ft. - 30' of cement - Above Medina.
- Bridge at 4353 ft. - Wood, lead, & cement - Oriskany 4303-33.
Plug at 4300 ft.
- Bridge at 2030 ft. - Wood, lead, & cement - Berea 2012-15.
Plug at 2000 ft.
- Bridge at 1580 ft. - Wood, lead, & cement - Big Injun 1538-55.
Plug at 1510 ft.
- Bridge at 1380 ft. - Wood, lead, & cement - Salt sand 1300-65.
Plug at 1290 ft.
- Bridge at 1150 ft. - Wood, lead, & cement - Cow Run & Dunkard 910-1145.
Plug at 900 ft.

WORK ORDER REVISED BY THE DEPARTMENT OF MINES:

Red Clay from bottom to 5600' - 110' above White Medina
30' cement at 5600'

Set a permanent bridge at 4630' - 30' below Gas at 4600'
10' Neat Cement on bridge.
Red Clay or other non-porous material 4600' - 4190' - top of Corniferous Lime.
Wood and lead plugs 4190' - 4186'
About 30' neat cement on plug - sealing hole completely above Oriskany & Corniferous Lime.

Set a permanent bridge at 2030'
Fill with non-porous material to 1872' - 15' below 9" O.D. Casing.
Wood Plug 1872' - 1869'
Cement 1869' - 1859' - sealing hole.

Pull 9" Casing.
Fill with non-porous material to 1500'
Wood, lead & Cement Plugs 1485'

Set a permanent bridge 1380'
Fill with non-porous material 1380' - 1280'
Wood Plug 1280' - 1277'
Cement 1277' - 1267' - sealing hole.

To the Department of Mines
Coal Owner or Operator,
Lease or Property Owner.

Set a permanent bridge 1150'
Fill with non-porous material 1150' 900' - top of Dunkard Sands.
Wood, lead & Cement 900' - 885'

Revised Work Order--Continued

Set a permanent bridge at 150'

Pull 14" Casing and--
Fill with red clay to surface

Erect Marker such as is required by Rule 18, 1931 regulations.

NOTE: CEMENT FOR MAKING CEMENT PLUGS BE MIXED WITH WATER ONLY--APPROXIMATELY FIVE GAL WATER TO ONE SACK CEMENT.

property owners or interposed by the Department of Mines. Therefore, the same is hereby approved this 5th day

of January, 1939.

DEPARTMENT OF MINES 01/05/2024
Oil and Gas Division

By:

NOTE: This "work order" shall be filed in triplicate, one copy for the files of the Department of Mines; one to be approved or corrected and returned to the well operator as his authority for plugging said well; and one for the well inspector.

RECEIVED

JUN 29 1970

OIL & GAS DIVISION
DEPT. OF MINES

FORM OG-8

STATE OF WEST VIRGINIA
DEPARTMENT OF MINES
OIL AND GAS DIVISION

AFFIDAVIT OF PLUGGING AND FILLING WELL

AFFIDAVIT SHOULD BE MADE IN TRIPPLICATE, ONE COPY MAILED TO THE DEPARTMENT, ONE COPY TO BE RETAINED BY THE WELL OPERATOR AND THE THIRD COPY (AND EXTRA COPIES IF REQUIRED) SHOULD BE MAILED TO EACH COAL OPERATOR AT THEIR RESPECTIVE ADDRESSES.

None
COAL OPERATOR OR OWNER

A.A. Pursley dba:
Pursley's Pulling & Well Service
NAME OF WELL OPERATOR

Box 51, Leroy, West Virginia 25252
COMPLETE ADDRESS

June 24 19 70
WELL AND LOCATION

Harris District

W.H. Orem Wood County

LEASE OR PROPERTY OWNER
Bellville, West Virginia
ADDRESS

Well No. One

W.H. Orem Farm

STATE INSPECTOR SUPERVISING PLUGGING: Kenneth Butcher, Barboursville, West Virginia

AFFIDAVIT

STATE OF WEST VIRGINIA,
County of Jackson } ss:
Eugene Pursley

and A.A. Pursley
being first duly sworn according to law depose and say that they are experienced in the work of plugging and filling oil and gas wells and were employed by Pursleys Pulling & Well Service, well operator, and participated in the work of plugging and filling the above well, that said work was commenced on the 12 day of June MAY, 19 70, and that the well was plugged and filled in the following manner:

SAND OR ZONE RECORD FORMATION	FILLING MATERIAL	PLUGS USED SIZE & KIND	CASING	
			CSG PULLED	CSG LEFT IN
	Cement & 6% Bentonite Gel	60' 40' 20' 15' 1 1/2"	3 1/2 40'	135'
		11"	3.4 808	104'
		14"		59'
	Gelled hole before starting job.			
	Set cement plugs at: 2440', 1910', 1520', 1050', 884' 220'. All plugs displaced with gel.			
COAL SEAMS		DESCRIPTION OF MONUMENT		
(NAME)		Erected marker as required by the Department of Mines		
(NAME)				
(NAME)				
(NAME)				

and that the work of plugging and filling said well was completed on the 5 day of June, 19 70.

And further deponents saith not.

Eugene Pursley
A.A. Pursley
Sworn to and subscribed before me this 24 day of June, 19 70.
Jason Duster
Notary Public.

01/05/2024

My commission expires:
March 22, 1980

Permit No. W00-72-P

100-100000-100000

100-100000-100000

100-100000-100000

100-100000-100000

100-100000-100000

100-100000-100000

100-100000-100000

100-100000-100000

100-100000-100000

100-100000-100000

100-100000-100000

100-100000-100000

100-100000-100000

100-100000-100000

100-100000-100000

100-100000-100000

100-100000-100000

100-100000-100000

100-100000-100000

100-100000-100000

100-100000-100000

100-100000-100000

100-100000-100000

100-100000-100000

100-100000-100000

100-100000-100000

100-100000-100000

100-100000-100000

100-100000-100000

100-100000-100000

100-100000-100000

01/05/2024



Blanket Bond No: 455-694

RECEIVED
APR 24 1970

STATE OF WEST VIRGINIA
DEPARTMENT OF MINES
OIL AND GAS WELLS DIVISION

NOTICE OF INTENTION TO PLUG AND ABANDON WELL
(REQUIRED BY SECTION 9, ARTICLE 4, CHAPTER 22 OF THE CODE)

To THE DEPARTMENT OF MINES,
Charleston, W. Va.

A.A. Pursley dba:

Fee
Coal Operator

Pursley's Pulling & Well Service
Name of Well Operator

Address

Box 51, Leroy, West Virginia 25252
Complete Address

Coal Owner

April 22 1970
Date

WELL TO BE ABANDONED

Address

~~Harris~~ Tyggart District

W. H. Orem
Lease or Property Owner

Wood County

Bellville, West Virginia
Address

Well No. # 1
W. H. Orem Farm

Inspector Kenneth Butcher, Barboursville, West Virginia 25504 Telephone 736-4885

TO BE NOTIFIED 24 HOURS IN ADVANCE OF PLUGGING OPERATIONS

Gentlemen:—

The undersigned well operator is about to abandon the above described well and will commence

the work of plugging and abandoning said well on the date inspector is notified (which date shall not be less than five days after the day on which this notice so mailed is received, or in due course should be received by the Department of Mines).

This notice is given you in order that your respective representatives may be present at the plugging and filling of said well. You are further notified that whether you are represented or not represented the undersigned will proceed on that date, or shortly thereafter, to plug and fill said well in the manner required by Section 10, Article 4, Chapter 22 of the Code and given in detail on the reverse side of this notice, in "Work Order."

This notice is being mailed by registered mail to each of you at the above addresses on the above date.

Very truly yours,

A. A. Pursley
Well Operator

NOTE: Upon the abandonment of any well drilled prior to June 1, 1929, a plat prepared by a registered engineer, shall be filed with THREE COPIES OF APPLICATION, (OG-9) AND "WORK ORDER" AND TWO COPIES OF THE WELL RECORD, (OG-10). The map must show the district and county in which the tract of land is located, the name and acreage of same, the name or names of the owners and names of adjacent tracts and the location of the well to be abandoned, determined by survey with the courses and distances of such well from two permanent points or landmarks on said tract, in compliance with Rule 5 of the Rules **01/05/2024**

NOTE: In case plugging is not commenced within four months from the date of permit, same shall expire and be of no further force or effect.

NOTE: PERMIT IS NON TRANSFERABLE.

BLANKET BOND

WOO- 72-P

Permit Number

AFFIDAVIT, FORM OG-8, MANNER WELL PLUGGED MUST BE SUBMITTED TO OBTAIN RELEASE OF WELL UNDER BOND.

PROPOSED MANNER OF PLUGGING AND FILLING WELL

(REQUIRED BY RULES AND REGULATIONS)

WEST VIRGINIA DEPARTMENT OF MINES

OIL AND GAS DIVISION

WORK ORDER

Well to be plugged and filled as follows:

Total Depth: 5250'.

Total depth of tubing: 5200'.

4 $\frac{1}{2}$ " Casing cemented back to approx 3575'. Gel hole from total depth to 4450', set 60' cement plug back to 4390', below oriskiny, gel hole and set 60' cement plug 3760' to 3700', pull tubing out of hole and cut 4 $\frac{1}{2}$ " casing at free point. Approx 3550', gel ~~and set~~ to 2125', set 40' cement plug, gel to 1910', set 20' cement plug pull balance of 4 $\frac{1}{2}$ " Casing. 1857' of 8 5/8 casing, set 15' cement plug 1520' back to 1505', Big Lime. Gel to 1650' set 15' cement plug, pull 8 5/8 casing, 10" casing set at 988', if 10" will pull, will set 15' cement plug at 910' to 900', if we can not pull will set plug where severed, gel to surface, set 15' cement plug at 220' to 205'. Erect marker as prescribed by oil and gas division.

To the Department of Mines
Coal Owner or Operator,
Lease or Property Owner.

IF PARTIAL PLUGGING
PLEASE SUBMIT REVISED WELL RECORD
WHEN WORK IS COMPLETED.

Gentlemen:

This "work order" is submitted for your approval and concurrence and unless notified of your disapproval or non-concurrence, the undersigned will proceed with the plugging and filling of said well in the above described manner on the date inspector is notified after permit is issued.

Very truly yours,

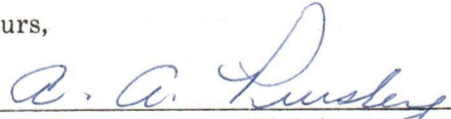
Well Operator

No objections have been filed by the coal owner or coal operator, or any available adjacent lease or property owners or interposed by the Department of Mines to the manner herein described for the plugging and filling of the well above mentioned. Therefore, the same is hereby approved this

24th. day of April, 1970.

DEPARTMENT OF MINES **01/05/2024**
Oil and Gas Division

By: 

NOTE: This "work order" shall be filed in triplicate, one copy for the files of the Department of Mines; one to be approved or corrected and returned to the well operator as his authority for plugging said well; and one for the well inspector.

PLUG 4/24/70
GEN

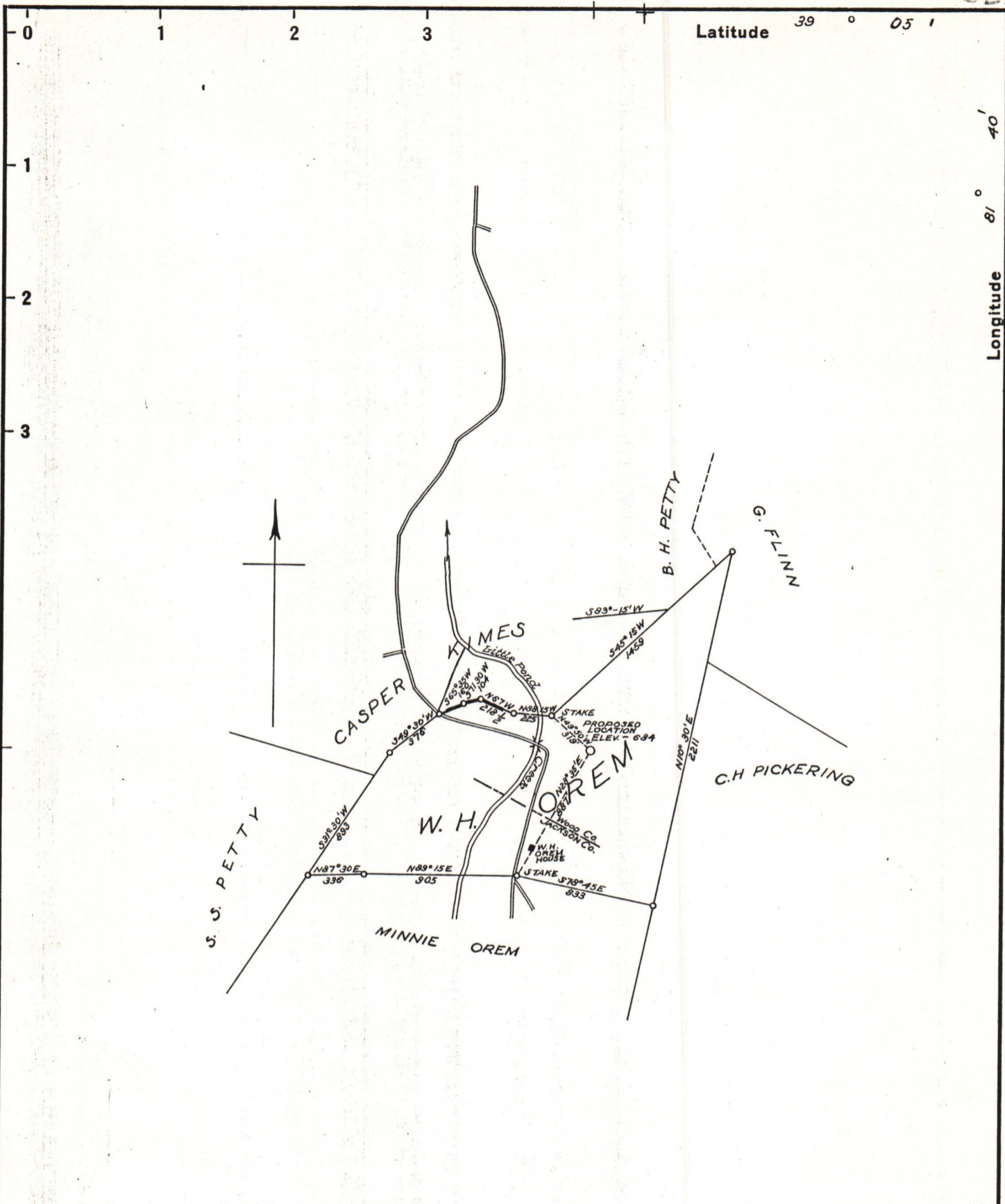

REDRILL ✓ ISSUED FEB. 15, 1968
 New Location
 Drill Deeper.....
 Abandonment..... - Issued 4-24-70

~~RESORTS DEVELOPMENT CORP~~ A.A. Pursley dba Pursleys Pulling & Well Service
 Company BOYER DEVELOPMENT CO
 Address 46 Howard G. Comb, 401 27th St, Vienna, W. Va. Box 51, Leroy, West Va., 25252
 Farm W. H. OREM
 Tract ONE Acres 63± Lease No. 9511
 Well (Farm) No. ONE Serial No. _____
 Elevation (Spirit Level) 684
 Quadrangle BELLEVILLE
 County WOOD District HARRIS
 Engineer HARVEY A. KATILA
 Engineer's Registration No. _____
 File No. _____ Drawing No. _____
 Date NOV. 10, 1937 Scale 1" = 800'-0"

STATE OF WEST VIRGINIA
 DEPARTMENT OF MINES
 OIL AND GAS DIVISION
 CHARLESTON

WELL LOCATION MAP
 FILE NO. Woo-72-RED-P
 01/05/2024

+ Denotes location of well on United States Topographic Maps, scale 1 to 62,500, latitude and longitude lines being represented by border lines as shown.

- Denotes one inch spaces on border line of original tracing.