

NOTICE OF PROPOSED LOCATION OF OIL AND GAS WELL

(REQUIRED BY SECTION 2, CHAPTER 86, ACTS 1929)

WEST VIRGINIA DEPARTMENT OF MINES

OIL AND GAS SECTION

17-6-4-36

To THE DEPARTMENT OF MINES,
Charleston, W. Va.

Wm. R. Stagg (No coal)

COAL OPERATOR OR COAL OWNER

Wamsley Oil & Gas Company

NAME OF WELL OPERATOR

Walker, W. VA., R. F. D. #2

ADDRESS

Walker, W. VA., R.F. D. #2

COMPLETE ADDRESS

COAL OPERATOR OR COAL OWNER

ADDRESS

OWNER OF MINERAL RIGHTS

ADDRESS

May 30 1936

PROPOSED LOCATION

Union District

Wood County

Well No. 1

Wm. R. Stagg Farm

66.5

GENTLEMEN :

The undersigned well operator is entitled to drill upon the above named farm or tract of land for oil and gas, having fee title thereto, (or as the case may be) under grant or lease dated.....

December 26, 1934

made by Wm. R. Stagg, to

J. B. Yeager

and recorded on the 12th day

of January 1935, in the office of the County Clerk for said County in

Book 210, page 561

The enclosed plat was prepared by a competent engineer and shows the proposed location of a well to be drilled for oil and gas by the undersigned well operator on the farm and in the Magisterial District and County above named, determined by survey and courses and distances from two permanent points, or land marks.

The undersigned well operator is informed and believes there are no coal operators operating beds of coal beneath said farm or tract of land on which said well is located, or within 500 feet of the boundaries of the same, who have mapped their workings and filed their maps as required by law, excepting the coal operators or coal owners (if any) above named as addressees.

The above named coal operators or coal owners (if any) are notified that any objections they may desire to make to such proposed location, or which they are required to make by Section 3 of said Act, if the drilling of a well at said proposed location will cause a dangerous condition in or about their respective coal mines, must be received by, or filed with the Department of Mines within ten* days from the receipt of a copy of this notice and accompanying plat by said Department. Said coal operators are further notified that forms for use in making such objections will be furnished to them by the Department of Mines promptly on request and that all such objections must set forth as definitely as is reasonably possible the ground or grounds on which such objections are based and indicate the direction and distance the proposed location should be moved to overcome same.

(The next paragraph is to be completed only in Department's copy.)

Copies of this notice and the enclosed plat were mailed by registered mail, or delivered to the above

named coal operators or coal owners at their above shown respective address.....day.... before, or on the same day with the mailing or delivery of this copy to the Department of Mines at Charleston, West Virginia.

Very truly yours,

Wamsley Oil & Gas Company

By J.B. Wamsley Sec.-Treas.

WELL OPERATOR

Address of Well Operator }

STREET

Walker W. VA. R.F.D #2

CITY OR TOWN

W. VA.

STATE

01/05/2024

*Section 3 If no such objections be filed, or be found by the department of mines, within said period of ten days from the receipt of said notice and plat by the department of mines, to said proposed location, the department shall forthwith issue to the well operator a drilling permit reciting the filing of such plat, that no objections have been made by the coal operators to the location, or found thereto by the department, and that the same is approved and the well operator authorized to proceed to drill at said location.

A-10

June Eighth
1 9 3 6

Mr. Wm. R. Stagg,
R. F. D. No. 2,
Walker, W. Va.

Dear Sir:-

A notice of a proposed location of oil or gas Well No. 1 on the Wm. R. Stagg Farm, Union District, Wood County, has been received from the Wamsley Oil & Gas Company. A copy of the notice and location plat should have been mailed you by the well operator.

If you have any objections to the proposed location that come under our jurisdiction, please file same not later than June 14, 1936.

Very truly yours,

OIL AND GAS DIVISION

MG/p

01/05/2024

10-1

1930
L

Mr. Wm. R. Stebbins,
R. F. D. No. 2,
Walker, W. Va.

Dear Sir:-

A notice of a proposed location of oil
on gas well No. 1 on the Wm. R. Stebbins Farm, Union
District, Wood County, has been received from the
Wansley Oil & Gas Company. A copy of the notice
and location plat should have been mailed you by
the well operator.

If you have any objections to the pro-
posed location that come under our jurisdiction,
please file same not later than June 14, 1930.

Very truly yours,

OIL AND GAS DIVISION

WGT

A-11

June Sixteenth
1 9 3 6

Kansley Oil & Gas Company,
R. F. D. No. 2,
Walker, West Virginia.

Gentlemen:-

Permit No. Woc-47 to drill Well No. 1 on
the Wm. R. Stagg Farm, Union District, Wood County,
is enclosed.

Please see that the drillers keep a cor-
rect and complete log of the well, giving depths at
which water, and gas or oil are found and make a re-
port to this department as soon as the well is com-
pleted.

Very truly yours,

OIL AND GAS DIVISION

HO/p

Enc.
CC - Inspector Kent

01/05/2024

A-12

June 24, 1937

Wamsley Oil & Gas Company
Walker
West Virginia

Gentlemen:

Please send us complete records on Form G-10 for your Well No. 1 on the William R. Stagg farm, Union District, Wood County. Our files, Woo-47.

May we have this information by return mail? Blanks are enclosed.

Yours very truly,

Secretary
OIL AND GAS DIVISION

MG:ME
enc.

01/05/2024

WEST VIRGINIA DEPARTMENT OF MINES
OIL AND GAS DIVISION

Parkersburg

WELL RECORD

Permit No. *W-1-47*

Oil or Gas Well
(Kind)

Company *Marshall Gas Co*
 Address *Walker, W. Va*
 Farm *Mr. D. F. ...* Acres *6.8*
 Location (waters) *Wilmington Creek*
 Well No. *1* Elev. *910'*
 District *Union* County *of road*
 The surface of tract is owned in fee by *Mr. Stagg*
 Address *Walker*
 Mineral rights are owned by *Mr. Stagg*
 Address *Walker*
 Drilling commenced _____
 Drilling completed _____
 Date shot *not shot* Depth of shot _____
 Open Flow /10ths Water in _____ Inch
 /10ths Merc. in _____ Inch
 Volume _____ Cu. Ft.
 Rock Pressure _____ lbs. _____ hrs.
 Oil _____ bbls., 1st 24 hrs.
 Fresh water _____ feet _____ feet
 Salt water _____ feet _____ feet

Casing and Tubing	Used in Drilling	Left in Well	Packers
Size			Kind of Packer
16.			
13.			<i>Parsons</i>
10.			Size of <i>50</i>
8 3/4 <i>390</i>			
6 5/8 <i>1098</i>		<i>1098</i>	Depth set
5 3/16 1098			
3.			Perf. top
2.			Perf. bottom
Liners Used			Perf. top
			Perf. bottom

CASING CEMENTED _____ SIZE _____ No. FT. _____ Date _____
 COAL WAS ENCOUNTERED AT _____ FEET _____ INCHES
 _____ FEET _____ INCHES FEET _____ INCHES
 _____ FEET _____ INCHES FEET _____ INCHES

Formation	Color	Hard or Soft	Top	Bottom	Oil Gas or Water	Depth Found	Remarks
Red Rock		<i>soft</i>		<i>160 ft</i>	<i>at 15+75</i>		
Sand	<i>lighter</i>	<i>soft</i>	<i>160</i>	<i>165-</i>			
Red Rock		<i>soft</i>	<i>165-</i>	<i>180</i>			
Sand	<i>white</i>	<i>soft</i>	<i>180</i>	<i>195</i>			
R. Rock			<i>195</i>	<i>264</i>			
Sand	<i>white</i>	<i>soft</i>	<i>264</i>	<i>270</i>			
Red Rock			<i>270</i>	<i>305-</i>			
Lime			<i>305-</i>	<i>325</i>			
R. Rock			<i>325-</i>	<i>370</i>			
B. State			<i>370</i>	<i>380</i>			
Clay			<i>380</i>	<i>440</i>			
R. R.			<i>440</i>	<i>500</i>			
Lime			<i>500</i>	<i>512</i>			
R. R.			<i>512</i>	<i>540</i>			
Lime			<i>540</i>	<i>550</i>			
R. R.			<i>550</i>	<i>600</i>			
Lime			<i>600</i>	<i>640</i>			
R. R.			<i>640</i>	<i>710</i>			
Lime State			<i>710</i>	<i>775</i>			
R. Rock			<i>775-</i>	<i>805</i>			
Lime			<i>805-</i>	<i>845</i>			
State			<i>845-</i>	<i>874</i>			
Brom slate			<i>874</i>	<i>905</i>			
R. Rock			<i>905</i>	<i>925</i>			
Sand			<i>925</i>				



01/05/2024

B-2

WEST VIRGINIA DEPARTMENT OF MINES
OIL AND GAS DIVISION

WELL RECORD

Permit No. Woo-47

Oil or Gas Well.....
(Kind)

Company.....	Casing and Tubing	Used in Drilling	Left in Well	Packers
Address.....	Size			
Farm..... Acres.....	16.....			Kind of Packer.....
Location (waters).....	18.....			Size of.....
Well No..... Elev.....	10.....			Depth set.....
District..... County.....	8 1/4.....			Perf. top.....
The surface of tract is owned in fee by.....	6 5/8.....			Perf. bottom.....
Address.....	5 3/16.....			Perf. top.....
Mineral rights are owned by.....	3.....			Perf. bottom.....
Address.....	2.....			
Drilling commenced.....	Liners Used.....			
Drilling completed.....				
Date shot..... Depth of shot.....				
Open Flow /10ths Water in..... Inch				
/10ths Merc. in..... Inch				
Volume <u>486000</u> Cu. Ft.	CASING CEMENTED.....	SIZE.....	No. FT.....	Date.....
Rock Pressure..... lbs..... hrs.				
Oil..... <u>3 reb</u> bbls., 1st 24 hrs.	COAL WAS ENCOUNTERED AT.....	FEET.....	INCHES.....	
Fresh water <u>15 3/4</u> feet..... feet	FEET.....	INCHES.....	
Salt water <u>none</u> feet..... feet	FEET.....	INCHES.....	

Formation	Color	Hard or Soft	Top	Bottom	Oil Gas or Water	Depth Found	Remarks
slate			925	980			
sand			980	1000			
lime			1000	1020			
state			1020	1044			
Red Rock			1044	1050			
slate			1050	1088	gas	1128	
sand			1093	1148			
slate			1148	1200			
B slate			1200	1284			
sand			1284	1370	gas	1360	
slate			1370	1445			
sand			1445	1470			
slate			1470	1500			
			1500	1515			
lime			1515	1588	gas	1573	
slate			1568	1641	gas	1597	
sand							

01/05/2024



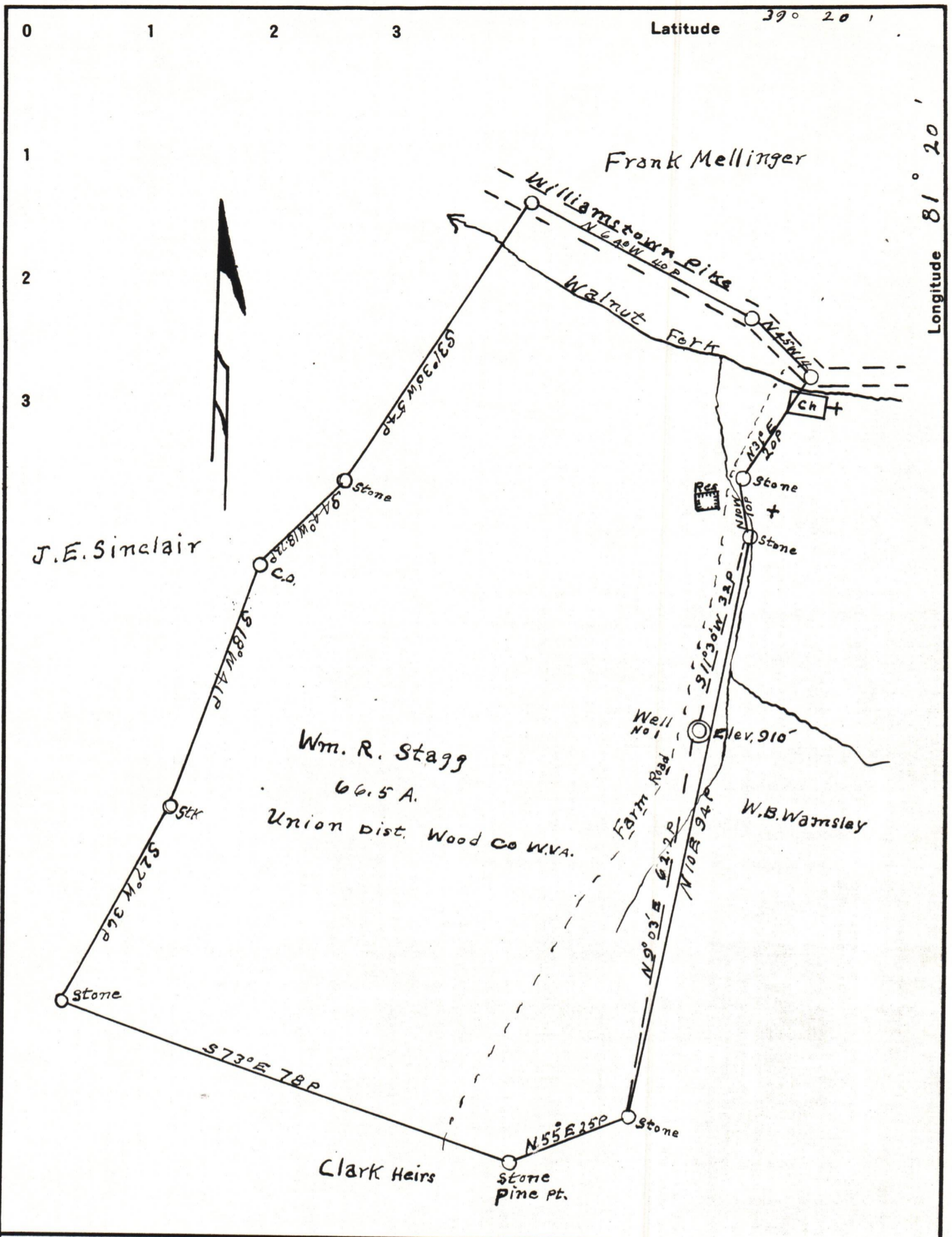

Company Wamsley oil & Gas Co.
 Address Walker, WVA. Rt # 2
 Farm Wm. R. Stagg
 Tract Acres 66.5A Lease No. 1
 Well (Farm) No. 1 Serial No. _____
 Quadrangle Parkersburg
 County Wood
 District Union
 Engineer Robt. Anderson
 Engineer's Registration No. 296
 File No. _____ Drawing No. _____
 Date May 25 1936 Scale 1 in = 20 P

STATE OF WEST VIRGINIA
 DEPARTMENT OF MINES
 OIL AND GAS DIVISION
 CHARLESTON

WELL LOCATION MAP
 FILE NO. Woo-47

01/05/2024

+ Denotes location of well on United States Topographic Maps, scale 1 to 62,500, latitude and longitude lines being represented by border lines as shown.

- Denotes one inch spaces on border line of original tracing.