



STATE OF WEST VIRGINIA
DEPARTMENT OF MINES

RECEIVED
OCT 3 1973-CEN

OIL & GAS DIVISION
DEPT. OF MINES

Oil and Gas Division

OIL AND GAS WELL PERMIT APPLICATION

TO THE DEPARTMENT OF MINES,
Charleston, W. Va.

DATE October 1, 1973

Surface Owner WestVaCo
Address New York, New York
Mineral Owner Glen W. Roberts
Address Elizabeth, W. Va. 26143
Coal Owner None
Address ----
Coal Operator None
Address ----

Company Glen W. Roberts
Address Elizabeth, W. Va. 26143
Farm WestVACO - Dihm Acres 68
Location (waters) Little Kanawha River @ Mouth of Two Riv
Well No. Dihm #1 (One) Elevation 648'
District Burning Springs County Wirt
Quadrangle Spencer

THIS PERMIT MUST BE POSTED AT THE WELL SITE

All provisions being in accordance with Chapter 22, of the W. Va. Code, the location is hereby approved for drilling. This permit shall expire if operations have not commenced by 2-3-74.

Deputy Director - Oil & Gas Division

INSPECTOR TO BE NOTIFIED H. Holliday
Grantsville, WV. PH: 354-6731

GENTLEMEN:

The undersigned well operator is entitled to drill upon the above named farm or tract of land for oil and gas, having fee title thereto, (or as the case may be) under grant or lease dated _____ 19____ by Walter M. Roberts made to Glen W. Roberts and recorded on the _____ day of _____ 19____, in Wirt County, Book 98 Page 407
 NEW WELL _____ DRILL DEEPER _____ REDRILL _____ FRACTURE OR STIMULATE _____ OIL AND GAS WELL ORIGINALLY DRILLED BEFORE JUNE 5, 1969.

The enclosed plat was prepared by a registered engineer or licensed land surveyor and all coal owners and/or operators have been notified as of the above date.

The above named coal owners and/or operator are hereby notified that any objection they wish to make, or are required to make by Section 3 of the Code, must be received by, or filed with the Department of Mines within ten (10) days. *

Copies of this notice and the enclosed plat were mailed by registered mail, or delivered to the above named coal operators or coal owners at their above shown respective address _____ day _____ before, or on the same day with the mailing or delivery of this copy to the Department of Mines at Charleston, West Virginia.

Very truly yours,
(Sign Name) Glen W. Roberts
Well Operator

Address
of
Well Operator

Box 92
Street
Elizabeth
City or Town
West Virginia 26143
State

01/12/2024

*SECTION 3 If no objections are filed or found by the Department of mines, within said period of ten days from the receipt of notice and plat by the department of mines, to said proposed location, the department shall forthwith issue to the well operator a permit reciting the filing of such plat, that no objections have been made by the coal operators or found thereto by the department and that the same is approved and the well operator authorized to proceed.

BOND DRILL

WIR-648
47 105

PERMIT NUMBER

**THIS IS AN ESTIMATE ONLY
ACTUAL INFORMATION WILL BE SUBMITTED ON OG-10 UPON COMPLETION**

PROPOSED WORK ORDER TO X DRILL _____ DEEPEN _____ FRACTURE-STIMULATE _____
 DRILLING CONTRACTOR: (If Known) RESPONSIBLE AGENT:
 NAME Steve Raines NAME Glen W. Roberts
 ADDRESS Gandeeville, W. Va. ADDRESS Elizabeth, W. Va. 26143
 TELEPHONE None TELEPHONE 275-3181
 ESTIMATED DEPTH OF COMPLETED WELL: 1415' ROTARY _____ CABLE TOOLS X
 PROPOSED GEOLOGICAL FORMATION: Salt Sand
 TYPE OF WELL: OIL _____ GAS X COMB. _____ STORAGE _____ DISPOSAL _____
 RECYCLING _____ WATER FLOOD _____ OTHER _____

TENTATIVE CASING PROGRAM:

CASING AND TUBING SIZE	USED FOR DRILLING	LEFT IN WELL	CEMENT FILL UP OR SACKS - CUBIC FT.
20 - 16			
13 - 10 <u>10'</u>	<u>100'</u>	<u>100'</u>	<u>To Surface</u>
9 - 5/8			
8 - 5/8	<u>Where Needed</u>		
7	<u>900' +</u>	<u>900' +</u>	
5 1/2			
4 1/2			
3			Perf. Top
2			Perf. Bottom
Liners			Perf. Top
			Perf. Bottom

APPROXIMATE FRESH WATER DEPTHS 50 FEET ----- SALT WATER None FEET -----
 APPROXIMATE COAL DEPTHS None
 IS COAL BEING MINED IN THE AREA? ----- BY WHOM? -----

TO DRILL:
 SUBMIT FIVE (5) COPIES OF OG - 1, \$100.00 PERMIT FEE, PERFORMANCE BOND AND PERMANENT COPY OF PLAT.

TO DRILL DEEPER OR REDRILL:
 SUBMIT FIVE (5) COPIES OF OG - 1, SHOWING ORIGINAL PERMIT NUMBER AND PERFORMANCE BOND. ON WELLS DRILLED PRIOR TO 1929, A PERMANENT COPY OF THE PLAT AND THE ORIGINAL WELL RECORD MUST ALSO BE SUBMITTED.

TO FRACTURE - STIMULATE:
 OIL AND/OR GAS WELL ORIGINALLY DRILLED BEFORE JUNE 5, 1929, FIVE (5) COPIES OG - 1, PERFORMANCE BOND, PERMANENT PLAT AND ORIGINAL WELL RECORD.
 OIL AND/OR GAS WELL ORIGINALLY DRILLED ON AND/OR AFTER JUNE 5, 1929, FIVE COPIES OG - 1, SHOWING ORIGINAL PERMIT NUMBER, AND PERFORMANCE BOND.
 Required forms must be filed within ninety (90) days of completion for bond release. Inspector to be notified twenty-four (24) hours in advance.

The following waiver must be completed by the coal operator if the permit is to be issued within ten days of receipt thereof.

WAIVER: I the undersigned, Agent for _____ Coal Company, Owner or Operator of the 01/12/2024 under this lease have examined and place on our mine maps this proposed well location.
 We the _____ Coal Company have no objections to said well being drilled at this location, providing operator has complied with all rules and regulations in Articles 4, 5, and 7, Chapter 22 of the West Virginia Code.

 For Coal Company

 Official Title

B-1



RECEIVED

AUG 18 1975

STATE OF WEST VIRGINIA
DEPARTMENT OF MINES

OIL & GAS DIVISION
DEPT. OF MINES

Oil and Gas Division

WELL RECORD 1C

Quadrangle Spencer

Permit No. WIR 648

Rotary _____ Oil _____
Cable X Gas X
Recycling _____ Comb. _____
Water Flood _____ Storage _____
Disposal _____ (Kind)

Company Glen W. Roberts
Address Elizabeth
Farm Glen W. Roberts-Dihm Acres 68
Location (waters) Little Kanawha River
Well No. One Elev. 648
District Burning Springs County Wirt
The surface of tract is owned in fee by _____
Westvaco
Address New York, New York
Mineral rights are owned by Glen W. Roberts
Address Elizabeth
Drilling Commenced 11-73
Drilling Completed 1-74
Initial open flow _____ cu. ft. _____ bbls.
Final production 400,000 cu. ft. per day _____ bbls.
Well open _____ hrs. before test 600# RP.

Casing and Tubing	Used in Drilling	Left in Well	Cement fill up Cu. ft. (Sks.)
Size 20-16			
Cond. 13-10" 10 3/4	95'	95'	35 Sks-Cement to surface
9 5/8			
8 5/8			
7	736'	736'	
5 1/2			
4 1/2			
3			
2 Tubing	1413'	1413'	
Liners Used			

Well treatment details:

No treatment.

Attach copy of cementing record.

Coal was encountered at _____ Feet _____ Inches
Fresh water _____ Feet _____ Salt Water _____ Feet _____
Producing Sand Salt Sand Depth 1413

Formation	Color	Hard or Soft	Top Feet	Bottom Feet	Oil, Gas or Water	* Remarks
Conductor			0	12		
Sand			12	35		
Red Rock			35	55		
Slate			55	68		
Red Rock & Lime			68	95		
Lime			95	105		
Slate			105	115		
Sand			115	225		
Slate			225	235		
Red Rock			235	245		
Slate			245	255		
Lime & Slate			255	400		
Red Rock			400	442		
Lime			442	465		
Red Rock			465	505		
Gritty Lime			505	515		
Red Rock			515	555		
Slate & Shells			555	595		
Gritty Lime			595	605		
Red Rock			605	630		
Red Lime & Slate			630	720		
Black Slate			720	745		
Gritty Lime			745	780		
				OVER		

01/12/2024

(over)

* Indicates Electric Log tops in the remarks section.

B-2

Formation	Color	Hard or Soft	Top Feet	Bottom Feet	Oil, Gas or Water	* Remarks
Slate & Shells			780	865		
Sand			865	935		
Slate & Lime			935	985		
Sand			985	1050		
Black Shale			1050	1080		
Sand			1080	1148		
Black Shale			1148	1310		
Sand			1310	1370	Show Oil	1350
Shale Break			1370	1390		
Lime			1390	1400	Gas	1400-1413
Sand			1400	1413		
				1413	T.D.	

01/12/2024

Date 8/15, 1975

APPROVED Glen Wholbert, Owner

By _____ (Title)

B-3

STATE OF WEST VIRGINIA
DEPARTMENT OF MINES
OIL AND GAS WELLS DIVISION

RECEIVED

OCT 19 1973

INSPECTOR'S WELL REPORT

OIL & GAS DIVISION
DEPT. OF MINES

Permit No. WVA-648

Oil or Gas Well _____
(KIND)

Company <u>ELEN W. ROBERTS</u>	CASING AND TUBING	USED IN DRILLING	LEFT IN WELL	PACKERS
Address <u>ELIZABETH VA 26143</u>	Size			
Farm <u>WEST VACO</u>	16			Kind of Packer
Well No. <u>TEAM #1</u>	13	<u>17'</u>		
District <u>BURDENES SPRING</u> County <u>WEST</u>	10 <u>CEM</u>	<u>95'</u>		Size of
Drilling commenced <u>10-11-73</u>	8 1/4			
Drilling completed _____ Total depth _____	6 5/8			Depth set
Date shot _____ Depth of shot _____	5 3/16			
Initial open flow _____ /10ths Water in _____ Inch	3			Perf. top
Open flow after tubing _____ /10ths Merc. in _____ Inch	2			Perf. bottom
Volume _____ Cu. Ft.	Liners Used			Perf. top
Rock pressure _____ lbs. _____ hrs.				Perf. bottom
Oil _____ bbls., 1st 24 hrs.				
Fresh water <u>25'</u> feet _____ feet				
Salt water _____ feet _____ feet				

35 3/4
CASING CEMENTED 10 3/4 SIZE 95' No. FT. 107 1/2 Date

NAME OF SERVICE COMPANY READYCRAVE

COAL WAS ENCOUNTERED AT 107 1/2 FEET _____ INCHES
_____ FEET _____ INCHES _____ FEET _____ INCHES
_____ FEET _____ INCHES _____ FEET _____ INCHES

Drillers' Names H. WESTFALL & S. PATNEZ

Remarks: SHUT DOWN AT 95' FOR FUEL.

STEVE PATNEZ SAUNDER

10-17-73
DATE

H.C. Holliday
DISTRICT WELL INSPECTOR

01/12/2024

B-4

STATE OF WEST VIRGINIA
DEPARTMENT OF MINES
OIL AND GAS WELLS DIVISION

RECEIVED

NOV 16 1973

OIL & GAS DIVISION
DEPT. OF MINES

INSPECTOR'S WELL REPORT

Permit No. WIR-648

Oil or Gas Well _____
(KIND)

Company <u>GLEN W. ROBERTS</u>	CASING AND TUBING	USED IN DRILLING	LEFT IN WELL	PACKERS
	Address <u>ELIZABETH, W. VA. 26143</u>	Size		
Farm <u>WEST VARD</u>	16			Kind of Packer _____
Well No. <u>DIHN #1</u>	13	<u>12'</u>		
District <u>DUAL SPRINGS</u> County <u>WEST</u>	10 <u>CEM.</u>	<u>95'</u>		Size of _____
Drilling commenced <u>10-11-73</u>	8 1/4			Depth set _____
Drilling completed _____ Total depth _____	6 5/8			
Date shot _____ Depth of shot _____	5 3/16			Perf. top _____
Initial open flow _____ /10ths Water in _____ Inch	3			Perf. bottom _____
Open flow after tubing _____ /10ths Merc. in _____ Inch	2			Perf. top _____
Volume _____ Cu. Ft.	Liners Used			Perf. bottom _____
Rock pressure _____ lbs. _____ hrs.	<u>35 3/4</u>			
Oil _____ bbls., 1st 24 hrs.	CASING CEMENTED <u>95 3/4</u> SIZE <u>95</u> No. FT. <u>151273</u> Date			
Fresh water <u>34'</u> feet _____ feet	NAME OF SERVICE COMPANY <u>READY CEMENT CO.</u>			
Salt water _____ feet _____ feet	COAL WAS ENCOUNTERED AT <u>100</u> FEET _____ INCHES			
	_____ FEET _____ INCHES _____ FEET _____ INCHES			
	_____ FEET _____ INCHES _____ FEET _____ INCHES			

Drillers' Names M. WESTFALL-S. PATRICK

STEVE PATRICKS - SPURDIE

Remarks: LAYING FUEL LINE. - S. DOWN AT 95'

11-14-73
DATE

H.A. Holiday
DISTRICT WELL INSPECTOR

01/12/2024

11-28-73
DATE

H.A. Holiday
DISTRICT WELL INSPECTOR

B-6

STATE OF WEST VIRGINIA
DEPARTMENT OF MINES
OIL AND GAS WELLS DIVISION

RECEIVED

NOV 28 1973

OIL & GAS DIVISION
DEPT. OF MINES

INSPECTOR'S WELL REPORT

Permit No. WIR-648

Oil or Gas Well _____
(KIND)

Company <u>ELEN W. ROBERTS</u>	CASING AND TUBING	USED IN DRILLING	LEFT IN WELL	PACKERS
Address <u>ELIZABETH, W.VA. 26143</u>	Size			Kind of Packer _____
Farm <u>WEST VACS</u>	16			
Well No. <u>DEHM #1</u>	13			
District <u>QUANING SPRING</u> County <u>WEST</u>	10 <u>CEM.</u>	<u>95</u>		Size of _____
Drilling commenced <u>10-11-73</u>	8 1/4			Depth set _____
Drilling completed _____ Total depth _____	6 5/8			
Date shot _____ Depth of shot _____	5 3/16			Perf. top _____
Initial open flow _____ /10ths Water in _____ Inch	3			Perf. bottom _____
Open flow after tubing _____ /10ths Merc. in _____ Inch	2			Perf. top _____
Volume _____ Cu. Ft.	Liners Used			Perf. bottom _____
Rock pressure _____ lbs. _____ hrs.				
Oil _____ bbls., 1st 24 hrs.	CASING CEMENTED <u>35 5/8"</u> <u>10 3/4"</u> SIZE <u>95'</u> No. FT. <u>107 1/2</u> Date _____			
Fresh water <u>25</u> <u>14 FULL</u> feet _____ feet	NAME OF SERVICE COMPANY <u>READY CEM. CO.</u>			
Salt water _____ feet _____ feet	COAL WAS ENCOUNTERED AT <u>NONE</u> FEET _____ INCHES			
	_____ FEET _____ INCHES _____ FEET _____ INCHES			
	_____ FEET _____ INCHES _____ FEET _____ INCHES			

Drillers' Names S. MAINES - M. WESTFALL

Remarks: S. MAINES - SPUDDER
DRILLING AT 525'

11-26-73
DATE

H. A. NOLLING
DISTRICT WELL INSPECTOR
01/12/2024

B-7

STATE OF WEST VIRGINIA
DEPARTMENT OF MINES
OIL AND GAS WELLS DIVISION

RECEIVED

DEC 10 1973

INSPECTOR'S WELL REPORT

OIL & GAS DIVISION
DEPT. OF MINES
Oil or Gas Well
(KIND)

Permit No. WTA-648

Company <u>GLEN W. ROBERTS</u>	CASING AND TUBING	USED IN DRILLING	LEFT IN WELL	PACKERS
	Address <u>ELIZABETH, W. VA. 26143</u>	Size		
Farm <u>WEST VACO</u>	16			
Well No. <u>DIAN #1</u>	13			
District <u>BOONING SPRING</u> County <u>WEST</u>	10 <u>CEM.</u>	<u>9 1/2'</u>		Size of
Drilling commenced <u>10-11-73</u>	8 1/4			
Drilling completed _____ Total depth _____	6 5/8	<u>636</u>		Depth set
Date shot _____ Depth of shot _____	5 3/16			
Initial open flow _____ /10ths Water in _____ Inch	3			Perf. top
Open flow after tubing _____ /10ths Merc. in _____ Inch	2			Perf. bottom
Volume _____ Cu. Ft.	Liners Used			Perf. top
Rock pressure _____ lbs. _____ hrs.				Perf. bottom
Oil _____ bbls., 1st 24 hrs.				
Fresh water <u>35</u> ^{W FULL} feet _____ feet				
Salt water <u>NONE</u> feet _____ feet				

^{35 SRS} CASING CEMENTED 10 3/4 SIZE 9 1/2' No. FT. 101225 Date

NAME OF SERVICE COMPANY PEANUTS & CO.

COAL WAS ENCOUNTERED AT NONE FEET _____ INCHES

_____ FEET _____ INCHES _____ FEET _____ INCHES

_____ FEET _____ INCHES _____ FEET _____ INCHES

Drillers' Names S. PAINEY - M. WESTFALL

Remarks: DRILLING AT 140' S. PAINEY - SPUDDER
2 RD SALT 9 - 1310-1370 - SHOW OIL - 1350
3 RD SALT 9 - 1400 - 675-1461

12-6-73
DATE

J. C. Holliday
DISTRICT WELL INSPECTOR

01/12/2024

B-8

STATE OF WEST VIRGINIA
DEPARTMENT OF MINES
OIL AND GAS WELLS DIVISION

RECEIVED

DEC 12 1973

OIL & GAS DIVISION
DEPT. OF MINES

INSPECTOR'S WELL REPORT

Permit No. WTA-648

Oil or Gas Well _____
(KIND)

Company <u>GLEN W. ROBERTS</u>	CASING AND TUBING	USED IN DRILLING	LEFT IN WELL	PACKERS
Address <u>ELIZABETH, W.VA. 26143</u>	Size			
Farm <u>WEST VACO</u>	16			Kind of Packer _____
Well No. <u>DIANA #1</u>	13	12'	12'	<u>ANCHOR</u>
District <u>QUANTICO SPRES</u> County <u>WEST</u>	10 <u>CEM.</u>	95	99	Size of _____
Drilling commenced <u>10-11-73</u>	8 1/4	729	66'	<u>2 X 7"</u>
Drilling completed <u>12-6-73</u> Total depth <u>1413'</u>	6 5/8	636	636	Depth set _____
Date shot _____ Depth of shot _____	5 3/16			<u>1597'</u>
Initial open flow <u>42</u> /10ths Water in <u>2</u> Inch	3			Perf. top _____
Open flow after tubing _____ /10ths Merc. in _____ Inch	2 <u>TUB</u>		1413	Perf. bottom _____
Volume <u>315 (NATURAL) 12</u> Cu. Ft.	Liners Used			Perf. top _____
Rock pressure <u>500</u> lbs. _____ hrs.				Perf. bottom _____
Oil _____ bbls., 1st 24 hrs.				
Fresh water <u>30' A FULL</u> feet _____ feet	<u>35 5/8"</u> CASING CEMENTED <u>10 3/4</u> SIZE <u>95</u> No. FT. <u>1512</u> Date _____			
Salt water <u>NONE</u> feet _____ feet	NAME OF SERVICE COMPANY <u>PREMIER CEM. CO.</u> COAL WAS ENCOUNTERED AT <u>1700</u> FEET _____ INCHES _____ FEET _____ INCHES FEET _____ INCHES _____ FEET _____ INCHES FEET _____ INCHES			

Drillers' Names S. PAINES - M. WESTFALL

STEVE PAINES - SPUDDER.

Remarks: WELL COMPLETED NATURAL

12-10-73

DATE

H. C. McRobbie

DISTRICT WELL INSPECTOR

01/12/2024

6-9

STATE OF WEST VIRGINIA
DEPARTMENT OF MINES
OIL AND GAS WELLS DIVISION

RECEIVED

SEP 9 1974

OIL & GAS DIVISION
DEPT. OF MINES
INSPECTOR'S PLUGGING REPORT

Permit No. Wir-648-P

Well No. 3

COMPANY Camden Oil Co. ADDRESS _____
FARM Basil Bumgardner DISTRICT Reedy COUNTY Wirt

Filling Material Used _____

Liner Location Amount Packer Location

PLUGS USED AND DEPTH PLACED			BRIDGES	CASING AND TUBING		
CEMENT-THICKNESS	WOOD-SIZE	LEAD	CONSTRUCTION-LOCATION	RECOVERED	SIZE	LOST
2590 - 2470	Cem			750'	4 1/2	1840
2470 - 750	Gel					
750 - 710	Cem					
710 - 200	Gel					
200 - 180	Cem					
180 - 50	Gel					
50 - 0	Cem					

Drillers' Names Ron Williams
J. L. Morris - Service Rig

Remarks:

Dowell was used in plugging operation

Job Comm - 9-5-74

Job Comp - 9-5-74

9-5-74

DATE

I hereby certify I visited the above well on this date.

W. E. Goodright

DISTRICT WELL INSPECTOR

01/12/2024

STATE OF WEST VIRGINIA
DEPARTMENT OF MINES
OIL AND GAS WELLS DIVISION

INSPECTOR'S WELL REPORT

Permit No. _____

Oil or Gas Well _____
(KIND)

	CASING AND TUBING	USED IN DRILLING	LEFT IN WELL	PACKERS
Company _____	Size			
Address _____	16			Kind of Packer _____
Farm _____	13			
Well No. _____	10			Size of _____
District _____ County _____	8 1/4			
Drilling commenced _____	6 5/8			Depth set _____
Drilling completed _____ Total depth _____	5 3/16			
Date shot _____ Depth of shot _____	3			Perf. top _____
Initial open flow _____ /10ths Water in _____ Inch	2			Perf. bottom _____
Open flow after tubing _____ /10ths Merc. in _____ Inch	Liners Used _____			Perf. top _____
Volume _____ Cu. Ft.				Perf. bottom _____
Rock pressure _____ lbs. _____ hrs.	CASING CEMENTED _____ SIZE _____ No. FT. _____ Date _____			
Oil _____ bbls., 1st 24 hrs.	NAME OF SERVICE COMPANY _____			
Fresh water _____ feet _____ feet	COAL WAS ENCOUNTERED AT _____ FEET _____ INCHES			
Salt water _____ feet _____ feet	_____ FEET _____ INCHES _____ FEET _____ INCHES			
	_____ FEET _____ INCHES _____ FEET _____ INCHES			

Drillers' Names _____

Remarks:

DATE

DISTRICT WELL INSPECTOR

01/12/2024

B-10



State of West Virginia

Department of Mines
Oil and Gas Division
Charleston 25305
August 26, 1975

JOHN ASHCRAFT
Director

ROBERT L. DODD
Deputy Director

Paul Goodnight
Smithville, W.Va.

PERMIT	WIRT-648
COMPANY	Glen W. Roberts
FARM	WestVaco
WELL NO	Dihm # 1
DISTRICT	Burning Springs
COUNTY	Wirt

Dear Sir:

Please make a final inspection of the well described above.

Very truly yours,

Robert L. Dodd

RLD/ ch (Plat)

B-11

STATE OF WEST VIRGINIA
DEPARTMENT OF MINES
OIL AND GAS WELLS DIVISION

RECEIVED

MAR 16 1976

OIL & GAS DIVISION
DEPT. OF MINES

INSPECTOR'S WELL REPORT

Permit No. Wir-648

Oil or Gas Well _____
(KIND)

Company <u>Glen W. Roberts</u>	CASING AND TUBING	USED IN DRILLING	LEFT IN WELL	PACKERS
Address <u>to</u>	Size			
Farm <u>Westuaco</u>	16			Kind of Packer _____
Well No. <u>1</u>	13			
District <u>Burning Spring</u> County <u>Wirt</u>	10			Size of _____
Drilling commenced _____	8 1/4			
Drilling completed _____ Total depth _____	6 5/8			Depth set _____
Date shot _____ Depth of shot _____	5 3/16			
Initial open flow _____ /10ths Water in _____ Inch	3			Perf. top _____
Open flow after tubing _____ /10ths Merc. in _____ Inch	2			Perf. bottom _____
Volume _____ Cu. Ft.	Liners Used			Perf. top _____
Rock pressure _____ lbs. _____ hrs.				Perf. bottom _____
Oil _____ bbls., 1st 24 hrs.	CASING CEMENTED _____ SIZE _____ No. FT. _____ Date _____			
Fresh water _____ feet _____ feet	NAME OF SERVICE COMPANY _____			
Salt water _____ feet _____ feet	COAL WAS ENCOUNTERED AT _____ FEET _____ INCHES			
	_____ FEET _____ INCHES _____ FEET _____ INCHES			
	_____ FEET _____ INCHES _____ FEET _____ INCHES			

Drillers' Names _____

Remarks:

Rel-

3-11-76

DATE

[Signature]

DISTRICT WELL INSPECTOR

01/12/2024



01/12/2024

e-1

1.0 API well number: (If not available, leave blank. 14 digits.)	<u>47-105-0648</u>			
2.0 Type of determination being sought: (Use the codes found on the front of this form.)	<u>108</u> Section of NGPA		Category Code	
3.0 Depth of the deepest completion location: (Only needed if sections 103 or 107 in 2.0 above.)	_____ feet			
4.0 Name, address and code number of applicant: (35 letters per line maximum. If code number not available, leave blank.)	<div style="text-align: right; font-size: small;">Ray Resources Div. of F.D.O.C. Seller Code</div> Name <u>RAY RESOURCES, DIVISION</u> Street <u>630 Commerce Square</u> City <u>Charleston, W. Va. 25301</u> State _____ Zip Code _____ Street <u>DIAMOND OIL CORPORATION</u> City <u>630 Commerce Square</u> State _____ Zip Code _____			
5.0 Location of this well: [Complete (a) or (b).] (a) For onshore wells (35 letters maximum for field name.)	Field Name <u>Burning Springs</u> State <u>WV</u> County <u>Wirt</u>			
(b) For OCS wells:	Area Name <u>N/A</u> Block Number _____ Date of Lease: _____ Mo. Day Yr. OCS Lease Number _____			
(c) Name and identification number of this well: (35 letters and digits maximum.)	<u>Dillon #663</u>			
(d) If code 4 or 5 in 2.0 above, name of the reservoir: (35 letters maximum.)	_____			
6.0 (a) Name and code number of the purchaser: (35 letters and digits maximum. If code number not available, leave blank.)	Name <u>Columbia Gas Trans</u> Buyer Code _____			
(b) Date of the contract:	<u>05/21/73</u> Mo. Day Yr.			
(c) Estimated annual production:	<u>12.25</u> MMcf.			
	(a) Base Price (\$/MMBTU)	(b) Tax	(c) All Other Prices [Indicate (+) or (-).]	(d) Total of (a), (b) and (c)
7.0 Contract price: (As of filing date. Complete to 3 decimal places.)	<u>2.264</u>	<u>..338</u>	<u>..009</u>	<u>2.611</u>
8.0 Maximum lawful rate: (As of filing date. Complete to 3 decimal places.)	<u>2.264</u>	<u>..338</u>	<u>..009</u>	<u>2.611</u>
9.0 Person responsible for this application:	Name <u>TOM R. RAGSDALE</u> Title <u>VICE PRES</u> Signature <u>[Signature]</u> Date Application is Completed <u>1-30-79</u> Phone Number <u>304-344-8393</u>			
Agency Use Only	Date Received by Juris. Agency <u>FEB 28 1979</u>			
Date Received by FERC	_____			

01/12/2024

REVISIONS:

DATE: SEP 19 1979

WELL-FILE CODE

WELL OPERATOR: Ray Resources

000726

FIRST PURCHASER: Columbia Gas Transmission

004030

OTHER:

Qualifies as Section 108, stripper well
R. S. Ray

W. Va. Department of Mines, Oil & Gas Division
 WELL DETERMINATION FILE NUMBER
790228-103-105-0648
 Use Above File Number on all Communications
 Relating to Determination of this Well

CHECK EACH ITEM AS COMPLETE OR NOTE WHAT IS MISSING

ITEM NO.

- 1 FERC-121 Items not completed - Line No. _____
- 2 IV-1 - Agent James S. Ray
- 3 IV-2 - Well Permit
- 4 IV-6 - Well Plat
- 5 IV-35- Well Record Drilling Deepening _____
- 6 IV-36- Gas-Oil Test: Gas Only Was Oil Produced? _____ Ratio _____
- 7 IV-39- Annual Production 1 years 1 mo.
- 8 IV-40- 90 day Production 93 Days off Line: _____
- 9 IV-48- Application for Certification. Complete?
- 10 - 17 IV Form #51 - 52 - 53 - 54 - 55 - 56 - 57 - 58. Complete Affidavit Signed
- 18 - 28 Other: Survey _____ Logs _____ Geological Charts _____ Structure Map _____
 1:4000 Map _____ Well Tabulations _____ Gas Analyses _____
- (5) Date Commenced: 11-73 Deepened _____
 Date Completed: 1-74
- (5) Production Depth: 1400-1413'
 Frac Depth: _____
- (5) Production Formation: Salt Sand
- (5) Final Open Flow: 400 MCF
 Initial Potential: _____
- (5) Final Rock Pressure: 600 #
 Static H.T. Initial: _____
- (6) Other Gas Test: _____
- (7) Avg. Daily Gas from Annual Production: $\frac{10,992}{335} = 32.8$ MCF
- (8) Avg. Daily Gas from 90-day ending w/1-120 days $\frac{3383}{93} = 36.4$ MCF
- (8) Line Pressure: N/A PSIG from Daily Report _____
- (5) Oil Production: Yes From Completion Report 1310-1370'
- (10-17) Does lease inventory indicate enhanced recovery being done: NO 01/12/2024
- (10-17) Is affidavit signed? Notarized?
- Does official well record with the Department confirm the submitted information? Yes
- Additional Information _____ Does computer program confirm? _____
- Was Determination Objected to? _____ By Whom? _____

MR

STATE OF WEST VIRGINIA
DEPARTMENT OF MINES, OIL AND GAS DIVISION

Date 1-30 1979

Operator's Well No. 663

API Well No. 47 - 105 - 0648
State County Permit

WELL CLASSIFICATION FORM

STRIPPER GAS WELL

MGPA Section 108

DESIGNATED AGENT Ray Resources, Div. OF F. D. O. C.

ADDRESS 630 Commerce Sq.

Charleston, W. Va. 25301

WELL OPERATOR Ray Resources, Div of F. D. O. C.

ADDRESS 630 Commerce Sq.

Charleston W. Va. 25301

GAS PURCHASER Columbia Gas

ADDRESS 1700 MacCable Ave SE

Charleston W. Va 25325

ELEVATION: 648

Watershed Little Kanawha River

Dist Bu Sp. County Wirt Quad. Spencer

Gas Purchase Contract No. 7743

Meter Chart Code 2029030

Date of Contract 5-21-73

* * * * *

Provide a complete inventory of the lease and production equipment used for the well for the previous 24 months or, if less than 24 months, the period the well has been in production. Include a complete list of equipment or processes used in connection with recognized enhanced recovery techniques during completion or production. (Attach separate sheets, if necessary.)

- 1) well head
- 2) 2" gathering line
- 3) tubing
- 4) separator
- 5) tank

List all records reasonably available to you which contain information relevant to a determination of eligibility (including production records, B&O Tax Records and royalty payment records) and indicate the location of such records:

- 1) Production Statements
 - 2) Lease files
 - 3) Tax Records
- Located in Main Office

01/12/2024

Describe the search made of any records listed above:

- 1) Checked Production Statements
- 2) Checked Lease files
- 3) Checked Tax Records

Are you aware of any other information which would tend to be inconsistent with the information specified above? Yes No . If yes, indicate the type and source of the information.

TOM R. RAGSDALE AFFIDAVIT

I, Tom R. Ragsdale, having been first sworn according to law, state that I have caused to be made a diligent search of those records hereinbefore indicated in the manner herein described, that the information contained in this document is true and accurate and that on the basis of the records and examinations hereinbefore described, and to the best of my information, knowledge and belief, the well for which this certification is sought qualifies as a stripper well.

Tom R. Ragsdale

STATE OF WEST VIRGINIA,

COUNTY OF Kanawha TO WIT:

I, Donald R. Wilcox, Jr. a Notary Public in and for the state and county aforesaid, do certify that Tom R. Ragsdale, whose name is signed to the writing above, bearing date the 30th day of JANUARY, 19 79, has acknowledged the same before me, in my county aforesaid.

Given under my hand and official seal this 17th day of February, 19 79.

My term of office expires on the 12th day of August, 1980 **01/12/2024**

Donald R. Wilcox, Jr.
Notary Public

[NOTARIAL SEAL]

IV-39-NC

STATE OF WEST VIRGINIA
DEPARTMENT OF MINES
DIVISION OF OIL AND GAS

REPORT OF MONTHLY PRODUCTION
GAS VOLUMES IN MFC 2 14, 73
OIL IN BARRELS 2 60 DEGREES
OPERATOR: Ray Resources, Division of Flying Diamond Oil Corporation

REPORT DATE - 2/6/79

1978
API 47-105-0648 FARM 1 Dixon

GAS MFC	COUNTY: Wirt							AVG. FLOW PRESSURE	SHUT-IN PRESSURE	TOTALS
	J	F	M	A	M	J	J			
_____	_____	_____	_____	_____	_____	_____	_____	_____	_____	_____
OIL BBL	J	F	M	A	M	J	J	30	31	0
DAYS ONLINE	_____	_____	_____	_____	_____	_____	_____	_____	_____	_____

1978
API 47-105-0648 FARM 1 Dixon

GAS MFC	COUNTY: Wirt							AVG. FLOW PRESSURE	SHUT-IN PRESSURE	TOTALS
	J	F	M	A	M	J	J			
_____	_____	_____	_____	_____	_____	_____	_____	_____	_____	_____
OIL BBL	J	F	M	A	M	J	J	30	31	0
DAYS ONLINE	_____	_____	_____	_____	_____	_____	_____	_____	_____	_____

SUMMARIZATION SCHEDULE
Section 271. 804 (b)

In accordance with Section 271.804(b) please list all other wells which are to be used in determining this well classification under Part 271 Subpart H.

API NUMBERS
47-105-0637
47-105-0664

01/12/2024

10/3/73 CEN

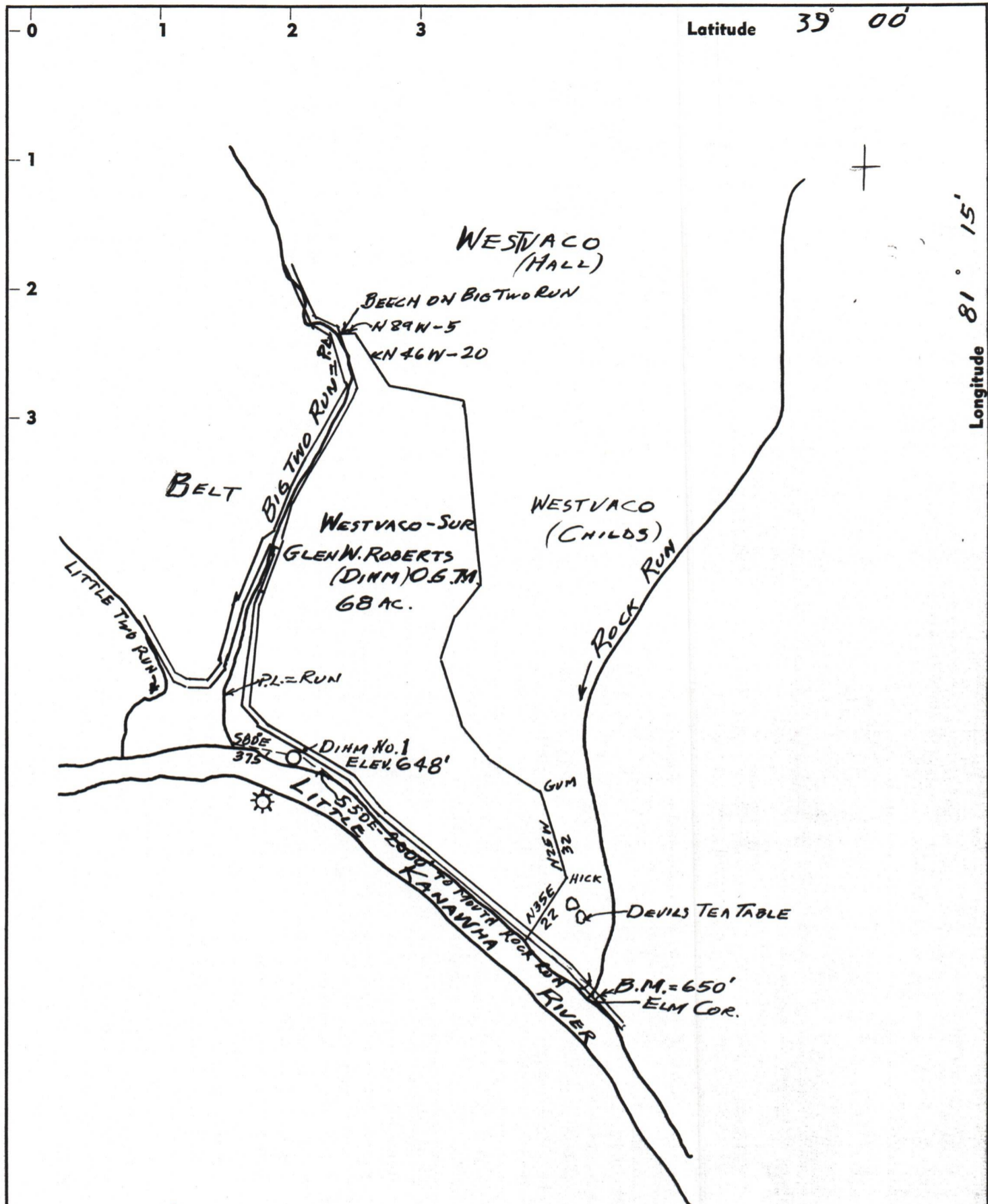

- New Location .
- Drill Deeper
- Redrill
- Abandonment

ELEV. FROM B.M. AT BRIDGE
 "I, the undersigned, hereby certify that this map is correct to the best of my knowledge and belief and shows all the information required by paragraph 6 of the rules and regulations of the oil and gas section of the mining laws of West Virginia."
 LIMIT OF ERROR 1 IN 200

Company	GLEN W. ROBERTS
Address	ELIZABETH, WEST VA. 26143
Farm	WESTVACO-DIHM
Tract	Acres 68 Lease No.
Well (Farm) No.	DIHM No 1 Serial No.
Elevation (Spirit Level)	648 FT.
Quadrangle	SPENCER
County	WIRT District BURNING SPRINGS
Engineer	Glen W Roberts
Engineer's Registration No.	860
File No.	Drawing No.
Date	SEPT 28, 1973 Scale 1 IN = 40 POLES

STATE OF WEST VIRGINIA
 DEPARTMENT OF MINES
 OIL AND GAS DIVISION
 CHARLESTON
 WELL LOCATION MAP
 FILE NO. Win-648 04/12/2024

+ Denotes location of well on United States Topographic Maps, scale 1 to 62,500, latitude and longitude lines being represented by border lines as shown.
 - Denotes one inch spaces on border line of original tracing.
 47 105

B-5

STATE OF WEST VIRGINIA
DEPARTMENT OF MINES
OIL AND GAS WELLS DIVISION

RECEIVED

NOV 26 1973

INSPECTOR'S WELL REPORT

Permit No. WTA-648

Oil or Gas Well _____
(KIND)

Company <u>OLEN W. ROBERTS</u>	CASING AND TUBING	USED IN DRILLING	LEFT IN WELL	PACKERS
	Address <u>ELIZABETH, WVA-26143</u>	Size		
Farm <u>WEST VACA</u>	16			
Well No. <u>DEHM #1</u>	13	<u>12'</u>		
District <u>BURNING SPRING</u> County <u>WEST</u>	10 <u>CEM</u>	<u>9'</u>		Size of _____
Drilling commenced <u>10-11-73</u>	8 1/4			
Drilling completed _____ Total depth _____	6 5/8			Depth set _____
Date shot _____ Depth of shot _____	5 3/16			
Initial open flow _____ /10ths Water in _____ Inch	3			Perf. top _____
Open flow after tubing _____ /10ths Merc. in _____ Inch	2			Perf. bottom _____
Volume _____ Cu. Ft.	Liners Used			Perf. top _____
Rock pressure _____ lbs. _____ hrs.				Perf. bottom _____
Oil _____ bbls., 1st 24 hrs.	CASING CEMENTED <u>35 S.H.F.</u> <u>10 3/4</u> SIZE <u>9 5/8</u> No. FT. <u>1012</u> Date _____			
Fresh water <u>25</u> ^{APU} feet _____ feet	NAME OF SERVICE COMPANY <u>READY CEMENT CO.</u>			
Salt water _____ feet _____ feet	COAL WAS ENCOUNTERED AT <u>1200</u> FEET _____ INCHES			
	FEET	INCHES	FEET	INCHES
	FEET	INCHES	FEET	INCHES

Drillers' Names S. HAINES - M. WESTFALL

STEVE HAINES - SPLUNDER

Remarks: DRILLING @ 190'

11-28-73
DATE

H.A. Hobbie
DISTRICT WELL INSPECTOR

of Chapter 22 have been met. "Bonds will stay in force for life of the wells."

Very truly yours,
Robert L. Dodd
Robert L. Dodd, Deputy Director
Oil and Gas Division

01/12/2024

STATE OF WEST VIRGINIA
DEPARTMENT OF MINES
OIL AND GAS WELLS DIVISION
INSPECTOR'S PLUGGING REPORT

Permit No. _____

Well No. _____

COMPANY _____

ADDRESS _____



01/12/2024

B-12



State of West Virginia

Department of Mines

Oil and Gas Division

Charleston 25305

March 17, 1976

*Glen W. Roberts
Box 92
Elizabeth, W.Va. 26143*

Dear Sir:

The required records and reports have been received in this office and the District Inspectors have submitted Final Inspections for the following wells listed below:

- WIRT-620 - Denzil Ferree # 1 - Burning Springs District*
- WIRT-622 - D. P. Ferree # 2 - Burning Springs District*
- WIRT-648 - West Va Co - Dihm # 1 - Burning Springs*

In accordance with Chapter 22, Article 4, Section 2, the bond coverage for above captioned wells will stay in force until such time as the requirements of Chapter 22 have been met. "Bonds will stay in force for life of the wells."

Very truly yours,

A handwritten signature in cursive script, appearing to read "Robert L. Dodd".

Robert L. Dodd, Deputy Director
Oil and Gas Division

RLD/cc

01/12/2024