



STATE OF WEST VIRGINIA
DEPARTMENT OF MINES

RECEIVED

JUL 16 1973-CEN

OIL & GAS DIVISION
DEPT. OF MINES

Oil and Gas Division

OIL AND GAS WELL PERMIT APPLICATION

TO THE DEPARTMENT OF MINES,
Charleston, W. Va.

DATE July 13, 1973

Surface Owner W.Va. Paper Company

Company Halbert and Prough

Address Summersville, West Virginia

Address 317 Bank of Commerce, Abalene, Tex

Mineral Owner Jewel Boyce

Farm Jewel Boyce Acres 62

Address Akron, Ohio

Location (waters) Little Kanawha River

Coal Owner _____

Well No. One Elevation 908

Address _____

District Burning Springs County Wirt

Coal Operator _____

Quadrangle Spencer

Address _____

THIS PERMIT MUST BE POSTED AT THE WELL SITE

All provisions being in accordance with Chapter 22, of the W. Va Code, the location is hereby approved for drilling. This permit shall expire if operations have not commenced by 11-16-73.

Deputy Director - Oil & Gas Division

INSPECTOR TO BE NOTIFIED Harry Holliday
Grantsville, W.Va. PH: 354-6731

GENTLEMEN:

The undersigned well operator is entitled to drill upon the above named farm or tract of land for oil and gas, having fee title thereto, (or as the case may be) under grant or lease dated June 11, 1973, by Jewel Boyce made to Halbert & Prough and recorded on the _____ day of _____ 19____, in Wirt County, Book _____ Page _____

NEW WELL _____ DRILL DEEPER _____ REDRILL _____ FRACTURE OR STIMULATE
_____ OIL AND GAS WELL ORIGINALLY DRILLED BEFORE JUNE 5, 1969.

The enclosed plat was prepared by a registered engineer or licensed land surveyor and all coal owners and/or operators have been notified as of the above date.

The above named coal owners and/or operator are hereby notified that any objection they wish to make, or are required to make by Section 3 of the Code, must be received by, or filed with the Department of Mines within ten (10) days. *

Copies of this notice and the enclosed plat were mailed by registered mail, or delivered to the above named coal operators or coal owners at their above shown respective address _____ day _____ before, or on the same day with the mailing or delivery of this copy to the Department of Mines at Charleston, West Virginia.

Very truly yours,

(Sign Name) A.T. Halbert
Well Operator

Address
of
Well Operator

317 Bank of Commerce
Street
Abalene
City or Town
Texas
State

01/26/2024

*SECTION 3 If no objections are filed or found by the Department of mines, within said period of ten days from the receipt of notice and plat by the department of mines, to said proposed location, the department shall forthwith issue to the well operator a permit reciting the filing of such plat, that no objections have been made by the coal operators or found thereto by the department and that the same is approved and the well operator authorized to proceed.

BOND DRILL

WIRT-636

PERMIT NUMBER

47 105

THIS IS AN ESTIMATE ONLY

RECEIVED



01/26/2024

providing operator has complied with all rules and regulations in Articles 4, 5, and 7, Chapter 22 of the west virginia Code.

For Coal Company

Official Title

WV-030

WEST VIRGINIA

101 10



RECEIVED

APR 11 1974

OIL & GAS DIVISION
DEPT. OF MINES

B-1
39-00
9 3-24

STATE OF WEST VIRGINIA
DEPARTMENT OF MINES
Oil and Gas Division
WELL RECORD

Quadrangle Spencer

Permit No. WV-636

Rotary Oil _____
Cable _____ Gas
Recycling _____ Comb.
Water Flood _____ Storage _____
Disposal _____ (Kind) _____

Company <u>Halbert & Prough</u>	Casing and Tubing	Used in Drilling	Left in Well	Cement fill up Cu. ft. (Sks.)
Address <u>Abilene, Texas</u>	Size			
Farm <u>Jewel Boyce</u> Acres <u>62.</u>	20-16			
Location (waters) <u>Little Kanawha River</u>	Cond.			
Well No. <u>One</u> Elev. <u>917 KB</u>	13-10"			
District <u>Burning Springs</u> County <u>Wirt</u>	9 5/8			
The surface of tract is owned in fee by _____	8 5/8	212	212	75 Sk.
<u>W. Va. Paper Company</u>	7			
Address <u>Summersville, W. Va.</u>	5 1/2			
Mineral rights are owned by <u>Jewel Boyce</u>	4 1/2	2065	2065	To 1400 ft.
Address <u>Akron, Ohio</u>	3			
Drilling Commenced <u>7/21/73</u>	2			
Drilling Completed <u>7/25/73</u>	Liners Used			
Initial open flow <u>not taken</u> cu. ft. _____ bbls.				
Final production <u>250m</u> cu. ft. per day _____ bbls.				
Well open <u>24</u> hrs. before test <u>700</u> RP.				

Well treatment details:
Attach copy of cementing record.
Perforated 1984 1995 12 holes
Well fractured 600 bbl. water 4000 lb, 20/40 sand 500 gal 15% acid

Coal was encountered at None Feet _____ Inches
Fresh water _____ Feet _____ Salt Water _____ Feet _____
Producing Sand Big Injun Depth 1968 @ 1996

Formation	Color	Hard or Soft	Top Feet	Bottom Feet	Oil, Gas or Water	* Remarks
Soil			0	10		
Shale & Sand			10	352		
Sandstone			352	370		
Shale			370	404		
Sandstone			404	512		
Shale (Sandy)			512	660		
Shale & Red Rock			660	990		
Shale (Sandy)			990	1032		
Sand			1032	1056		
Shale			1056	1146		
Sand			1146	1186		
Shale			1186	1248		
Sandstone			1248	1420		
Shale (Sandy)			1420	1600		
Sandstone			1600	1676		
Shale			1676	1707		
Sandstone			1707	1762		
Shale			1762	1780		
Maxton			1780	1808		
Little Lime - Pencil Cave			1808	1838		
Big Lime			1838	1968		
Big Injun			1968	1996		
Shale			1996	2033		
				2033	TOTAL DEPTH LOG	
				2075	TOTAL DEPTH DRILLER	

01/26/2024

(over)

* Indicates Electric Log tops in the remarks section.

Formation	Color	Hard or Soft	Top Feet	Bottom Feet	Oil, Gas or Water	* Remarks

Well fractured 600 psi. water. Perforated 1984 12 15 holes. 1000 lb. 20% a mg 500 gal 15% acid

Date April 10 **01/26/2024**, 1974

APPROVED Halbert & Prugh, Owner

By W. V. Jursell, agt.
(Title)

B-2

STATE OF WEST VIRGINIA
DEPARTMENT OF MINES
OIL AND GAS WELLS DIVISION

RECEIVED

JUL 24 1973

OIL & GAS DIVISION
DEPT. OF MINES

INSPECTOR'S WELL REPORT

Permit No. WDR-636

Oil or Gas Well _____
(KIND)

Company <u>HALBERT & PROUGH</u> <u>317 BANK OF COMMERCE</u> Address <u>ABILENE, TEXAS</u> Farm <u>JEWEL BOYCE</u> Well No. <u>E</u> District <u>BURNING SPRINGS</u> County <u>WEST</u> Drilling commenced <u>7-20-73</u> Drilling completed _____ Total depth _____ Date shot _____ Depth of shot _____ Initial open flow _____ /10ths Water in _____ Inch Open flow after tubing _____ /10ths Merc. in _____ Inch Volume _____ Cu. Ft. Rock pressure _____ lbs. _____ hrs. Oil _____ bbls., 1st 24 hrs. Fresh water <u>2</u> ^{DRILL COLLAR} feet Salt water <u>2</u> ^{DRILL COLLAR} feet	CASING AND TUBING	USED IN DRILLING	LEFT IN WELL	PACKERS
	Size			Kind of Packer
	16			
	13			
	10			Size of
	8 1/4 <u>CEM</u>	<u>190</u>		
	6 5/8			Depth set
	5 3/16			
	3			Perf. top
	2			Perf. bottom
	Liners Used			Perf. top
				Perf. bottom
<p style="text-align: center;"><u>90 PER</u> CASING CEMENTED <u>8 3/4</u> SIZE <u>190</u> No. FT. <u>78 1/2</u> Date _____ NAME OF SERVICE COMPANY <u>NEW</u> COAL WAS ENCOUNTERED AT <u>2200</u> FEET _____ INCHES _____ FEET _____ INCHES _____ FEET _____ INCHES _____ FEET _____ INCHES _____ FEET _____ INCHES</p>				

Drillers' Names FRED PAULS - H.L. BRASS - C. W. PRICE

F. W. P. - 1700

Remarks: DRG. AT 1060'

7-23-73
DATE

H. A. [Signature]
DISTRICT WELL INSPECTOR

01/26/2024

STATE OF WEST VIRGINIA
 DEPARTMENT OF MINES
 OIL AND GAS WELLS DIVISION
INSPECTOR'S PLUGGING REPORT

Permit No. _____ Well No. _____

COMPANY _____ ADDRESS _____

FARM _____ DISTRICT _____ COUNTY _____

Filling Material Used _____

Liner	Location	Amount	Packer	Location	
PLUGS USED AND DEPTH PLACED			BRIDGES	CASING AND TUBING	
CEMENT-THICKNESS	WOOD-SIZE	LEAD	CONSTRUCTION-LOCATION	RECOVERED	SIZE LOST

Drillers' Names _____

Remarks: _____

_____ I hereby certify I visited the above well on this date.

DATE

DISTRICT WELL INSPECTOR
 01/26/2024

B-3

STATE OF WEST VIRGINIA
DEPARTMENT OF MINES
OIL AND GAS WELLS DIVISION

RECEIVED

AUG 1 1973

INSPECTOR'S WELL REPORT

Permit No. WIR-636

OIL & GAS DIVISION
DEPT. OF MINES
Oil or Gas Well
(KIND)

Company	CASING AND TUBING	USED IN DRILLING	LEFT IN WELL	PACKERS
<u>HALBERT + PAUGH</u>	Size			
<u>ABALINE, TEXAS</u>	16			Kind of Packer
<u>JEWEL BOYCE</u>	13			
<u>I</u>	10			Size of
<u>BURNING SPR. County WIRT</u>	8 1/4 <u>CEM</u>	<u>2 1/8</u>	<u>2 1/8</u>	
<u>7-20-73</u>	6 5/8			Depth set
<u>7-26-73 Total depth 2075'</u>	5 3/16			
	8 1/2		<u>2058'</u>	Perf. top
	2			Perf. bottom
	Liners Used			Perf. top
				Perf. bottom
	<u>80 SWS - 8 7/8" - 2 1/8" - 7-21-73</u>			
	<u>90 SWS - 4 1/2" SIZE 2058 No. FT. 2050 Date</u>			
	NAME OF SERVICE COMPANY <u>H.C.W.CO.</u>			
	COAL WAS ENCOUNTERED AT <u>NONE</u> FEET _____ INCHES			
	_____ FEET _____ INCHES _____ FEET _____ INCHES			
	_____ FEET _____ INCHES _____ FEET _____ INCHES			

Drillers' Names FRED DAVIS - P.L. BOSS - C.W. PRICE

Remarks: F.W.A. - MUD
WELL COMP. TO F.P.A.C. 7-25-73

7-30-73
DATE

H.C. Holliday
DISTRICT INSPECTOR
01/26/2024

STATE OF WEST VIRGINIA
 DEPARTMENT OF MINES
 OIL AND GAS WELLS DIVISION
INSPECTOR'S PLUGGING REPORT

Permit No. _____ Well No. _____

COMPANY _____ ADDRESS _____

FARM _____ DISTRICT _____ COUNTY _____

Filling Material Used _____

Liner		Location	Amount	Packer	Location		
PLUGS USED AND DEPTH PLACED			BRIDGES		CASING AND TUBING		
CEMENT-THICKNESS	WOOD-SIZE	LEAD	CONSTRUCTION-LOCATION		RECOVERED	SIZE	LOST

Drillers' Names _____

Remarks: _____

_____ I hereby certify I visited the above well on this date.

DATE

DISTRICT WELL INSPECTOR

01/26/2024

B-4

STATE OF WEST VIRGINIA
DEPARTMENT OF MINES
OIL AND GAS WELLS DIVISION

RECEIVED
SEP 7 1973

INSPECTOR'S WELL REPORT

OIL & GAS DIVISION
DEPT. OF MINES

Permit No. WIA-636

Oil or Gas Well G
(KIND)

Company <u>HALBERT & PROUGH</u>	CASING AND TUBING	USED IN DRILLING	LEFT IN WELL	PACKERS
	Address <u>ADILENE, TEXAS</u>	Size		
Farm <u>JEWEL BOYCE</u>	16			
Well No. <u>I</u>	13			Size of
District <u>BURN. SPRINGS</u> County <u>WERT.</u>	10			
Drilling commenced <u>7-20-73</u>	8 1/4 <u>CEM</u>	<u>218'</u>	<u>218'</u>	Depth set
Drilling completed <u>7-25-73</u> Total depth <u>2075'</u>	6 5/8			
<u>NOVELL - THROUGH 4 1/2" PIPE</u>	5 3/16			Perf. top
Date shot <u>8-31-73</u> Depth of shot <u>2075'</u>	3 <u>4 1/2</u>		<u>2058</u>	Perf. bottom
Initial open flow _____ /10ths Water in _____ Inch	2			Perf. top
Open flow after tubing _____ /10ths Merc. in _____ Inch	Liners Used			Perf. bottom
Volume _____ Cu. Ft.	1005. - 7 5/8 - 218 - 7-21-73 2009 4 1/2 SIZE 2058 No. FT. 7-25-73 Date			
Rock pressure _____ lbs. _____ hrs.	NAME OF SERVICE COMPANY <u>H. C. W. CO.</u>			
Oil _____ bbls., 1st 24 hrs.	COAL WAS ENCOUNTERED AT <u>1600'</u> FEET _____ INCHES			
Fresh water <u>? H2O</u> _____ feet _____ feet	_____ FEET _____ INCHES _____ FEET _____ INCHES			
Salt water <u>? H2O</u> _____ feet _____ feet	_____ FEET _____ INCHES _____ FEET _____ INCHES			

Drillers' Names F. DAVIS - P. L. BOGGS - C. W. PRICE

Remarks: F. W. A. POT - H2O
WELL PAUC - 8-31-73

9-6-73
DATE

R. C. Holliday
DISTRICT WELL INSPECTOR
01/26/2024

B-5

RECEIVED

NOV 12 1975

STATE OF WEST VIRGINIA
DEPARTMENT OF MINES
OIL AND GAS WELLS DIVISION

OIL & GAS DIVISION
DEPT. OF MINES

INSPECTOR'S PLUGGING REPORT

Permit No. W.V. 636-P Well No. 1
COMPANY Interstate Drilling Inc. ADDRESS 1527 Skyline Road
Charleston, W.Va 25314
FARM Jewel Boyce DISTRICT Burning Springs COUNTY Wirt

Filling Material Used _____

Liner	Location	Amount	Packer	Location
PLUGS USED AND DEPTH PLACED			BRIDGES	
CEMENT-THICKNESS	WOOD-SIZE	LEAD	CONSTRUCTION-LOCATION	CASING AND TUBING
				RECOVERED SIZE LOST
2000 - 1900	Cem			1400 4 1/2 665
1900 - 1400	Gel			— 8 5/8 212
1400 - 1350	Cem			
1350 - 222	Gel			
222 - 188	Cem			
188 - 20	Gel			
20 - 0	Cem			

Drillers' Names Danny Moore
Contc M & H Service Co - W. H. Hildreth

Remarks:

Ready Cem Co was used in plugging operation
Job Comm - 11-5-75
Job Comp - 11-6-75

11-6-75 I hereby certify I visited the above well on this date.
DATE

[Signature]
DISTRICT WELL INSPECTOR

01/26/2024

STATE OF WEST VIRGINIA
DEPARTMENT OF MINES
OIL AND GAS WELLS DIVISION

INSPECTOR'S WELL REPORT

Permit No. _____

Oil or Gas Well _____
(KIND)

	CASING AND TUBING	USED IN DRILLING	LEFT IN WELL	PACKERS
Company _____				
Address _____	Size			
Farm _____	16			Kind of Packer _____
Well No. _____	13			
District _____ County _____	10			Size of _____
Drilling commenced _____	8 1/4			
Drilling completed _____ Total depth _____	6 5/8			Depth set _____
Date shot _____ Depth of shot _____	5 3/16			
Initial open flow _____ /10ths Water in _____ Inch	3			Perf. top _____
Open flow after tubing _____ /10ths Merc. in _____ Inch	2			Perf. bottom _____
Volume _____ Cu. Ft.	Liners Used			Perf. top _____
Rock pressure _____ lbs. _____ hrs.				Perf. bottom _____
Oil _____ bbls., 1st 24 hrs.	CASING CEMENTED _____ SIZE _____ No. FT. _____ Date _____			
Fresh water _____ feet _____ feet	NAME OF SERVICE COMPANY _____			
Salt water _____ feet _____ feet	COAL WAS ENCOUNTERED AT _____ FEET _____ INCHES			
	_____ FEET _____ INCHES	_____ FEET _____ INCHES	_____ FEET _____ INCHES	_____ FEET _____ INCHES
	_____ FEET _____ INCHES	_____ FEET _____ INCHES	_____ FEET _____ INCHES	_____ FEET _____ INCHES

Drillers' Names _____

Remarks:

B-6



State of West Virginia
Department of Mines
Oil and Gas Division
Charleston 25305

WALTER N. MILLER
DIRECTOR

THEODORE M. STREIT
ADMINISTRATOR

December 15, 1982

Interstate Drilling, Inc.
Route 2, Box 213
Weston, W. Va. 26452

IN RE: PERMIT NO. 47-105-636-P
FARM Jewel Boyce
WELL NO. 1
DISTRICT Burning Springs
COUNTY Wirt

Gentlemen:

The final inspection report for the above described well has been received in this office. Only the column checked below applies.

XXXXXX The well designated by the above permit number has been released under your blanket Bond.

 Please return the enclosed cancelled single bond which covered the well designated by the above permit number to the surety company who executed said bond on your behalf, in order that they may give you credit on your records.

 Your well record was received and reclamation requirements approved. In accordance with Chapter 22, Article 4, Section 2, the above captioned well will remain under bond coverage for life of the well.

Very truly yours,

Theodore M. Streit

S:rl

well connected to gas line.

01/26/2024

10. 22. 82

DATE

Plug

Joe Mace

DISTRICT WELL INSPECTOR



State of West Virginia

Department of Mines
Oil and Gas Division

Charleston 25305

November 4, 1975

Brumbaugh, Atty.
t
25276

ugh

In Re: Permit No. WIRT-636
Farm Jewel Boyce
Well No. 1
District Burging Springs
County Wirt

men:

The final inspection report for the well which is described above
en received in this office. Only the column checked below applies.

The bond covering the well designated by the above permit number
en released under your Blanket Bond.

Please return the enclosed cancelled bond which covered the well
ated by the above permit number to the Surety Company who executed
ond in your behalf, in order that they may give you credit on their
P. (Well sold to: Interstate Drilling, Inc.)

Very truly yours,

Deputy Director
Oil and Gas Division

D/ch

ure: Single Bond # 621057 dated 7-13-73 (Royal Indemnity Company)

SENDER: Complete items 1, 2, and 3. "RETURN TO" space on reverse. Add your address in the "RETURN TO" space on reverse.	
1. The following service is requested (check one). <input checked="" type="checkbox"/> Show to whom and date delivered..... 15¢ <input type="checkbox"/> Show to whom, date, & address of delivery.. 35¢ <input type="checkbox"/> RESTRICTED DELIVERY. <input type="checkbox"/> Show to whom and date delivered..... 65¢ <input type="checkbox"/> RESTRICTED DELIVERY. <input type="checkbox"/> Show to whom, date, and address of delivery 85¢	
2. ARTICLE ADDRESSED TO: Richard H. Brumbaugh 212 Court Street Spencer, W.Va. 25276	
3. ARTICLE DESCRIPTION: REGISTERED NO. <u>81879</u> INSURED NO. _____ (Always obtain signature of addressee or agent) I have received the article described above. SIGNATURE <input type="checkbox"/> Addressee <input type="checkbox"/> Authorized agent <u>Carol Board</u>	
4. DATE OF DELIVERY <u>11-5-75</u>	POSTMARK NOV 5 1975 SPENCER, WV INITIALS USPO
5. ADDRESS (Complete only if requested)	
6. UNABLE TO DELIVER BECAUSE:	

☆ GPO : 1975-O-568-047

01/26/202

Department of Mines - Oil & Gas Division
1204 Kanawha Blvd. E.
Charleston, W.Va. 25301

01/26/2024



RECEIVED

NOV 4 - 1975

STATE OF WEST VIRGINIA
DEPARTMENT OF MINES
OIL AND GAS WELLS DIVISION

OIL & GAS DIVISION
DEPT. OF MINES

NOTICE OF INTENTION TO PLUG AND ABANDON WELL

(REQUIRED BY SECTION 9, ARTICLE 4, CHAPTER 22 OF THE CODE)

To THE DEPARTMENT OF MINES,
Charleston, W. Va.

No Coal
Coal Operator

Interstate Drilling Inc
Name of Well Operator

Address

1527 SKYLINE ROAD
CHARLESTON, WVA 25314
Complete Address

Coal Owner

11/4/75
Date

WELL TO BE ABANDONED

Address

BURNING SPRINGS District

Lease or Property Owner

Wirt County

Address

Well No. WIR-636 /

Jewel Boyce Farm

Inspector: K PAUL Goodnight Telephone 477-2455

TO BE NOTIFIED 24 HOURS IN ADVANCE OF PLUGGING OPERATIONS

Gentlemen:—

The undersigned well operator is about to abandon the above described well and will commence

the work of plugging and abandoning said well on the date inspector is notified (which date shall not be less than five days after the day on which this notice so mailed is received, or in due course should be received by the Department of Mines).

This notice is given you in order that your respective representatives may be present at the plugging and filling of said well. You are further notified that whether you are represented or not represented the undersigned will proceed on that date, or shortly thereafter, to plug and fill said well in the manner required by Section 10, Article 4, Chapter 22 of the Code and given in detail on the reverse side of this notice, in "Work Order."

This notice is being mailed by registered mail to each of you at the above addresses on the above date.

Very truly yours,

H. U. Jarrell
Well Operator

NOTE: Upon the abandonment of any well drilled prior to June 1, 1929, a plat prepared by a registered engineer, shall be filed with THREE COPIES OF APPLICATION, (OG-9) AND "WORK ORDER" AND TWO COPIES OF THE WELL RECORD, (OG-10). The map must show the district and county in which the tract of land is located, the name and acreage of same, the name or names of the owners and names of adjacent tracts and the location of the well to be abandoned, determined by survey with the courses and distances of such well from two permanent points or landmarks on said tract, in compliance with Rule 5 of the Rules of Practice and Procedure. 01/26/2024

NOTE: In case plugging is not commenced within four months from the date of permit, same shall expire and be of no further force or effect.

NOTE: PERMIT IS NON TRANSFERABLE.

BLANKET BOND

WIRT-636-P

AFFIDAVIT, FORM OG-8, MANNER WELL PLUGGED MUST BE SUBMITTED TO OBTAIN RELEASE OF WELL UNDER BOND.

47-105

Permit Number

B-9

PROPOSED MANNER OF PLUGGING AND FILLING WELL

(REQUIRED BY RULES AND REGULATIONS)

WEST VIRGINIA DEPARTMENT OF MINES

OIL AND GAS DIVISION

WORK ORDER

Well to be plugged and filled as follows:

T.D. to 2000' Gel
 2000' to 1980' Cement
 1980' to where pipe is Ripped - Gel
 50' Plug where pipe is Ripped
 Gel to 222'
 222' to 188' Cement
 198' to 20' Gel
 20' to Surface Cement
 Erect monument

To the Department of Mines
 Coal Owner or Operator,
 Lease or Property Owner.

IF PARTIAL PLUGGING
 PLEASE SUBMIT REVISED WELL RECORD
 WHEN WORK IS COMPLETED.

Gentlemen:

This "work order" is submitted for your approval and concurrence and unless notified of your disapproval or non-concurrence, the undersigned will proceed with the plugging and filling of said well in the above described manner on the date inspector is notified after permit is issued.

Very truly yours,

 Well Operator

No objections have been filed by the coal owner or coal operator, or any available adjacent lease or property owners or interposed by the Department of Mines to the manner herein described for the plugging and filling of the well above mentioned. Therefore, the same is hereby approved this

4th. day of November, 19-75.

DEPARTMENT OF MINES
 Oil and Gas Division

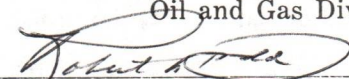
By: 
 01/26/2024

NOTE: This "work order" shall be filed in triplicate, one copy for the files of the Department of Mines; one to be approved or corrected and returned to the well operator as his authority for plugging said well; and one for the well inspector.

9-680-1017
 201-111

9800 130000

RECEIVED APR 1 1933

STATE OF NEW YORK
DEPARTMENT OF MINES
BUREAU OF GEOLOGY

REPORT OF THE GEOLOGICAL SURVEY

THE GEOLOGICAL SURVEY OF THE STATE OF NEW YORK HAS THE HONOR TO ACKNOWLEDGE THE RECEIPT OF THE FOLLOWING REPORTS:

REPORT OF THE GEOLOGICAL SURVEY OF THE STATE OF NEW YORK FOR THE YEAR 1932

REPORT OF THE GEOLOGICAL SURVEY OF THE STATE OF NEW YORK FOR THE YEAR 1931

REPORT OF THE GEOLOGICAL SURVEY OF THE STATE OF NEW YORK FOR THE YEAR 1930

REPORT OF THE GEOLOGICAL SURVEY OF THE STATE OF NEW YORK FOR THE YEAR 1929

REPORT OF THE GEOLOGICAL SURVEY OF THE STATE OF NEW YORK FOR THE YEAR 1928

REPORT OF THE GEOLOGICAL SURVEY OF THE STATE OF NEW YORK FOR THE YEAR 1927

REPORT OF THE GEOLOGICAL SURVEY OF THE STATE OF NEW YORK FOR THE YEAR 1926

REPORT OF THE GEOLOGICAL SURVEY OF THE STATE OF NEW YORK FOR THE YEAR 1925

REPORT OF THE GEOLOGICAL SURVEY OF THE STATE OF NEW YORK FOR THE YEAR 1924

REPORT OF THE GEOLOGICAL SURVEY OF THE STATE OF NEW YORK FOR THE YEAR 1923

REPORT OF THE GEOLOGICAL SURVEY OF THE STATE OF NEW YORK FOR THE YEAR 1922

REPORT OF THE GEOLOGICAL SURVEY OF THE STATE OF NEW YORK FOR THE YEAR 1921

REPORT OF THE GEOLOGICAL SURVEY OF THE STATE OF NEW YORK FOR THE YEAR 1920

REPORT OF THE GEOLOGICAL SURVEY OF THE STATE OF NEW YORK FOR THE YEAR 1919

REPORT OF THE GEOLOGICAL SURVEY OF THE STATE OF NEW YORK FOR THE YEAR 1918

REPORT OF THE GEOLOGICAL SURVEY OF THE STATE OF NEW YORK FOR THE YEAR 1917

REPORT OF THE GEOLOGICAL SURVEY OF THE STATE OF NEW YORK FOR THE YEAR 1916

REPORT OF THE GEOLOGICAL SURVEY OF THE STATE OF NEW YORK FOR THE YEAR 1915

REPORT OF THE GEOLOGICAL SURVEY OF THE STATE OF NEW YORK FOR THE YEAR 1914

REPORT OF THE GEOLOGICAL SURVEY OF THE STATE OF NEW YORK FOR THE YEAR 1913

REPORT OF THE GEOLOGICAL SURVEY OF THE STATE OF NEW YORK FOR THE YEAR 1912

REPORT OF THE GEOLOGICAL SURVEY OF THE STATE OF NEW YORK FOR THE YEAR 1911

REPORT OF THE GEOLOGICAL SURVEY OF THE STATE OF NEW YORK FOR THE YEAR 1910

REPORT OF THE GEOLOGICAL SURVEY OF THE STATE OF NEW YORK FOR THE YEAR 1909

REPORT OF THE GEOLOGICAL SURVEY OF THE STATE OF NEW YORK FOR THE YEAR 1908

REPORT OF THE GEOLOGICAL SURVEY OF THE STATE OF NEW YORK FOR THE YEAR 1907

REPORT OF THE GEOLOGICAL SURVEY OF THE STATE OF NEW YORK FOR THE YEAR 1906

REPORT OF THE GEOLOGICAL SURVEY OF THE STATE OF NEW YORK FOR THE YEAR 1905

01/26/2024

7/16/73 CEN

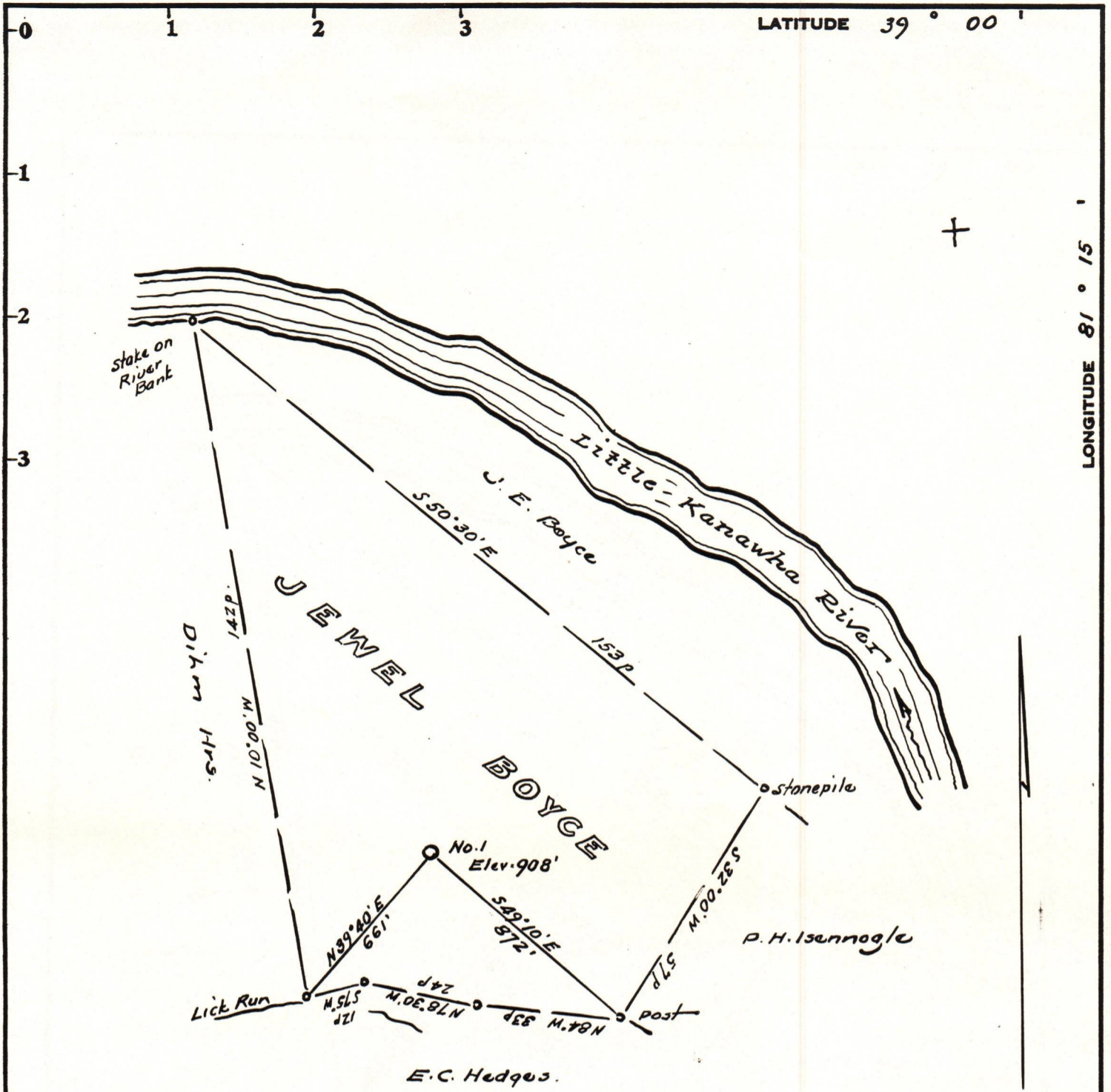

Minimum Error of Closure 1 in 200'
 Source of Elevation U.S.G.S. B.M. at Craston = 648'

I, the undersigned, hereby certify that this map is correct to the best of my knowledge and belief and shows all the information required by paragraph 6 of the rules and regulations of the oil and gas section of the mining laws of West Virginia.

Fracture.....
 New Location.....
 Drill Deeper.....
 Abandonment..... 11/4/75

Signed: [Signature]
 Squares: N S E W

Company INTERSTATE DRILLING, INC.
 Address 1527 Skyline Rd. Charleston W.V. 25314
 Farm Jewel Boyce
 Tract _____ Acres 62 Lease No. _____
 Well (Farm) No. One Serial No. _____
 Elevation (Spirit Level) 908
 Quadrangle Spencer
 County Wirt District Burning Springs
 Engineer [Signature]
 Engineer's Registration No. 1227
 File No. _____ Drawing No. _____
 Date July 6, 1973 Scale 1" = 30P = 495'

STATE OF WEST VIRGINIA
 DEPARTMENT OF MINES
 OIL AND GAS DIVISION
 CHARLESTON

WELL LOCATION MAP
 FILE NO. WIRT-636-P

+ Denotes location of well on United States Topographic Maps, scale 1 to 62,500, latitude and longitude lines being represented by border lines as shown.

- Denotes one inch spaces on border line of original tracing. 47 105

TRASCO 17 5153 1-73 54291•

Date July 6, 1973 Scale 1" = 30P = 495'

- Denotes one inch spaces on border line of original tracing. 47 105

TRASCO 17 5153 1-73 54291•



01/26/2024



STATE OF WEST VIRGINIA
DEPARTMENT OF MINES

RECEIVED

JUL 16 1973-CEN

OIL & GAS DIVISION
DEPT. OF MINES

Oil and Gas Division

OIL AND GAS WELL PERMIT APPLICATION

TO THE DEPARTMENT OF MINES,
Charleston, W. Va.

DATE July 13, 1973

Surface Owner W.Va. Paper Company

Company Halbert and Prough

Address Summersville, West Virginia

Address 317 Bank of Commerce, Abalene, Tex

Mineral Owner Jewel Boyce

Farm Jewel Boyce Acres 62

Address Akron, Ohio

Location (waters) Little Kanawha River

Coal Owner _____

Well No. One Elevation 908

Address _____

District Burning Springs County Wirt

Coal Operator _____

Quadrangle Spencer

Address _____

THIS PERMIT MUST BE POSTED AT THE WELL SITE
All provisions being in accordance with Chapter 22,
of the W. Va Code, the location is hereby approved
for drilling. This permit shall expire if
operations have not commenced by 11-16-73.

Deputy Director - Oil & Gas Division

INSPECTOR TO BE NOTIFIED Harry Holliday
Grantsville, W.Va. PH: 354-6731

GENTLEMEN:

The undersigned well operator is entitled to drill upon the above named farm or tract of land for oil and gas, having fee title thereto, (or as the case may be) under grant or lease dated June 11, 1973, by Jewel Boyce made to Halbert & Prough and recorded on the _____ day of _____ 19____, in Wirt County, Book _____ Page _____

NEW WELL _____ DRILL DEEPER _____ REDRILL _____ FRACTURE OR STIMULATE
_____ OIL AND GAS WELL ORIGINALLY DRILLED BEFORE JUNE 5, 1969.

The enclosed plat was prepared by a registered engineer or licensed land surveyor and all coal owners and/or operators have been notified as of the above date.

The above named coal owners and/or operator are hereby notified that any objection they wish to make, or are required to make by Section 3 of the Code, must be received by, or filed with the Department of Mines within ten (10) days. *

Copies of this notice and the enclosed plat were mailed by registered mail, or delivered to the above named coal operators or coal owners at their above shown respective address _____ day _____ before, or on the same day with the mailing or delivery of this copy to the Department of Mines at Charleston, West Virginia.

Very truly yours,

(Sign Name) A.T. Halbert
Well Operator

Address
of
Well Operator

317 Bank of Commerce
Street
Abalene
City or Town
Texas
State

01/26/2024

*SECTION 3 If no objections are filed or found by the Department of mines, within said period of ten days from the receipt of notice and plat by the department of mines, to said proposed location, the department shall forthwith issue to the well operator a permit reciting the filing of such plat, that no objections have been made by the coal operators or found thereto by the department and that the same is approved and the well operator authorized to proceed.

BOND DRILL

WIRT-636

PERMIT NUMBER

47 105

THIS IS AN ESTIMATE ONLY
ACTUAL INFORMATION WILL BE SUBMITTED ON OG-10 UPON COMPLETION

PROPOSED WORK ORDER TO X DRILL _____ DEEPEN _____ FRACTURE-STIMULATE _____
 DRILLING CONTRACTOR: (If Known) _____ RESPONSIBLE AGENT: _____
 NAME F.W.A. Drilling Company NAME John Archer
 ADDRESS Elkview, West Virginia ADDRESS Elkview, West Virginia
 TELEPHONE 965-5201 TELEPHONE 965-5201
 ESTIMATED DEPTH OF COMPLETED WELL: 2500' ROTARY X CABLE TOOLS _____
 PROPOSED GEOLOGICAL FORMATION: Berea
 TYPE OF WELL: OIL _____ GAS _____ COMB. X STORAGE _____ DISPOSAL _____
 RECYCLING _____ WATER FLOOD _____ OTHER _____

TENTATIVE CASING PROGRAM:

CASING AND TUBING SIZE	USED FOR DRILLING	LEFT IN WELL	CEMENT FILL UP OR SACKS - CUBIC FT.
20 - 16			
13 - 10			
9 - 5/8			
8 - 5/8 200'	8 5/8"	200'	100 sacks cement
7			
5 1/2			
4 1/2 2500'	4 1/2"	2500'	100 sacks cement
3			Perf. Top
2			Perf. Bottom
Liners			Perf. Top
			Perf. Bottom

APPROXIMATE FRESH WATER DEPTHS 150' FEET _____ SALT WATER _____ FEET _____
 APPROXIMATE COAL DEPTHS _____
 IS COAL BEING MINED IN THE AREA? _____ BY WHOM? _____

TO DRILL:

SUBMIT FIVE (5) COPIES OF OG - 1, \$100.00 PERMIT FEE, PERFORMANCE BOND AND PERMANENT COPY OF PLAT.

TO DRILL DEEPER OR REDRILL:

SUBMIT FIVE (5) COPIES OF OG - 1, SHOWING ORIGINAL PERMIT NUMBER AND PERFORMANCE BOND. ON WELLS DRILLED PRIOR TO 1929, A PERMANENT COPY OF THE PLAT AND THE ORIGINAL WELL RECORD MUST ALSO BE SUBMITTED.

TO FRACTURE - STIMULATE:

OIL AND/OR GAS WELL ORIGINALLY DRILLED BEFORE JUNE 5, 1929, FIVE (5) COPIES OG - 1, PERFORMANCE BOND, PERMANENT PLAT AND ORIGINAL WELL RECORD.

OIL AND/OR GAS WELL ORIGINALLY DRILLED ON AND/OR AFTER JUNE 5, 1929, FIVE COPIES OG - 1, SHOWING ORIGINAL PERMIT NUMBER, AND PERFORMANCE BOND.

Required forms must be filed within ninety (90) days of completion for bond release. Inspector to be notified twenty-four (24) hours in advance.

The following waiver must be completed by the coal operator if the permit is to be issued within ten days of receipt thereof.

WAIVER: I the undersigned, Agent for _____ Coal Company, Owner or Operator of the coal under this lease have examined and place on our mine maps this proposed well location.

We the _____ Coal Company have no objections to said well being drilled at this location, providing operator has complied with all rules and regulations in Articles 4, 5, and 7, Chapter 22 of the West Virginia Code.

 For Coal Company

 Official Title

01/26/2024

STATE OF WEST VIRGINIA
DEPARTMENT OF MINES
OIL AND GAS WELLS DIVISION

INSPECTOR'S WELL REPORT

Permit No. 105-636-P

RECEIVED
OCT 27 1982
OIL AND GAS DIVISION
DEPARTMENT OF MINES

Company <u>INTERSTATE DRILLING INC</u>	CASING AND TUBING	USED IN DRILLING	LEFT IN WELL	PACKERS
Address _____	Size			
Farm <u>JEWEL BOYCE</u>	16			Kind of Packer _____
Well No. <u>1</u>	13			
District <u>BURNING SPRING</u> County <u>WIAT</u>	10			Size of _____
Drilling commenced _____	8 1/4			
Drilling completed _____ Total depth _____	6 5/8			Depth set _____
Date shot _____ Depth of shot _____	5 3/16			
Initial open flow _____ /10ths Water in _____ Inch	3			Perf. top _____
Open flow after tubing _____ /10ths Merc. in _____ Inch	2			Perf. bottom _____
Volume _____ Cu. Ft.	Liners Used _____			Perf. top _____
Block pressure _____ lbs. _____ hrs.				Perf. bottom _____
Oil _____ bbls., 1st 24 hrs.	CASING CEMENTED _____ SIZE _____ No. FT. _____ Date _____			
Fresh water _____ feet _____ feet	NAME OF SERVICE COMPANY _____			
Salt water _____ feet _____ feet	COAL WAS ENCOUNTERED AT _____ FEET _____ INCHES			
	_____ FEET _____ INCHES _____ FEET _____ INCHES			
	_____ FEET _____ INCHES _____ FEET _____ INCHES			

Drillers' Names _____

Remarks: O.K. To Release
well connected to gas line.

Plug

10.22.82
DATE

J. M. Mac
DISTRICT WELL INSPECTOR

LEW-1886	Russell Woofter #2	Lewis	Freemans Creek
LEW-1887	Russell Woofter # H&P1	Lewis	Freemans Creek
LEW-1888	Russell Woofter #1B	Lewis	Freemans Creek
LEW-1890	Dale W. Groves #1	Lewis	Freemans Creek
LEW-1956	Dale W. Groves #2	Lewis	Freemans Creek
LEW-1962	Russell Woofter #3	Lewis	Freemans Creek
WIR-604	E. J. Campbell No. 1	Wirt	Spring Creek
WIR-621	E. J. Campbell No. 2	Wirt	Spring Creek
WIR-630	Warren Campbell No. 1	Wirt	Spring Creek
<u>WIR-636</u>	Jewel Boyce No. 1	Wirt	Burnings Springs
WIR-638	Campbell-DePue 1A	Wirt	Burnings Springs
WIR-639	Gordon Cooper No. 3	Wirt	Spring Creek

01/26/2024

Very truly yours
UNITED STATES FIDELITY & GUARANTY COMPANY
E. D. Ziegler
E. D. Ziegler
Attorney-in-Fact

STATE OF WEST VIRGINIA
DEPARTMENT OF MINES
OIL AND GAS WELLS DIVISION
INSPECTOR'S PLUGGING REPORT

Permit No. _____

Well No. _____

COMPANY _____ ADDRESS _____

FARM _____ DISTRICT _____ COUNTY _____

Filling Material Used _____

Liner Location Amount Packer Location

PLUGS USED AND DEPTH PLACED	BRIDGES	CASING AND TUBING
-----------------------------	---------	-------------------

75

75

75

01/26/2024

7/16/73 CEN

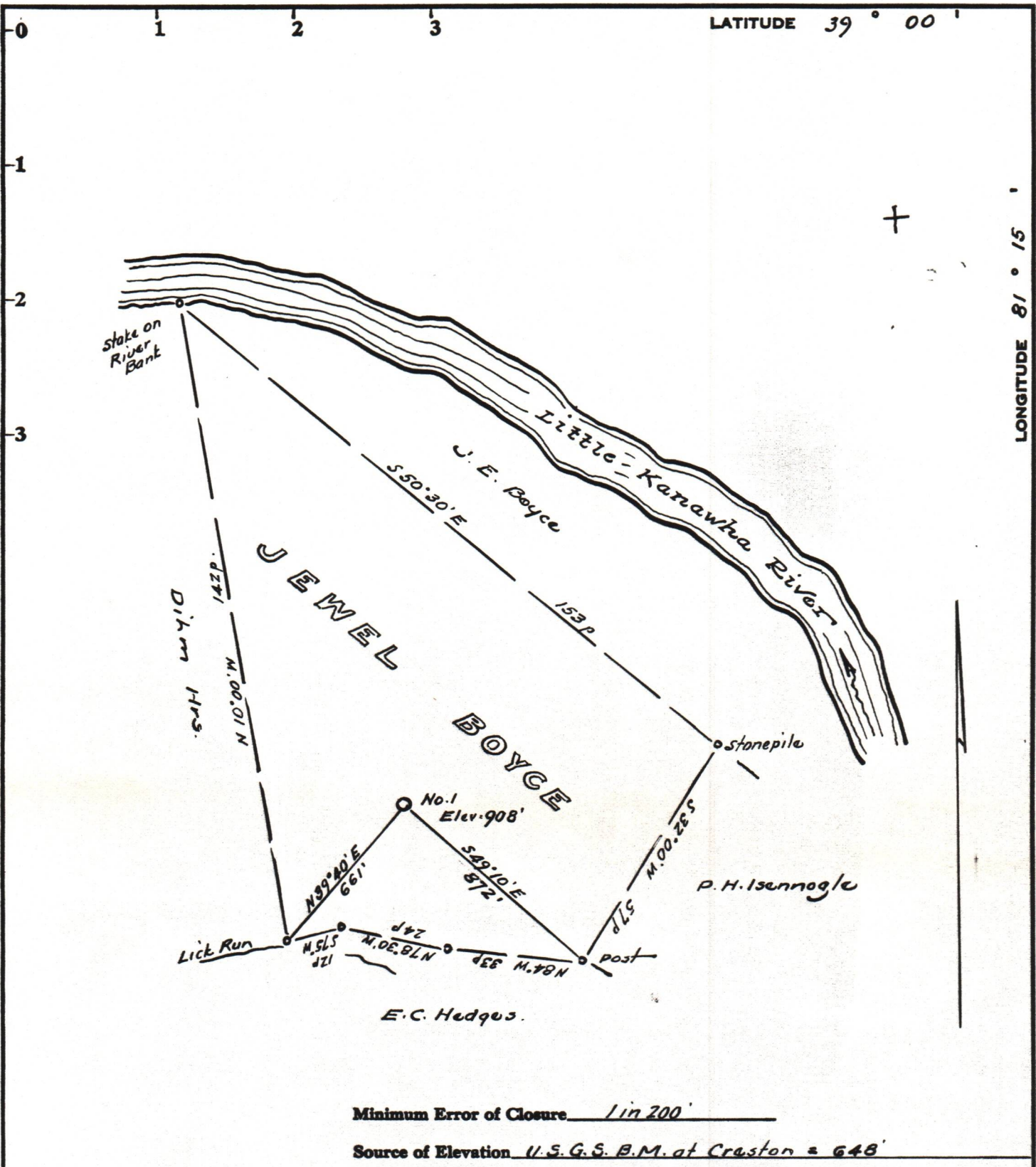

Minimum Error of Closure 1 in 200'
 Source of Elevation U.S.G.S. B.M. at Craston = 648'

Fracture.....
 New Location.....
 Drill Deeper.....
 Abandonment..... 11/4/75

I, the undersigned, hereby certify that this map is correct to the best of my knowledge and belief and shows all the information required by paragraph 6 of the rules and regulations of the oil and gas section of the mining laws of West Virginia.

Signed: [Signature]
 Squares: N S E W

Company INTERSTATE DRILLING, INC.
 Address 1527 Skyline Rd. Charleston W.V. 25314
 Farm Jewel Boyce
 Tract _____ Acres 62 Lease No. _____
 Well (Farm) No. One Serial No. _____
 Elevation (Spirit Level) 908
 Quadrangle Spencer
 County Wirt District Burning Springs
 Engineer [Signature]
 Engineer's Registration No. 1227
 File No. _____ Drawing No. _____
 Date July 6, 1973 Scale 1" = 30 P = 495'

STATE OF WEST VIRGINIA
 DEPARTMENT OF MINES
 OIL AND GAS DIVISION
 CHARLESTON

WELL LOCATION MAP
 FILE NO. WIRT-636-P
01/26/2024

+ Denotes location of well on United States Topographic Maps, scale 1 to 62,500, latitude and longitude lines being represented by border lines as shown.
 - Denotes one inch spaces on border line of original tracing. 47 105

A 12

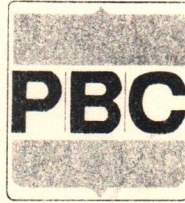

RECEIVED

OCT 28 1975

OIL & GAS DIVISION
DEPT. OF MINES

PATTERSON, BELL & CRANE COMPANY

October 23, 1975

Mr. Robert L. Dodd, Director
Oil & Gas Division, Department of Mines
1204 Kanawha Boulevard, East
Charleston, West Virginia

RE: INTERSTATE DRILLING, INC.

Dear Mr. Dodd:

Permission is granted to add to Interstate Drilling, Inc., blanket bond the following wells which were originally under the name of Halbert & Prough.

PERMIT NO.	WELL NAME	COUNTY	DISTRICT
CAL-2509	Mary Davis	Cathoun	Sheridan
GIL-2263	W. H. Simmons #2	Gilmer	Troy
GIL-2264	W. H. Simmons #3	Gilmer	Troy
GIL-2265	Gut Simmons	Gilmer	Troy
GIL-2272	W. H. Simmons #4	Gilmer	Troy
GIL-2274	Bennett Heirs #1	Gilmer	Troy
GIL-2275	Bennett Heirs #2	Gilmer	Troy
GIL-2277	Dora Heckert #1	Gilmer	Troy
GIL-2279	Simmons-West #1	Gilmer	Troy
GIL-2314	Newlon-Goff	Gilmer	Troy
LEW-1885	Russell Woofter #1	Lewis	Freemans Creek
LEW-1886	Russell Woofter #2	Lewis	Freemans Creek
LEW-1887	Russell Woofter # H&P1	Lewis	Freemans Creek
LEW-1888	Russell Woofter #1B	Lewis	Freemans Creek
LEW-1890	Dale W. Groves #1	Lewis	Freemans Creek
LEW-1956	Dale W. Groves #2	Lewis	Freemans Creek
LEW-1962	Russell Woofter #3	Lewis	Freemans Creek
WIR-604	E. J. Campbell No. 1	Wirt	Spring Creek
WIR-621	E. J. Campbell No. 2	Wirt	Spring Creek
WIR-630	Warren Campbell No. 1	Wirt	Spring Creek
WIR-636	Jewel Boyce No. 1	Wirt	Burnings Springs
WIR-638	Campbell-DePue 1A	Wirt	Burnings Springs
WIR-639	Gordon Cooper No. 3	Wirt	Spring Creek

Very truly yours
UNITED STATES FIDELITY & GUARANTY COMPANY

E. D. Ziegler
Attorney-in-Fact

01/26/2024

EDZ:rc