



STATE OF WEST VIRGINIA  
DEPARTMENT OF MINES  
OIL AND GAS DIVISION

*Jesse*

NOTICE OF PROPOSED LOCATION OF OIL AND GAS WELL

To THE DEPARTMENT OF MINES,  
Charleston, W. Va.

None  
COAL OPERATOR OR COAL OWNER

Ned W. Easley DBA Cooperative Oil Investments  
NAME OF WELL OPERATOR

ADDRESS

Box 295, Spencer, West Virginia 25276  
COMPLETE ADDRESS

None  
COAL OPERATOR OR COAL OWNER

October 25, 19 68  
PROPOSED LOCATION

ADDRESS

Burning Springs District

West Virginia Pulp and Paper Co.  
OWNER OF MINERAL RIGHTS

Wirt County

299 Park Avenue, New York, New York  
ADDRESS

Well No. Wesvaco #1  
West Virginia Pulp & Paper Co. Farm (Formerly Young)  
Elevation 722.8' Acres 50 (Part of 470)

GENTLEMEN:

The undersigned well operator is entitled to drill upon the above named farm or tract of land for oil and gas, having fee title thereto, (or as the case may be) under grant or lease dated June 4, 1968, made by West Virginia Pulp and Paper Co., to Ned W. Easley DBA Cooperative Oil Investments, and recorded on the 12th day of September, 1968, in the office of the County Clerk for said County in Book 132, page 874.

The enclosed plat was prepared by a competent engineer and shows the proposed location of a well to be drilled for oil and gas by the undersigned well operator on the farm and in the Magisterial District and County above named, determined by survey and courses and distances from two permanent points, or land marks.

The undersigned well operator is informed and believes there are no coal operators operating beds of coal beneath said farm or tract of land on which said well is located, or within 500 feet of the boundaries of the same, who have mapped their workings and filed their maps as required by law, excepting the coal operators or coal owners (if any) above named as addressees.

The above named coal operators or coal owners (if any) are notified that any objections they may desire to make to such proposed location, or which they are required to make by Section 3 of said Code, if the drilling of a well at said proposed location will cause a dangerous condition in or about their respective coal mines, must be received by, or filed with the Department of Mines within ten\* days from the receipt of a copy of this notice and accompanying plat by said Department. Said coal operators are further notified that forms for use in making such objections will be furnished to them by the Department of Mines promptly on request and that all such objections must set forth as definitely as is reasonably possible the ground or grounds on which such objections are based and indicate the direction and distance the proposed location should be moved to overcome same.

(The next paragraph is to be completed only in Department's copy.)

Copies of this notice and the enclosed plat were mailed by registered mail, or delivered to the above named coal operators or coal owners at their above shown respective address \_\_\_\_\_ day \_\_\_\_\_ before, or on the same day with the mailing or delivery of this copy to the Department of Mines at Charleston, West Virginia.

Very truly yours,

*Ned W. Easley*

Ned W. Easley DBA Cooperative Oil Investments  
WELL OPERATOR



Address of Well Operator }

Box 295  
STREET

Spencer, West Virginia 25276 **07/12/2024**  
CITY OR TOWN

West Virginia  
STATE

\*Section 3 . . . . If no such objections be filed or be found by the department of mines, within said period of ten days from the receipt of said notice and plat by the department of mines, to said proposed location, the department shall forthwith issue to the well operator a drilling permit reciting the filing of such plat, that no objections have been made by the coal operators to the location, or found thereto by the department, and that the same is approved and the well operator authorized to proceed to drill at said location.

565

WIR-565 PERMIT NUMBER

10/30/68 CEN

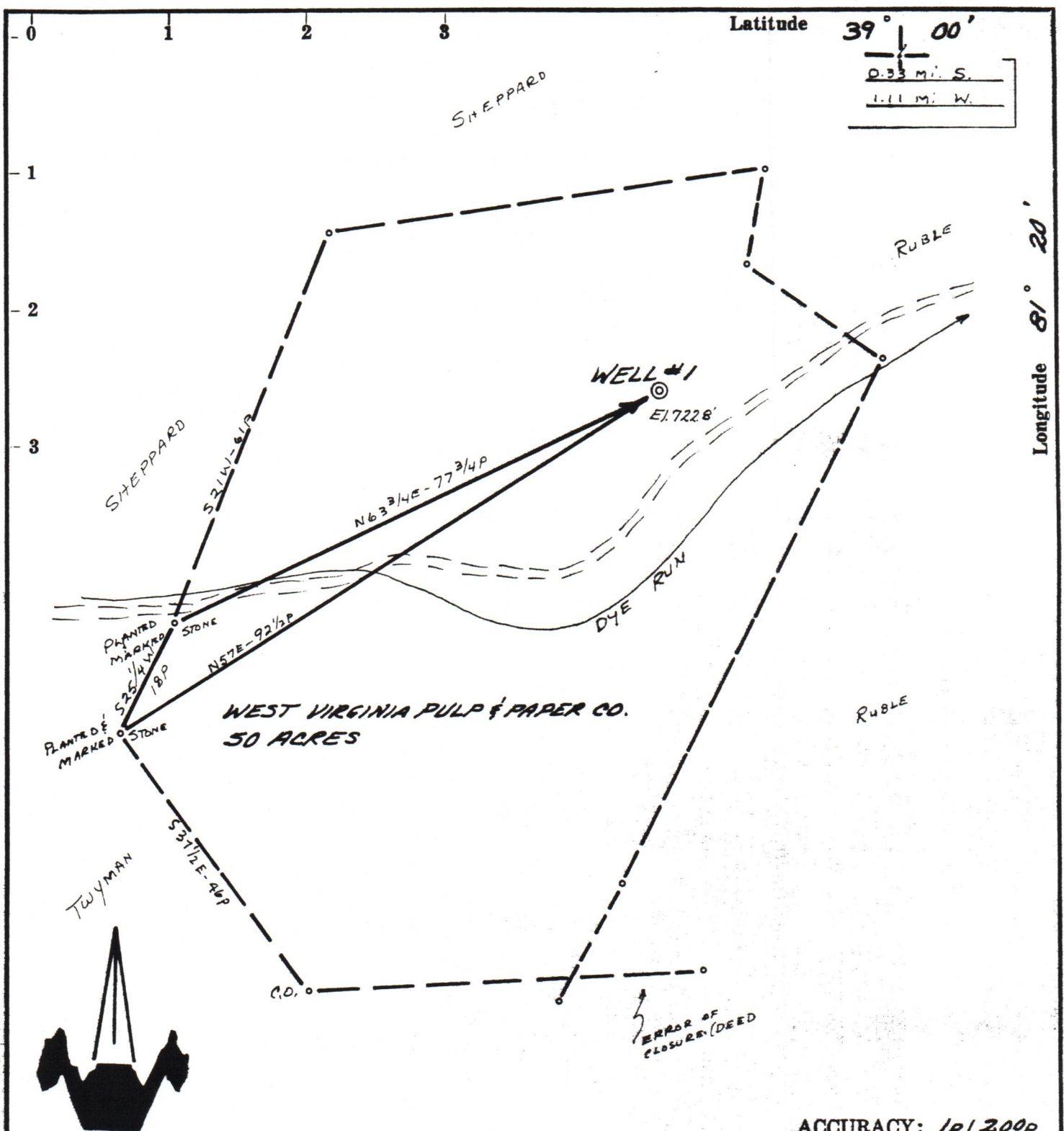

ACCURACY: 1p/200p

Source of Elevation CALM SCHOOL (731')

I, the undersigned, hereby certify that this map is correct to the best of my knowledge and belief and shows all the information required by paragraph 6 of the rules and regulations of the oil and gas section of the mining laws of West Virginia.

- New Location
- Drill Deeper
- Abandonment *issued 1-15-70*
- Fracture
- Redrill

*Chet Waterman*

Company NEO MEADLEY & CO  
CO-OPERATIVE OIL INVESTMENTS  
 P.O. Box 295  
 Address SPENCER, W. VA. 25276

Farm WEST VIRGINIA PULP & PAPER CO.  
*Part of 470 ac.*

Tract \_\_\_\_\_ Acres 50 Lease No. \_\_\_\_\_

Well (Farm) No. 1 Serial No. \_\_\_\_\_

Elevation (Spirit Level) 722.8'

Quadrangle SPENCER

County WIRT District BURNING SPRINGS

Engineer CHET WATERMAN

Engineer's Registration No. 3788

File No. 68003-190 Drawing No. \_\_\_\_\_

Date 10/23/68 Scale 1" = 20p

STATE OF WEST VIRGINIA  
DEPARTMENT OF MINES  
OIL AND GAS DIVISION  
CHARLESTON

WELL LOCATION MAP

FILE NO. WIR-565 *05/12/2024*

*Re-issued As WIR-577-P*  
+ Denotes location of well on United States Topographic Maps, scale 1 to 62,500, latitude and longitude lines being represented by border lines as shown.

— Denotes one inch spaces on border line of original tracing.

10/30/68 CEN

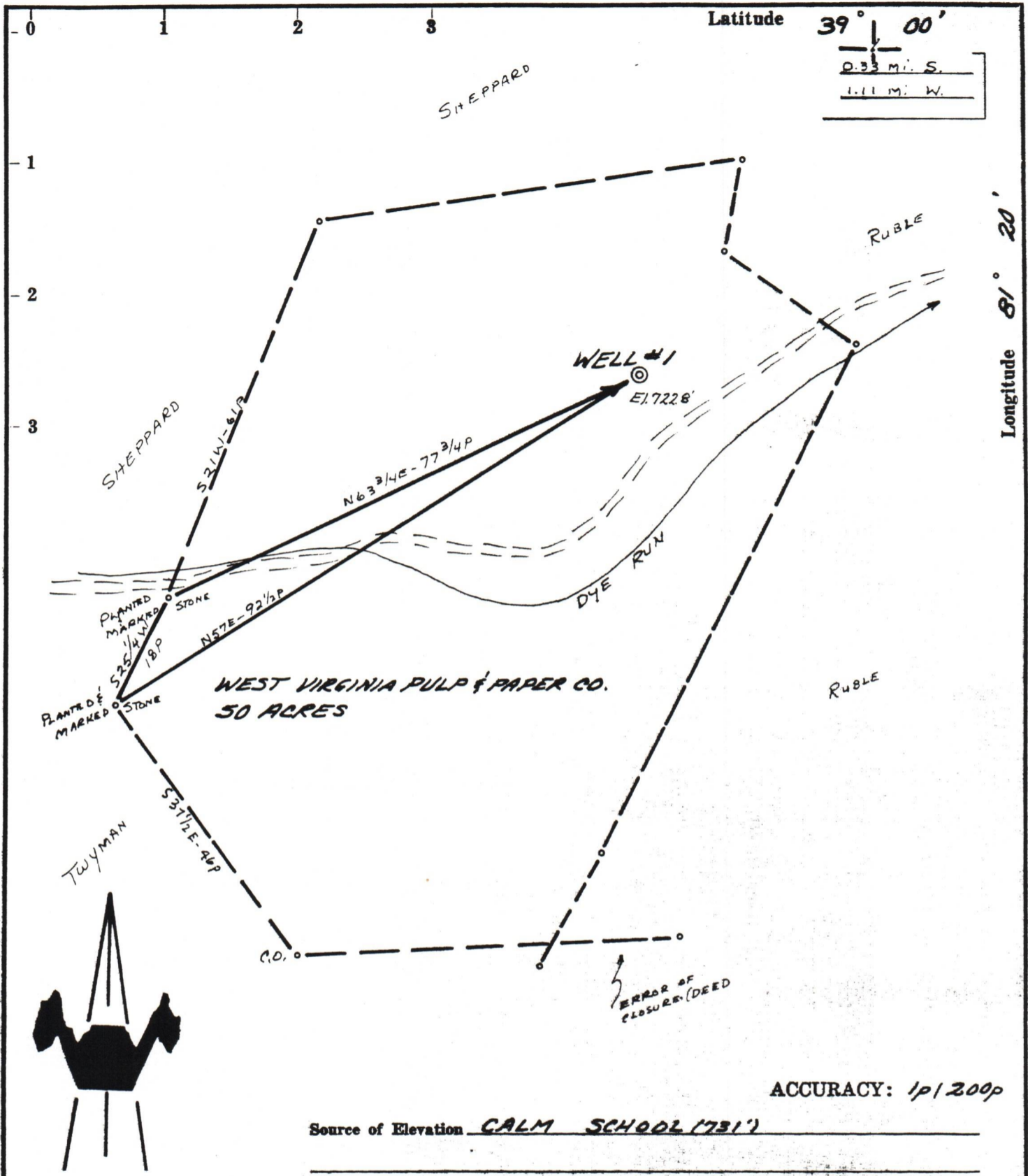

ACCURACY: 1p/200p

Source of Elevation CALM SCHOOL (731')

I, the undersigned, hereby certify that this map is correct to the best of my knowledge and belief and shows all the information required by paragraph 6 of the rules and regulations of the oil and gas section of the mining laws of West Virginia.

- New Location
- Drill Deeper
- Abandonment *issued 1-15-70*
- Fracture
- Redrill

*Chet Waterman*

Company NEO MEASLEY dba CO-OPERATIVE OIL INVESTMENTS  
 P.O. Box 295  
 Address SPENCER, W. VA. 25276  
 Farm WEST VIRGINIA PULP & PAPER CO.  
Part of 970 ac.  
 Tract \_\_\_\_\_ Acres 50 Lease No. \_\_\_\_\_  
 Well (Farm) No. 1 Serial No. \_\_\_\_\_  
 Elevation (Spirit Level) 722.8'  
 Quadrangle SPENCER  
 County WIRT District BURNING SPRINGS  
 Engineer CHET WATERMAN  
 Engineer's Registration No. 3788  
 File No. 68003-190 Drawing No. \_\_\_\_\_  
 Date 10/23/68 Scale 1" = 20p

STATE OF WEST VIRGINIA  
DEPARTMENT OF MINES  
OIL AND GAS DIVISION  
CHARLESTON

WELL LOCATION MAP

FILE NO. WIR-565

*Re-issued As Win-577-P*

+ Denotes location of well on United States Topographic Maps, scale 1 to 62,500, latitude and longitude lines being represented by border lines as shown.

— Denotes one inch spaces on border line of original tracing.

01/12/2024