

Latitude

Longitude

2.50s
.41w

Topo Location

7.5' Loc. _____ 15' Loc. _____
_____ (calc.) _____

Company Pennycod United, Inc

Farm J B Dewhurst #29

15' Quad _____
(sec.)

7.5' Quad Center Point

District Grant

WELL LOCATION PLAT

County 103 Permit 50007

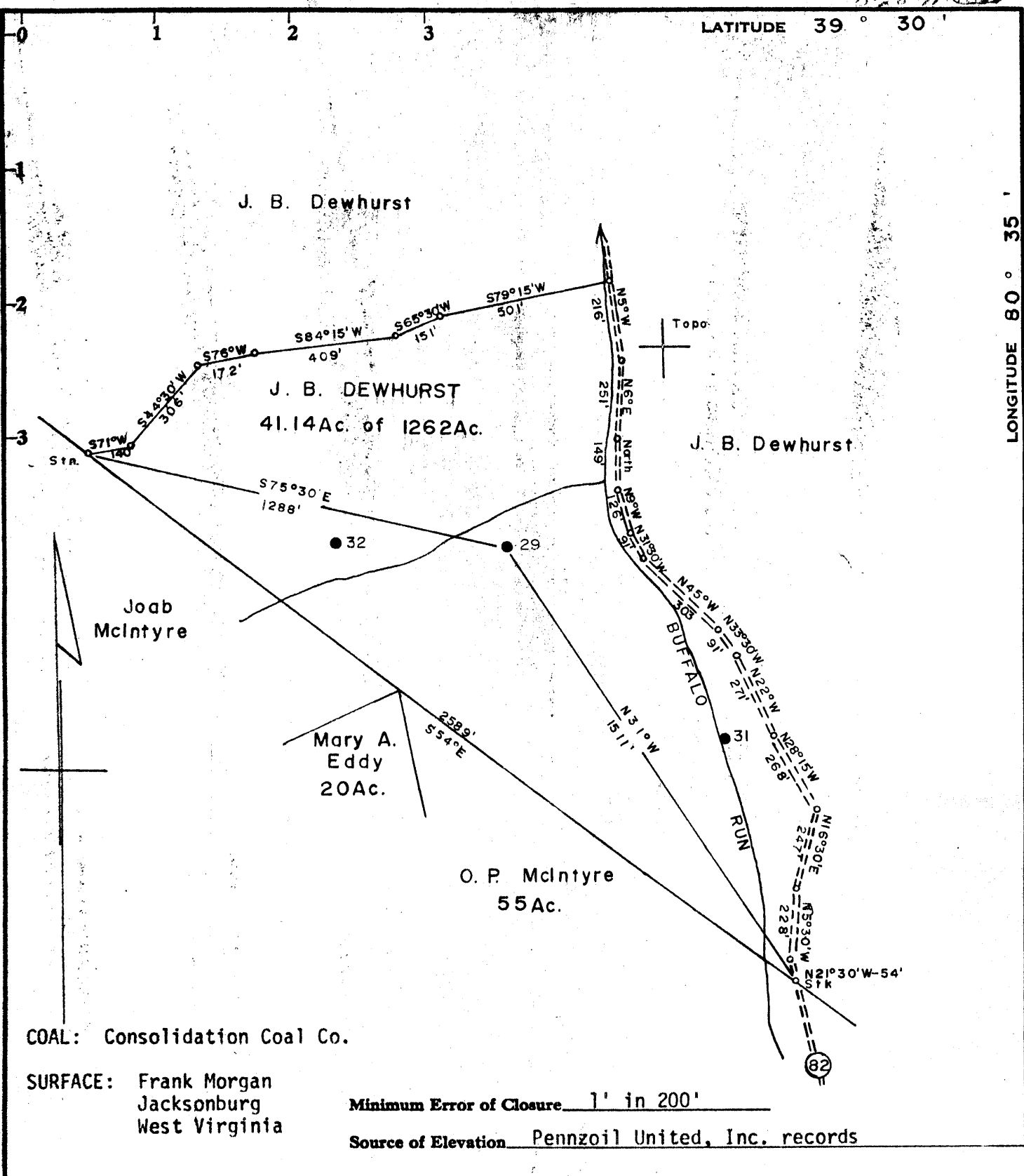

COAL: Consolidation Coal Co.

SURFACE: Frank Morgan
Jacksonburg
West Virginia

Minimum Error of Closure 1' in 200'

Source of Elevation Pennzoil United, Inc. records

- Fracture
- New Location
- Drill Deeper
- Abandonment

I, the undersigned, hereby certify that this map is correct to the best of my knowledge and belief and shows all the information required by paragraph 6 of the rules and regulations of the oil and gas section of the mining laws of West Virginia.

Signed: *Curtis A. Lucas*

Map No. N48 Squares: N | S E W |

1-24-72
issued 10-15-71

Company	PENNZOIL UNITED, INC.		
Address	P. O. Box 1588, Parkersburg, W. Va.		
Farm	J. B. Dewhurst		
Tract	41.14 of 1262 acres	Lease No.	10253
Well (Farm) No.	29	Serial No.	
Elevation (Spirit Level)	1072.89' Fl.		
Quadrangle	Centerpoint <i>MC</i>		
County	Wetzel	District	Grant
Surveyor	<i>Curtis A. Lucas</i>		
Engineer's Registration No.	275 LLS		
File No.	1531	Drawing No.	
Date	August 19, 1971		
Scale	1" = 400'		

STATE OF WEST VIRGINIA
DEPARTMENT OF MINES
OIL AND GAS DIVISION
CHARLESTON

WELL LOCATION MAP

FILE NO. *Wet-7-Frac-P.*

+ Denotes location of well on United States Topographic Maps, scale 1 to 62,500, latitude and longitude lines being represented by border lines as shown.

- Denotes one inch spaces on border line of original tracing.

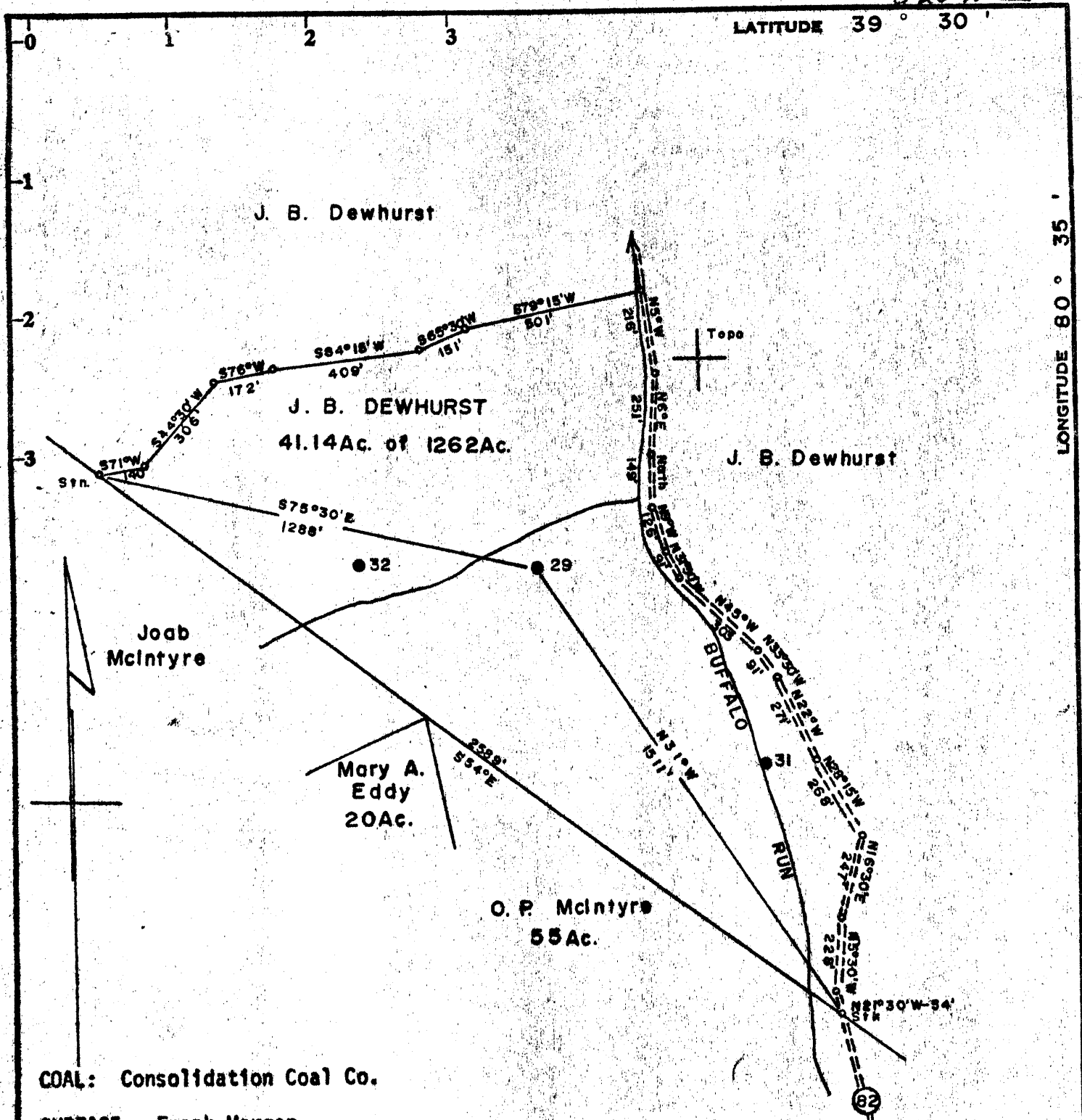

LATITUDE 39° 30'

LONGITUDE 80° 35'

COAL: Consolidation Coal Co.

SURFACE: Frank Morgan
Jacksonburg
West Virginia

Minimum Error of Closure 1' in 200'

Source of Elevation Pennzoil United, Inc. records

I, the undersigned, hereby certify that this map is correct to the best of my knowledge and belief and shows all the information required by paragraph 6 of the rules and regulations of the oil and gas section of the mining laws of West Virginia.

- Fracture
- New Location
- Drill Deeper
- Abandonment
- Partially Plug

Signed: Curtis A. Lucas

Map No. N48

Squares N I S E W I

Issued 10-15-71

Company	PENNZOIL UNITED, INC.		
Address	P. O. Box 1588, Parkersburg, W. Va.		
Farm	J. B. Dewhurst		
Tract	41.14 of 1262 acres	Lease No.	10253
Well (Farm) No.	29	Serial No.	
Elevation (Spirit Level)	1072.89' Fl.		
Quadrangle	Centerpoint NE		
County	Wetzel	District	Grant
Surveyor Engineer	<u>Curtis A. Lucas</u>		
Surveyor's Registration No.	275 LLS		
File No.	1531	Drawing No.	
Date	August 19, 1971		
Scale	1" = 400'		

STATE OF WEST VIRGINIA
DEPARTMENT OF MINES
OIL AND GAS DIVISION
CHARLESTON

WELL LOCATION MAP

FILE NO. Wet-7-Frac-P.P

+ Denotes location of well on United States Topographic Maps, scale 1 to 62,500, latitude and longitude lines being represented by border lines as shown.

- Denotes one inch spaces on border line of original tracing.

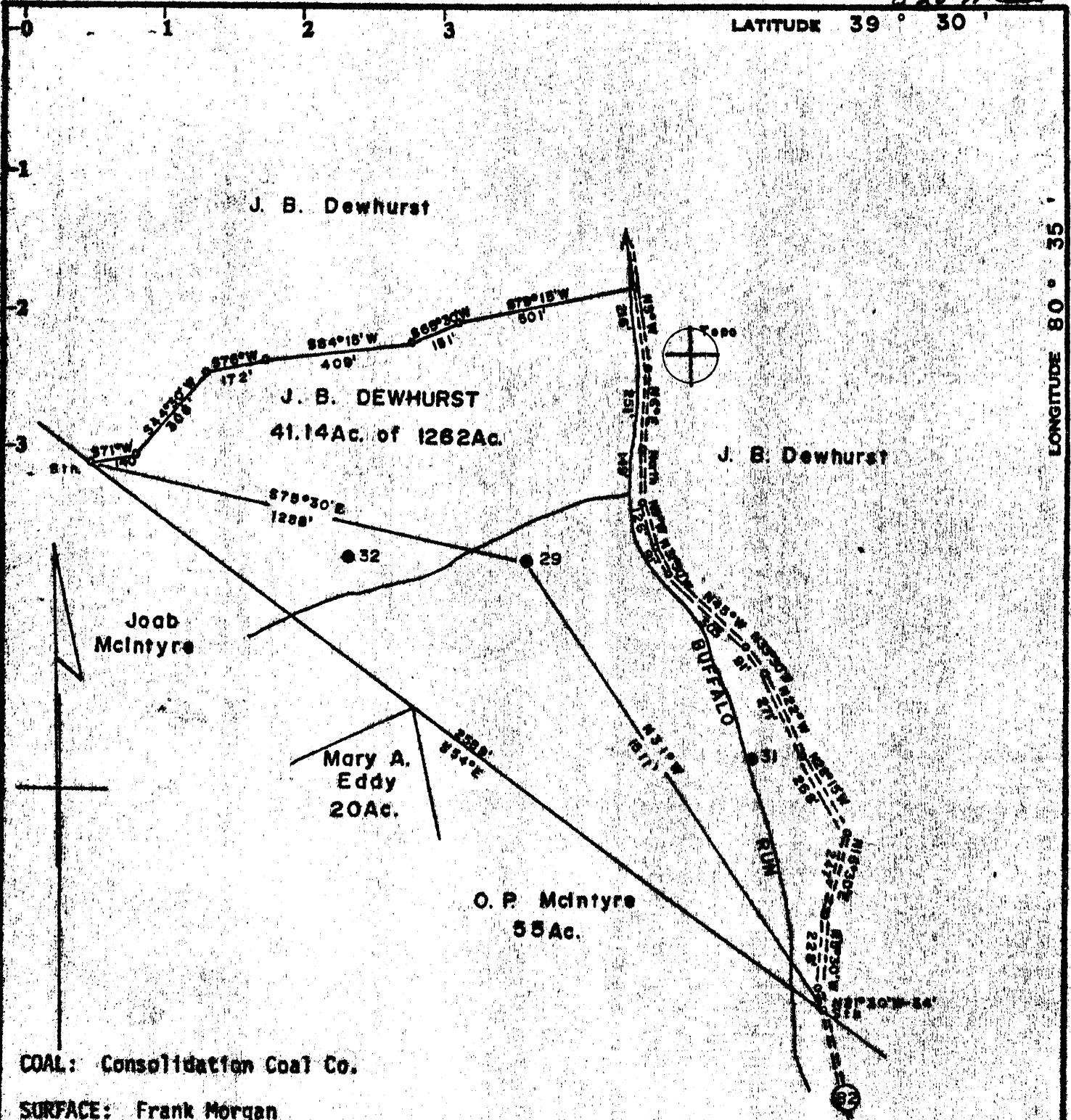

COAL: Consolidation Coal Co.

SURFACE: Frank Morgan
Jacksonburg
West Virginia

Maximum Error of Closure 1' in 200'

Source of Elevation Pennzoil United, Inc. records

- Fracture
- New Location
- Drill Deeper
- Abandonment

I, the undersigned, hereby certify that this map is correct to the best of my knowledge and belief and shows all the information required by paragraph 6 of the rules and regulations of the oil and gas section of the mining laws of West Virginia.

Signed: *Curtis A. Lucas*

Map No. N48 Squares: N 1 S E W 1

Company	PENNZOIL UNITED, INC.	
Address	P. O. Box 1588, Parkersburg, W. Va.	
Farm	J. B. Dewhurst	
Tract	41.14 of 1262 acres	Lease No. 10253
Well (Farm) No.	29	Serial No.
Elevation (Spirit Level)	1072.89' Fl.	
Quadrangle	Centerpoint 10	
County	Wetzel	District Grant
Surveyor	<i>Curtis A. Lucas</i>	
Engineer's Registration No.	275 LLS	
File No.	1531	Drawing No.
Date	August 19, 1971	
Scale	1" = 400'	

STATE OF WEST VIRGINIA
DEPARTMENT OF MINES
OIL AND GAS DIVISION
CHARLESTON

WELL LOCATION MAP
FILE NO. *Wet-7-Frac.*

+ Denotes location of well on United States Topographic Maps, scale 1 to 62,500, latitude and longitude lines being represented by border lines as shown.

— Denotes one inch spaces on border line of original tracing.