

Latitude

Longitude

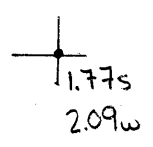

Topo Location

7.5' Loc. _____ 15' Loc. _____
 _____ (calc.) _____

Company Quaker State

Farm J M Lovell #3

15' Quad _____
(sec.)

7.5' Quad Big Run

District Grant

WELL LOCATION PLAT

County 103 Permit 996A

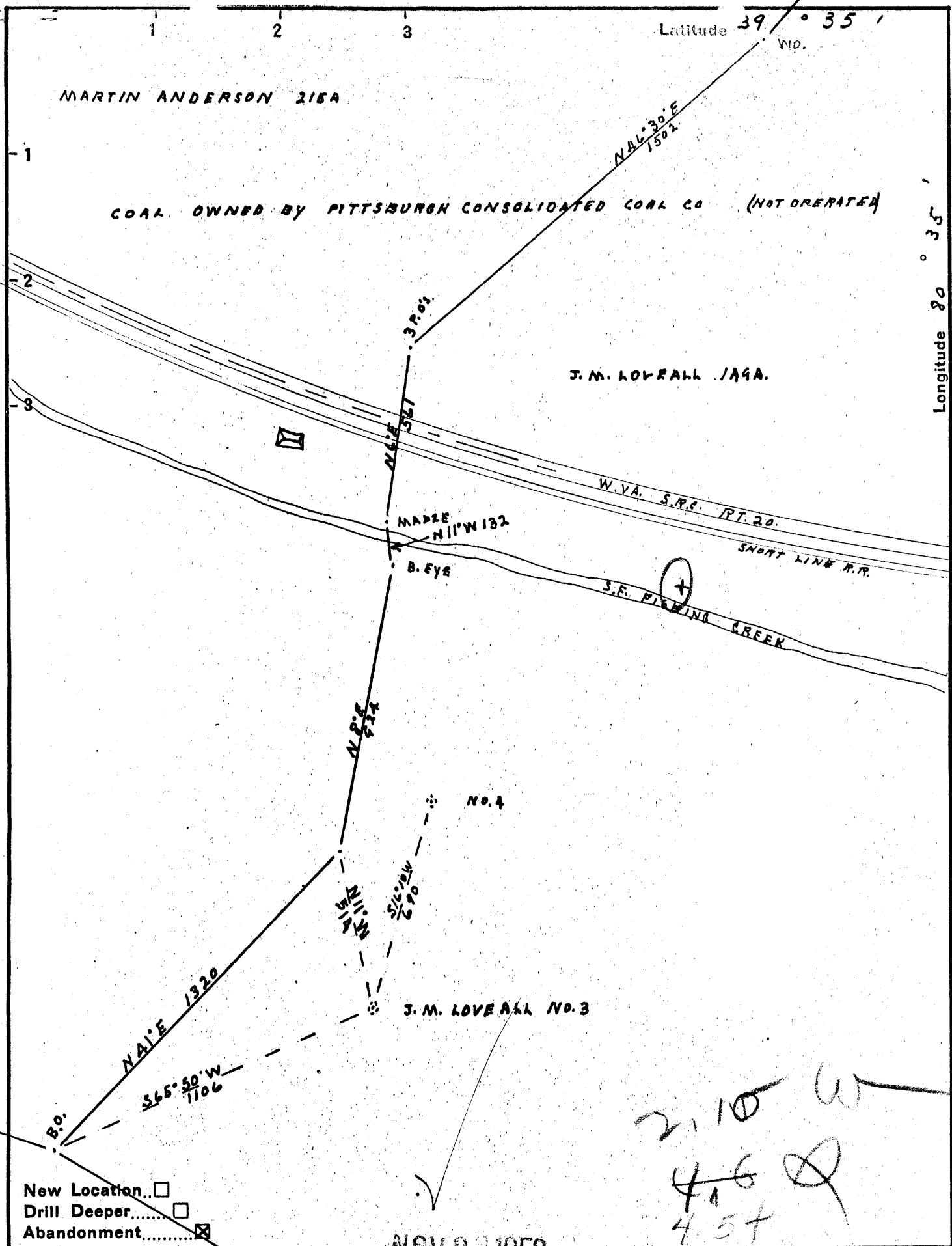

New Location...
 Drill Deeper...
 Abandonment...

NOV 2 1953

Company QUAKER STATE OIL CORP
 Address PO. BOX 1789, 1222 MARKET ST, PARRISBURGH, W. VA.
 Farm J.M. LOVEALL
 Tract _____ Acres 1.49 Lease No. _____
 Well (Farm) No. 3 Serial No. _____
 Elevation (Spirit Level) 968.5
 Quadrangle LITTLETON
 County WETZEL District GRANT
 Engineer J.M. Goodwin
 Engineer's Registration No. 60, Duwayor
 File No. _____ Drawing No. _____
 Date NET 12, 1953 Scale ADD' = 1"

STATE OF WEST VIRGINIA
 DEPARTMENT OF MINES
 OIL AND GAS DIVISION
 CHARLESTON

WELL LOCATION MAP
 FILE NO. Wet-996-A

+ Denotes location of well on United States Topographic Maps, scale 1 to 62,500, latitude and longitude lines being represented by border lines as shown.
 - Denotes one inch spaces on border line of original tracing.

J. M. LOVEALL NO. 3 - QUAKER STATE OIL CORP. - WET-996-A



STATE OF WEST VIRGINIA
DEPARTMENT OF MINES
OIL AND GAS DIVISION

142W

Littleton
996A

WELL RECORD

Permit No. 996A Oil or Gas Well Oil (KIND)

Company QUAKER STATE OIL REFINING CORP
Address Box 1789, Parkersburg, W. Va.
Farm J. M. Laveall Acres 150-a
Location (waters) _____
Well No. 3 Elev. 968.5
District Grant County Wayne
The surface of tract is owned in fee by _____
Address _____
Mineral rights are owned by _____
Address _____
Drilling commenced _____
Drilling completed Sept. 16, 1901
Date Shot July 12 From 80 qts. To _____
With Sept. 27, '01 30 qts.
May 21, '26 80 qts. (Young Torp. Co.)
Open Flow _____ /10ths Water in _____ Inch
_____ /10ths Merc. in _____ Inch
Volume _____ Cu. Ft.
Rock Pressure _____ lbs. _____ hrs.
Oil _____ bbls., 1st 24 hrs.
Fresh water _____ feet _____ feet
Salt water _____ feet _____ feet

Casing and Tubing	Used in Drilling	Left in Well	Packers
Size			Kind of Packer
16			
18			
10	435'	Pulled	Size of
8 1/4	1275	"	
6%	2030		Depth set
5 3/16	2285		
3			Perf. top
2			Perf. bottom
Liners Used			Perf. top
			Perf. bottom

CASING CEMENTED _____ SIZE _____ No. Ft. _____ Date _____
COAL WAS ENCOUNTERED AT _____ FEET _____ INCHES
_____ FEET _____ INCHES FEET _____ INCHES
_____ FEET _____ INCHES FEET _____ INCHES

Formation	Color	Hard or Soft	Top	Bottom	Oil, Gas or Water	Depth Found	Remarks
Pittw. Coal			750				
Cave			1175	1235			
Cow Run sand			1275	1305			
Sand			1550	1800	1750 Water		
Maxon			1860	1890			
Line			2000	2050			
Big Injun			2050	2230			
Stray			2834	2849			
Gordon Sand			2849	2882			
Oil			(2180				
			(2873				
			(2879				
Total Depth				2894			

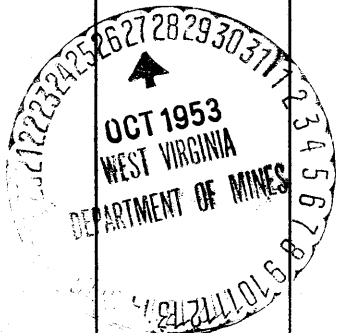

Grant District, Wetzel County, W. Va.
By Carter Oil Co.

	Top.	Bottom.	Thickness.
Pittsburgh Coal (good)	750	- 757	7
Cow Run Sand	1275	- 1305	30
Salt Sand	1550	- 1800	250
Marion Sand	1860	- 1890	30
Lime	2000	- 2050	50
Big Injun Sand	2050	- 2230	180
Stray Sand	2834	- 2849	15
Borden Sand	2849	- 2882	33