

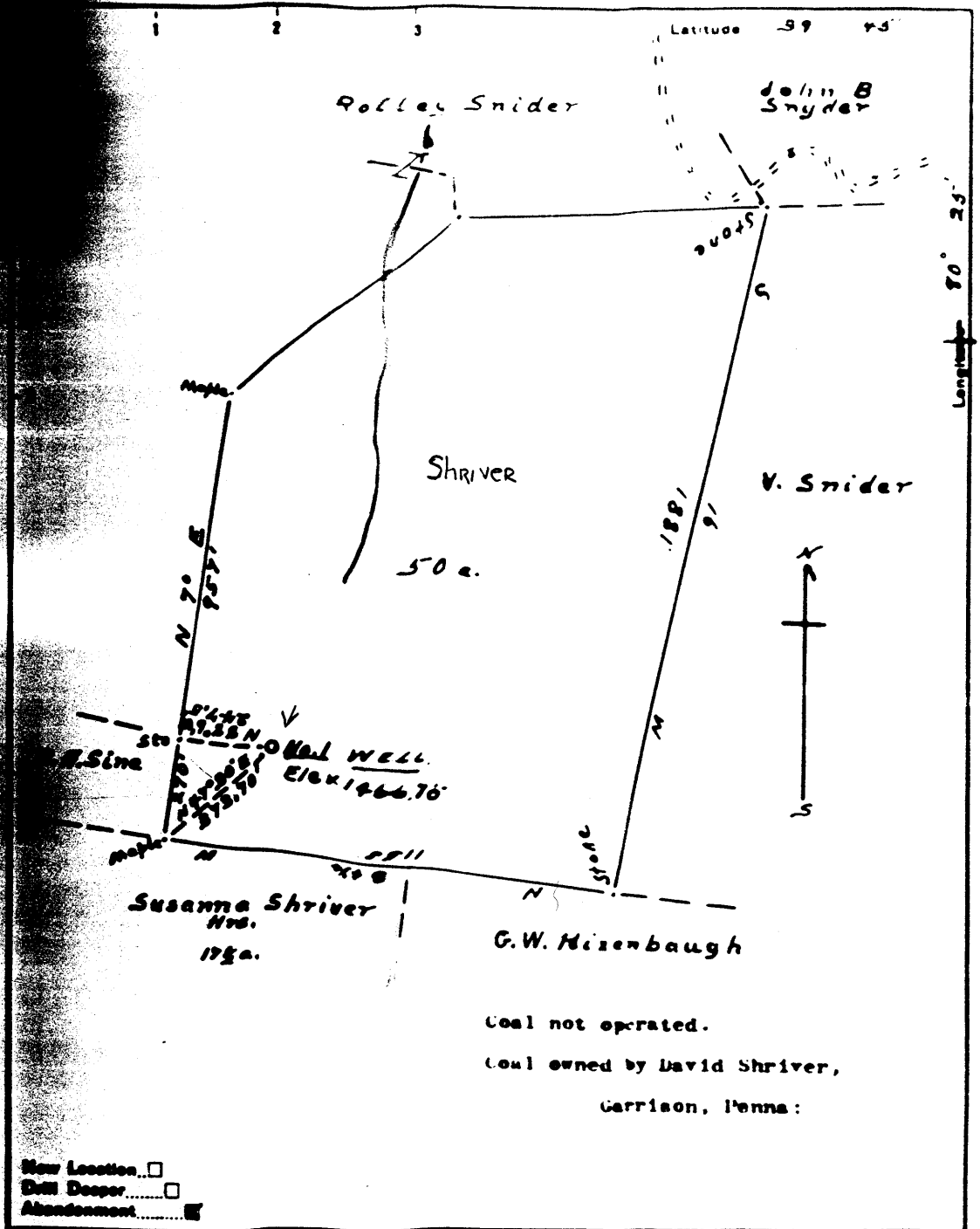



30906



Coal not operated.  
 Coal owned by David Shriver,  
 Garrison, Penna:

New Location   
 Dirt Deeper   
 Abandonment

Company Fred Meblay  
 Address Hundred, W. Va.  
 From Susanna Shriver Hrd

STATE OF WEST VIRGINIA  
 DEPARTMENT OF MINES  
 OIL AND GAS DIVISION

906  
 Wet-~~51~~-A (?)

Church District, Wetzel County, W. Va.  
 By Carter Oil Co.  
 Two miles southeast of Burton.  
 Elevation, 1175' B.  
 2-bbl. well.

	Top.	Bottom.
Mapletown (Sewickley) Coal	912	- 917
Pittsburgh Coal	1012	- 1014
Cave (Moundsville)	1014	- 1032
Little Dunkard Sand (First Cow Run) //	1332	- 1376
Dunkard Sand	1410	- 1442
Sand	1460	- 1925
Little Lime	2145	- 2160
Big Lime	2195	- 2280
Big Injun Sand (water, 2505')	2280	- 2535
Pencil Cave	2840	- 2870
Gantz Sand	2870	- 2966
Fifty-foot Sand	2973	- 3003
Thirty-foot Sand (gas, 3029'; oil, 3044')	3023	- 3055
Stray Sand	3070	- 3085
Gordon Sand	3105	- 3175
Fourth Sand	3185	- 3219
Bayard Sand	3377	- 3383

103-30906

S.M. Shriver No. 1 Well (39-I)

Church District, Wetzel Co., W. Va.; on a northern branch of West Virginia Fork of Fish Creek 1.5 miles southeast of Cotton-town; completed April 21, 1922; by Wade Oil & Gas Co.; elevation, \_\_\_\_\_.

	Top. Feet.	Bottom. Feet.
Coal, <u>Mabletown, Sewickley</u> .....	1015	1020
Coal, <u>Pittsburgh</u> .....	1115	1124
Sand, <u>Little Dunkard, Buffalo</u> .....	1490	1555
Sand, <u>Big Dunkard, Mahoning</u> .....	1635	1680
Sand, <u>Burning Springs, Upper Freeport</u> ....	1780	1818
Gas Sand, <u>Lower Freeport</u> .....	1820	1875
Sand, <u>Second Cow Run, Homewood</u> .....	1954	2020
Sand (shells), <u>Salt, Upper Connocuenessing</u>	2020	2064
Red rock ( <u>Maxton Sand horizon</u> ) .....	2264	2284
<u>Little Lime</u> .....	2285	2305
Slate, <u>Pencil Cave</u> .....	2305	2316
<u>Big Lime</u> .....	2316	2373
Sand, <u>Big Injun (gas, 2400')</u> .....	2373	2473
Total depth .....		2466
Total depth when drilled deeper in 1924...		3166

Well made some Big Injun Sand gas and showed 1 bbl. of oil in Thirty-foot Sand; now abandoned.

DD = 700