

30902
Church

39°45'

80°20'

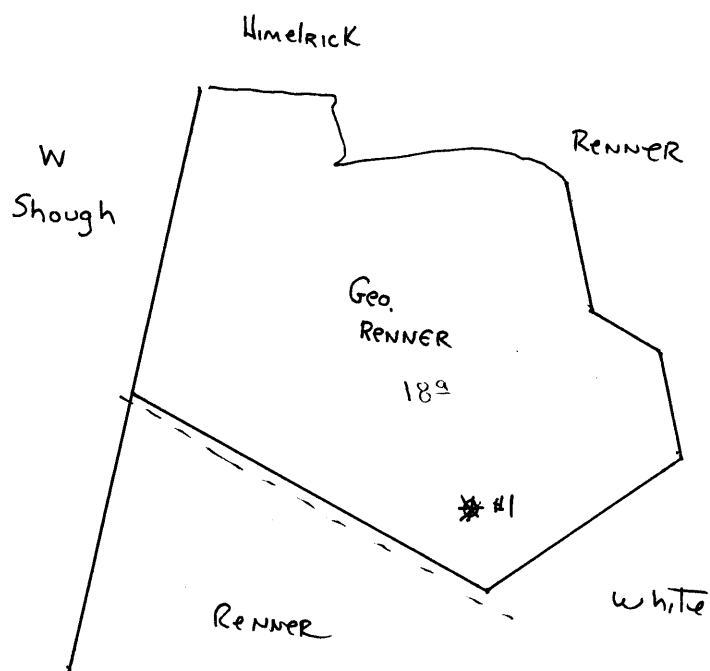



STATE OF WEST VIRGINIA
DEPARTMENT OF MINES
OIL AND GAS DIVISION

1339

WELL RECORD

Permit No. 902A

~~Oil~~ Gas Well (KIND)

Company Duane Snider
 Address Garrison, Pa.
 Farm Geo. M. Remer Acres 18
 Location (waters) _____
 Well No. 1 Elev. 1193
 District Church County Wetzel
 The surface of tract is owned in fee by Ralph White
Box No. 2 Address Morgantown, W. Va.
 Mineral rights are owned by Coal: Benjamin G. Reeder
 Address Morgantown, W. Va.
 Drilling commenced Aug 1st 1927
 Drilling completed Oct. 3rd 1927
 Date Shot No Record From _____ To _____
 With _____

Casing and Tubing	Used in Drilling	Left in Well	Packers
Size			
16			Kind of Packer
13			
10	222	222	Size of
8 1/2	1468	1468	
6 1/2	2190	2190	Depth set
5 3/16			
3			Perf. top
2			Perf. bottom
Liners Used			Perf. top
			Perf. bottom

Open Flow /10ths Water in _____ Inch
 /10ths Merc. in _____ Inch
 Volume _____ Cu. Ft.
 Rock Pressure _____ lbs. _____ hrs.
 Oil _____ bbls., 1st 24 hrs.
 Fresh water _____ feet _____ feet
 Salt water _____ feet _____ feet

CASING CEMENTED _____ SIZE _____ No. Ft. _____ Date _____
 COAL WAS ENCOUNTERED AT 900 FEET 84 INCHES
 _____ FEET _____ INCHES FEET _____ INCHES
 _____ FEET _____ INCHES FEET _____ INCHES

Formation	Color	Hard or Soft	Top	Bottom	Oil, Gas or Water	Depth Found	Remarks
Pittsburgh Coal			980	987			
Little Dunkard Sand			1362	1393			
Big Dunkard Sand			1455	1578			
Gas Sand			1590	1730			
1st Salt Sand			1790	1860			
2nd Salt Sand			1948	1990			
Red Rock			2035	2102			
Line Shells			2102	2160			
Pencil Cove			2160	2170			
Big Line			2170	2228			
Big Injun Sand			2228				
Gas Pay			2232	2236			
Gas Pay			2238	2243			
Total Depth				2470			

