

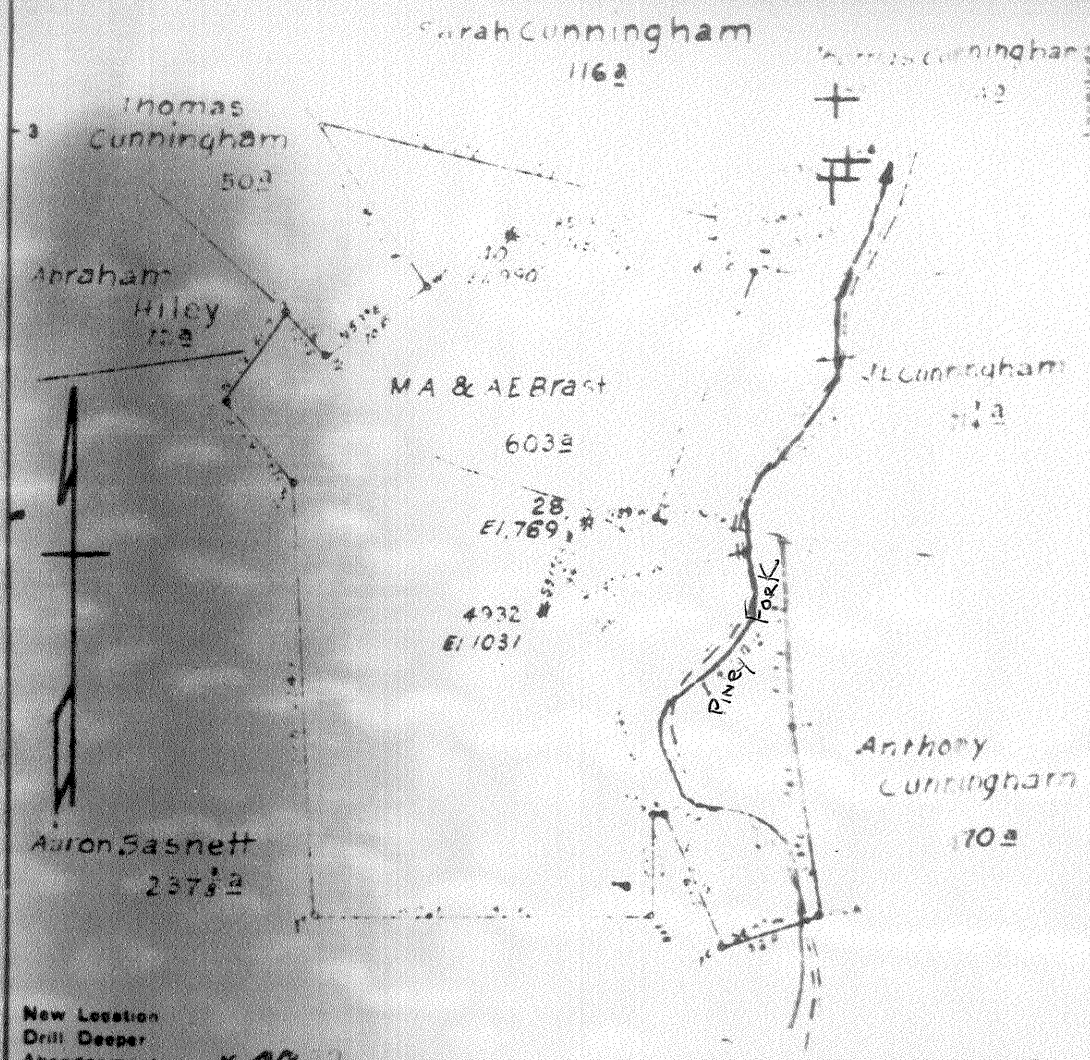

30894



New Location  
 Drill Deeper  
 Abandonment *x 49-2*

Map Sec. 39 N 7 W 5 E B. 920 HI-16

Company *Hope Natural Gas Co*  
 Address *Clarksburg Wva.*  
 Farm *M.A. & A.E. Brast*  
 Tract \_\_\_\_\_ Acres *603* Lease No. *481*  
 Well (Farm) No. \_\_\_\_\_ Serial No. *As Shown*  
 Elevation (Spirit Level) *As Shown*  
 Quadrangle *Littleton*  
 County *Wetzel* District *Greene*  
 Engineer *M.M. Bowers*  
 Engineer's Registration No. *400*  
 File No. \_\_\_\_\_ Drawing No. \_\_\_\_\_  
*1-5-49* *1"-120'*

STATE OF WEST VIRGINIA  
 DEPARTMENT OF MINES  
 OIL AND GAS DIVISION  
 CHARLESTON

**WELL LOCATION MAP**  
 FILE NO \_\_\_\_\_

⊕ Denotes location of well on United States Topographic Maps, scale 1 to 62,500, latitude and longitude lines being represented by border lines as shown.  
 = Denotes one inch spaces on border line of original tracing



STATE OF WEST VIRGINIA  
DEPARTMENT OF MINES  
OIL AND GAS DIVISION

1327

WELL RECORD

Permit No. 894 A

Oil or Gas Well Oil (KIND)

Company Hope Natural Gas Company  
 Address 445 West Main St. Clarksburg, W. Va.  
 Farm A.E. Brast Acres 6.3  
 Location (waters) \_\_\_\_\_  
 Well No. 4932 Elev. 1031  
 District Green County Wetzel  
 The surface of tract is owned in fee by \_\_\_\_\_  
 Address \_\_\_\_\_  
 Mineral rights are owned by \_\_\_\_\_  
 Address \_\_\_\_\_  
 Drilling commenced November 29, 1917  
 Drilling completed March 23, 1918  
 Date Shot \_\_\_\_\_ From \_\_\_\_\_ To \_\_\_\_\_  
 With \_\_\_\_\_  
 Open Flow \_\_\_\_\_ /10ths Water in \_\_\_\_\_ Inch  
 \_\_\_\_\_ /10ths Merc. in \_\_\_\_\_ Inch  
 Volume \_\_\_\_\_ Cu. Ft.  
 Rock Pressure \_\_\_\_\_ lbs. \_\_\_\_\_ hrs.  
 Oil \_\_\_\_\_ bbls., 1st 24 hrs.  
 Fresh water \_\_\_\_\_ feet \_\_\_\_\_ feet  
 Salt water 1690 feet \_\_\_\_\_ feet

| Casing and Tubing | Used in Drilling | Left in Well  | Packers        |
|-------------------|------------------|---------------|----------------|
| Size              |                  |               | Kind of Packer |
| 16                |                  |               |                |
| 13                |                  |               |                |
| 10                | <u>494</u>       | <u>Pulled</u> | Size of        |
| 8 1/4             | <u>1308</u>      | <u>Pulled</u> |                |
| 6 3/8             | <u>1983</u>      | <u>1983</u>   | Depth set      |
| 5 3/16            | <u>2800</u>      | <u>2800</u>   |                |
| 3                 |                  |               | Perf. top      |
| 2                 | <u>2913</u>      | <u>2913</u>   | Perf. bottom   |
| Liners Used       |                  |               | Perf. top      |
|                   |                  |               | Perf. bottom   |

CASING CEMENTED NOT SIZE \_\_\_\_\_ No. Ft. \_\_\_\_\_ Date \_\_\_\_\_  
 COAL WAS ENCOUNTERED AT 320 FEET 48 INCHES  
758 FEET 24 INCHES FEET \_\_\_\_\_ INCHES  
 FEET \_\_\_\_\_ INCHES FEET \_\_\_\_\_ INCHES

| Formation      | Color | Hard or Soft | Top  | Bottom | Oil, Gas or Water | Depth Found | Remarks         |
|----------------|-------|--------------|------|--------|-------------------|-------------|-----------------|
| Coal           |       |              | 320  | 324    |                   |             |                 |
| Coal           |       |              | 758  | 760    |                   |             |                 |
| Kittle Dunkard |       |              | 1167 | 1183   |                   |             |                 |
| Big Dunkard    |       |              | 1281 | 1320   |                   |             |                 |
| Gas sand       |       |              | 1368 | 1392   |                   |             |                 |
| First Salt     |       |              | 1505 | 1550   |                   |             |                 |
| Second Salt    |       |              | 1686 | 1850   | water 1690        |             | salty hole full |
| Maxon          |       |              | 1866 | 1881   |                   |             |                 |
| Little Lime    |       |              | 1965 | 1975   |                   |             |                 |
| Pencil cave    |       |              | 1975 | 1983   |                   |             |                 |
| Big Lime       |       |              | 1983 | 2046   |                   |             |                 |
| Big Injun      |       |              | 2046 | 2250   |                   |             |                 |
| Squaw          |       |              | 2255 | 2270   |                   |             |                 |
| Berea          |       |              | 2420 | 2450   |                   |             |                 |
| Gantz          |       |              | 2452 | 2487   |                   |             |                 |
| Fifty foot     |       |              | 2628 | 2640   |                   |             |                 |
| Gordon stray   |       |              | 2841 | 2858   | gas               | 2846        |                 |
| Gordon         |       |              | 2860 | 2866   | gas               | 2850        | 61              |
| Total depth    |       |              |      | 2879   |                   |             |                 |

