

Latitude 39° 40'

Longitude 80° 35'

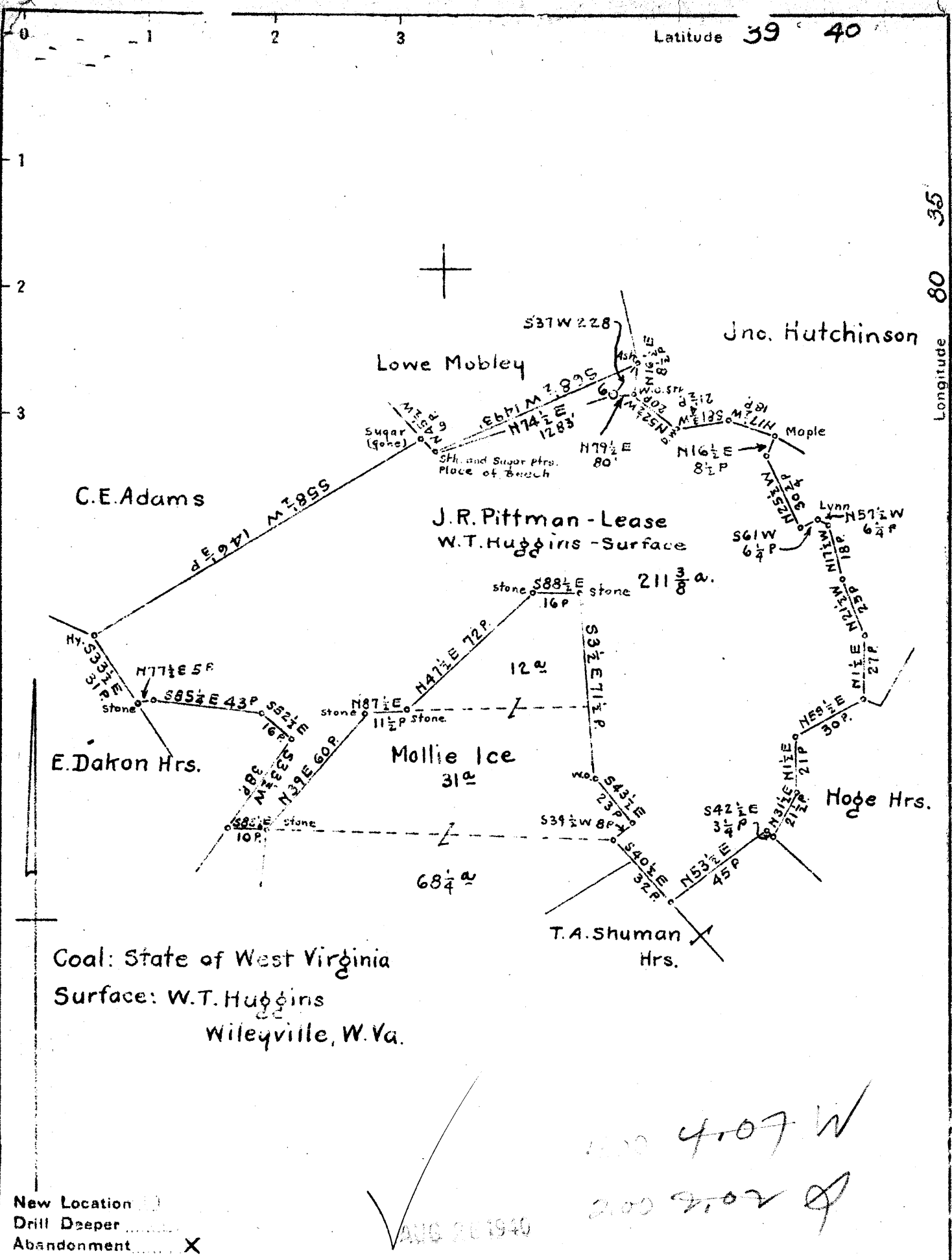

Coal: State of West Virginia
 Surface: W.T. Huggins
 Wileyville, W. Va.

New Location
 Drill Deeper
 Abandonment

✓
 AUG 26 1940
 4.07 W
 2.00 2.02

Company South Penn Natural Gas Co.
 Address Parkersburg, W. Va.
 Farm J.R. Pittman
 Tract _____ Acres 218 Lease No. 30331
 Well (Farm) No. 6 Serial No. _____
 Elevation (Spirit Level) 1075.93
 Quadrangle Littleton
 County Wetzel District Center
 Engineer E.C. Tabler
 Engineer's Registration No. _____
 File No. _____ Drawing No. _____
 Date July 25, 1940 Scale 1" = 800

STATE OF WEST VIRGINIA
 DEPARTMENT OF MINES
 OIL AND GAS DIVISION
 CHARLESTON

WELL LOCATION MAP
 FILE NO. WET-340A

+ Denotes location of well on United States Topographic Maps, scale 1 to 62,500, latitude and longitude lines being represented by border lines as shown.
 - Denotes one inch spaces on border line of original tracing.

STATE OF WEST VIRGINIA
DEPARTMENT OF MINES
OIL AND GAS DIVISION

814

WELL RECORD

Oil or Gas Well **OIL**
(KIND)

Permit No. **342-A**

Company **South Penn Natural Gas Company**
 Address **Union Trust Bldg. Parkersburg, W. Va.**
 Farm **J. R. Pitman** Acres **218**
 Location (waters) **--**
 Well No. **6** Elev. **1075.93'**
 District **Center** County **Wetzel**
 The surface of tract is owned in fee by **W. T. Huggins**
 Address **Wileyville, W. Va.**
 Mineral rights are owned by **Rock Camp Oil Co. et al**
 Address **Morgantown, W. Va.**
 Drilling commenced **Dec. 8, 1903**
 Drilling completed **March 18, 1904**
 Date shot **3-19-04 30 qt.** Depth of shot **--**
8-9-10 60"
 Open Flow /10ths Water in **---** Inch
 /10ths Merc. in **---** Inch
 Volume **---** Cu. Ft.
 Rock Pressure **---** lbs **---** hrs.
 Oil **10** bbls., 1st 24 hrs.
 Fresh water **--** feet **--** feet
 Salt water **--** feet **--** feet

Casing and Tubing	Used in Drilling	Left in Well	Packers
Size			
16.			Kind of Packer --
13.			--
10.	865' (Pulled)		Size of --
8 1/4	1540' (Pulled)		--
6 5/8	2000'		Depth set --
5 3/16	2350'		--
3.			Perf. top --
2.			Perf. bottom --
Liners Used			Perf. top --
Cond. 16'			Perf. bottom --

CASING CEMENTED **--** SIZE **--** No. Ft. **--** Date **--**
 COAL WAS ENCOUNTERED AT **545** FEET **60?** INCHES
1020 FEET **72?** INCHES **--** FEET **--** INCHES
-- FEET **--** INCHES **--** FEET **--** INCHES

Formation	Color	Hard or Soft	Top	Bottom	Oil, Gas or Water	Depth Found	Remarks
Native Coal			545	550?			
Pittsburgh Coal			1020	1026?			
Dunkard Sand			1520	1565			
Salt Sand			1800	2080			
Pencil Cave			2170	2180			
Big Line			2180	2240			
Big Injun Sand			2240	2475			
Fifty Foot Sand			2847	2885			
Stray Sand			3047	3070			
Gordon Sand			3070		Oil & Gas	3048	
Total Depth				3081 1/2			

