

30210

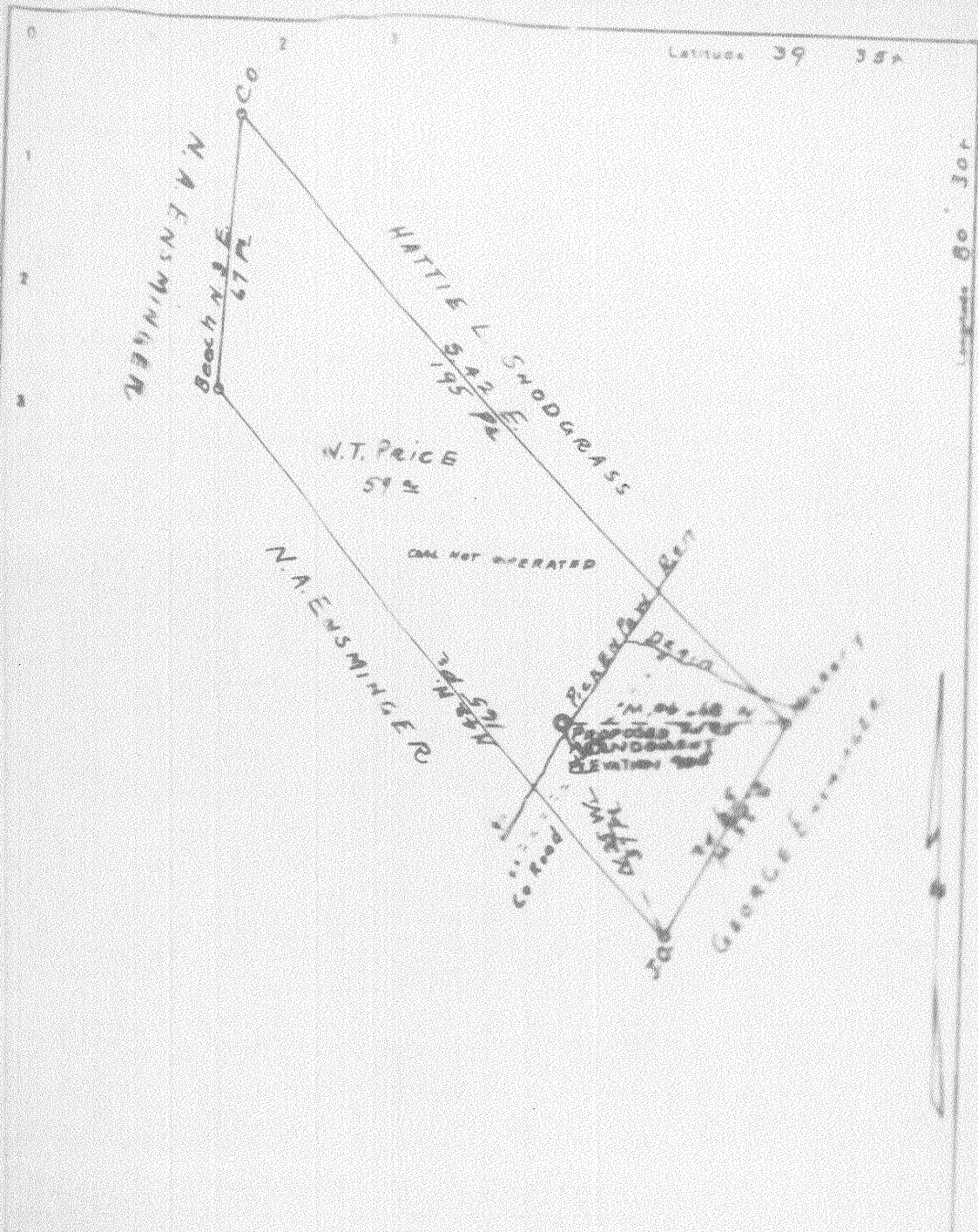

Grant District, Wetzel County, W. Va.

By H. A. Marshall & Co., Box 921, Butler, Pa.

Abandoned under permit Wet-210, issued 9-5-36. (Sept. report).

On 5 1/2 acres, on Pickensaw Run; surface owned by C. F. Rice,
Route 1, Smithfield, W. Va., and minerals by W. T. Price,
Route 1, Smithfield, W. Va.

Elevation, 905' L.

13" conductor, 15'; 10"..... 8"..... 6" casing, 1962';
5", 2180'. Liner was used at one time and was pulled out.

Coal was encountered at 710-716'.

Abandonment report filed with Dept. of Mines Sept. 1, 1936. (not
dated and not signed).

Well was shot at 2833' (twice?).

Oil well.

Record to RCT from Mrs. Griffith Sept. 16, 1938.

	Top.	Bottom.	Thickness.
Pittsburgh Coal, black	710	- 716	6
Big Injun Sand	2022	- 2157	135
Gordon Stray Sand	2779	-
Gordon Sand (oil)	2828	-
Total depth			2843