

well to be abandoned

Company South Penn Oil Co
 Address 411-712 Ave. Pittsburgh
 Farm L. L. C. Dea
 Tract - Acres 20 - Lease No. 22
 Well Farm No. 1 - Base No.
 Quarter-angle 1/4 Sec 15
 County Wayne

STATE OF WEST VIRGINIA
 DEPARTMENT OF MINES
 OIL AND GAS DIVISION
 CHARLESTON

WELL LOCATION MAP
 FILE NO. WV-208

★ Denotes location of well or United States

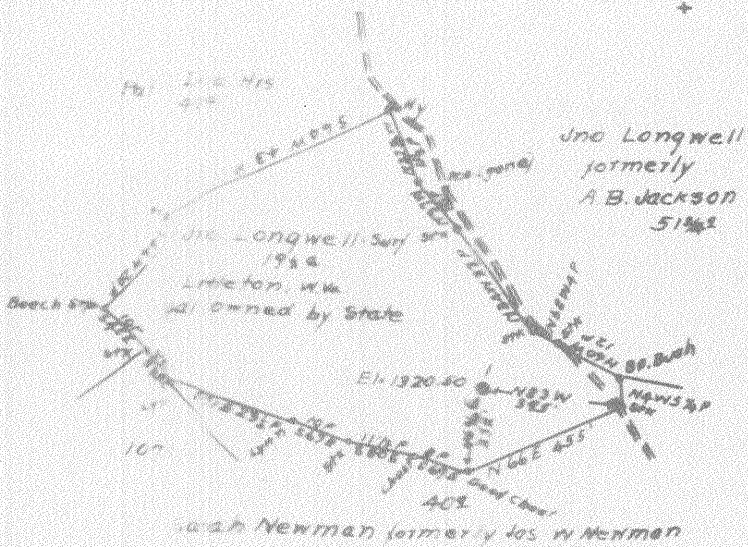

Well to be abandoned

Company South Penn Oil Co
 Address 911-7th Ave Pittsburgh
 Farm L. J. Dea
 Tract - Acre 20 Lease No. 15-32
 Well Farm No. 1 Serial No.
 Quadrangle Littleton
 County Wetzel

STATE OF WEST VIRGINIA
 DEPARTMENT OF MINES
 OIL AND GAS DIVISION
 CHARLESTON

WELL LOCATION MAP
 FILE NO. WET-208

+ Denotes location of well on United States

Wet-208-A

Clay District, Wetzel County, W. Va.

By South Penn Oil Co., Chamber of Commerce Bldg., Pittsburgh, Pa.

On 20 acres, surface owned by John Longwell, Littleton, W. Va.,
and mineral rights by Lawrence O'Dea, Littleton, W. Va.

Elevation, 1320.50' L.

15' conductor; 10" casing, 523' (pulled); 8 $\frac{1}{2}$ " , 1505' (pulled);
6-5/8" , 2260' ; 5-3/16" , 2610'.

Coal was encountered at 1045-1051'.

Abandonment reported to Dept. of Mines July 21, 1936.

Oil well.

	Top.	Bottom.
Pittsburgh Coal	1045	- 1051
Dunkard Sand	1510	- 1560
Salt Sand	1960	- 2030
Pencil Cave	2205	- 2220
Big Lime	2220	- 2295
Big Injun Sand	2295	- 2610
Fifty-foot Sand	2945	- 2970
Stray Sand (show of oil, 3152')	3110	- 3158
Gordon Sand (oil, 3162')	3158	- 3169
Total depth		3169