

30196

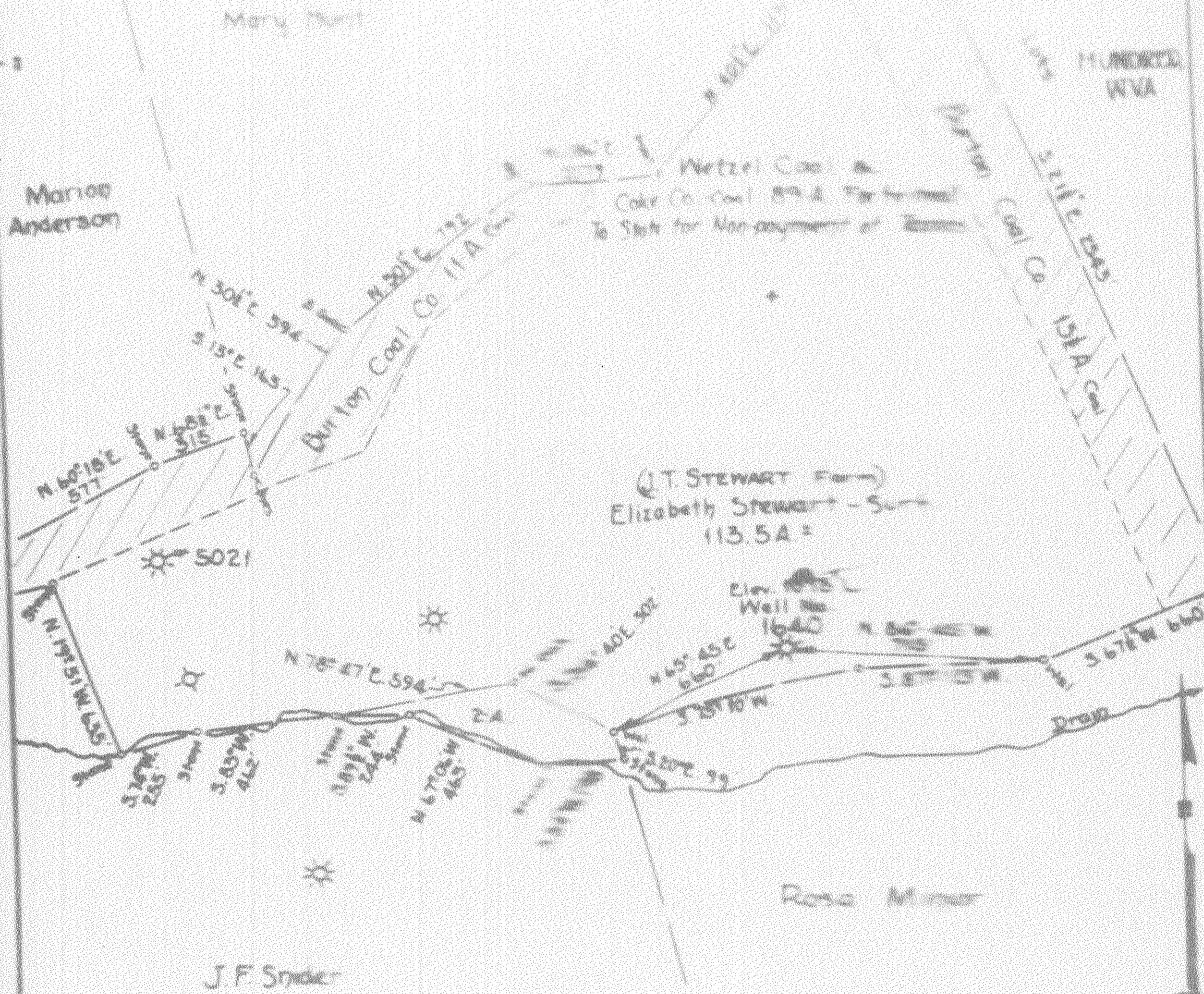

Company PITTSBURGH & W.VA. GAS CO.
 Address Living Nat Bank Bldg, Clarksburg, W. Va.
 Farm J.T. STEWART
 Tract Acres 113.8 Lease No. 29807
 Well Farm No. 1 Serial No. 1640

LOCATION OF WELL NO. 1640 TO ABANDON
 STATE OF WEST VIRGINIA
 DEPARTMENT OF MINES
 OIL AND GAS DIVISION
 CHARLESTON
 WELL LOCATION MAP
 FILE NO. RET-188

Wet-196-A

Church District, Wetzel County, W. Va.
 By Pittsburgh & W. Va. Gas Co., Clarksburg, W. Va.
 On 113.5⁴ acres (Map Ref. Mann. N. W. 3-1-2); surface and mineral
 rights owned by Elizabeth Stewart, Hundred, W. Va.
 Well was completed Nov. 4, 1897. (14th?)
 Elevation, 1073' L.
 13" conductor, 8'; 10" casing, 254'; 8¹/₂", 1095'; 6-5/8", 1142'.
 Coal was encountered at 280-283 and 763-768'.
 Abandonment reported to Dept. of Mines April 27, 1936.
 Began drilling July 6, 1897; comp. drg. Nov. 14, 1897.
 Gas well. 6-5/8" hole.

	Top.	Bottom.	Thickness.
Lime, blue, hard	0	23	23
Slate and shell	23	73	50
Lime, white, hard	73	90	17
Red rock, soft	90	100	10
Lime, white, hard	100	115	15
Slate, white, soft	115	145	30
Sand, gray, soft	145	160	15
Red rock, soft	160	170	10
Slate, white, soft	170	200	30
Lime, white, hard	200	220	20
Slate, black, soft	220	250	30
Lime, white, hard	250	270	20
Sand, gray, hard	270	280	10
Coal	280	283	3
Slate, black, soft	283	313	30
Slate and shells	313	343	30
Lime, white, hard	343	358	15
Slate and shells	358	388	30
Lime, white, shelly	388	418	30
Slate, black, soft	418	444	26
Lime, white, shelly	444	454	10
Slate, white, soft	454	470	16
Lime, black, hard	470	500	30
Slate, black, soft	500	520	20
Lime, white, hard	520	540	20
Slate, white, soft	540	545	5
Lime, white, hard	545	575	30
Shells, hard	575	595	20
Lime, hard	595	635	40
Slate, white, soft	635	650	15
Shells	650	660	10
Slate, black, soft	660	690	30
Lime, black, hard	690	720	30
Slate, blue, hard	720	763	43
Coal, soft	763	768	5
Slate, black, soft	768	803	35
Lime, white, hard	803	813	10
Slate and shells	813	835	22
Red rock, soft	835	853	18
Slate and shells	853	893	40
Sand, white, hard	893	903	10
Slate, white, soft	903	908	5
Red rock, soft	908	980	72
Slate, white, soft	980	1040	60
Red rock, soft	1040	1075	35
Lime, gray, hard	1075	1080	5
Slate, white, soft	1080	1095	15
Sand, gray, hard	1095	1105	10

(OVER)

J. T. STEWART NO. 1640 WELL (Continued).

	Top.	Bottom.	Thickness.
Slate and shells	1105	- 1125	20
Slate, black, soft	1125	- 1153	28
Red rock, soft	1153	- 1158	5
Lime, blue, hard	1158	- 1168	10
Slate, white, soft	1168	- 1188	20
Sand, white, hard	1188	- 1203	15
Slate, blue, soft	1203	- 1233	30
Sand, white, soft	1233	- 1248	15
Red rock, soft	1248	- 1256	8
Slate, white, soft	1256	- 1267	11
Sand, white, hard	1267	- 1310	43
Slate and shells, hard	1310	- 1370	60
Shells, hard	1370	- 1400	30
Slate, white, soft	1400	- 1410	10
Sand, white, hard	1410	- 1490	80
Slate and shells, soft	1490	- 1570	80
Sand	1570	- 1585	15
Sand, white, hard	1585	- 1653	68
Slate, black, soft	1653	- 1683	30
Lime, white, hard	1683	- 1693	10
Sand, white, hard	1693	- 1708	15
Slate, black, soft	1708	- 1745	37
Shells, hard	1745	- 1755	10
Sand, white, hard	1755	- 1770	15
Slate, black, soft	1770	- 1775	5
Sand, white, hard	1775	- 1825	50
Lime, white, hard	1825	- 1875	50
Keener Sand, gray, hard	1875	- 1920	45
Lime, white, hard	1920	- 1980	60
Sand, white, hard	1980	- 2039	59
Sand, white, hard	2039	- 2240	201
Lime, white, hard	2240	- 2250	10
Slate and shells, white, soft	2250	- 2320	70
Sand, white, hard	2320	- 2420	100
Lime, white, hard	2420	- 2460	40
Slate and shells, white, hard	2460	- 2485	25
Lime, white, hard	2485	- 2535	50
Sand, white, hard	2535	- 2585	50
Slate and shells, white, hard	2585	- 2680	95
Sand, white, hard	2680	- 2720	40
Slate and shells, white, hard	2720	- 2750	30
Sand, white, hard	2750	- 2762	12
Slate and shells	2762	- 2787	25
Sand, white	2787	- 2792	5
Sand and shells	2792	- 2812	20
Gordon Stray Sand (gas, 2815')	2812	- 2825	13
Slate	2825	- 2830	5
Red rock	2830	- 2834	4
Sand	2834	- 2839	5
Lime	2839	- 2844	5
Red rock	2844	- 2852	8
Gordon Sand	2852	- 2870	18
Slate and shells	2870	- 2898	28
4th Sand	2898	- 2910	12
Slate and shells	2910	- 2974	64
5th Sand	2974	- 2984	10
Unrecorded, to bottom	2984	- 2998	14