

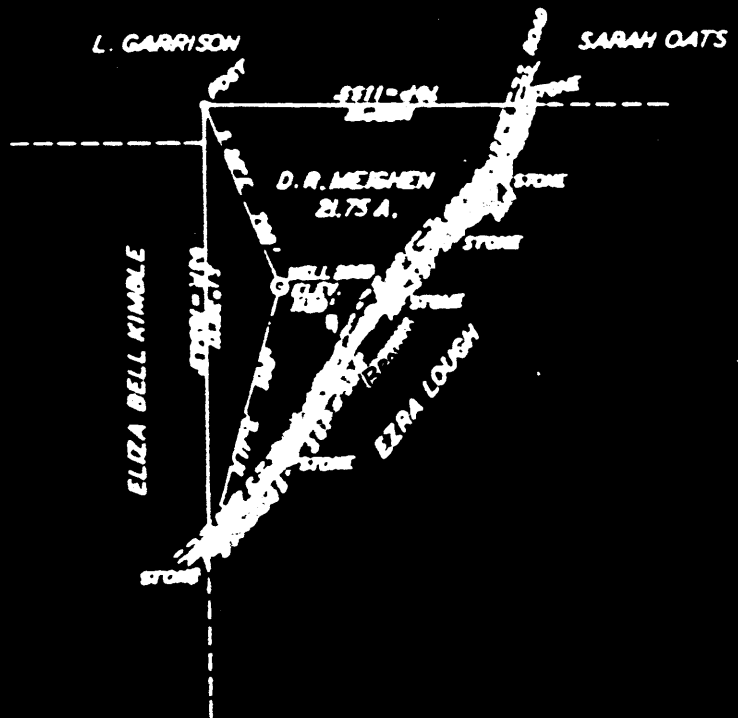

PLAT OF THE PROPOSED ABANDONMENT OF WELL NO. 2085 OF  
THE MANUFACTURERS LIGHT AND HEAT CO., OF PITTSBURGH, P.A.  
ON THE D.R. MEIGHEN FARM CONSISTING OF 21.75 ACRES  
LOCATED IN CLAY DISTRICT, WETZEL COUNTY, W. VA.

SCALE 1" = 200'



COAL OWNED BY D.L. HOOVER  
PITTSBURGH PA.

ENGINEERS CERTIFICATE

I, THE UNDERSIGNED, HEREBY CERTIFY THAT THIS MAP IS CORRECT AND SHOWS  
ALL THE INFORMATION TO THE BEST OF MY KNOWLEDGE AND BELIEF REQUIRED  
BY THE OIL AND GAS SECTION OF THE MINING LAWS OF WEST VIRGINIA.



**AFFIDAVIT IN TRIPLICATE TO TIME AND MANNER OF  
PLUGGING AND FILLING WELL**

(REQUIRED BY SECTION 2, ARTICLE 4, CHAPTER 22 OF THE CODE)

**WEST VIRGINIA DEPARTMENT OF MINES  
OIL AND GAS DIVISION**

Coal Operator or Owner: W. L. Hoover  
 Address: Waynesburg, Penna.

Name of Well Operator: The Manufacturers Light & Heat Co.  
 Complete Address: 800 Union Trust Building,  
Pittsburgh, Pa.

Date: May 11th 1936

Well and Location: Clay District  
Wetzel County

Well No. 2685

Part: D. E. Weigher

IN WITNESS WHEREOF, I have hereunto set my hand and the seal of the Department of Mines, Oil and Gas Division, at the City of Charleston, West Virginia, this 11th day of May, 1936.

**AFFIDAVIT**

STATE OF WEST VIRGINIA

County of Wetzel

Loyd W. Church and Josiah Church  
 being first duly sworn according to law depose and say that they are experienced in the work of plugging and filling oil and gas wells and were employed by The Manufacturers Light & Heat Co. Well operator and participated in the work of plugging and filling the above well, that said work was commenced on the 30th day of March, 1936, and that the well was plugged and filled in the following manner:

Manner in which sand was plugged: Clay 2156-2050, Wood plug 2050-2047, Led plug 2046, Cement 2046-2027, Pulled 6 5/8 casing, Bridged @ 1855, Clay 1855, 1744, Wood plug 1744-1741, Cement 1741-1731, Bridged @ 1630, Clay 1630, 1525, Wood plug 1522, Cement 1522-1512, Bridged @ 1355, Pulled 8 1/2" casing, Red mud 1355-1158, 1158-1155. Set bridge and vent pipe @ 846'.

Manner in which coal was plugged: Cement 846-791, Clay 791-713, Cement 713-662, Clay 662' to surface.

Description of monument: Monument erected as prescribed by law.

THE ABOVE DESCRIPTIONS MUST BE IN DETAIL AND IN ACCORDANCE WITH THE PROVISIONS OF SECTION 2, ARTICLE 4, CHAPTER 22 OF THE CODE and that the work of plugging and filling said well was completed on the 20th day of April

19 36  
 and further deponents saith not

*Loyd W. Church*