

39°46'00"

Latitude

80°25'00"

Longitude

+
1.69s
2.13w

Topo Location

7.5' Loc. _____ 15' Loc. _____
(calc.) _____

Company Hope Nat Gas

Farm RL MERRINER # 4155

15' Quad _____
(sec.)

7.5' Quad Hundred

District Church

WELL LOCATION PLAT

County 103 **Permit** 30182

No. of Station
 Date
 Name
 County, W. Va.

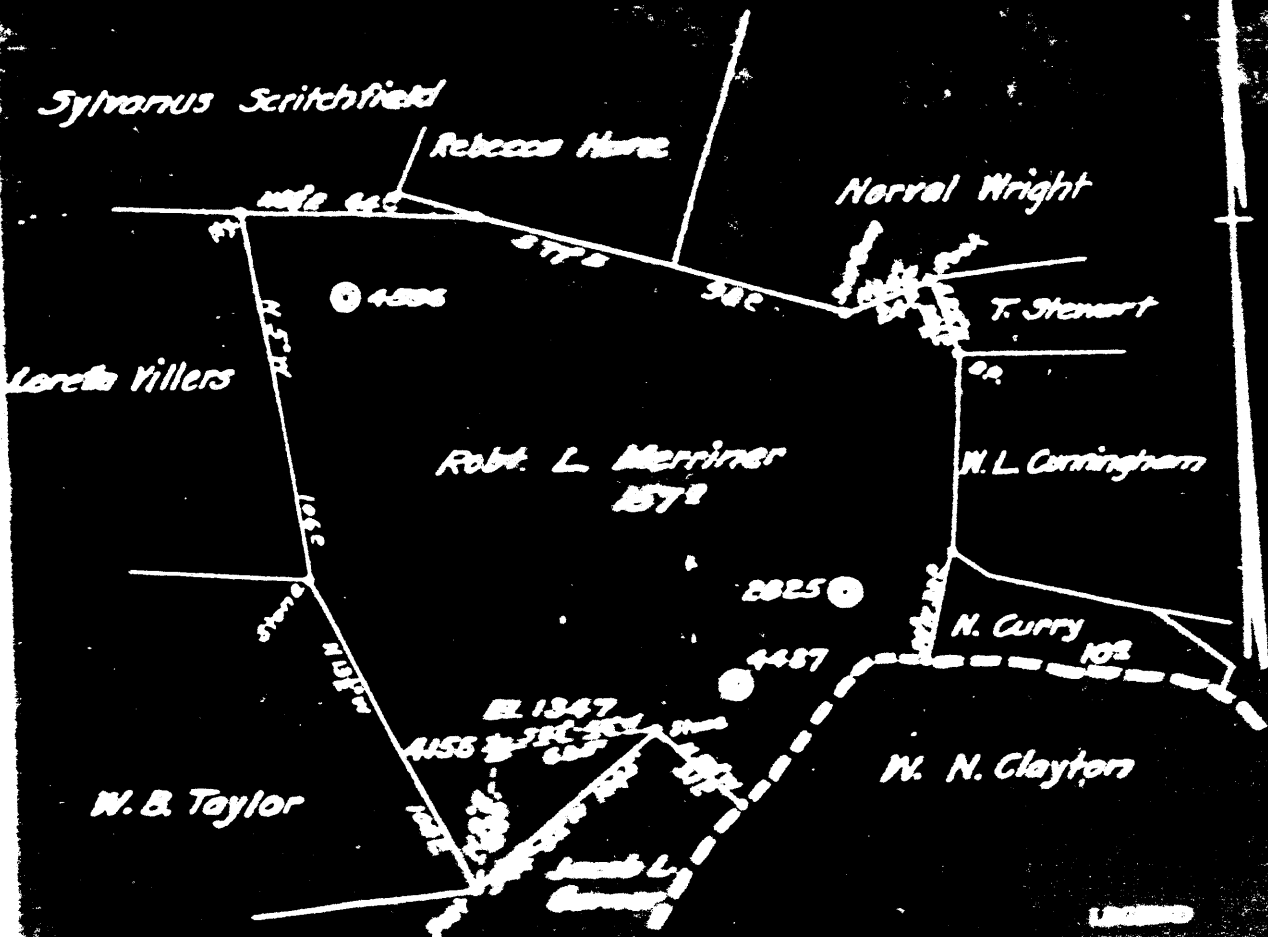

- Legend
 ● Location
 ○ Elevation
 --- Boundary

Mapleton Creek

Pittsburg Road

Murphy Sand

Section 10

100 ft

100 ft

100 ft

100 ft

100 ft

100 ft

100 ft

100 ft

100 ft

AMERICAN LUBRICATING OIL COMPANY
PLUGGING AND CEMENTING DEPARTMENT
WEST VIRGINIA DEPARTMENT
MINISTERS OF OIL

No. of well operated...
Name of well...
Coal owner...
District...
County...
4155
L. Herringer Farm

APPENDIX

STATE OF WEST VIRGINIA
County of...
Herbert E. Ayers
William C. Lambert
General Gas Company
that the well was plugged and filled in
red clay from 1184 to 1188 ft.
then placed cement plug, then filled with
cement from 1118 to 1124 ft.

...from 1184-80 feet below
...this filling also
...casing at 802 ft then put in
...casing at 457', then
...use 15 bbls this mixture and
...and was down outside of 8" casing.
...cement at 438' then filled solid
...uncovered 8" casing at this depth and
...between 8" & 10" casing, filled to surface
...extracted with Iron & Cement, size
...the surface set in a cement base