

20176

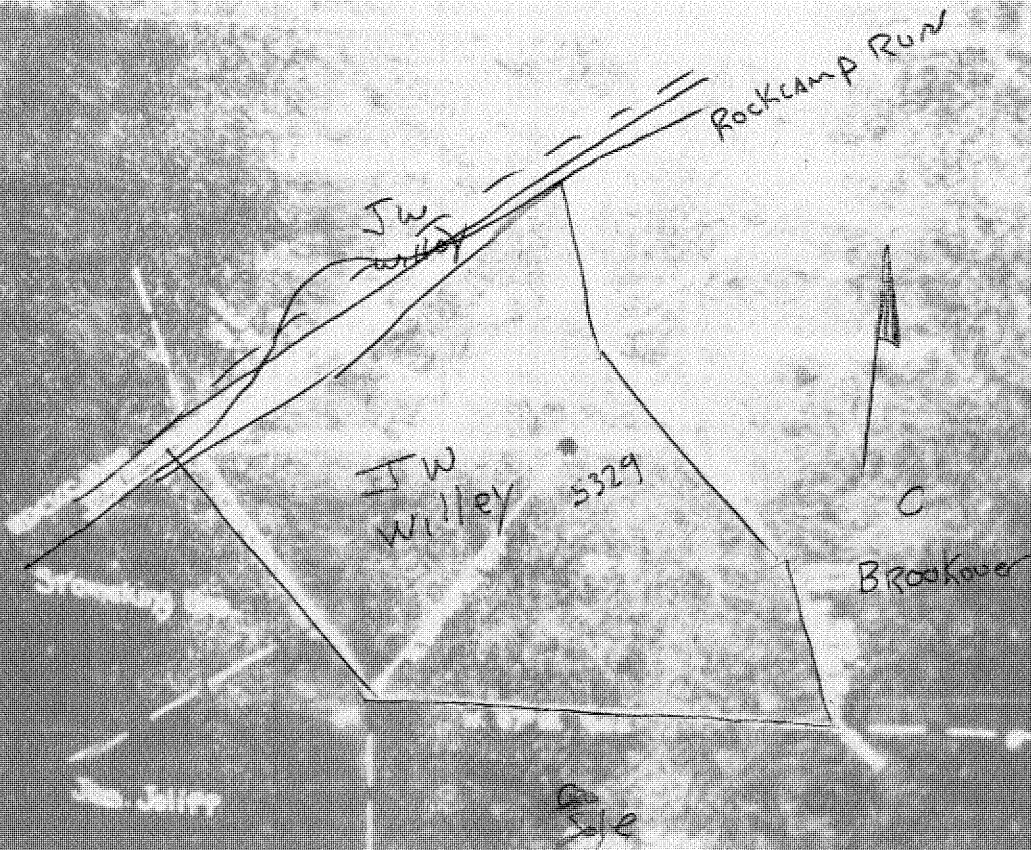

WET-176-A

Grant District, Wetzel County, W. Va.

By Pittsburgh &amp; W. Va. Gas Co., Clarksburg, W. Va.

On 21 acres (Map Ref. Littleton S.E. 2-3); surface and mineral rights owned by J. W. Willey, Jr., and Julia A. Willey, Kodol, W. Va.

Well completed 8-18-1922.

Elevation, 1078.5' L.

13" conductor, 16"; 10" casing, 413'; 8 $\frac{1}{2}$ ", 1410'; 6 $\frac{5}{8}$ ", 2053'.

Coal was encountered at 330-332, 465-468, 716-719, 815-820, 1330-1332, and 1616-1623'.

Abandonment reported to Dept. of Mines Sept. 6, 1935, &amp; Aug. 15, 1935.

Located 5-18-1922; began drilling 6-29-1922; comp. drg. 8-18-1922.

Fresh water at 100'.

Salt water at 1580 and 1702-30'.

Well was not shot.

6 $\frac{5}{8}$ " hole. Gas well.

	Top.	Bottom.	Thickness.
Red rock, soft	0	- 25	25
Slate, light, soft	25	- 50	25
Sand, light, medium (2 bailers fresh water at 100')	50	- 115	65
Red rock, soft	115	- 165	50
Sand, light, medium	165	- 205	40
Slate, light, soft	205	- 230	25
Lime, light, hard	230	- 255	25
Red rock, soft	255	- 295	40
Slate, light, soft	295	- 330	35
Coal, black, soft	330	- 332	2
Slate, light, soft	332	- 370	38
Lime, white, hard	370	- 395	25
Slate, light, medium	395	- 425	30
Lime, white, hard	425	- 430	5
Slate, dark, soft	430	- 450	20
Lime, white, hard	450	- 465	15
Coal, black, soft	465	- 468	3
Lime, white, hard	468	- 500	32
Slate, light, soft	500	- 550	50
Slate, dark, soft	550	- 565	15
Lime, light, medium	565	- 590	25
Lime, white, hard	590	- 713	123
Slate, dark, soft	713	- 716	3
Mapletown (Sewickley) Coal, black, soft	716	- 719	3
Slate, dark, soft	719	- 760	41
Lime, white, hard	760	- 812	52
Slate, dark, soft	812	- 815	3
Pittsburgh Coal, black, soft	815	- 820	5
Slate, dark, soft	820	- 825	5
Lime, white, hard	825	- 855	30
Red rock, soft	855	- 865	10
Slate, dark, soft	865	- 870	5
Lime, white, hard	870	- 875	5
Red rock, soft	875	- 880	5
Lime, white, soft	880	- 890	10
Red rock, soft	890	- 895	5
Lime, white, hard	895	- 900	5
Red rock, soft	900	- 905	5
Slate, white, soft	905	- 935	30

(OVER)

	Top.	Bottom.	Thickness.
Lime, white, hard	935	- 955	20
Sand, white, hard	955	- 1014	59
Slate, white, soft	1014	- 1024	10
Red rock, soft	1024	- 1030	6
Lime, white, hard	1030	- 1050	20
Slate, light, soft	1050	- 1060	10
Red rock, soft	1060	- 1072	12
Lime, white, hard	1072	- 1078	6
Slate, dark, soft	1078	- 1110	32
Red rock, soft	1110	- 1120	10
Slate, white, soft	1120	- 1150	30
Lime, white, hard	1150	- 1160	10
Little Dunkard Sand, white, hard	1160	- 1180	20
Shale, black, soft	1180	- 1192	12
Slate, light, soft	1192	- 1212	20
Lime, white, hard	1212	- 1242	30
Slate, dark, soft	1242	- 1250	8
Lime, white, hard	1250	- 1265	15
Shale, black, soft	1265	- 1270	5
Big Dunkard Sand, light, medium	1270	- 1285	15
Slate, light, soft	1285	- 1300	15
Lime, white, hard	1300	- 1330	30
Coal, black, soft	1330	- 1332	2
Lime, white, hard	1332	- 1405	73
1st Gas Sand, dark, hard	1405	- 1495	90
Slate, dark, soft	1495	- 1515	20
2nd Gas Sand, white, hard	1515	- 1530	15
Slate, dark, soft	1530	- 1560	30
1st Salt Sand, dark, hard (6 bailers salt water at 1580')	1560	- 1616	56
Coal, black, soft	1616	- 1623	7
Lime, white, hard	1623	- 1630	7
Slate, dark, soft	1630	- 1640	10
Lime, light, hard	1640	- 1650	10
Shale and slate, dark, medium	1650	- 1690	40
3rd Salt Sand, white, hard (salt water, 1702-30')	1690	- 1775	85
Slate, dark, medium	1775	- 1780	5
Lime, white, hard	1780	- 1790	10
Shells and slate, dark, medium	1790	- 1800	10
Sand, white, hard	1800	- 1890	90
Lime, dark, hard	1890	- 1905	15
Red rock, pink, soft	1905	- 1907	2
Lime, light, hard	1907	- 1915	8
Red rock, soft	1915	- 1925	10
Lime, white, hard	1925	- 2005	80
Slate, dark, soft	2005	- 2019	14
Little Lime, white, hard	2019	- 2025	6
Pencil Cave, dark, soft	2025	- 2029	4
Big Lime, white, hard	2029	- 2100	71
Big Injun Sand, light, hard	2100	- 2215	115
Slate, dark, soft	2215	- 2218	3
Sand, dark, hard	2218	- 2280	62
Slate, dark, soft	2280	- 2340	60
Lime, light, hard	2340	- 2395	55
Slate, dark, soft	2395	- 2415	20
Lime, light, hard	2415	- 2445	30

	Top.	Bottom.	Thickness.
Slate, dark, soft	2445	- 2465	20
Lime, light, hard	2465	- 2505	40
Slate, dark, soft	2505	- 2540	35
Lime, light, hard	2540	- 2600	60
Slate, light, soft	2600	- 2690	90
Lime, light, hard	2690	- 2715	25
Slate, dark, soft	2715	- 2730	15
Lime, light, hard	2730	- 2780	50
Slate, dark, soft	2780	- 2810	30
Lime, light, hard	2810	- 2825	15
Slate, dark, soft	2825	- 2855	30
Gordon Stray Sand, dark, hard	2855	- 2885	30
Slate, dark, soft	2885	- 2927	42
Gordon Sand, light, hard	2927	- 2942	15
Slate, dark, soft	2942	- 2990	48
4th Sand, light, hard (gas, 2993-96')	2990	- 3000	10
Slate, dark, soft	3000	- 3048	48
5th Sand, light, medium	3048	- 3051	3
Shells and slate, light, hard and soft	3051	- 3135	84
Total depth		3135	