

30082

Grant

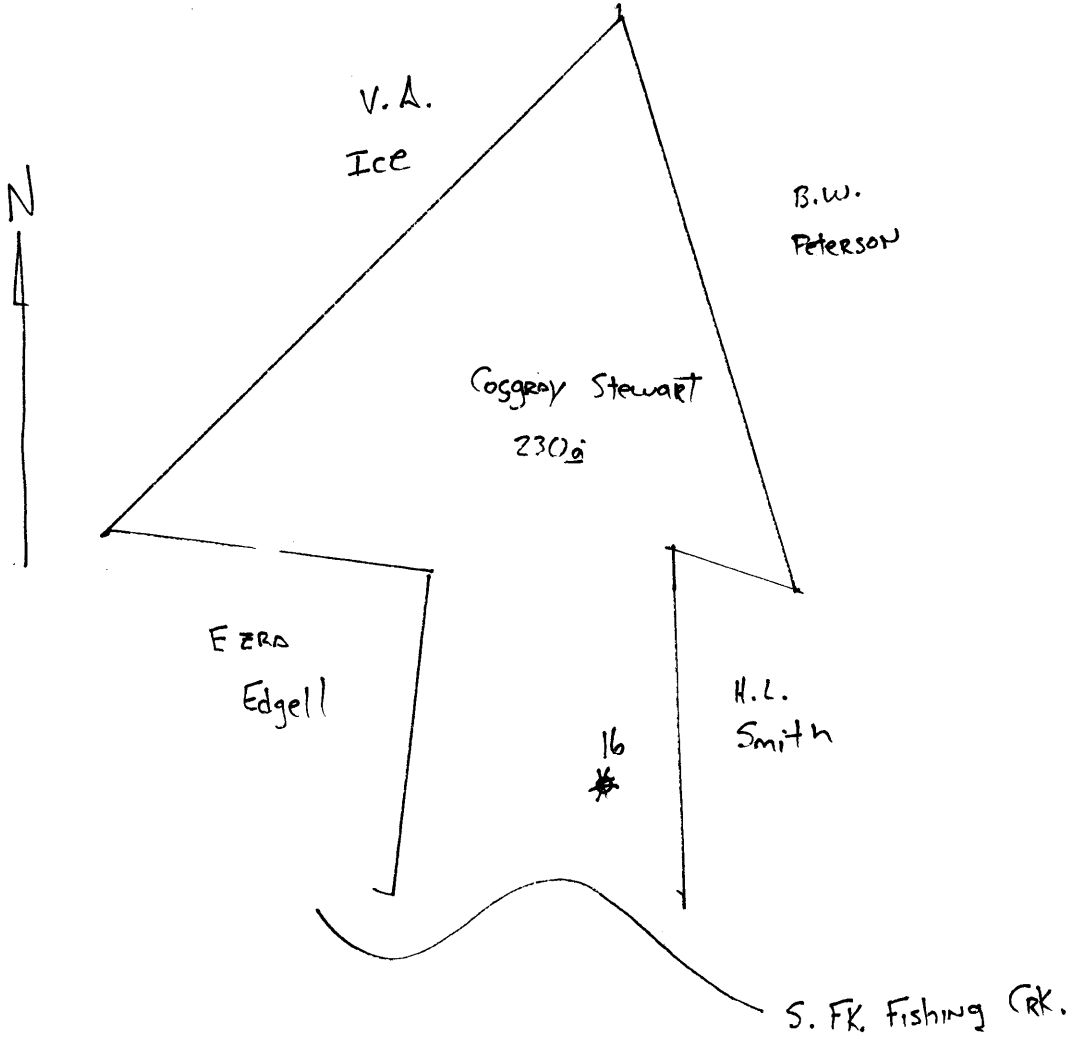

Grant District, Wetzel County, W. Va.
 By South Penn Oil Co., Drawer 1255, Pittsburgh, Pa.
 On 230 acres, surface and minerals owned by W. D. Cosgray,
 Lawrenceville, Kansas.

Elevation, 1104' L.
 16' conductor; 10" casing, 345'; 8 1/2", 1400'; 6-5/8", 2152';
 5-3/16", 2670'.

Coal was encountered at 890-900'.
 Abandonment reported to Dept. of Mines June 23, 1932.
 Well was shot May 31, 1917, with 30 qts., and May 24, 1920,
 with 40 qts.

Oil well.

	Top.	Bottom.
Conductor	0	16
Pittsburgh Coal	890	900
Little Dunkard Sand	1215	1240
Gas Sand	1315	1665
1st Salt Sand	1690	1735
2nd Salt Sand	1890	1942
Little Lime	2118	2130
Pencil Cave	2130	2140
Big Lime	2140	2200
Big Injun Sand (water and oil, 2285')	2200	2375
50-Ft. Sand	2700	2720
Stray Sand	2920	2948
Gordon Sand (oil, 3000-3003')	2997	
Total depth		3010

WET-82-A