

Latitude

Longitude



Topo Location

7.5' Loc. _____ 15' Loc. _____
 _____ (calc.) _____

Company Hope Nat Gas Co

Farm MARY ANN HOGE #4746

15' Quad _____
(sec.)

7.5' Quad PINE GROVE

District GRANT

WELL LOCATION PLAT

County 103 Permit 30073

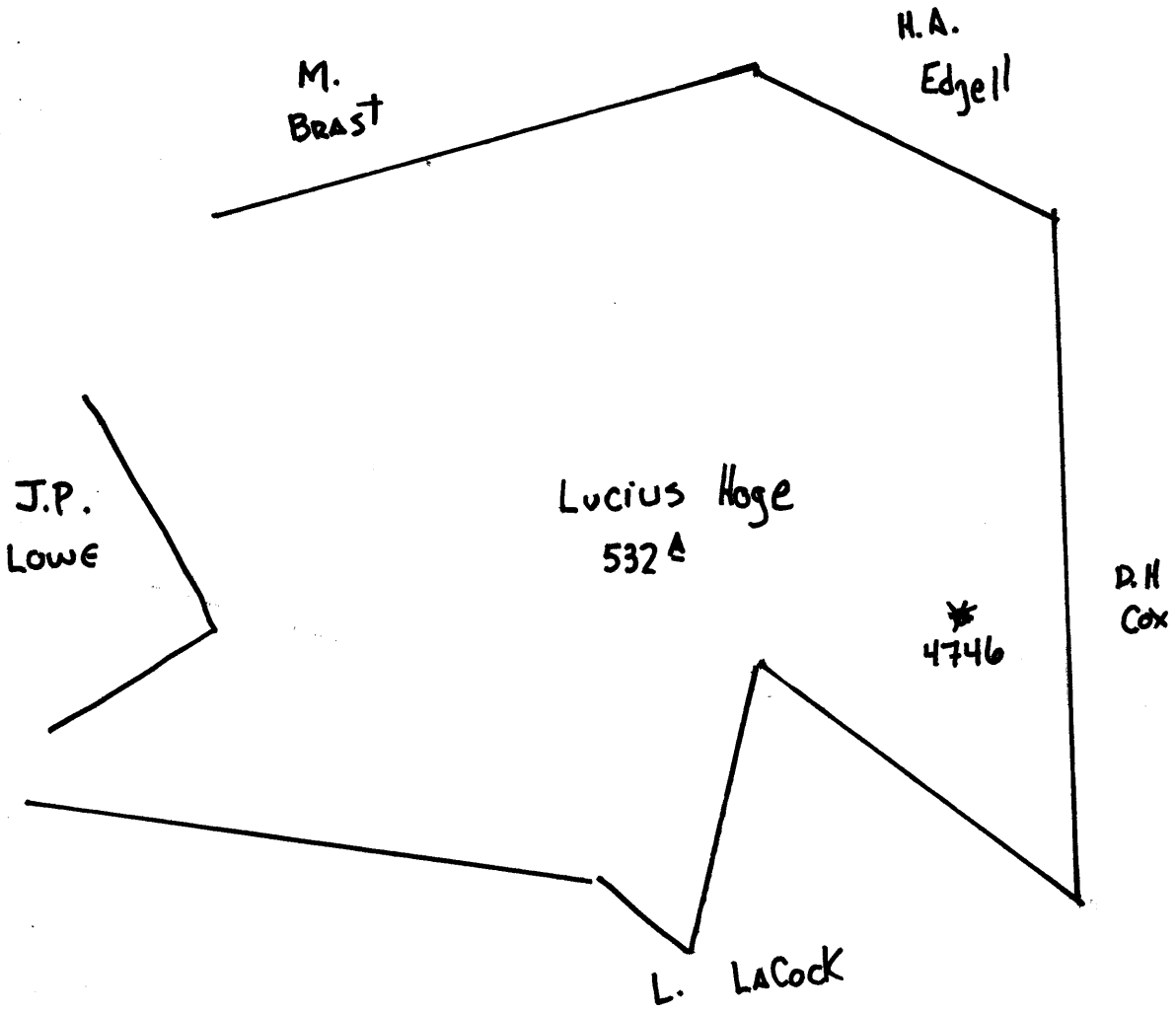

Grant District, Wetzel County, W. Va.
 By Hope Natural Gas Co., 445 W. Main St., Clarksburg, W. Va.
 On 532 acres, surface owned by Lucius Hoge Heirs.
 Elevation, 1252' L.
 8 1/4" casing, 1504'; 6-5/8", 2197'.
 Coal was encountered at 455-460 and 939-946'.
 Abandonment reported to Dept. of Mines Dec. 28, 1931.
 No record of shot.
 Salt water at 2110'; no record of fresh water.
 Gas well; now exhausted to extent of not being commercially
 productive.

WET-73-A

	Top.	Bottom.	Thickness.
Native coal	455	- 460	5
Pittsburgh Coal	939	- 946	7
Gas Sand	1550	- 1585	35
Sand	1619	- 1685	66
First Salt Sand	1710	- 1730	20
Second Salt Sand	1755	- 1790	35
Sand	1850	- 1980	130
Maxton Sand (salt water, 2110')	2105	- 2125	20
Little Lime	2127	- 2137	10
Pencil Cave	2150	- 2155	5
Big Lime	2155	- 2205	50
Big Injun Sand	2205	- 2400	195
Squaw Sand (show gas, 2432')	2410	- 2445	35
Berea Sand	2587	- 2632	45
50-Ft. Sand	2775	- 2805	30
Gordon Stray Sand	2998		
Gordon Sand (gas, 3027-3030')		3040	
Total depth		3067	