

LATITUDE 39° 32' 30" TH: 7,300'

LATITUDE 39° 32' 30" BH: 9,470'

Tesla 5H
Tesla
EQT Production Company



NOTES ON SURVEY

1. COORDINATES SYSTEM IS UTM, NAD 83 DATUM, ZONE 17, U.S. FOOT AND WELL COORDINATES ESTABLISHED USING SURVEY GRADE GPS.
2. SURFACE AND ROYALTY OWNER INFORMATION AND THEIR BOUNDARIES SHOWN HEREON WERE PLOTTED FROM DEEDS AND/OR TAX PARCEL MAPS PROVIDED BY CLIENT AND FIELD LOCATIONS.
3. THIS PLAT DOES NOT REPRESENT A BOUNDARY SURVEY OF THE PARCELS SHOWN HEREON.
4. NO DWELLINGS AND BUILDINGS WITHIN 625 FEET OF PROPOSED CENTER OF PAD.
5. NO WATER WELLS OR DEVELOPED SPRINGS WITHIN 250 FEET OF PROPOSED WELL.
6. NO PERENNIAL STREAMS, LAKES, PONDS, RESERVOIRS OR WETLANDS WITHIN 100 FEET OF THE LIMITS OF DISTURBANCE.
7. NO NATURALLY PRODUCING TROUT STREAM WITHIN 300 FEET OF LIMITS OF DISTURBANCE.

LEGEND

- Active Well Location
- Plugged Well Location
- Abandoned Well
- Surface Tract Identification
- Proposed Gas Well
- Located Corner, as noted
- Surface Tract Lines (Surveyed)
- Surface Tract Lines (Tax Map)
- Reference Line
- Lease Boundary
- Creek or Drain
- WV County Route
- WV State Route

() Denotes Location of Well on United States Topographic Maps



I, the undersigned, hereby certify that this plat is correct to the best of my knowledge and belief and shows all the information required by law and the regulations issued and prescribed by the Department of Environmental Protection.

L. L. S. 2394
L. L. S. 2394

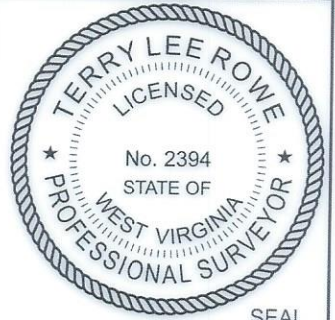

SEAL

FILE NO: _____
 DRAWING NO: _____
 SCALE: 1" = 2000'
 MINIMUM DEGREE OF ACCURACY: 1:2500
 PROVEN SOURCE OF ELEVATION: NGS CORS Station



DATE: MARCH 26 20 24
 OPERATORS WELL NO: Tesla 5H
 API WELL NO: 47 - 103 - 03662
 STATE COUNTY PERMIT

WELL TYPE: OIL GAS LIQUID INJECTION WASTE DISPOSAL
 (IF GAS) PRODUCTION: STORAGE DEEP SHALLOW

LOCATION ELEVATION: 1320' WATERSHED: Fishing Creek QUADRANGLE: Glover Gap
 DISTRICT: Grant COUNTY: Wetzel

SURFACE OWNER: Harrison County Coal Resources & EQT Production Company ACREAGE: 05/31/2024
 ROYALTY OWNER: William M. Peterson, Jr., et al. LEASE NO: 129822001 ACREAGE: 4,564 ±

PROPOSED WORK: DRILL CONVERT DRILL DEEPER FRACTURE OR STIMULATE PLUG OFF OLD FORMATION
 PERFORATE NEW FORMATION OTHER PHYSICAL CHANGE IN WELL (SPECIFY)

PLUG AND ABANDON CLEAN OUT AND REPLUG TARGET FORMATION: Marcellus ESTIMATED DEPTH: 7,644'

WELL OPERATOR: EQT Production Company DESIGNATED AGENT: Joseph C Mallow
 ADDRESS: 400 Woodcliff Drive ADDRESS: 427 Midstate Drive
 Canonsburg, PA 15317 Clarksburg, WV 26301

**Tesla 5H
Tesla
EQT Production Company**

Tract ID.	Tax Map No.	Parcel No.	County	District	Surface Tract Owner	Acres
1	31	1.0	Wetzel	Grant	Harrison County Coal Resources & EQT Production Company	47.30
2	31	2.0	Wetzel	Grant	Consolidation Coal Company	29.00
3	30	13.0	Wetzel	Grant	Brooks Lee & Lisa Kay Brown	75.00
4	31	2.2	Wetzel	Grant	Smith H L EST	26.00
5	30	12.0	Wetzel	Grant	Joseph Rex Smith	92.12
6	30	38.0	Wetzel	Grant	Dallison Lumber INC	137.80

Lease	Owner	Acres
129822001	William M. Peterson, Jr., et al.	4,564 ac
175061000	OXY USA Inc., et al.	5.50 ac of 31,151.581 ac
136839005	Country Roads Minerals, LLC, et al.	76 ac
121441000	Stone Hill Minerals Holdings, LLC, et al.	92.12 ac of 14,054.30 ac

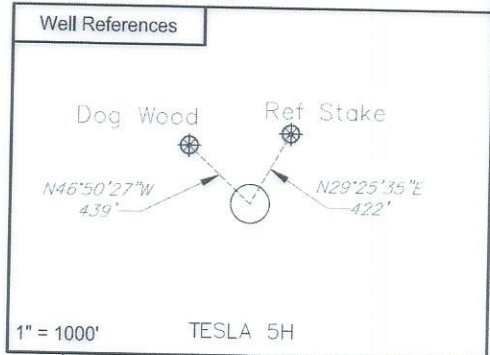
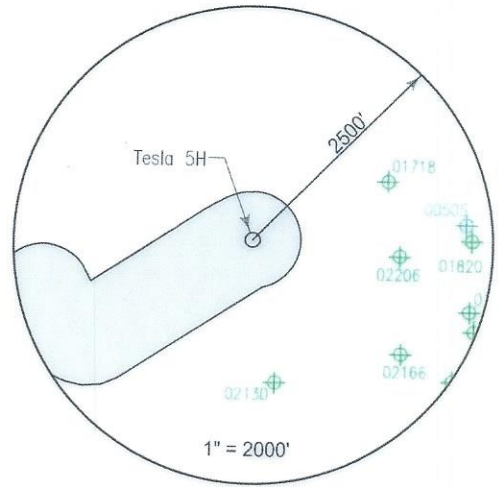

Notes:
 TESLA 5H coordinates are
 NAD 27 N: 370,505.077 E: 1,722,275.763
 NAD 27 Lat: 39.513076 Long: -80.484390
 NAD 83 UTM N: 4,373,852.113 E: 544,339.538

TESLA 5H Bottom Hole coordinates are
 NAD 27 N: 369,928.044 E: 1,720,098.404
 NAD 27 Lat: 39.511426 Long: -80.492084
 NAD 83 UTM N: 4,373,665.247 E: 543,679.104

West Virginia Coordinates system of 1927 (North Zone)
 based upon Differential GPS Measurements
 Plat orientation, Corner and well ties are based upon
 the grid north meridian
 Well location references are based upon the grid north
 meridian.
 UTM coordinates are NAD83, Zone 17, Meters.

- TESLA PAD**
- TESLA 17H ○
 - TESLA 15H ○
 - TESLA 13H ○
 - TESLA 11H ○
 - TESLA 9H ○
 - TESLA 7H ○
 - TESLA 5H ○
 - TESLA 3H ○
 - TESLA 1H ○



I, the undersigned, hereby certify that this plat is correct to the best of my knowledge and belief and shows all the information required by law and the regulations issued and prescribed by the Department of Environmental Protection.

L. L. S. 2394

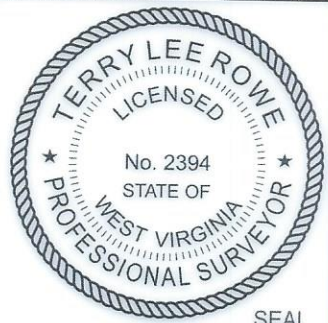

FILE NO: _____
 DRAWING NO: _____
 SCALE: 1" = 1000'
 MINIMUM DEGREE OF ACCURACY: 1:2500
 PROVEN SOURCE OF ELEVATION: NGS CORS Station



DATE: MARCH 26 20 24
 OPERATORS WELL NO: Tesla 5H
 API WELL NO: 47 - 103 - 03662
 STATE COUNTY PERMIT

WELL TYPE: OIL GAS LIQUID INJECTION WASTE DISPOSAL
 (IF GAS) PRODUCTION: STORAGE DEEP SHALLOW

LOCATION ELEVATION: 1320' WATERSHED: Fishing Creek QUADRANGLE: Glover Gap
 DISTRICT: Grant COUNTY: Wetzel

SURFACE OWNER: Harrison County Coal Resources & EQT Production Company ACREAGE: 47.3 ±
 ROYALTY OWNER: William M. Peterson, Jr., et al. LEASE NO: 129822001 ACREAGE: 4,564 ±

PROPOSED WORK: DRILL CONVERT DRILL DEEPER FRACTURE OR STIMULATE PLUG OFF OLD FORMATION
 PERFORATE NEW FORMATION OTHER PHYSICAL CHANGE IN WELL (SPECIFY) _____
 PLUG AND ABANDON CLEAN OUT AND REPLUG TARGET FORMATION: Marcellus ESTIMATED DEPTH: 7,644'

WELL OPERATOR: EQT Production Company DESIGNATED AGENT: Joseph C Mallow
 ADDRESS: 400 Woodcliff Drive ADDRESS: 427 Midstate Drive
 Canonsburg, PA 15317 Clarksburg, WV 26301

05/31/2024