

Location: Wetzel County, WV

Slot: 6H

Field: Wetzel

Well: Constance Taylor Wtz 6H

Facility: Constance Taylor Wtz Pad

Wellbore: Constance Taylor Wtz 6H AWB

Plot reference wellpath is Constance Taylor Wtz 6H awp Proj: 22038

Grid System: NAD83 / UTM Zone 17 North, US feet

True vertical depths are referenced to SDC 40 (KB)

* = Wellpath was transformed from a different geodetic datum

Reference wellpath measured depths are referenced to SDC 40 (KB)

North Reference: Grid north

SDC 40 (KB) to Mean Sea Level: 1456.2 feet

Scale: True distance

Mean Sea Level to Ground level (At Slot: 6H): -1430.2 feet

Coordinates are in feet referenced to Slot

Offset wellpath MDs are referenced to each path's default MD datum

Depths are in feet

Created by: tranlam on 2024-02-05; Database: WA_MPL_EASTERLUS_Defn

Location Information

Facility Name			Grid East (US ft)	Grid North (US ft)	Latitude	Longitude
Constance Taylor Wtz Pad			1730676.583	14401131.208	39°39'16.6280"N	80°40'45.5230"W
Slot	Local N (ft)	Local E (ft)	Grid East (US ft)	Grid North (US ft)	Latitude	Longitude
6H	-49.83	36.88	1730713.450	14401081.400	39°39'16.1343"N	80°40'45.0537"W
SDC 40 (KB) to Ground level (At Slot: 6H)					26ft	
Mean Sea Level to Ground level (At Slot: 6H)					-1430.2ft	
SDC 40 (KB) to Mean Sea Level					1456.2ft	

Bottom Hole Location

MD (ft)	Inc (°)	Az (°)	TVD (ft)	Local N (ft)	Local E (ft)	Grid East (US ft)	Grid North (US ft)	Latitude	Longitude
22038.00	89.750	137.760	7553.66	-10460.27	9523.79	1740233.50	14390625.24	39°37'32.4031"N	80°38'43.8169"W

API: 47103036080000
 BH JOB: 112077229
 DURATION: 02.02.2024 to 02.04.2024
 RIG: SDC 40

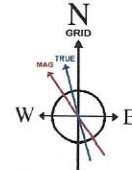

User specified Dip: 66.33° Field: 51502 nT
 Magnetic North is 8.31 degrees West of True North (at 1/23/2024)
 Grid North is 0.20 degrees East of True North
 To correct azimuth from True to Grid subtract 0.20 degrees
 To correct azimuth from Magnetic to Grid subtract 8.51 degrees

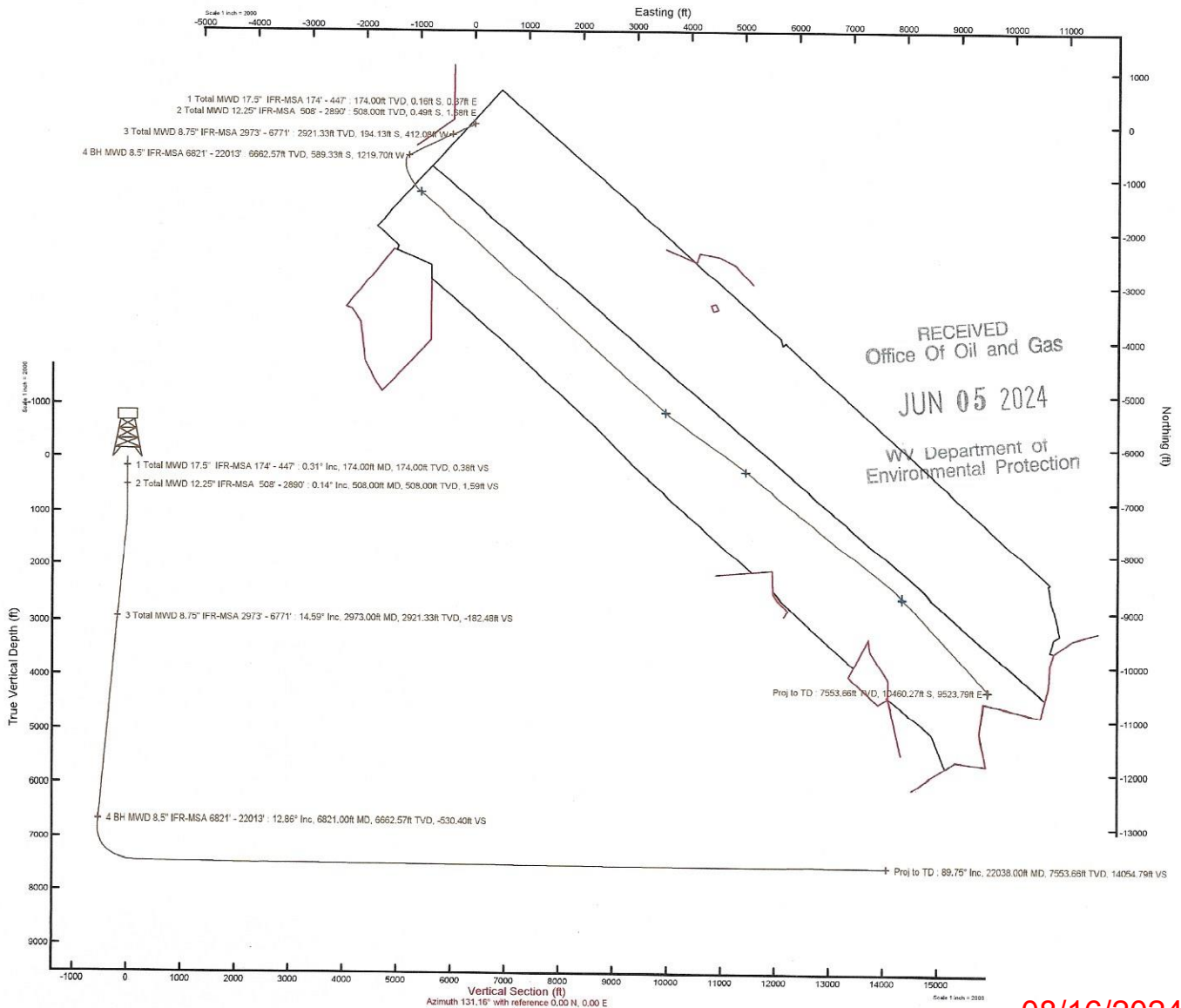

08/16/2024

REFERENCE WELLPATH IDENTIFICATION			
Operator	SWN PRODUCTION COMPANY, LLC	Well	Constance Taylor WTZ 6H
Field	Wetzel	API	47103036080000
Facility	Constance Taylor WTZ Pad	Wellbore	Constance Taylor WTZ 6H AWB
Slot	6H		

REPORT SETUP INFORMATION			
Projection System	NAD83 / UTM Zone 17 North, US feet	Software System	WellArchitect® 6.0
North Reference	Grid	User	Tranlam
Scale	0.999609	Report Generated	2/5/2024 at 11:13:11 AM
Convergence at slot	0.20° East	Database	WA_MPL_EASTERNUS_Defn

WELLPATH LOCATION						
	Local coordinates		Grid coordinates		Geographic coordinates	
	North[ft]	East[ft]	Easting[US ft]	Northing[US ft]	Latitude	Longitude
Slot Location	-49.83	36.88	1730713.45	14401081.40	39°39'16.1343"N	80°40'45.0537"W
Facility Reference Pt			1730676.58	14401131.21	39°39'16.6280"N	80°40'45.5230"W
Field Reference Pt			0.00	0.00	0°00'0.0000"	85°29'19.4780"W

WELLPATH DATUM			
Calculation method	Minimum curvature	SDC 40 (KB) to Facility Vertical Datum	1456.20ft
Horizontal Reference Pt	Slot	SDC 40 (KB) to Mean Sea Level	1456.20ft
Vertical Reference Pt	SDC 40 (KB)	SDC 40 (KB) to Ground Level at Slot (6H)	26.00ft
MD Reference Pt	SDC 40 (KB)	Section Origin	N 0.00, E 0.00 ft
Field Vertical Reference	Mean Sea Level	Section Azimuth	131.16°

APPROVED
 Environmental Protection
 Department of
 Natural Resources
 and Gas
 2024

REFERENCE WELLPATH IDENTIFICATION			
Operator	SWN PRODUCTION COMPANY, LLC	Well	Constance Taylor WTZ 6H
Field	Wetzel	API	47103036080000
Facility	Constance Taylor WTZ Pad	Wellbore	Constance Taylor WTZ 6H AWB
Slot	6H		

WELLPATH DATA (235 stations) † = interpolated, ‡ = extrapolated station

MD [ft]	Inclination [°]	Azimuth [°]	TVD [ft]	Vert Sect [ft]	North [ft]	East [ft]	Grid East [US ft]	Grid North [US ft]	Latitude	Longitude	Closure Dist [ft]	Closure Dir [°]	DLS ["/100ft]
0.00†	0.000	113.400	0.00	0.00	0.00	0.00	1730713.45	14401081.40	39°39'16.1343"N	80°40'45.0537"W	0.00	0.000	0.00
26.00	0.000	113.400	26.00	0.00	0.00	0.00	1730713.45	14401081.40	39°39'16.1343"N	80°40'45.0537"W	0.00	0.000	0.00
174.00	0.310	113.400	174.00	0.38	-0.16	0.37	1730713.82	14401081.24	39°39'16.1327"N	80°40'45.0490"W	0.40	113.400	0.21
235.00	0.390	107.050	235.00	0.73	-0.29	0.72	1730714.17	14401081.11	39°39'16.1314"N	80°40'45.0446"W	0.77	111.696	0.15
327.00	0.200	120.610	327.00	1.17	-0.46	1.15	1730714.60	14401080.94	39°39'16.1297"N	80°40'45.0390"W	1.24	111.674	0.22
400.00	0.170	114.300	400.00	1.40	-0.57	1.36	1730714.81	14401080.83	39°39'16.1286"N	80°40'45.0363"W	1.48	112.634	0.05
477.00	0.230	55.460	477.00	1.55	-0.53	1.59	1730715.04	14401080.87	39°39'16.1290"N	80°40'45.0334"W	1.68	108.313	0.26
508.00	0.140	83.480	508.00	1.59	-0.49	1.68	1730715.13	14401080.91	39°39'16.1294"N	80°40'45.0322"W	1.75	106.172	0.40
600.00	0.350	73.100	600.00	1.81	-0.39	2.06	1730715.51	14401081.01	39°39'16.1303"N	80°40'45.0274"W	2.10	100.801	0.23
691.00	0.430	217.990	690.99	1.98	-0.58	2.12	1730715.57	14401080.82	39°39'16.1284"N	80°40'45.0267"W	2.20	105.355	0.82
781.00	1.700	226.490	780.98	1.87	-1.77	0.94	1730714.39	14401079.63	39°39'16.1168"N	80°40'45.0417"W	2.00	151.899	1.42
873.00	3.350	231.340	872.88	1.27	-4.39	-2.15	1730711.31	14401077.02	39°39'16.0910"N	80°40'45.0814"W	4.88	206.061	1.81
961.00	5.400	232.710	960.62	-0.01	-8.50	-7.45	1730706.01	14401072.90	39°39'16.0505"N	80°40'45.1493"W	11.30	221.220	2.33
1050.00	7.650	235.230	1049.04	-2.29	-14.42	-15.65	1730697.81	14401066.99	39°39'15.9923"N	80°40'45.2544"W	21.28	227.341	2.55
1141.00	8.960	236.620	1139.09	-5.65	-21.77	-26.54	1730686.92	14401059.64	39°39'15.9200"N	80°40'45.3941"W	34.33	230.637	1.46
1231.00	10.600	241.860	1227.78	-10.45	-29.53	-39.69	1730673.77	14401051.88	39°39'15.8438"N	80°40'45.5626"W	49.47	233.350	2.07
1319.00	12.320	246.130	1314.02	-17.27	-37.15	-55.42	1730658.05	14401044.27	39°39'15.7691"N	80°40'45.7640"W	66.72	236.164	2.18
1411.00	13.150	248.670	1403.76	-26.25	-44.93	-74.14	1730639.34	14401036.49	39°39'15.6929"N	80°40'46.0037"W	86.69	238.785	1.09
1502.00	14.280	247.170	1492.16	-35.95	-53.05	-94.13	1730619.36	14401028.37	39°39'15.6133"N	80°40'46.2596"W	108.05	240.596	1.30
1590.00	14.770	244.470	1577.35	-45.15	-62.09	-114.25	1730599.24	14401019.33	39°39'15.5246"N	80°40'46.5173"W	130.04	241.477	0.95
1682.00	13.360	245.590	1666.59	-54.19	-71.54	-134.52	1730578.99	14401009.89	39°39'15.4320"N	80°40'46.7768"W	152.36	241.994	1.56
1772.00	13.470	247.660	1754.13	-63.17	-79.82	-153.68	1730559.83	14401001.61	39°39'15.3508"N	80°40'47.0222"W	173.17	242.552	0.55
1865.00	13.500	246.340	1844.57	-72.62	-88.30	-173.64	1730539.88	14400993.14	39°39'15.2678"N	80°40'47.2778"W	194.80	243.047	0.33
1957.00	13.340	245.790	1934.06	-81.61	-96.96	-193.16	1730520.37	14400984.48	39°39'15.1829"N	80°40'47.5277"W	216.13	243.345	0.22
2048.00	13.290	246.170	2022.61	-90.41	-105.49	-212.30	1730501.23	14400975.95	39°39'15.0992"N	80°40'47.7729"W	237.06	243.578	0.11
2140.00	13.120	245.650	2112.18	-99.21	-114.07	-231.49	1730482.06	14400967.38	39°39'15.0151"N	80°40'48.0186"W	258.06	243.768	0.23
2230.00	13.290	244.160	2199.80	-107.48	-122.79	-250.10	1730463.45	14400958.66	39°39'14.9296"N	80°40'48.2570"W	278.62	243.851	0.42
2321.00	13.690	243.110	2288.29	-115.59	-132.22	-269.12	1730444.44	14400949.24	39°39'14.8371"N	80°40'48.5005"W	299.84	243.836	0.52
2412.00	13.590	241.660	2376.72	-123.36	-142.16	-288.13	1730425.43	14400939.29	39°39'14.7395"N	80°40'48.7441"W	321.30	243.739	0.39
2502.00	13.660	242.710	2464.19	-130.97	-152.05	-306.88	1730406.69	14400929.41	39°39'14.6424"N	80°40'48.9843"W	342.49	243.643	0.29

REFERENCE WELLPATH IDENTIFICATION			
Operator	SWN PRODUCTION COMPANY, LLC	Well	Constance Taylor Wtz 6H
Field	Wetzel	API	47103036080000
Facility	Constance Taylor Wtz Pad	Wellbore	Constance Taylor Wtz 6H AWB
Slot	6H		

WELLPATH DATA (235 stations)													
MD [ft]	Inclination [°]	Azimuth [°]	TVD [ft]	Vert Sect [ft]	North [ft]	East [ft]	Grid East [US ft]	Grid North [US ft]	Latitude	Longitude	Closure Dist [ft]	Closure Dir [°]	DLS [°/100ft]
2593.00	13.690	247.400	2552.61	-139.68	-161.12	-326.38	1730387.20	14400920.34	39°39'14.5535"N	80°40'49.2339"W	363.98	243.726	1.22
2683.00	13.690	250.930	2640.06	-149.67	-168.69	-346.27	1730367.31	14400912.78	39°39'14.4793"N	80°40'49.4886"W	385.18	244.027	0.93
2774.00	13.840	250.440	2728.44	-160.34	-175.85	-366.71	1730346.89	14400905.62	39°39'14.4092"N	80°40'49.7502"W	406.69	244.380	0.21
2890.00	14.320	247.630	2840.96	-173.52	-185.96	-393.05	1730320.56	14400895.52	39°39'14.3103"N	80°40'50.0874"W	434.82	244.680	0.72
2973.00	14.590	245.910	2921.33	-182.48	-194.13	-412.08	1730301.53	14400887.34	39°39'14.2302"N	80°40'50.3312"W	455.52	244.775	0.61
3066.00	13.840	246.010	3011.49	-192.06	-203.44	-432.94	1730280.68	14400878.04	39°39'14.1390"N	80°40'50.5983"W	478.35	244.831	0.81
3157.00	13.160	244.970	3099.97	-200.81	-212.24	-452.27	1730261.36	14400869.24	39°39'14.0526"N	80°40'50.8458"W	499.59	244.860	0.79
3248.00	12.490	242.730	3188.70	-208.61	-221.14	-470.40	1730243.23	14400860.35	39°39'13.9654"N	80°40'51.0780"W	519.79	244.822	0.92
3340.00	12.850	244.230	3278.46	-216.28	-230.14	-488.46	1730225.18	14400851.35	39°39'13.8770"N	80°40'51.3093"W	539.96	244.772	0.53
3433.00	13.490	245.870	3369.01	-224.86	-239.07	-507.67	1730205.98	14400842.42	39°39'13.7894"N	80°40'51.5553"W	561.15	244.783	0.80
3525.00	13.330	242.630	3458.51	-233.23	-248.33	-526.88	1730186.77	14400833.16	39°39'13.6986"N	80°40'51.8014"W	582.47	244.764	0.83
3614.00	13.470	244.000	3545.08	-241.01	-257.60	-545.31	1730168.35	14400823.91	39°39'13.6077"N	80°40'52.0374"W	603.09	244.715	0.39
3702.00	13.670	245.150	3630.63	-249.22	-266.46	-563.96	1730149.71	14400815.05	39°39'13.5207"N	80°40'52.2762"W	623.74	244.710	0.38
3794.00	13.590	243.800	3720.04	-257.80	-275.80	-583.52	1730130.16	14400805.71	39°39'13.4291"N	80°40'52.5268"W	645.42	244.702	0.36
3882.00	13.600	242.080	3805.57	-265.47	-285.21	-601.94	1730111.75	14400796.30	39°39'13.3368"N	80°40'52.7627"W	666.09	244.648	0.46
4064.00	14.070	241.570	3982.29	-280.83	-305.76	-640.30	1730073.40	14400775.76	39°39'13.1350"N	80°40'53.2541"W	709.56	244.474	0.27
4152.00	13.930	243.460	4067.68	-288.58	-315.59	-659.19	1730054.52	14400765.94	39°39'13.0386"N	80°40'53.4960"W	730.83	244.417	0.54
4241.00	13.920	243.480	4154.06	-296.71	-325.15	-678.35	1730035.37	14400756.38	39°39'12.9447"N	80°40'53.7414"W	752.25	244.390	0.01
4332.00	14.180	244.320	4242.34	-305.25	-334.87	-698.19	1730015.54	14400746.66	39°39'12.8493"N	80°40'53.9955"W	774.34	244.376	0.36
4422.00	14.250	243.740	4329.58	-313.84	-344.55	-718.06	1729995.68	14400736.99	39°39'12.7544"N	80°40'54.2499"W	796.44	244.367	0.18
4512.00	14.170	243.630	4416.83	-322.30	-354.34	-737.86	1729975.88	14400727.20	39°39'12.6583"N	80°40'54.5036"W	818.53	244.348	0.09
4604.00	13.280	244.390	4506.20	-330.77	-363.91	-757.48	1729956.27	14400717.63	39°39'12.5644"N	80°40'54.7548"W	840.36	244.339	0.99
4695.00	13.230	242.310	4594.78	-338.65	-373.27	-776.12	1729937.63	14400708.28	39°39'12.4726"N	80°40'54.9936"W	861.22	244.315	0.53
4786.00	12.960	240.990	4683.41	-345.87	-383.05	-794.27	1729919.49	14400698.50	39°39'12.3765"N	80°40'55.2261"W	881.81	244.253	0.44
4877.00	12.530	242.850	4772.17	-352.98	-392.51	-811.98	1729901.79	14400689.05	39°39'12.2837"N	80°40'55.4529"W	901.87	244.201	0.65
4969.00	12.470	244.330	4861.99	-360.58	-401.36	-829.81	1729883.97	14400680.19	39°39'12.1968"N	80°40'55.6813"W	921.78	244.188	0.35
5063.00	12.360	246.580	4953.79	-368.89	-409.76	-848.19	1729865.60	14400671.80	39°39'12.1145"N	80°40'55.9166"W	941.98	244.215	0.53
5150.00	12.770	247.270	5038.73	-377.12	-417.18	-865.60	1729848.19	14400664.39	39°39'12.0418"N	80°40'56.1396"W	960.88	244.268	0.50
5244.00	12.970	246.790	5130.35	-386.25	-425.35	-884.88	1729828.92	14400656.22	39°39'11.9617"N	80°40'56.3864"W	981.80	244.327	0.24
5334.00	13.840	245.950	5217.89	-395.14	-433.71	-903.99	1729809.82	14400647.86	39°39'11.8797"N	80°40'56.6312"W	1002.65	244.369	0.99

RECEIVED
Oil and Gas
1/17/24

REFERENCE WELLPATH IDENTIFICATION			
Operator	SWN PRODUCTION COMPANY, LLC	Well	Constance Taylor WTZ 6H
Field	Wetzel	API	47103036080000
Facility	Constance Taylor WTZ Pad	Wellbore	Constance Taylor WTZ 6H AWB
Slot	6H		

WELLPATH DATA (235 stations)													
MD [ft]	Inclination [°]	Azimuth [°]	TVD [ft]	Vert Sect [ft]	North [ft]	East [ft]	Grid East [US ft]	Grid North [US ft]	Latitude	Longitude	Closure Dist [ft]	Closure Dir [°]	DLS [°/100ft]
5425.00	14.610	244.970	5306.10	-404.33	-443.01	-924.33	1729789.48	14400638.57	39°39'11.7886"N	80°40'56.8916"W	1025.01	244.393	0.89
5516.00	14.510	243.030	5394.18	-413.21	-453.03	-944.89	1729768.93	14400628.55	39°39'11.6902"N	80°40'57.1549"W	1047.88	244.384	0.55
5608.00	14.380	241.680	5483.27	-421.51	-463.68	-965.22	1729748.61	14400617.90	39°39'11.5857"N	80°40'57.4153"W	1070.81	244.341	0.39
5698.00	14.200	240.970	5570.49	-429.17	-474.34	-984.71	1729729.13	14400607.25	39°39'11.4810"N	80°40'57.6650"W	1093.00	244.280	0.28
5788.00	13.560	243.320	5657.86	-436.89	-484.43	-1003.79	1729710.06	14400597.16	39°39'11.3819"N	80°40'57.9094"W	1114.57	244.238	0.95
5879.00	13.490	244.260	5746.34	-445.08	-493.83	-1022.88	1729690.97	14400587.76	39°39'11.2897"N	80°40'58.1539"W	1135.85	244.229	0.25
5973.00	13.500	242.730	5837.74	-453.41	-503.62	-1042.51	1729671.35	14400577.98	39°39'11.1937"N	80°40'58.4053"W	1157.78	244.215	0.38
6063.00	13.330	242.630	5925.29	-461.07	-513.20	-1061.06	1729652.81	14400568.40	39°39'11.0996"N	80°40'58.6429"W	1178.65	244.188	0.19
6154.00	13.020	244.050	6013.89	-468.90	-522.51	-1079.59	1729634.28	14400559.09	39°39'11.0082"N	80°40'58.8803"W	1199.39	244.173	0.49
6244.00	13.100	242.430	6101.56	-476.54	-531.67	-1097.75	1729616.13	14400549.94	39°39'10.9184"N	80°40'59.1128"W	1219.72	244.158	0.42
6335.00	13.630	244.850	6190.10	-484.59	-541.00	-1116.60	1729597.29	14400540.61	39°39'10.8268"N	80°40'59.3542"W	1240.75	244.150	0.85
6425.00	13.600	243.860	6277.57	-492.94	-550.17	-1135.70	1729578.20	14400531.45	39°39'10.7369"N	80°40'59.5988"W	1261.94	244.153	0.26
6606.00	13.620	244.680	6453.49	-509.65	-568.66	-1174.06	1729539.85	14400512.97	39°39'10.5555"N	80°41'0.0902"W	1304.53	244.157	0.11
6697.00	13.680	245.750	6541.92	-518.41	-577.66	-1193.56	1729520.36	14400503.97	39°39'10.4672"N	80°41'0.3398"W	1326.00	244.174	0.29
6771.00	13.350	246.290	6613.87	-525.68	-584.69	-1209.36	1729504.57	14400496.94	39°39'10.3983"N	80°41'0.5422"W	1343.28	244.198	0.48
6821.00	12.860	245.310	6662.57	-530.40	-589.33	-1219.70	1729494.23	14400492.30	39°39'10.3527"N	80°41'0.6746"W	1354.62	244.211	1.08
6918.00	13.470	244.120	6757.02	-539.23	-598.77	-1239.67	1729474.26	14400482.86	39°39'10.2601"N	80°41'0.9304"W	1376.71	244.219	0.69
7015.00	15.430	219.400	6851.03	-543.24	-613.69	-1258.05	1729455.90	14400467.95	39°39'10.1133"N	80°41'1.1660"W	1399.75	243.996	6.62
7111.00	20.360	198.850	6942.45	-536.50	-639.41	-1271.57	1729442.38	14400442.25	39°39'9.8597"N	80°41'1.3400"W	1423.28	243.305	8.27
7208.00	27.860	187.810	7030.97	-517.60	-677.90	-1280.12	1729433.83	14400403.76	39°39'9.4795"N	80°41'1.4510"W	1448.54	242.096	8.99
7304.00	37.330	182.270	7111.78	-486.91	-729.34	-1284.33	1729429.62	14400352.35	39°39'8.9713"N	80°41'1.5072"W	1476.97	240.409	10.33
7401.00	43.800	173.980	7185.48	-443.75	-792.22	-1281.97	1729431.98	14400289.49	39°39'8.3498"N	80°41'1.4799"W	1507.01	238.285	8.67
7497.00	49.900	164.840	7251.18	-388.71	-860.84	-1268.86	1729445.09	14400220.89	39°39'7.6711"N	80°41'1.3153"W	1533.31	235.845	9.40
7594.00	56.190	159.260	7309.49	-322.19	-934.45	-1244.85	1729469.09	14400147.32	39°39'6.9429"N	80°41'1.0117"W	1556.55	233.106	7.94
7690.00	63.140	152.450	7357.99	-246.96	-1009.87	-1210.85	1729503.08	14400071.92	39°39'6.1963"N	80°41'0.5804"W	1576.70	230.171	9.48
7787.00	69.690	146.420	7396.81	-162.60	-1086.27	-1165.59	1729548.31	14399995.56	39°39'5.4397"N	80°41'0.0052"W	1593.30	227.017	8.83
7884.00	76.010	143.490	7425.40	-72.64	-1162.08	-1112.37	1729601.52	14399919.78	39°39'4.6886"N	80°40'59.3282"W	1608.67	223.748	7.13
7980.00	82.590	137.180	7443.24	20.40	-1234.58	-1052.18	1729661.68	14399847.30	39°39'3.9700"N	80°40'58.5620"W	1622.12	220.440	9.41
8077.00	88.000	129.970	7451.20	116.88	-1301.13	-982.20	1729731.63	14399780.78	39°39'3.3099"N	80°40'57.6703"W	1630.23	217.049	9.27
8173.00	88.520	130.180	7454.11	212.82	-1362.91	-908.78	1729805.03	14399719.03	39°39'2.6968"N	80°40'56.7344"W	1638.11	213.695	0.58

REFERENCE WELLPATH IDENTIFICATION			
Operator	SWN PRODUCTION COMPANY, LLC	Well	Constance Taylor WTZ 6H
Field	Wetzel	API	47103036080000
Facility	Constance Taylor WTZ Pad	Wellbore	Constance Taylor WTZ 6H AWB
Slot	6H		

WELLPATH DATA (235 stations)													
MD [ft]	Inclination [°]	Azimuth [°]	TVD [ft]	Vert Sect [ft]	North [ft]	East [ft]	Grid East [US ft]	Grid North [US ft]	Latitude	Longitude	Closure Dist [ft]	Closure Dir [°]	DLS [°/100ft]
8270.00	88.460	130.070	7456.67	309.77	-1425.40	-834.63	1729879.15	14399656.56	39°39'2.0766"N	80°40'55.7893"W	1651.78	210.351	0.13
8367.00	88.680	129.380	7459.09	406.71	-1487.37	-760.05	1729953.70	14399594.61	39°39'1.4615"N	80°40'54.8386"W	1670.31	207.067	0.75
8463.00	88.460	131.780	7461.49	502.67	-1549.80	-687.17	1730026.55	14399532.21	39°39'0.8420"N	80°40'53.9097"W	1695.31	203.912	2.51
8560.00	88.120	131.440	7464.38	599.62	-1614.18	-614.67	1730099.02	14399467.85	39°39'0.2032"N	80°40'52.9858"W	1727.25	200.847	0.50
8656.00	88.740	132.080	7467.01	695.58	-1678.09	-543.09	1730170.57	14399403.97	39°38'59.5690"N	80°40'52.0736"W	1763.79	197.933	0.93
8753.00	89.510	131.980	7468.49	792.56	-1743.03	-471.05	1730242.58	14399339.06	39°38'58.9248"N	80°40'51.1555"W	1805.56	195.123	0.80
8850.00	89.540	131.850	7469.30	889.54	-1807.82	-398.87	1730314.74	14399274.29	39°38'58.2818"N	80°40'50.2357"W	1851.30	192.442	0.14
8946.00	89.350	131.260	7470.23	985.54	-1871.50	-327.04	1730386.54	14399210.63	39°38'57.6500"N	80°40'49.3202"W	1899.86	189.912	0.65
9043.00	89.380	131.910	7471.30	1082.53	-1935.88	-254.49	1730459.06	14399146.28	39°38'57.0112"N	80°40'48.3956"W	1952.53	187.489	0.67
9140.00	89.290	131.790	7472.43	1179.51	-2000.59	-182.24	1730531.28	14399081.59	39°38'56.3691"N	80°40'47.4749"W	2008.87	185.205	0.15
9236.00	89.540	132.160	7473.41	1275.50	-2064.79	-110.87	1730602.62	14399017.42	39°38'55.7321"N	80°40'46.5655"W	2067.77	183.074	0.47
9333.00	89.230	131.800	7474.45	1372.48	-2129.67	-38.77	1730674.70	14398952.57	39°38'55.0884"N	80°40'45.6466"W	2130.02	181.043	0.49
9429.00	89.260	131.790	7475.71	1468.47	-2193.65	32.80	1730746.23	14398888.62	39°38'54.4536"N	80°40'44.7347"W	2193.89	179.143	0.03
9526.00	89.110	131.470	7477.09	1565.46	-2258.08	105.29	1730818.70	14398824.21	39°38'53.8143"N	80°40'43.8108"W	2260.53	177.330	0.36
9622.00	88.490	132.540	7479.11	1661.42	-2322.30	176.61	1730889.99	14398760.01	39°38'53.1770"N	80°40'42.9020"W	2329.01	175.651	1.29
9719.00	89.080	131.950	7481.16	1758.38	-2387.50	248.40	1730961.75	14398694.83	39°38'52.5301"N	80°40'41.9872"W	2400.39	174.060	0.86
9815.00	89.200	131.950	7482.60	1854.36	-2451.67	319.79	1731033.12	14398630.69	39°38'51.8934"N	80°40'41.0775"W	2472.44	172.568	0.12
9911.00	88.950	131.680	7484.15	1950.34	-2515.67	391.33	1731104.63	14398566.72	39°38'51.2584"N	80°40'40.1658"W	2545.92	171.158	0.38
10007.00	90.400	131.450	7484.70	2046.34	-2579.36	463.15	1731176.42	14398503.06	39°38'50.6264"N	80°40'39.2506"W	2620.61	169.820	1.53
10104.00	88.520	132.910	7485.61	2143.31	-2644.48	535.03	1731248.27	14398437.96	39°38'49.9803"N	80°40'38.3347"W	2698.06	168.562	2.45
10200.00	89.600	131.330	7487.19	2239.28	-2708.86	606.22	1731319.43	14398373.61	39°38'49.3416"N	80°40'37.4275"W	2775.86	167.385	1.99
10297.00	89.110	130.600	7488.28	2336.27	-2772.44	679.46	1731392.65	14398310.04	39°38'48.7105"N	80°40'36.4942"W	2854.49	166.230	0.91
10394.00	90.950	133.260	7488.23	2433.25	-2837.25	751.62	1731464.77	14398245.26	39°38'48.0674"N	80°40'35.5747"W	2935.12	165.163	3.33
10490.00	90.060	132.270	7487.38	2529.21	-2902.43	822.09	1731535.22	14398180.11	39°38'47.4208"N	80°40'34.6768"W	3016.61	164.186	1.39
10586.00	89.480	132.070	7487.77	2625.19	-2966.88	893.24	1731606.34	14398115.69	39°38'46.7813"N	80°40'33.7702"W	3098.43	163.244	0.64
10683.00	89.630	131.690	7488.52	2722.18	-3031.63	965.46	1731678.53	14398050.96	39°38'46.1388"N	80°40'32.8500"W	3181.65	162.335	0.42
10779.00	89.600	131.880	7489.17	2818.17	-3095.60	1037.04	1731750.08	14397987.02	39°38'45.5041"N	80°40'31.9378"W	3264.69	161.479	0.20
10876.00	89.660	131.510	7489.79	2915.17	-3160.12	1109.47	1731822.48	14397922.52	39°38'44.8639"N	80°40'31.0149"W	3349.22	160.655	0.39
10972.00	89.720	131.670	7490.31	3011.16	-3223.84	1181.27	1731894.25	14397858.82	39°38'44.2315"N	80°40'30.1000"W	3433.45	159.876	0.18
11068.00	89.570	131.760	7490.91	3107.16	-3287.72	1252.93	1731966.88	14397794.97	39°38'43.5976"N	80°40'29.1869"W	3518.37	159.139	0.18

REFERENCE WELLPATH IDENTIFICATION

Operator	SWN PRODUCTION COMPANY, LLC	Well	Constance Taylor WTZ 6H
Field	Wetzel	API	47103036080000
Facility	Constance Taylor WTZ Pad	Wellbore	Constance Taylor WTZ 6H AWB
Slot	6H		

WELLPATH DATA (235 stations)

MD [ft]	Inclination [°]	Azimuth [°]	TVD [ft]	Vert Sect [ft]	North [ft]	East [ft]	Grid East [US ft]	Grid North [US ft]	Latitude	Longitude	Closure Dist [ft]	Closure Dir [°]	DLS [°/100ft]
11165.00	89.230	131.240	7491.92	3204.15	-3351.99	1325.57	1732038.50	14397730.72	39°38'42.9599"N	80°40'28.2612"W	3604.58	158.423	0.64
11261.00	89.660	132.230	7492.85	3300.14	-3415.89	1397.20	1732110.10	14397666.85	39°38'42.3258"N	80°40'27.3484"W	3690.60	157.754	1.12
11357.00	89.720	131.660	7493.37	3396.13	-3480.06	1468.61	1732181.48	14397602.71	39°38'41.6890"N	80°40'26.4386"W	3777.25	157.120	0.60
11455.00	89.630	131.500	7493.93	3494.12	-3545.10	1541.91	1732254.76	14397537.69	39°38'41.0437"N	80°40'25.5046"W	3865.90	156.494	0.19
11552.00	89.600	131.790	7494.58	3591.12	-3609.55	1614.40	1732327.21	14397473.26	39°38'40.4040"N	80°40'24.5809"W	3954.13	155.903	0.30
11648.00	89.820	131.580	7495.06	3687.11	-3673.40	1686.09	1732398.88	14397409.45	39°38'39.7705"N	80°40'23.6674"W	4041.87	155.345	0.32
11744.00	89.780	131.560	7495.40	3783.11	-3737.10	1757.91	1732470.67	14397345.77	39°38'39.1384"N	80°40'22.7523"W	4129.91	154.808	0.05
11841.00	89.350	131.740	7496.14	3880.10	-3801.56	1830.39	1732543.12	14397281.33	39°38'38.4987"N	80°40'21.8287"W	4219.26	154.290	0.48
11937.00	89.600	131.900	7497.02	3976.09	-3865.57	1901.93	1732614.63	14397217.35	39°38'37.8636"N	80°40'20.9172"W	4308.13	153.802	0.31
12034.00	89.570	131.520	7497.72	4073.08	-3930.11	1974.34	1732687.01	14397152.84	39°38'37.2231"N	80°40'19.9946"W	4398.15	153.327	0.39
12130.00	89.540	131.560	7498.46	4169.08	-3993.77	2046.19	1732758.84	14397089.20	39°38'36.5914"N	80°40'19.0790"W	4487.43	152.872	0.05
12227.00	89.570	131.720	7499.22	4266.07	-4058.22	2118.68	1732831.30	14397024.78	39°38'35.9518"N	80°40'18.1554"W	4577.98	152.432	0.17
12323.00	89.540	131.710	7499.96	4362.07	-4122.09	2190.34	1732902.93	14396960.92	39°38'35.3179"N	80°40'17.2423"W	4667.90	152.015	0.03
12419.00	89.660	131.490	7500.63	4458.06	-4185.83	2262.13	1732974.69	14396897.21	39°38'34.6854"N	80°40'16.3276"W	4757.98	151.612	0.26
12516.00	89.570	131.460	7501.28	4555.06	-4250.07	2334.80	1733047.33	14396833.00	39°38'34.0479"N	80°40'15.4016"W	4849.16	151.218	0.10
12612.00	89.540	131.780	7502.03	4651.05	-4313.83	2406.57	1733119.07	14396769.26	39°38'33.4152"N	80°40'14.4872"W	4939.71	150.844	0.33
12709.00	89.780	131.590	7502.61	4748.04	-4378.34	2479.01	1733191.48	14396704.78	39°38'32.7751"N	80°40'13.5643"W	5031.43	150.482	0.32
12805.00	89.880	132.220	7502.89	4844.04	-4442.46	2550.45	1733262.90	14396640.69	39°38'32.1388"N	80°40'12.6540"W	5122.52	150.139	0.66
12902.00	89.720	131.710	7503.23	4941.02	-4507.32	2622.58	1733335.00	14396575.85	39°38'31.4952"N	80°40'11.7350"W	5214.77	149.807	0.55
12999.00	89.630	131.530	7503.78	5038.02	-4571.74	2695.09	1733407.48	14396511.45	39°38'30.8558"N	80°40'10.8111"W	5307.01	149.480	0.21
13095.00	89.780	131.840	7504.27	5134.01	-4635.58	2766.78	1733479.15	14396447.64	39°38'30.2223"N	80°40'9.8977"W	5398.49	149.169	0.36
13192.00	89.540	131.890	7504.85	5231.01	-4700.32	2839.02	1733551.35	14396382.93	39°38'29.5799"N	80°40'8.9773"W	5491.18	148.868	0.25
13288.00	89.690	131.770	7505.49	5327.00	-4764.34	2910.55	1733622.86	14396318.93	39°38'28.9445"N	80°40'8.0660"W	5583.03	148.579	0.20
13385.00	90.250	132.510	7505.55	5423.98	-4829.42	2982.47	1733694.75	14396253.87	39°38'28.2987"N	80°40'7.1496"W	5676.13	148.302	0.96
13481.00	89.570	131.850	7505.70	5519.96	-4893.88	3053.61	1733765.86	14396189.44	39°38'27.6591"N	80°40'6.2433"W	5768.42	148.037	0.99
13578.00	89.570	131.710	7506.42	5616.96	-4958.51	3125.95	1733838.17	14396124.84	39°38'27.0178"N	80°40'5.3218"W	5861.60	147.772	0.14
13674.00	89.510	131.950	7507.19	5712.95	-5022.53	3197.48	1733909.67	14396060.84	39°38'26.3824"N	80°40'4.4104"W	5953.96	147.518	0.26
13771.00	90.060	132.070	7507.56	5809.93	-5087.45	3269.55	1733981.71	14395995.95	39°38'25.7382"N	80°40'3.4922"W	6047.48	147.272	0.58
13867.00	89.570	131.530	7507.87	5905.93	-5151.43	3341.11	1734053.25	14395931.99	39°38'25.1032"N	80°40'2.5804"W	6140.06	147.033	0.76
13963.00	89.420	132.020	7508.71	6001.92	-5215.39	3412.70	1734124.81	14395868.06	39°38'24.4686"N	80°40'1.6684"W	6232.72	146.801	0.53

REFERENCE WELLPATH IDENTIFICATION			
Operator	SWN PRODUCTION COMPANY, LLC	Well	Constance Taylor WTZ 6H
Field	Wetzel	API	47103036080000
Facility	Constance Taylor WTZ Pad	Wellbore	Constance Taylor WTZ 6H AWB
Slot	6H		

WELLPATH DATA (235 stations)													
MD [ft]	Inclination [°]	Azimuth [°]	TVD [ft]	Vert Sect [ft]	North [ft]	East [ft]	Grid East [US ft]	Grid North [US ft]	Latitude	Longitude	Closure Dist [ft]	Closure Dir [°]	DLS [°/100ft]
14060.00	89.420	131.860	7509.70	6098.90	-5280.21	3484.85	1734196.93	14395803.26	39°38'23.8253"N	80°40'0.7492"W	6326.52	146.576	0.16
14156.00	89.690	132.550	7510.44	6194.88	-5344.70	3555.96	1734268.02	14395738.80	39°38'23.1853"W	80°39'59.8433"W	6419.56	146.363	0.77
14253.00	89.230	129.110	7511.36	6291.86	-5408.11	3629.34	1734341.37	14395675.41	39°38'22.5560"N	80°39'58.9083"W	6513.05	146.135	3.58
14349.00	89.970	127.990	7512.03	6387.76	-5467.94	3704.42	1734416.41	14395615.61	39°38'21.9620"N	80°39'57.9515"W	6604.62	145.883	1.40
14446.00	89.510	125.200	7512.47	6484.44	-5525.76	3782.29	1734494.25	14395557.81	39°38'21.3877"N	80°39'56.9588"W	6696.24	145.609	2.92
14542.00	89.910	126.100	7512.95	6580.00	-5581.71	3860.29	1734572.23	14395501.89	39°38'20.8319"N	80°39'55.9644"W	6786.55	145.332	1.03
14639.00	89.290	126.200	7513.63	6676.62	-5638.93	3938.62	1734650.52	14395444.69	39°38'20.2635"N	80°39'54.9659"W	6878.24	145.067	0.65
14735.00	89.970	126.020	7514.25	6772.25	-5695.50	4016.17	1734728.04	14395388.14	39°38'19.7015"N	80°39'53.9773"W	6969.10	144.810	0.73
14832.00	89.320	125.460	7514.85	6868.81	-5752.16	4094.90	1734806.74	14395331.50	39°38'19.1387"N	80°39'52.9736"W	7060.84	144.553	0.88
14928.00	89.510	125.840	7515.83	6964.36	-5808.11	4172.91	1734884.72	14395275.57	39°38'18.5829"N	80°39'51.9792"W	7151.73	144.304	0.44
15025.00	89.540	125.890	7516.64	7060.94	-5864.93	4251.51	1734963.29	14395218.77	39°38'18.0183"N	80°39'50.9772"W	7243.81	144.062	0.06
15121.00	89.350	126.080	7517.57	7156.55	-5921.34	4329.19	1735040.94	14395162.39	39°38'17.4580"N	80°39'49.9870"W	7335.13	143.829	0.28
15218.00	89.230	126.100	7518.77	7253.16	-5978.47	4407.57	1735119.29	14395105.28	39°38'16.8905"N	80°39'48.9878"W	7427.57	143.601	0.13
15314.00	89.450	125.890	7519.87	7348.77	-6034.89	4485.23	1735196.92	14395048.88	39°38'16.3300"N	80°39'47.9978"W	7519.12	143.380	0.32
15411.00	89.480	125.840	7520.78	7445.35	-6091.72	4563.84	1735275.50	14394992.08	39°38'15.7655"N	80°39'46.9958"W	7611.68	143.160	0.06
15508.00	89.320	125.600	7521.79	7541.90	-6148.34	4642.59	1735354.21	14394935.47	39°38'15.2029"N	80°39'45.9919"W	7704.27	142.944	0.30
15604.00	89.420	125.620	7522.85	7637.45	-6204.24	4720.63	1735432.23	14394879.60	39°38'14.6477"N	80°39'44.9970"W	7795.96	142.734	0.11
15701.00	89.350	125.950	7523.89	7734.02	-6260.96	4799.31	1735510.88	14394822.90	39°38'14.0842"N	80°39'43.9940"W	7888.79	142.528	0.35
15797.00	89.600	125.920	7524.77	7829.61	-6317.29	4877.04	1735588.57	14394766.59	39°38'13.5245"N	80°39'43.0032"W	7980.83	142.331	0.26
15894.00	89.600	126.000	7525.45	7926.21	-6374.25	4955.55	1735667.06	14394709.65	39°38'12.9587"N	80°39'42.0024"W	8073.94	142.137	0.08
15991.00	89.170	129.060	7526.49	8023.00	-6433.33	5032.46	1735743.94	14394650.60	39°38'12.3720"N	80°39'41.0222"W	8167.83	141.966	3.19
16087.00	89.480	128.910	7527.65	8118.92	-6493.72	5107.08	1735818.52	14394590.23	39°38'11.7724"N	80°39'40.0713"W	8261.40	141.816	0.33
16184.00	89.200	128.880	7528.79	8215.84	-6554.62	5182.57	1735893.98	14394529.35	39°38'11.1677"N	80°39'39.1094"W	8355.96	141.668	0.26
16280.00	89.540	128.750	7529.84	8311.75	-6614.79	5257.36	1735968.75	14394469.20	39°38'10.5702"N	80°39'38.1562"W	8449.58	141.523	0.38
16377.00	89.420	129.000	7530.72	8408.67	-6675.67	5332.88	1736044.23	14394408.35	39°38'9.9658"N	80°39'37.1940"W	8544.25	141.380	0.29
16474.00	89.630	129.110	7531.53	8505.60	-6736.78	5408.20	1736119.53	14394347.26	39°38'9.3590"N	80°39'36.2342"W	8639.03	141.243	0.24
16570.00	89.450	128.830	7532.30	8601.53	-6797.16	5482.83	1736194.13	14394286.91	39°38'8.7595"N	80°39'35.2831"W	8732.86	141.109	0.35
16667.00	89.350	128.910	7533.32	8698.45	-6858.03	5558.35	1736269.62	14394226.07	39°38'8.1551"N	80°39'34.3208"W	8827.67	140.976	0.13
16764.00	89.290	129.020	7534.47	8795.37	-6919.02	5633.77	1736345.00	14394165.10	39°38'7.5495"N	80°39'33.3598"W	8922.57	140.846	0.13
16860.00	89.480	128.990	7535.50	8891.30	-6979.44	5708.36	1736419.57	14394104.70	39°38'6.9496"N	80°39'32.4093"W	9016.54	140.721	0.20

REFERENCE WELLPATH IDENTIFICATION

Operator	SWN PRODUCTION COMPANY, LLC	Well	Constance Taylor WTZ 6H
Field	Wetzel	API	47103036080000
Facility	Constance Taylor WTZ Pad	Wellbore	Constance Taylor WTZ 6H AWB
Slot	6H		

WELLPATH DATA (235 stations)

MD [ft]	Inclination [°]	Azimuth [°]	TVD [ft]	Vert Sect [ft]	North [ft]	East [ft]	Grid East [US ft]	Grid North [US ft]	Latitude	Longitude	Closure Dist [ft]	Closure Dir [°]	DLS [°/100ft]
16957.00	89.320	128.860	7536.51	8988.22	-7040.38	5783.82	1736495.00	14394043.78	39°38'6.3445"N	80°39'31.4477"W	9111.51	140.596	0.21
17053.00	89.350	128.740	7537.63	9084.13	-7100.53	5858.63	1736569.78	14393983.66	39°38'5.7472"N	80°39'30.4944"W	9205.49	140.474	0.13
17150.00	89.200	128.930	7538.85	9181.04	-7161.35	5934.19	1736645.31	14393922.86	39°38'5.1433"N	80°39'29.5317"W	9300.51	140.353	0.25
17246.00	89.570	128.990	7539.88	9276.97	-7221.71	6008.83	1736719.92	14393862.52	39°38'4.5439"N	80°39'28.5806"W	9394.63	140.238	0.39
17343.00	90.030	128.600	7540.22	9373.88	-7282.48	6084.43	1736795.49	14393801.77	39°38'3.9405"N	80°39'27.6172"W	9489.72	140.122	0.62
17440.00	89.690	128.910	7540.46	9470.80	-7343.21	6160.07	1736871.10	14393741.08	39°38'3.3375"N	80°39'26.6534"W	9584.84	140.007	0.47
17536.00	89.290	128.520	7541.31	9566.70	-7403.25	6234.98	1736945.98	14393681.06	39°38'2.7413"N	80°39'25.6989"W	9679.00	139.896	0.58
17633.00	89.690	128.890	7542.18	9663.61	-7463.90	6310.67	1737021.64	14393620.43	39°38'2.1391"N	80°39'24.7344"W	9774.17	139.786	0.56
17729.00	89.690	128.580	7542.70	9759.52	-7523.97	6385.55	1737096.49	14393560.39	39°38'1.5426"N	80°39'23.7802"W	9868.40	139.679	0.32
17826.00	89.910	128.970	7543.04	9856.44	-7584.71	6461.17	1737172.09	14393499.66	39°38'0.9394"N	80°39'22.8166"W	9963.67	139.573	0.46
17922.00	89.630	129.020	7543.42	9952.37	-7645.12	6535.78	1737246.67	14393439.28	39°38'0.3396"N	80°39'21.8659"W	10058.05	139.473	0.30
18019.00	89.540	128.760	7544.12	10049.29	-7706.02	6611.28	1737322.14	14393378.41	39°37'59.7349"N	80°39'20.9039"W	10153.41	139.372	0.28
18115.00	89.600	128.730	7544.84	10145.20	-7766.10	6686.15	1737396.98	14393318.35	39°37'59.1383"N	80°39'19.9499"W	10247.78	139.273	0.07
18212.00	89.690	128.680	7545.45	10242.11	-7826.75	6761.85	1737472.64	14393257.72	39°37'58.5359"N	80°39'18.9854"W	10343.15	139.175	0.11
18308.00	89.970	129.170	7545.73	10338.04	-7887.07	6836.53	1737547.30	14393197.43	39°37'57.9370"N	80°39'18.0338"W	10437.63	139.081	0.59
18405.00	89.630	129.100	7546.07	10434.98	-7948.29	6911.77	1737622.51	14393136.23	39°37'57.3291"N	80°39'17.0752"W	10533.18	138.990	0.36
18501.00	89.660	128.590	7546.66	10530.90	-8008.50	6986.54	1737697.25	14393076.04	39°37'56.7312"N	80°39'16.1225"W	10627.69	138.899	0.53
18597.00	90.000	128.730	7546.95	10626.80	-8068.47	7061.50	1737772.18	14393016.10	39°37'56.1357"N	80°39'15.1673"W	10722.18	138.808	0.38
18693.00	89.820	128.900	7547.10	10722.72	-8128.65	7136.30	1737846.95	14392955.95	39°37'55.5382"N	80°39'14.2143"W	10816.73	138.719	0.26
18790.00	89.880	128.740	7547.35	10819.64	-8189.45	7211.88	1737922.50	14392895.16	39°37'54.9343"N	80°39'13.2513"W	10912.30	138.632	0.18
18886.00	89.480	128.520	7547.89	10915.55	-8249.38	7286.87	1737997.46	14392835.26	39°37'54.3392"N	80°39'12.2958"W	11006.85	138.545	0.48
18982.00	89.820	128.850	7548.48	11011.46	-8309.39	7361.81	1738072.37	14392775.28	39°37'53.7433"N	80°39'11.3410"W	11101.45	138.460	0.49
19078.00	89.630	128.950	7548.94	11107.38	-8369.67	7436.52	1738147.05	14392715.02	39°37'53.1447"N	80°39'10.3891"W	11196.12	138.379	0.22
19175.00	89.660	128.900	7549.54	11204.30	-8430.61	7511.98	1738222.48	14392654.10	39°37'52.5395"N	80°39'9.4276"W	11291.81	138.298	0.06
19271.00	89.690	128.750	7550.08	11300.22	-8490.80	7586.77	1738297.24	14392593.93	39°37'51.9419"N	80°39'8.4747"W	11386.51	138.218	0.16
19368.00	90.250	129.220	7550.13	11397.15	-8551.82	7662.17	1738372.61	14392532.93	39°37'51.3359"N	80°39'7.5141"W	11482.27	138.141	0.75
19464.00	89.780	128.780	7550.11	11493.08	-8612.24	7736.77	1738447.18	14392472.54	39°37'50.7360"N	80°39'6.5635"W	11577.06	138.065	0.67
19561.00	89.660	128.690	7550.58	11590.00	-8672.93	7812.44	1738522.82	14392411.87	39°37'50.1332"N	80°39'5.5995"W	11672.78	137.988	0.15
19657.00	90.220	128.580	7550.68	11685.90	-8732.87	7887.42	1738597.78	14392351.96	39°37'49.5380"N	80°39'4.6440"W	11767.52	137.912	0.59
19754.00	90.710	130.770	7549.90	11782.86	-8794.79	7962.08	1738672.40	14392290.06	39°37'48.9232"N	80°39'3.6930"W	11863.52	137.845	2.31

REFERENCE WELLPATH IDENTIFICATION			
Operator	SWN PRODUCTION COMPANY, LLC	Well	Constance Taylor Wtz 6H
Field	Wetzel	API	47103036080000
Facility	Constance Taylor Wtz Pad	Wellbore	Constance Taylor Wtz 6H AWB
Slot	6H		

WELLPATH DATA (235 stations) † = interpolated, ‡ = extrapolated station													
MD [ft]	Inclination [°]	Azimuth [°]	TVD [ft]	Vert Sect [ft]	North [ft]	East [ft]	Grid East [US ft]	Grid North [US ft]	Latitude	Longitude	Closure Dist [ft]	Closure Dir [°]	DLS [°/100ft]
19850.00	90.990	132.780	7548.47	11878.84	-8858.74	8033.66	1738743.95	14392226.14	39°37'48.2884"N	80°39'2.7813"W	11958.97	137.796	2.11
19946.00	90.680	134.520	7547.07	11974.73	-8924.99	8103.11	1738813.38	14392159.91	39°37'47.6310"N	80°39'1.8969"W	12054.70	137.763	1.84
20043.00	90.580	136.960	7546.00	12071.41	-8994.45	8170.80	1738881.04	14392090.48	39°37'46.9419"N	80°39'1.0353"W	12151.63	137.747	2.52
20140.00	90.550	137.180	7545.05	12167.89	-9065.47	8236.86	1738947.08	14392019.49	39°37'46.2375"N	80°39'0.1944"W	12248.62	137.742	0.23
20236.00	90.740	136.500	7543.97	12263.41	-9135.49	8302.53	1739012.72	14391949.49	39°37'45.5430"N	80°38'59.3587"W	12344.60	137.735	0.74
20333.00	90.340	136.990	7543.05	12359.95	-9206.14	8368.99	1739079.16	14391878.88	39°37'44.8423"N	80°38'58.5128"W	12441.58	137.727	0.65
20429.00	90.650	137.060	7542.22	12455.44	-9276.37	8434.43	1739144.57	14391808.67	39°37'44.1456"N	80°38'57.6799"W	12537.57	137.722	0.33
20526.00	90.680	136.820	7541.10	12551.94	-9347.24	8500.65	1739210.77	14391737.83	39°37'43.4427"N	80°38'56.8371"W	12634.55	137.716	0.25
20622.00	90.150	136.190	7540.40	12647.52	-9416.88	8566.73	1739276.81	14391668.22	39°37'42.7519"N	80°38'55.9961"W	12730.53	137.707	0.86
20718.00	87.850	135.940	7542.08	12743.15	-9485.99	8633.32	1739343.38	14391599.13	39°37'42.0662"N	80°38'55.1484"W	12826.47	137.694	2.41
20815.00	89.630	137.770	7544.21	12839.64	-9556.75	8699.63	1739409.67	14391528.41	39°37'41.3645"N	80°38'54.3045"W	12923.43	137.688	2.63
20911.00	89.880	137.930	7544.62	12934.98	-9627.92	8764.06	1739474.06	14391457.26	39°37'40.6586"N	80°38'53.4847"W	13019.43	137.689	0.31
21008.00	89.630	137.860	7545.04	13031.31	-9699.88	8829.09	1739539.08	14391385.33	39°37'39.9448"N	80°38'52.6571"W	13116.43	137.691	0.27
21105.00	89.420	137.610	7545.84	13127.67	-9771.66	8894.33	1739604.29	14391313.57	39°37'39.2329"N	80°38'51.8270"W	13213.42	137.691	0.34
21202.00	89.540	138.100	7546.72	13224.01	-9843.58	8959.41	1739669.35	14391241.68	39°37'38.5196"N	80°38'50.9988"W	13310.42	137.692	0.52
21298.00	89.290	137.840	7547.70	13319.32	-9914.89	9023.68	1739733.59	14391170.41	39°37'37.8124"N	80°38'50.1809"W	13406.41	137.694	0.38
21395.00	89.630	137.300	7548.62	13415.71	-9986.48	9089.13	1739799.01	14391098.84	39°37'37.1024"N	80°38'49.3482"W	13503.41	137.693	0.66
21491.00	89.420	137.960	7549.41	13511.10	-10057.40	9153.82	1739863.67	14391027.95	39°37'36.3989"N	80°38'48.5249"W	13599.40	137.693	0.72
21588.00	89.570	136.750	7550.27	13607.53	-10128.75	9219.53	1739929.36	14390956.63	39°37'35.6913"N	80°38'47.6888"W	13696.39	137.690	1.26
21684.00	89.600	137.700	7550.96	13702.98	-10199.21	9284.72	1739994.53	14390886.19	39°37'34.9923"N	80°38'46.8591"W	13792.39	137.687	0.99
21781.00	89.320	137.100	7551.88	13799.40	-10270.61	9350.37	1740060.15	14390814.82	39°37'34.2842"N	80°38'46.0236"W	13889.38	137.685	0.68
21878.00	89.570	137.400	7552.82	13895.85	-10341.84	9416.22	1740125.97	14390743.63	39°37'33.5777"N	80°38'45.1858"W	13986.37	137.682	0.40
21974.00	89.750	137.990	7553.39	13991.23	-10412.83	9480.83	1740190.56	14390672.66	39°37'32.8735"N	80°38'44.3636"W	14082.37	137.682	0.64
22013.00	89.750	137.760	7553.56	14029.96	-10441.76	9506.99	1740216.71	14390643.74	39°37'32.5866"N	80°38'44.0307"W	14121.37	137.683	0.59
22038.00†	89.750	137.760	7553.66	14054.79	-10460.27	9523.79	1740233.50	14390625.24	39°37'32.4031"N	80°38'43.8169"W	14146.37	137.683	0.00

REFERENCE WELLPATH IDENTIFICATION			
Operator	SWN PRODUCTION COMPANY, LLC	Well	Constance Taylor WTZ 6H
Field	Wetzel	API	47103036080000
Facility	Constance Taylor WTZ Pad	Wellbore	Constance Taylor WTZ 6H AWB
Slot	6H		

HOLE & CASING SECTIONS - Ref Wellbore: Constance Taylor WTZ 6H AWB Ref Wellpath: Constance Taylor WTZ 6H awp Proj: 22038'									
String/Diameter	Start MD [ft]	End MD [ft]	Interval [ft]	Start TVD [ft]	End TVD [ft]	Start N/S [ft]	Start E/W [ft]	End N/S [ft]	End E/W [ft]
13.0353in Casing	26.00	447.00	421.00	26.00	447.00	0.00	0.00	-0.58	1.50
9.625in Casing	26.00	2890.00	2864.00	26.00	2840.96	0.00	0.00	-185.96	-393.05
5.5in Casing	26.00	22038.00	22012.00	26.00	7553.66	0.00	0.00	-10460.27	9523.79

TARGETS								
Name	TVD [ft]	North [ft]	East [ft]	Grid East [US ft]	Grid North [US ft]	Latitude	Longitude	Shape
Constance Taylor WTZ 6H LP rev4	7448.00	-1281.17	-990.63	1729723.21	14399800.73	39°39'3.5074"N	80°40'57.7772"W	point
Constance Taylor WTZ wp2	7501.00	-5344.11	3547.72	1734259.78	14395739.39	39°38'23.1915"N	80°39'59.9486"W	point
Constance Taylor WTZ wp02	7513.00	-6453.88	5034.66	1735746.13	14394630.05	39°38'12.1688"N	80°39'40.9951"W	point
Constance Taylor WTZ wp03	7527.00	-8771.03	7928.02	1738638.36	14392313.81	39°37'49.1593"N	80°39'4.1271"W	point
Constance Taylor WTZ 6H BHL rev4	7528.00	-10469.24	9517.01	1740226.73	14390616.27	39°37'32.3146"N	80°38'43.9040"W	point

RECEIVED
 Office of Oil and Gas
 JUN 05 2024
 WV Department of
 Environmental Protection

REFERENCE WELLPATH IDENTIFICATION			
Operator	SWN PRODUCTION COMPANY, LLC	Well	Constance Taylor WTZ 6H
Field	Wetzel	API	47103036080000
Facility	Constance Taylor WTZ Pad	Wellbore	Constance Taylor WTZ 6H AWB
Slot	6H		

WELLPATH COMPOSITION - Ref Wellbore: Constance Taylor WTZ 6H AWB Ref Wellpath: Constance Taylor WTZ 6H awp Proj: 22038'					
Start MD [ft]	End MD [ft]	Positional Uncertainty Model	Log Name/Comment	Wellbore	Survey Date
26.00	477.00	OWSG MWD rev2 + IFR1 + Multi-Station Correction	1 Total MWD 17.5" IFR-MSA 174' - 447'	Constance Taylor WTZ 6H AWB	1/31/2024
477.00	2890.00	OWSG MWD rev2 + IFR1 + Multi-Station Correction	2 Total MWD 12.25" IFR-MSA 508' - 2890'	Constance Taylor WTZ 6H AWB	1/31/2024
2890.00	6771.00	OWSG MWD rev2 + IFR1 + Multi-Station Correction	3 Total MWD 8.75" IFR-MSA 2973' - 6771'	Constance Taylor WTZ 6H AWB	1/31/2024
6771.00	22038.00	OWSG MWD rev2 + IFR1 + Multi-Station Correction	4 BH MWD 8.5" IFR-MSA 6821' - 22013'	Constance Taylor WTZ 6H AWB	1/31/2024

RECEIVED
Office Of Oil and Gas
JUN 05 2024
WV Department of
Environmental Protection