

- NOTES ON SURVEY**
- COORDINATES SYSTEM IS UTM, NAD 83 DATUM, ZONE 17, U.S. FOOT AND WELL COORDINATES ESTABLISHED USING SURVEY GRADE GPS.
 - SURFACE AND ROYALTY OWNER INFORMATION AND THEIR BOUNDARIES SHOWN HEREON WERE PLOTTED FROM DEEDS AND/OR TAX PARCEL MAPS PROVIDED BY CLIENT AND FIELD LOCATIONS.
 - THIS PLAT DOES NOT REPRESENT A BOUNDARY SURVEY OF THE PARCELS SHOWN HEREON.
 - NO DWELLINGS AND BUILDINGS WITHIN 625 FEET OF PROPOSED CENTER OF PAD.
 - NO WATER WELLS OR DEVELOPED SPRINGS WITHIN 250 FEET OF PROPOSED WELL.
 - NO PERENNIAL STREAMS, LAKES, PONDS, RESERVOIRS OR WETLANDS WITHIN 100 FEET OF THE LIMITS OF DISTURBANCE.
 - NO NATURALLY PRODUCING TROUT STREAM WITHIN 300 FEET OF LIMITS OF DISTURBANCE.

- LEGEND**
- Active Well Location
 - Plugged Well Location
 - Abandoned Well
 - Surface Tract Identification
 - Proposed Gas Well
 - Located Corner, as noted
 - Surface Tract Lines (Surveyed)
 - Surface Tract Lines (Tax Map)
 - Reference Line
 - Lease Boundary
 - Creek or Drain
 - WV County Route
 - WV State Route
- (- o -) Denotes Location of Well on United States Topographic Maps



I, the undersigned, hereby certify that this plat is correct to the best of my knowledge and belief and shows all the information required by law and the regulations issued and prescribed by the Department of Environmental Protection.

Thomas C. Smit
L. L. S. 687



FILE NO: W2175 (BK 59-37)
DRAWING NO:
SCALE: 1" = 2000'
MINIMUM DEGREE OF ACCURACY: 1:2500
PROVEN SOURCE OF ELEVATION: NGS CORS Station



DATE: AUGUST 3 20 22
OPERATORS WELL NO: Haggard 6H
API WELL NO: H6A
47 - 103 - 03528
STATE COUNTY PERMIT

WELL TYPE: OIL GAS LIQUID INJECTION WASTE DISPOSAL
 (IF GAS) PRODUCTION: STORAGE DEEP SHALLOW
 LOCATION ELEVATION: 1512' WATERSHED: LOWER WEST VIRGINIA FORK FISH CREEK QUADRANGLE: LITTLETON
 DISTRICT: Center COUNTY: Wetzel
 SURFACE OWNER: Amie Lee Henderson ACREAGE: 45.5 ±
 ROYALTY OWNER: Earnest Howard Cadle, et al. LEASE NO: 186297001 ACREAGE: 95 ±
 PROPOSED WORK: DRILL CONVERT DRILL DEEPER FRACTURE OR STIMULATE PLUG OFF OLD FORMATION
 PERFORATE NEW FORMATION OTHER PHYSICAL CHANGE IN WELL (SPECIFY)
 PLUG AND ABANDON CLEAN OUT AND REPLUG TARGET FORMATION: Marcellus ESTIMATED DEPTH: 7,618'
 WELL OPERATOR: EQT Production Company DESIGNATED AGENT: Joseph C Mallow
 ADDRESS: 400 Woodcliff Drive ADDRESS: 427 Midstate Drive
 Canonsburg, PA 15317 Clarksburg, WV 26301

11/04/2022

Haggard 6H
Haggard
EQT Production Company

| Tract ID. | Tax Map No. | Parcel No. | County | District | Surface Tract Owner | Acres |
|-----------|-------------|------------|--------|----------|-----------------------------|-------|
| 1 | 10 | 36.0 | Wetzel | Center | Amie Lee Henderson | 45.50 |
| 2 | 10 | 37.0 | Wetzel | Center | Amie Lee Henderson | 14.50 |
| 3 | 10 | 51.0 | Wetzel | Center | Sharon J McMillen | 10.00 |
| 4 | 10 | 52.0 | Wetzel | Center | John G Miller ET AL | 55.50 |
| 5 | 14 | 5.0 | Wetzel | Center | Coastal Forest Resources CO | 66.15 |

| Lease | Owner | Acres |
|-----------|------------------------------|--------|
| 186297001 | Earnest Howard Cadle, et al. | 95 |
| 134572002 | Dale E. Long, et al. | 92 |
| 131545001 | John G. Miller, et al. | 55.495 |
| 218874005 | William F. Miller, et al. | 66.15 |

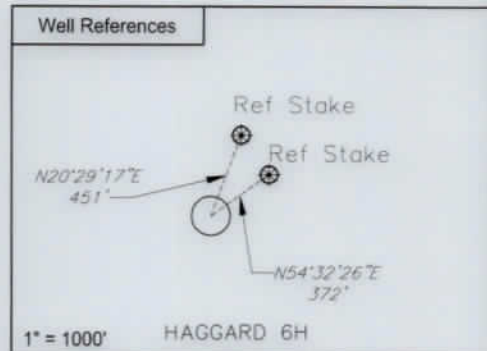
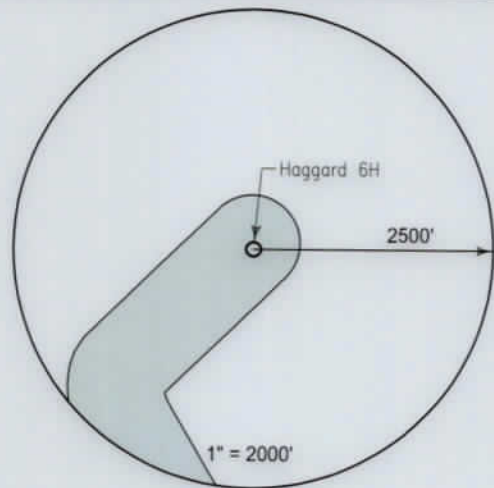

Notes:
HAGGARD 6H coordinates are
NAD 27 N: 422,354.585 E: 1,684,565.086
NAD 27 Lat: 39.654207 Long: -80.620334
NAD 83 UTM N: 4,389,456.668 E: 532,587.351

HAGGARD 6H Landing Point coordinates are
NAD 27 N: 420,377.496 E: 1,683,306.288
NAD 27 Lat: 39.648740 Long: -80.624719
NAD 83 UTM N: 4,388,848.327 E: 532,213.623

HAGGARD 6H Bottom Hole coordinates are
NAD 27 N: 419,229.970 E: 1,683,972.741
NAD 27 Lat: 39.645609 Long: -80.622299
NAD 83 UTM N: 4,388,501.703 E: 532,422.742

West Virginia Coordinates system of 1927 (North Zone)
based upon Differential GPS Measurements
Plat orientation, Corner and well ties are based upon
the grid north meridian
Well location references are based upon the grid north
meridian.
UTM coordinates are NAD83, Zone 17, Meters.

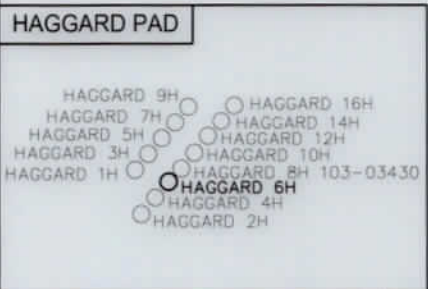

I, the undersigned, hereby certify that this plat is correct to the best of my knowledge and belief and shows all the information required by law and the regulations issued and prescribed by the Department of Environmental Protection.

Thomas C. Smit
L. L. S. 687



FILE NO: W2192 (BK 65-61)
DRAWING NO:
SCALE: 1" = 1000'
MINIMUM DEGREE OF ACCURACY:
1:2500
PROVEN SOURCE OF ELEVATION:
NGS CORS Station



DATE: AUGUST 3 20 22
OPERATORS WELL NO: Haggard 6H
API WELL NO: 464
47 - 103 - 03520
STATE COUNTY PERMIT

WELL TYPE: OIL GAS LIQUID INJECTION WASTE DISPOSAL
(IF GAS) PRODUCTION: STORAGE DEEP SHALLOW

LOCATION ELEVATION: 1512' WATERSHED: LOWER WEST VIRGINIA FORK FISH CREEK QUADRANGLE: LITTLETON
DISTRICT: Center COUNTY: Wetzel

SURFACE OWNER: Amie Lee Henderson ACREAGE: 45.5 ±
ROYALTY OWNER: Earnest Howard Cadle, et al. LEASE NO: 186297001 ACREAGE: 95 ±

PROPOSED WORK: DRILL CONVERT DRILL DEEPER FRACTURE OR STIMULATE PLUG OFF OLD FORMATION
 PERFORATE NEW FORMATION OTHER PHYSICAL CHANGE IN WELL (SPECIFY)

PLUG AND ABANDON CLEAN OUT AND REPLUG TARGET FORMATION: Marcellus ESTIMATED DEPTH: 7,618'

WELL OPERATOR: EQT Production Company DESIGNATED AGENT: Joseph C Mallow
ADDRESS: 400 Woodcliff Drive ADDRESS: 427 Midstate Drive
Canonsburg, PA 15317 Clarksburg, WV 26301

11/04/2022