

Haggard 2H
Haggard
EQT Production Company

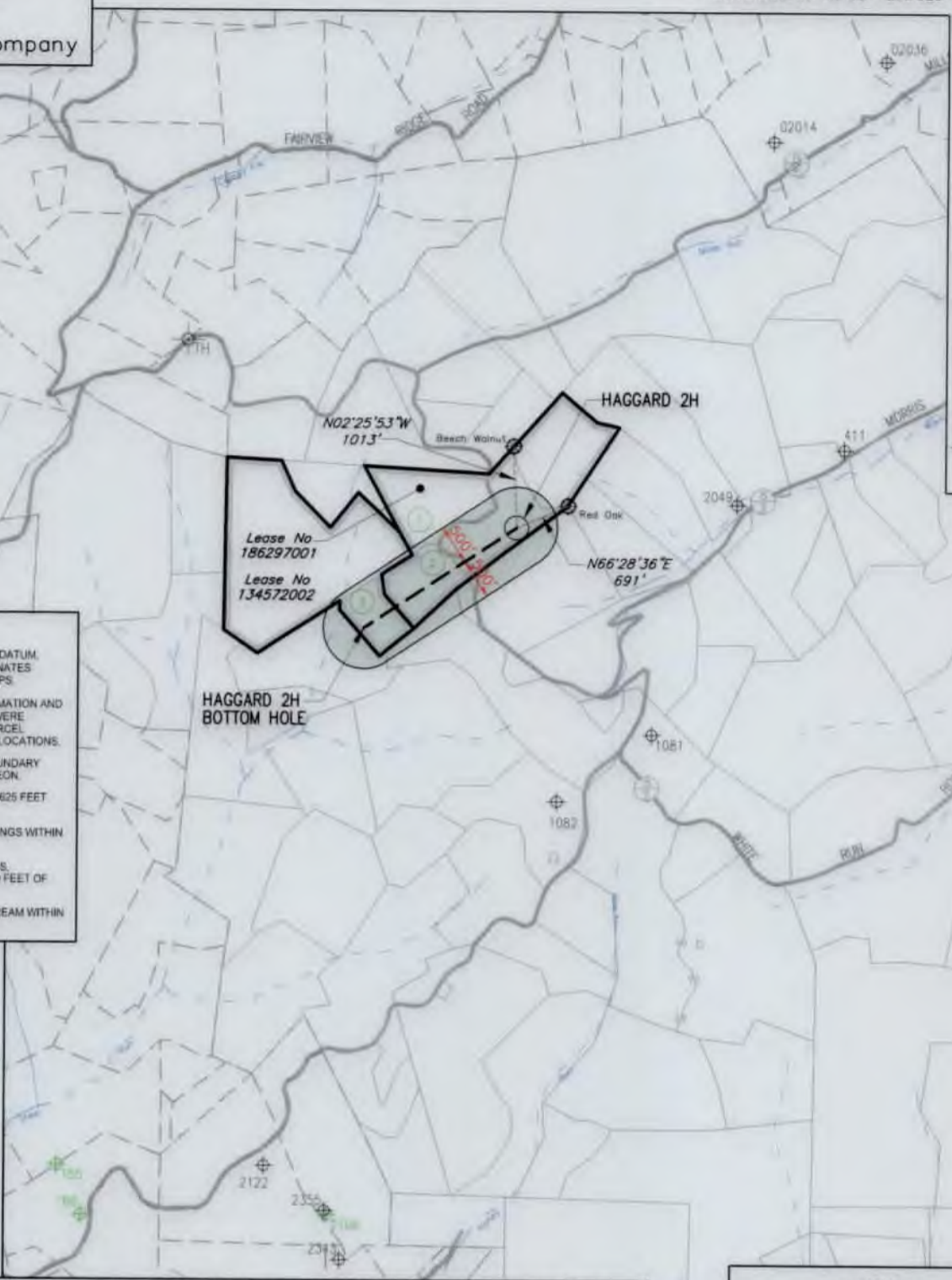
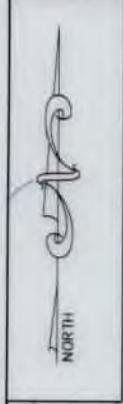

- NOTES ON SURVEY**
1. COORDINATES SYSTEM IS UTM, NAD 83 DATUM, ZONE 17, U.S. FOOT AND WELL COORDINATES ESTABLISHED USING SURVEY GRADE GPS.
 2. SURFACE AND ROYALTY OWNER INFORMATION AND THEIR BOUNDARIES SHOWN HEREON WERE PLOTTED FROM DEEDS AND/OR TAX PARCEL MAPS PROVIDED BY CLIENT AND FIELD LOCATIONS.
 3. THIS PLAT DOES NOT REPRESENT A BOUNDARY SURVEY OF THE PARCELS SHOWN HEREON.
 4. NO DWELLINGS AND BUILDINGS WITHIN 625 FEET OF PROPOSED OF CENTER OF PAD.
 5. NO WATER WELLS OR DEVELOPED SPRINGS WITHIN 250 FEET OF PROPOSED WELL.
 6. NO PERENNIAL STREAMS, LAKES, PONDS, RESERVOIRS OR WETLANDS WITHIN 100 FEET OF THE LIMITS OF DISTURBANCE.
 7. NO NATURALLY PRODUCING TROUT STREAM WITHIN 300 FEET OF LIMITS OF DISTURBANCE.

- LEGEND**
- ⊕ Active Well Location
 - ⊕ (Green) Plugger Well Location
 - ⊕ (Blue) Abandoned Well
 - ⊕ (Red) Salt Water Tract Ident. (Flowline)
 - Proposed Gas Well
 - ⊕ Located Corner, as noted
 - Surface Tract Lines (Surveyed)
 - Surface Tract Lines (Tax Map)
 - Reference Line
 - Lease Boundary
 - Creek or Drain
 - 5 WV County Route
 - 5 WV State Route

(⊕) Denotes Location of Well on United States Topographic Maps



I, the undersigned, hereby certify that this plat is correct to the best of my knowledge and belief and shows all the information required by law and the regulations issued and prescribed by the Department of Environmental Protection.

Thomas C. Smit
L. L. S. 687



FILE NO: _____
 DRAWING NO: _____
 SCALE: 1" = 2000'
 MINIMUM DEGREE OF ACCURACY: 1:2500
 PROVEN SOURCE OF ELEVATION: NGS CORS Station

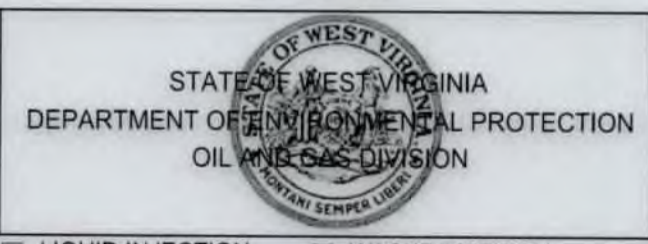

DATE: AUGUST 3 20 22
 OPERATORS WELL NO: Haggard 2H
 API WELL NO: 47 - 103 - 03526 H6A
 STATE COUNTY PERMIT

WELL TYPE: OIL GAS LIQUID INJECTION WASTE DISPOSAL
 (IF GAS) PRODUCTION: STORAGE DEEP SHALLOW

LOCATION ELEVATION: 1512' WATERSHED: LOWER WEST VIRGINIA FORK FISH CREEK QUADRANGLE: LITTLETON
 DISTRICT: Center COUNTY: Wetzel

SURFACE OWNER: Amie Lee Henderson ACREAGE: 45.5 ±
 ROYALTY OWNER: Earnest Howard Cadle, et al. LEASE NO: 186297001 ACREAGE: 95 ±

PROPOSED WORK: DRILL CONVERT DRILL DEEPER FRACTURE OR STIMULATE PLUG OFF OLD FORMATION
 PERFORATE NEW FORMATION OTHER PHYSICAL CHANGE IN WELL (SPECIFY)

PLUG AND ABANDON CLEAN OUT AND REPLUG TARGET FORMATION: Marcellus ESTIMATED DEPTH: 6,805'

11/04/2022

WELL OPERATOR: EQT Production Company DESIGNATED AGENT: Joseph C Mallow
 ADDRESS: 400 Woodcliff Drive ADDRESS: 427 Midstate Drive
 Canonsburg, PA 15317 Clarksburg, WV 26301

Haggard 2H
Haggard
EQT Production Company

Tract ID.	Tax Map No.	Parcel No.	County	District	Surface Tract Owner	Acres
1	10	36.0	Wetzel	Center	Amie Lee Henderson	45.50
2	10	37.0	Wetzel	Center	Amie Lee Henderson	14.50
3	10	51.0	Wetzel	Center	Sharon J McMillen	10.00

Lease	Owner	Acres
186297001	Earnest Howard Cadle, et al.	95
134572002	Dale E. Long, et al.	92

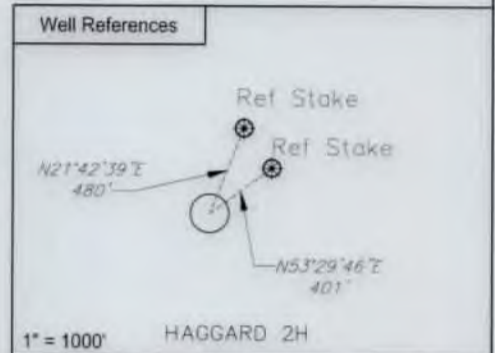
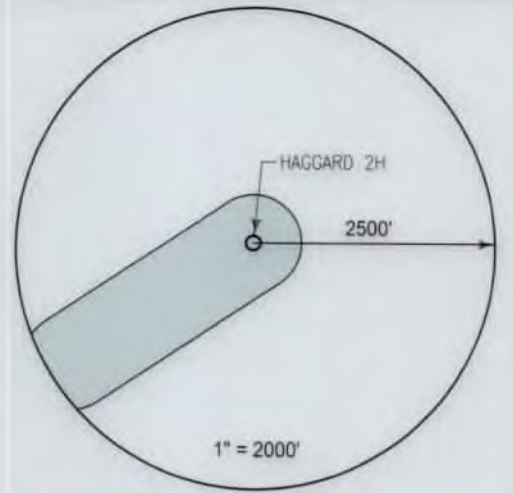

Notes:
HAGGARD 2H coordinates are
NAD 27 N: 422,331.750 E: 1,684,545.631
NAD 27 Lat: 39.654144 Long: -80.620402
NAD 83 UTM N: 4,389,449.612 E: 532,581.539

HAGGARD 2H Bottom Hole coordinates are
NAD 27 N: 421,091.200 E: 1,682,657.075
NAD 27 Lat: 39.650673 Long: -80.627053
NAD 83 UTM N: 4,389,062.041 E: 532,012.459

West Virginia Coordinates system of 1927 (North Zone)
based upon Differential GPS Measurements
Plat orientation, Corner and well ties are based upon
the grid north meridian
Well location references are based upon the grid north
meridian.
UTM coordinates are NAD83, Zone 17, Meters.

HAGGARD PAD

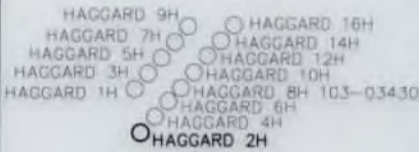

I, the undersigned, hereby certify that this plat is correct to the best of my knowledge and belief and shows all the information required by law and the regulations issued and prescribed by the Department of Environmental Protection.

Thomas C. Smit
L. L. S. 687



SEAL

FILE NO:
DRAWING NO:
SCALE: 1" = 1000'
MINIMUM DEGREE OF ACCURACY:
1:2500
PROVEN SOURCE OF ELEVATION:
NGS CORS Station

STATE OF WEST VIRGINIA
DEPARTMENT OF ENVIRONMENTAL PROTECTION
OIL AND GAS DIVISION



DATE: AUGUST 3 20 22
OPERATORS WELL NO: Haggard 2H
API WELL NO
47 - 103 - 03526 H44
STATE COUNTY PERMIT

WELL TYPE: OIL GAS LIQUID INJECTION WASTE DISPOSAL
(IF GAS) PRODUCTION: STORAGE DEEP SHALLOW

LOCATION ELEVATION: 1512' WATERSHED: LOWER WEST VIRGINIA FORK FISH CREEK QUADRANGLE: LITTLETON
DISTRICT: Center COUNTY: Wetzel

SURFACE OWNER: Amie Lee Henderson ACREAGE: 45.5 ±
ROYALTY OWNER: Earnest Howard Cadle, et al. LEASE NO: 186297001 ACREAGE: 95 ±

PROPOSED WORK: DRILL CONVERT DRILL DEEPER FRACTURE OR STIMULATE PLUG OFF OLD FORMATION
 PERFORATE NEW FORMATION OTHER PHYSICAL CHANGE IN WELL (SPECIFY)
 PLUG AND ABANDON CLEAN OUT AND REPLUG TARGET FORMATION: Marcellus ESTIMATED DEPTH: 6,805'

WELL OPERATOR: EQT Production Company DESIGNATED AGENT: Joseph C Mallow
ADDRESS: 400 Woodcliff Drive ADDRESS: 427 Midstate Drive
Canonsburg, PA 15317 Clarksburg, WV 26301

11/04/2022