

Cash 5H
Cash
EQT Production Company



CASH 5H
BOTTOM HOLE

MORRIS Run

Lease No
129400

Lease No
124458

Lease No
109572

Lease No
173671

Lease No
217153

Lease No
106710

Lease No
215535

CASH 5H
LANDING POINT

Lease No
138900

Lease No
132323

NOTES ON SURVEY

- COORDINATES SYSTEM IS UTM, NAD 83 DATUM, ZONE 17, U.S. FOOT AND WELL COORDINATES ESTABLISHED USING SURVEY GRADE GPS.
- SURFACE AND ROYALTY OWNER INFORMATION AND THEIR BOUNDARIES SHOWN HEREON WERE PLOTTED FROM DEEDS AND/OR TAX PARCEL MAPS PROVIDED BY CLIENT AND FIELD LOCATIONS.
- THIS PLAT DOES NOT REPRESENT A BOUNDARY SURVEY OF THE PARCELS SHOWN HEREON.
- NO DWELLINGS AND BUILDINGS WITHIN 625 FEET OF PROPOSED OF CENTER OF PAD.
- NO WATER WELLS OR DEVELOPED SPRINGS WITHIN 250 FEET OF PROPOSED WELL.
- NO PERENNIAL STREAMS, LAKES, PONDS, RESERVOIRS OR WETLANDS WITHIN 100 FEET OF THE LIMITS OF DISTURBANCE.
- NO NATURALLY PRODUCING TROUT STREAM WITHIN 300 FEET OF LIMITS OF DISTURBANCE.

LEGEND

- Active Well Location
- Abandoned Well Location
- Abandoned Well
- Surface Well Location
- Proposed Gas Well
- Located Corner, as noted
- Surface Tract Lines (Surveyed)
- Surface Tract Lines (Tax Map)
- Reference Line
- Lease Boundary
- Creek or Drain
- WV County Route
- WV State Route

() Denotes Location of Well on United States Topographic Maps



I, the undersigned, hereby certify that this plat is correct to the best of my knowledge and belief and shows all the information required by law and the regulations issued and prescribed by the Department of Environmental Protection.

Thomas C. Smit

L. L. S. 687



SEAL

FILE NO:
DRAWING NO:
SCALE: 1" = 2000'
MINIMUM DEGREE OF ACCURACY:
1:2500
PROVEN SOURCE OF ELEVATION:
NGS CORS Station

STATE OF WEST VIRGINIA
DEPARTMENT OF ENVIRONMENTAL PROTECTION
OIL AND GAS DIVISION

DATE: JULY 12 20 22
OPERATORS WELL NO: Cash 5H
API WELL NO
47 - 103 - 03523
STATE COUNTY PERMIT

WELL TYPE: OIL GAS LIQUID INJECTION WASTE DISPOSAL
(IF GAS) PRODUCTION: STORAGE DEEP SHALLOW
LOCATION ELEVATION: 1501' WATERSHED: Little Fishing Creek QUADRANGLE: Littleton
DISTRICT: Center COUNTY: Wetzel
SURFACE OWNER: John R. & Phyllis R. Bohrer ACREAGE: 52.95 ±
ROYALTY OWNER: Green Dot Farm, Inc., et al. LEASE NO: 215535 ACREAGE: 121.18±
PROPOSED WORK: DRILL CONVERT DRILL DEEPER FRACTURE OR STIMULATE PLUG OFF OLD FORMATION
 PERFORATE NEW FORMATION OTHER PHYSICAL CHANGE IN WELL (SPECIFY)
 PLUG AND ABANDON CLEAN OUT AND REPLUG TARGET FORMATION: Marcellus ESTIMATED DEPTH: 7,577'

08/19/2022

WELL OPERATOR: EQT Production Company DESIGNATED AGENT: Joseph C Mallow
ADDRESS: 400 Woodcliff Drive ADDRESS: 427 Midstate Drive
Canonsburg, PA 15317 Clarksburg, WV 26301

Cash 5H
Cash
EQT Production Company

Tract ID.	Tax Map No.	Parcel No.	County	District	Surface Tract Owner	Acres
1	15	59.1	Wetzel	Center	Michael D & Amber N Amos	24.74
2	15	58.0	Wetzel	Center	John R. & Phyllis R. Bohrer	52.95
3	15	47.0	Wetzel	Center	Phillips CO EST & Goldie EST, Shuman & Anna Marie Haynes	47.30
4	15	46.0	Wetzel	Center	Robert E Sr & Brenda S Dorsey	82.00
5	15	46.1	Wetzel	Center	Robert E Dorsey Sr	1.00
6	15	32.0	Wetzel	Center	Ronald L Reed	19.58
7	15	19.0	Wetzel	Center	Linda Kay & Gary Wilson	12.04
8	15	19.2	Wetzel	Center	William Coffman	2.03
9	15	17.0	Wetzel	Center	Jonathan W White	41.50
10	15	21.1	Wetzel	Center	Tamara M & Shaun D Kuhn	7.73
11	15	3.0	Wetzel	Center	Connie S White	47.50
12	11	30.0	Wetzel	Center	Edward M., II & Judith Q. Kauffman, Jeffrey M. Kauffman and Jennifer M. Stake	93.48
13	11	15.0	Wetzel	Center	Green Dot Farm, Inc.	133.00
Lease	Owner				Acres	
215535	Green Dot Farm, Inc., et al				121.15 ac	
132323	AMP IV, LP, et al				100 ac	
138900	William B. Franck and Pamela S. Franck, Trustees of the William B. and Pamela S. Franck Joint Revocable Living Trust dated 2/12/2018, et al				75 ac	
119126	Thomas J. Jacoboni, Trustee of the Thomas J. Jacoboni Revocable Trust Agreement dated 5/15/2018, et al				16.66 ac	
106710	Adelaide Yvonne Emery Aulch, et al				39.5 ac	
217153	Venable Royalty, LTD., and V14 LP				47.144 ac	
173671	William B. Franck and Pamela S. Franck, Trustees of the William B. and Pamela S. Franck Joint Revocable Living Trust dated 2/12/2018, et al				8,08375 ac	
109572	AMP IV, LP, et al				47.5 ac of 389.34 ac lease	
124458	Dorothy L. Barrett, et al				96 ac	
129400	Timothy J. Ascraft, et al				398 ac	

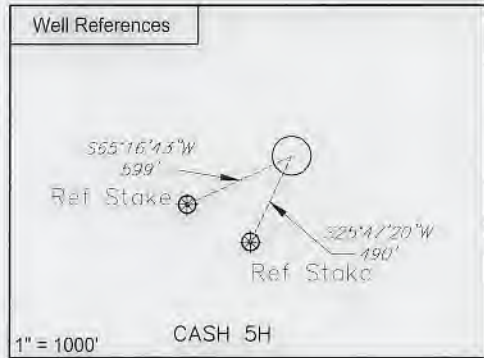
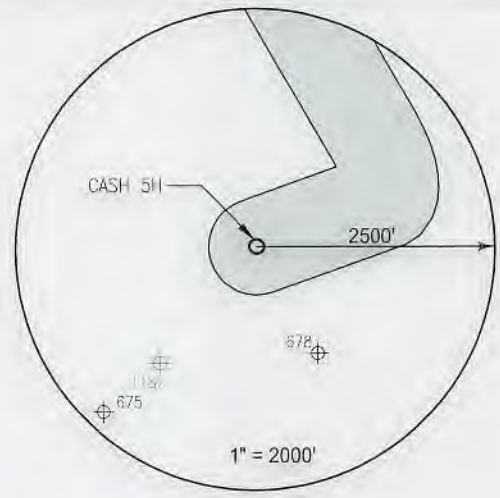

Notes:
 CASH 5H coordinates are
 NAD 27 N: 413,429.025 E: 1,694,704.066
 NAD 27 Lat: 39.630045 Long: -80.583944
 NAD 83 UTM N: 4,386,789.062 E: 535,721.645

CASH 5H Landing Point coordinates are
 NAD 27 N: 414,576.919 E: 1,695,926.125
 NAD 27 Lat: 39.633237 Long: -80.579654
 NAD 83 UTM N: 4,387,145.009 E: 536,088.139

CASH 5H Bottom Hole coordinates are
 NAD 27 N: 423,428.851 E: 1,690,785.041
 NAD 27 Lat: 39.657367 Long: -80.598291
 NAD 83 UTM N: 4,389,815.654 E: 534,476.902

West Virginia Coordinates system of 1927 (North Zone)
 based upon Differential GPS Measurements
 Plat orientation, Corner and well ties are based upon
 the grid north meridian
 Well location references are based upon the grid north
 meridian.
 UTM coordinates are NAD83, Zone 17, Meters.

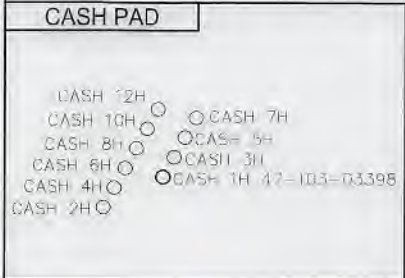

I, the undersigned, hereby certify that this plat is correct to the best of my knowledge and belief and shows all the information required by law and the regulations issued and prescribed by the Department of Environmental Protection.

Thomas C. Smit
 L. L. S. 687



FILE NO: W2192 (BK 65-61)
 DRAWING NO:
 SCALE: 1" = 1000'
 MINIMUM DEGREE OF ACCURACY:
 1:2500
 PROVEN SOURCE OF ELEVATION:
 NGS CORS Station



DATE: JULY 12 20 22
 OPERATORS WELL NO: Cash 5H
 API WELL NO
 47 - 103 - 03523
 STATE COUNTY PERMIT

WELL TYPE: OIL GAS LIQUID INJECTION WASTE DISPOSAL
 (IF GAS) PRODUCTION: STORAGE DEEP SHALLOW

LOCATION ELEVATION: 1501' WATERSHED: Little Fishing Creek QUADRANGLE: Littleton
 DISTRICT: Center COUNTY: Wetzel

SURFACE OWNER: John R. & Phyllis R. Bohrer ACREAGE: 52.95 ±
 ROYALTY OWNER: Green Dot Farm, Inc., et al. LEASE NO: 215535 ACREAGE: 121.18 ±

PROPOSED WORK: DRILL CONVERT DRILL DEEPER FRACTURE OR STIMULATE PLUG OFF OLD FORMATION
 PERFORATE NEW FORMATION OTHER PHYSICAL CHANGE IN WELL (SPECIFY)

PLUG AND ABANDON CLEAN OUT AND REPLUG TARGET FORMATION: Marcellus ESTIMATED DEPTH: 7,577'

WELL OPERATOR: EQT Production Company DESIGNATED AGENT: Joseph C Mallow
 ADDRESS: 400 Woodcliff Drive ADDRESS: 427 Midstate Drive
 Canonsburg, PA 15317 Clarksburg, WV 26301

08/19/2022